

LATITUDE: 37°15'00"

LONGITUDE: 81°42'30"

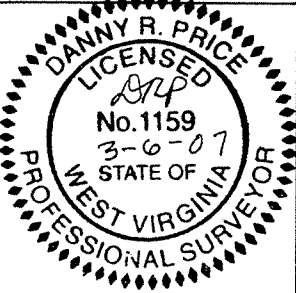

COORDINATES
 N. 87,906.61 LAT. 37.238926
 E. 1,790,758.44 LONG. 81.719597

WV SOUTH
 NAD 27

A N 64°53'25" W 948.19'
 B N 75°08'02" W 6651.19'
 C N 76°49'23" W 5720.60'

NOTE:
 PLAT WERE TAKEN FROM MAPS PROVIDED BY CNX LAND RESOURCES AND WERE NOT SURVEYED

COORDINATES FOR THE EXISTING WELLS WERE TAKEN FROM THE OFFICE OF OIL AND GAS RECORDS

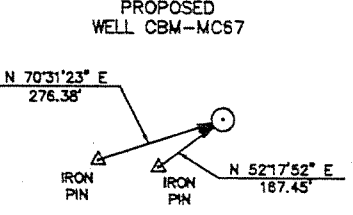

REFERENCES: NO SCALE

NO KNOWN WATER WELLS WITHIN 1000'

FILE NO. _____
 DRAWING NO. _____
 SCALE 1" = 2000'
 MINIMUM DEGREE OF ACCURACY 1 : 2,500
 PROVEN SOURCE OF ELEVATION _____ SURVEYED

I THE UNDERSIGNED, HEREBY CERTIFY THAT THIS PLAT IS CORRECT TO THE BEST OF MY KNOWLEDGE AND BELIEF AND SHOWS ALL THE INFORMATION REQUIRED BY LAW AND THE REGULATIONS ISSUED AND PRESCRIBED BY THE DEPARTMENT OF MINES.
 (SIGNED) Danny R. Price
 R.P.E. _____ L.L.S. ✓

(+) DENOTES LOCATION OF WELL ON UNITED STATES TOPOGRAPHIC MAPS
 FORM IV-6
 (8-78)



DATE MARCH 06, 2007
 OPERATOR'S WELL NO. CBM-MC67
 API WELL NO. 47-047-02428C
 STATE COUNTY PERMIT

Division of Environmental Protection
 Office of Oil & Gas

WELL TYPE : OIL _____ GAS X LIQUID INJECTION _____ WASTE DISPOSAL _____
 (IF "GAS" , PRODUCTION X STORAGE _____ DEEP _____ SHALLOW X)
 LOCATION: ELEVATION 2983.63' WATER SHED WAR CREEK OF DRY FORK OF THE TUG RIVER
 DISTRICT BIG CREEK COUNTY MCDOWELL
 QUADRANGLE AMONATE

SURFACE OWNER BERWIND LAND COMPANY ACREAGE 715
 OIL & GAS ROYALTY OWNER BERWIND LAND COMPANY LEASE ACREAGE 31,425.18
 LEASE NO. 490001

PROPOSED WORK : DRILL X CONVERT _____ DRILL DEEPER _____ REDRILL _____ FRACTURE OR STIMULATION X PLUG OFF OLD FORMATION _____ PERFORATE NEW FORMATION _____ OTHER PHYSICAL CHANGE IN WELL (SPECIFY) _____

PLUG AND ABANDON _____ CLEAN OUT AND REPLUG _____
 TARGET FORMATION POCAHOTAS / NEW RIVER ESTIMATED DEPTH 2340'
 WELL OPERATOR CNX GAS COMPANY LLC DESIGNATED AGENT JOHN H. JOHNSTON
 ADDRESS 2481 JOHN NASH BLVD. BLUEFIELD, WV 24701 ADDRESS BANK ONE CENTER, 7TH FLOOR P.O. BOX 1588 CHARLESTON WV 25326-1588

JAN 25 2008

McDOW 0428C