

PROPOSED CALCITE #1 CBM
 WELL COORDINATES:
 WEST VIRGINIA STATE PLANE
 N: 179566.33 E: 1763259.26
 ELEVATION: 1812.55

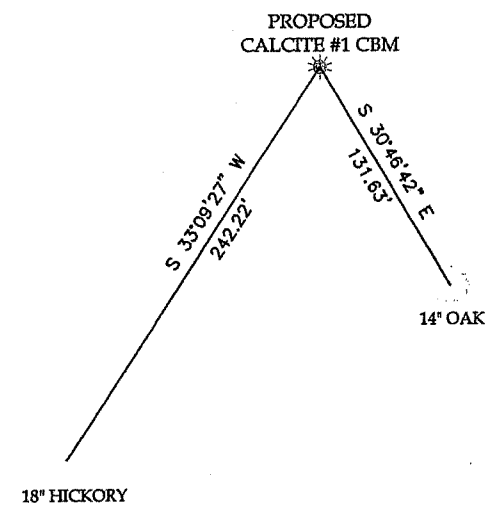
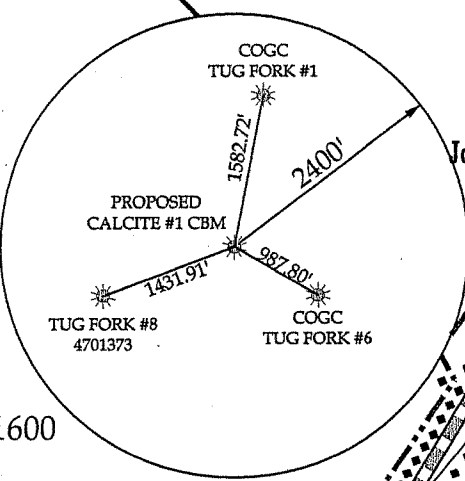

REFERENCES SCALE: 1"=100'

I THE UNDERSIGNED, HEREBY CERTIFY THAT THIS PLAT IS CORRECT TO THE BEST OF MY KNOWLEDGE AND BELIEF AND SHOWS ALL THE INFORMATION REQUIRED BY LAW AND THE REGULATIONS ISSUED AND PRESCRIBED BY THE DIVISION OF ENVIRONMENTAL PROTECTION.

(SIGNED) Philip Bailey

R.P.E. _____ R.P.S. X

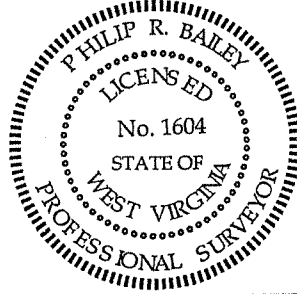

(+) DENOTES LOCATION OF WELL ON UNITED STATES TOPO MAPS

DATE DECEMBER 16, 20 05

OPERATOR'S WELL NO. CALCITE #1 CBM

API WELL No. 47 - 47 - 02161C

STATE COUNTY PERMIT

MINIMUM DEGREE OF ACCURACY 1:10,000

FILE NO. G500-05

SCALE: 1" = 1000'

PROVEN SOURCE OF ELEVATION TRIG LEVELING FROM KNOWN GPS MONUMENT

DRAWING NO. CALCITE1plat.dwg

STATE OF WEST VIRGINIA
 DIVISION OF ENVIRONMENTAL PROTECTION
 OFFICE OF OIL AND GAS

WELL TYPE: OIL _____ GAS X LIQUID INJECTION _____ WASTE DISPOSAL _____

(IF "GAS") PRODUCTION X STORAGE _____ DEEP _____ SHALLOW _____

LOCATION: ELEVATION 1812.55 WATER SHED JOHNNYCAKE BRANCH

DISTRICT SANDY RIVER COUNTY McDOWELL

QUADRANGLE IAEGER

SURFACE OWNER TUG FORK LAND CO. ACREAGE ±172

OIL & GAS ROYALTY OWNER MARCO LAND CO. (COAL & CBM) LEASE ACREAGE ±1200

LEASE NO. _____

PROPOSED WORK: DRILL X CONVERT _____ DRILL DEEPER _____ REDRILL _____ FRACTURE OR STIMULATE _____ PLUG OFF OLD FORMATION _____ PERFORATE NEW FORMATION _____ OTHER PHYSICAL CHANGE IN WELL (SPECIFY) _____

PLUG AND ABANDON X CLEAN OUT AND REPLUG _____

TARGET FORMATION Point Coal ESTIMATED DEPTH 2215' JUN 23 2006

WELL OPERATOR NORTHPORT PRODUCTION COMPANY DESIGNATED AGENT TOM WHITE

ADDRESS 2601 NW EXPRESSWAY, SUITE 902-E OKLAHOMA CITY, OK 73112 ADDRESS: 1 MEADOW RD DUNBAR, WV 25064

McDOWELL 2161C