

(+) DENOTES LOCATION OF WELL ON 7.5' TOPOGRAPHIC MAP

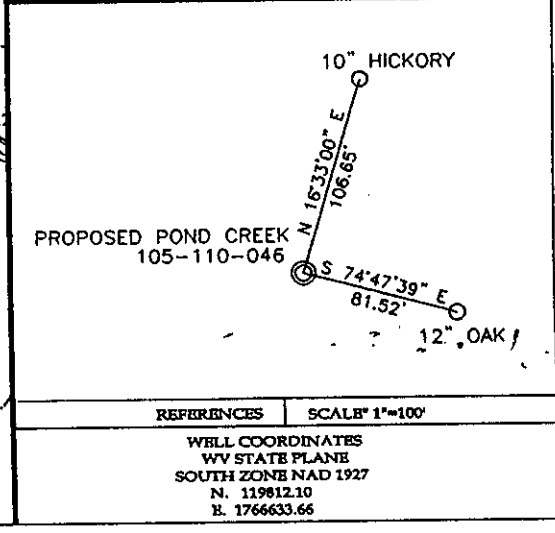

TEE Engineering Company, Inc.
 320 Cutlers Hill Court
 Lexington, KY 40509
 (606) 263-5350
 Fax (606) 263-5345

GeoMet Operating Company, Inc.
 Well No. Pond Creek 105-110-046

FILE NO. 1883-08
 DRAWING NO. WELL 46 PLAT
 SCALE: 1" = 2,000'
 MIN. DEGREE OF ACCURACY 1 : 2,500
 PROVEN SOURCE OF ELEVATION
 GPS STATION TEC-1 (ELEV. 2406.60)

I, THE UNDERSIGNED, HEREBY CERTIFY THAT THIS PLAT IS CORRECT TO THE BEST OF MY KNOWLEDGE AND BELIEF AND SHOWS ALL THE INFORMATION REQUIRED BY LAW AND THE REGULATIONS ISSUED AND PRESCRIBED BY THE DEPARTMENT OF MINES.

Don F. Blackburn
 (SIGNATURE)

R.P.E. 8643 R.P.S.

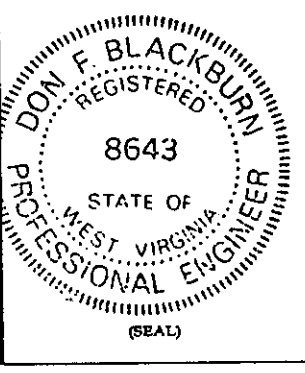

STATE OF WEST VIRGINIA
 DEPARTMENT OF ENVIRONMENTAL PROTECTION
 OFFICE OF OIL AND GAS

DATE MAY 6, 2002
 OPERATOR'S WELL NO. POND CREEK 105-110-046

WELL TYPE: OIL GAS X CBM LIQUID INJECTION WASTE DISPOSAL
 (IF "GAS") PRODUCTION STORAGE DEEP SHALLOW

LOCATION: ELEVATION 1,576.74' WATER SHED HITE FORK OF BRADSHAW CREEK
 DISTRICT SANDY RIVER COUNTY McDOWELL
 QUADRANGLE BRADSHAW

SURFACE OWNER PLUM CREEK TIMBERLANDS, L.P. ACREAGE 9,909.37
 CBM ROYALTY OWNER PLUM CREEK TIMBERLANDS, L.P. LEASE ACREAGE 9,909.37
 LEASE NO. RECORDING IN PROGRESS

PROPOSED WORK: DRILL X CONVERT DRILL DEEPER REDRILL FRACTURE OR
 STIMULATE PLUG OFF OLD FORMATION PERFORATE NEW
 FORMATION OTHER PHYSICAL CHANGE IN WELL (SPECIFY)

PLUG AND ABANDON CLEAN OUT AND REPLUG

TARGET FORMATION NEW RIVER AND POCAHONTAS COALS ESTIMATED DEPTH 1,519'
 WELL OPERATOR GEOMET OPERATING COMPANY, INC. DESIGNATED AGENT GREGG CLEARY
 ADDRESS 5336 STADIUM TRACE PARKWAY SUITE 3206 ADDRESS 1105 HEATHERWOOD ROAD
BIRMINGHAM, ALABAMA 35244 BLUEFIELD, WV 24701

Mc Dow 1672C

State of West Virginia
Department of Environmental Protection
Office of Oil and Gas

Aut

Well Operator's Report of Well Work

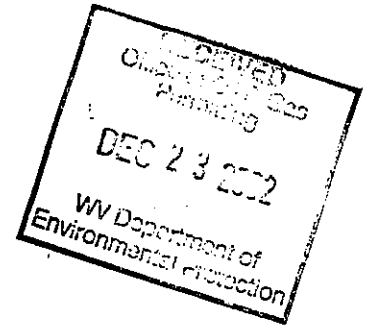

FARM NAME: Plum Creek Timberlands, L.P. OPERATOR WELL NO.: PC #46

LOCATION:

Elevation: 1,576.74' Quadrangle: Bradshaw

District: Sandy River County: McDowell
Latitude: 3,155 Feet South of 37 Deg. 20 Min. 00 Sec.
Longitude: 2,577 Feet West of 81 Deg. 47 Min. 30 Sec.

| Company: <u>GeoMet Operating Company</u> | Casing & Tubing | Used in Drilling | Left in Well | Cement fill up Cu. Ft. |
|---|-----------------|------------------|--------------|------------------------|
| Address: <u>5336 Stadium Trace Parkway, Suite 206 Birmingham, Alabama 35244</u> | <u>13-3/8"</u> | <u>18'</u> | <u>18'</u> | |
| Agent: <u>Gregg Cleary</u> | | | | |
| Inspector: <u>Ronnie Scott</u> | <u>8-5/8"</u> | <u>410'</u> | <u>410'</u> | <u>169/Pumped 168</u> |
| Date Permit Issued: <u>July 5, 2002</u> | | | | |
| Date Well Work Commenced: <u>August 20, 2002</u> | <u>5-1/2"</u> | <u>1496'</u> | <u>1496'</u> | <u>275/ Pumped 288</u> |
| Date Well Work Completed: <u>September 13, 2002</u> | | | | |
| Verbal Plugging: | | | | |
| Date Permission granted on: | | | | |
| Rotary <u>XXXX</u> Cable <u> </u> Rig <u> </u> | | | | |
| Total Depth (feet): <u>1520'</u> | | | | |
| Fresh Water Depth (feet): <u>Unknown</u> | | | | |
| Salt Water Depth (feet): <u>Unknown</u> | | | | |
| Is coal being mined in area (N/Y)? <u>No</u> | | | | |

Coal Depths (feet): 404/446/562/660/684/906/922/961/1014/1100/1156/1266

OPEN FLOW DATA

Producing formation All Zones Commingled Pay zone depth (ft) _____
Gas: Initial Open Flow N/A MCF/d Oil: Initial Open Flow _____ Bbl/d
Final Open Flow N/A MCF/d Final Open Flow _____ Bbl/d
Time of Open Flow between initial and final tests N/A Hours
Static Rock Pressure 200 psig (surface pressure) after 96 Hours

NOTE: ON BACK OF THIS FORM PUT THE FOLLOWING: 1). DETAILS OF PERFORATED INTERVALS, FRACTURING OR STIMULATING, PHYSICAL CHANGE, ETC. 2). THE WELL LOG WHICH IS A SYSTEMATIC DETAILED GEOLOGICAL RECORD OF ALL FORMATIONS, INCLUDING COAL ENCOUNTERED BY THE WELLBORE.

SIGNED: _____
BY: Karen Rye
DATE: 12-19-2002

JAN 17 2003

Mc Dow 1672C

API #: 47-01672C

Operator Well #: PC #046

Farm Name: Plum Creek Timberlands, L.P.

1.) Details of perforated intervals, fracturing or stimulating, physical change, etc.

1st Stage:

Perf P1, 1263' – 1267'/Perf P-2, 1254' – 1257' & frac on 09/13/02 by Superior with 70Q Foam 23,000# 16/30 Sand, 257,000 SCF N2, 238 Total Bbls Fluid. Breakdown Pressure 3680 PSIG, Average Pressure 2590 PSI, 1346 ISIP

2nd Stage:

Perf P3, 1157' – 1163'/Perf P4 1100' – ~~1163'~~ & frac on 09/13/02 by Superior with 70Q Foam 32,000# 16/30 Sand, 257,000 SCF N2, 214 Total Bbls Fluid. Breakdown Pressure 2001 PSIG, Average Pressure 1973 PSI, 1163 ISIP

3rd Stage:

Perf P5, 1013' – 1017' & frac on 09/13/02 by Superior with 70Q Foam 17,000# 16/30 Sand, 205,000 SCF N2, 167 Total Bbls Fluid. Breakdown Pressure 2920 PSIG, Average Pressure 2506 PSI, 1678 ISIP

4th Stage:

Perf P9-6, 962' – 970' & frac on 09/13/02 by Superior with 70Q Foam 52,000# 16/30 Sand, 382,000 SCF N2, 333 Total Bbls Fluid. Breakdown Pressure 2621 PSIG, Average Pressure 2586 PSI, 1591 ISIP

5th Stage:

Perf P9, 906' – 925' & frac on 09/13/02 by Superior with 70Q Foam 23,000# 16/30 Sand, 234,000 SCF N2, 143 Total Bbls Fluid. Breakdown Pressure 3570 PSIG, Average Pressure 2395 PSI, 1003 ISIP

6th Stage:

Perf P10, 694' – 703'/Perf P10-1, 661' – 664' & frac on 09/13/02 by Superior with 70Q Foam 37,000# 16/30 Sand, 223,000 SCF N2, 167 Total Bbls Fluid. Breakdown Pressure 1965 PSIG, Average Pressure 1825 PSI, 1135 ISIP

DRILL DATA HOLE - NOAH HORN WELL DRILLING, INC.

COMPANY: GEOMET OPERATING CO. HOLE NO.: GPPC-046

LOCATION: BUG HURLEY HOLLOW DRILL: RIG # 23

DATE STARTED: 08-20-2002 DATE COMPLETED: 08-23-2002

| DEPTH | | THICKNESS | STRATA | REMARKS |
|-------------------|-------------------|------------------|---|-----------------------|
| FROM | TO | FT. | DESCRIPTION | VOIDS, ETC |
| 0.00 | 18.00 | 18.00 | OVERBURDEN | 18' W/ 13 3/8" CASING |
| 18.00 | 30.00 | 12.00 | SANDSTONE | |
| 30.00 | 61.00 | 31.00 | SAND / COAL STR / SAND | |
| 61.00 | 92.00 | 31.00 | SANDSTONE | |
| 92.00 | 123.00 | 31.00 | SAND / SANDY SHALE | |
| 123.00 | 154.00 | 31.00 | SANDY SHALE | |
| 154.00 | 185.00 | 31.00 | SANDY SHALE / COAL 160'-162' / SANDY SHALE / SAND STR | |
| 185.00 | 215.00 | 30.00 | COAL 187' / SANDY SHALE / SAND | |
| 215.00 | 245.00 | 30.00 | COAL 217' / SAND | |
| 245.00 | 275.00 | 30.00 | SAND / COAL 270'-273' | |
| 275.00 | 305.00 | 30.00 | SANDY SHALE / SAND | |
| 305.00 | 335.00 | 30.00 | SAND / SANDY SHALE / POSS. COAL | |
| 335.00 | 365.00 | 30.00 | SANDY SHALE / COAL 348'-350' / SAND | |
| 365.00 | 395.00 | 30.00 | COAL 368'-370' / SANDY SHALE / SAND | |
| 395.00 | 425.00 | 30.00 | COAL 400'-402' / SANDY SHALE / SAND | |
| 425.00 | 450.00 | 25.00 | SANDY SHALE / COAL STR / SANDY SHALE | 410' W/ 8 5/8" CASING |
| 450.00 | 480.00 | 30.00 | SANDY SHALE | |
| 480.00 | 510.00 | 30.00 | SANDY SHALE / SAND / SANDY SHALE | |
| 510.00 | 540.00 | 30.00 | SANDY SHALE | |
| 540.00 | 570.00 | 30.00 | SAND / COAL STR / SANDY SHALE | |
| 570.00 | 630.00 | 60.00 | SANDSTONE | |
| 630.00 | 660.00 | 30.00 | SAND / COAL STR / SANDY SHALE | |
| 660.00 | 690.00 | 30.00 | SANDY SHALE / SAND / SANDY SHALE | |
| 690.00 | 720.00 | 30.00 | SANDY SHALE / COAL / SANDY SHALE / COAL STR / SANDY SHALE | |
| 720.00 | 750.00 | 30.00 | SANDY SHALE / SAND / SANDY SHALE | |
| 750.00 | 780.00 | 30.00 | SANDY SHALE | |
| 780.00 | 810.00 | 30.00 | SANDY SHALE / COAL STR / SANDY SHALE | |
| 810.00 | 840.00 | 30.00 | SANDY SHALE / SANDSTONE | |
| 840.00 | 870.00 | 30.00 | SANDSTONE | |
| 870.00 | 900.00 | 30.00 | SAND / SANDY SHALE | |
| 900.00 | 930.00 | 30.00 | SANDY SHALE / COAL STR / SANDY SHALE | |
| 930.00 | 960.00 | 30.00 | SANDY SHALE / COAL STR | |
| 960.00 | 990.00 | 30.00 | SANDY SHALE / SAND / COAL STR / SAND | |
| 990.00 | 1020.00 | 30.00 | SANDY HSALE / COAL 1007'-1009' / SANDY SHALE | |
| 1020.00 | 1050.00 | 30.00 | SANDY SHALE / SAND | |
| 1050.00 | 1080.00 | 30.00 | SAND / SANDY SHALE / COAL STR 1075' / SAND | |
| 1080.00 | 1110.00 | 30.00 | SANDY SHALE / COAL 1100' / SAND | |

400 7 2000

M = Down / 672 C

| FROM | TO | FT. | DESCRIPTION |
|---------|---------|-------|---|
| 1110.00 | 1140.00 | 30.00 | SANDY SHALE / SAND STR / SANDY SHALE |
| 1140.00 | 1170.00 | 30.00 | SAND / SANDY SHALE / COAL 1160'-1162'/ SANDY SHALE |
| 1170.00 | 1200.00 | 30.00 | SANDY SHALE / SAND / COAL 1190'-1192'/ SAND |
| 1200.00 | 1230.00 | 30.00 | SANDY SHALE / SAND STR / SANDY SHALE |
| 1230.00 | 1260.00 | 30.00 | SAND / SANDY SHALE |
| 1260.00 | 1290.00 | 30.00 | COAL 1262'-1264'/ SANDY SHALE / SAND |
| 1290.00 | 1320.00 | 30.00 | SANDY SHALE / SAND |
| 1320.00 | 1350.00 | 30.00 | SAND / SANDY SHALE |
| 1350.00 | 1380.00 | 30.00 | SANDY SHALE / SAND / COAL 1365' |
| 1380.00 | 1410.00 | 30.00 | SAND |
| 1410.00 | 1440.00 | 30.00 | SANDY SHALE / COAL STR 1425'/ SANDY SHALE |
| 1440.00 | 1470.00 | 30.00 | SAND / SANDY SHALE / RED SHALE 1465' |
| 1470.00 | 1530.00 | 60.00 | SAND / SANDY SHALE TD 8" HOLE |

1530.00 FT. TOTAL DEPTH
 18.00 FT. OF 13 3/8" CASING
 410.00 FT. OF 8 5/8" CASING