

42-13

WEST VIRGINIA STATE PLANE COORDINATES

NAD 27
N 186,651.83
E 1,814,916.22

LATITUDE 37° 32' 30"

LONGITUDE 81° 37' 30"

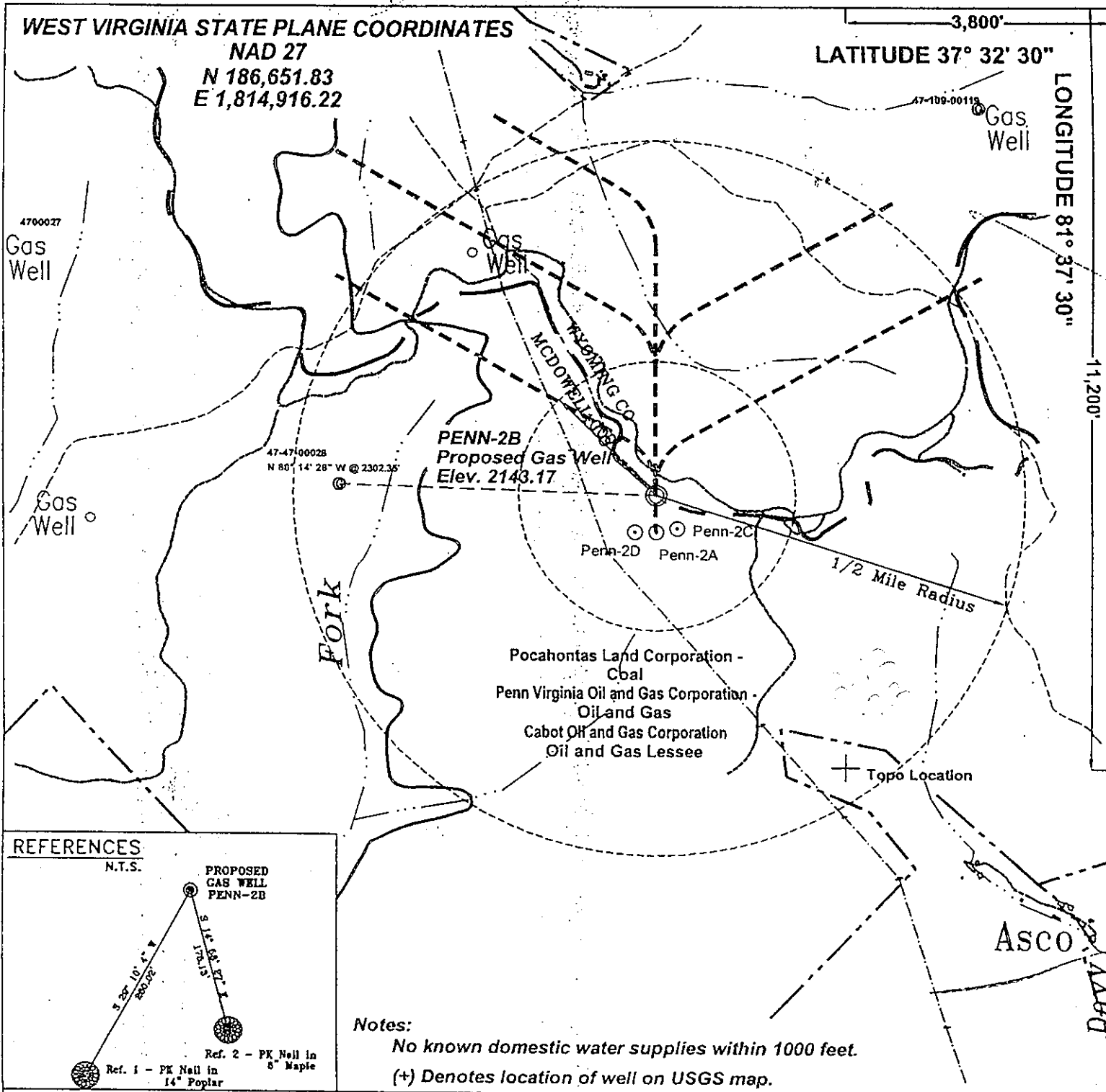

REFERENCES

N.T.S.

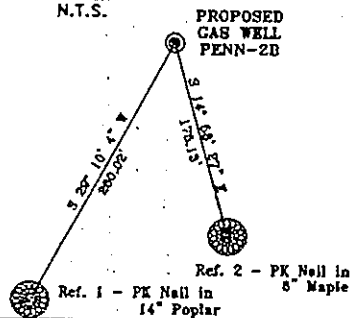

Notes:

No known domestic water supplies within 1000 feet.
(+) Denotes location of well on USGS map.

FILE No. CDXGAS
 DRAWING NAME CDXGAS\PLAT
 DRAWING NAME PENN-2B
 SCALE 1" = 1000'
 MINIMUM DEGREE OF ACCURACY 1 : 2500
 PROVEN SOURCE OF ELEVATION GPS - GLOBAL POSITIONING SYSTEM

I THE UNDERSIGNED, HEREBY CERTIFY THAT THIS PLAT IS CORRECT TO THE BEST OF MY KNOWLEDGE AND BELIEF AND SHOWS ALL THE INFORMATION REQUIRED BY LAW AND THE REGULATIONS ISSUED AND PRESCRIBED BY THE DEPARTMENT OF MINES.

(SIGNED) W. Claude Banner, Jr.
 R.P.E. 2430 R.P.S.

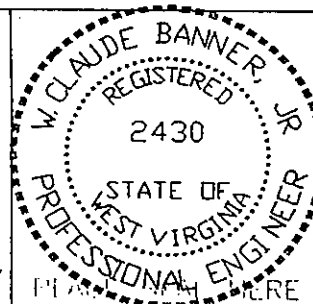

STATE OF WEST VIRGINIA
 DIVISION OF ENVIRONMENTAL PROTECTION
 OFFICE OF OIL AND GAS
 NITRO, WV

DATE APRIL 29, 2002
 OPERATOR'S WELL No. PENN-2B
 API WELL No. 47 - 047 - 016580
 STATE COUNTY PERMIT

WELL TYPE: OIL GAS CBM LIQUID INJECTION WASTE DISPOSAL
 (IF "GAS") PRODUCTION X STORAGE DEEP SHALLOW
 LOCATION: ELEVATION 2143.17 WATER SHED TRIBUTARY OF LEFT FORK OF TUG FORK
 DISTRICT BROWNS CREEK COUNTY MCDOWELL
 QUADRANGLE BAILEYSVILLE, WV

SURFACE OWNER POCAHONTAS LAND CORPORATION ACREAGE 5,522.72
 CBM ROYALTY OWNER PENN VIRGINIA OIL AND GAS CORPORATION LEASE ACREAGE 5,522.72

LEASE No. _____
 PROPOSED WORK: DRILL X CONVERT DRILL DEEPER REDRILL FRACTURE OR STIMULATE PLUG OFF OLD FORMATION PERFORATE NEW FORMATION OTHER PHYSICAL CHANGE IN WELL (SPECIFY)

PLUG AND ABANDON CLEAN OUT AND REPLUG
 TARGET FORMATION POCA NO. 3, POCA NO. 4 AND FIRECREEK ESTIMATED DEPTH 1451' JUN 07 2002
 WELL OPERATOR CDX GAS, LLC DESIGNATED AGENT JOSEPH ZUPANICK
 ADDRESS P.O. BOX 609 ADDRESS P.O. BOX 609
PINEVILLE, WV 24874 PINEVILLE, WV 24874