

40°00'00"

Latitude

80°42'30"

Longitude

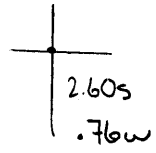

**Topo Location**

7.5' Loc. \_\_\_\_\_ 15' Loc. \_\_\_\_\_  
 \_\_\_\_\_ (calc.) \_\_\_\_\_

**Company** Producers Supply + Tool Co

**Farm** Phillip Mankey #1

**15' Quad** \_\_\_\_\_  
(sec.)

**7.5' Quad** Moundsville

**District** Union

**WELL LOCATION PLAT**

**County** 051 **Permit** 30041

Union dist

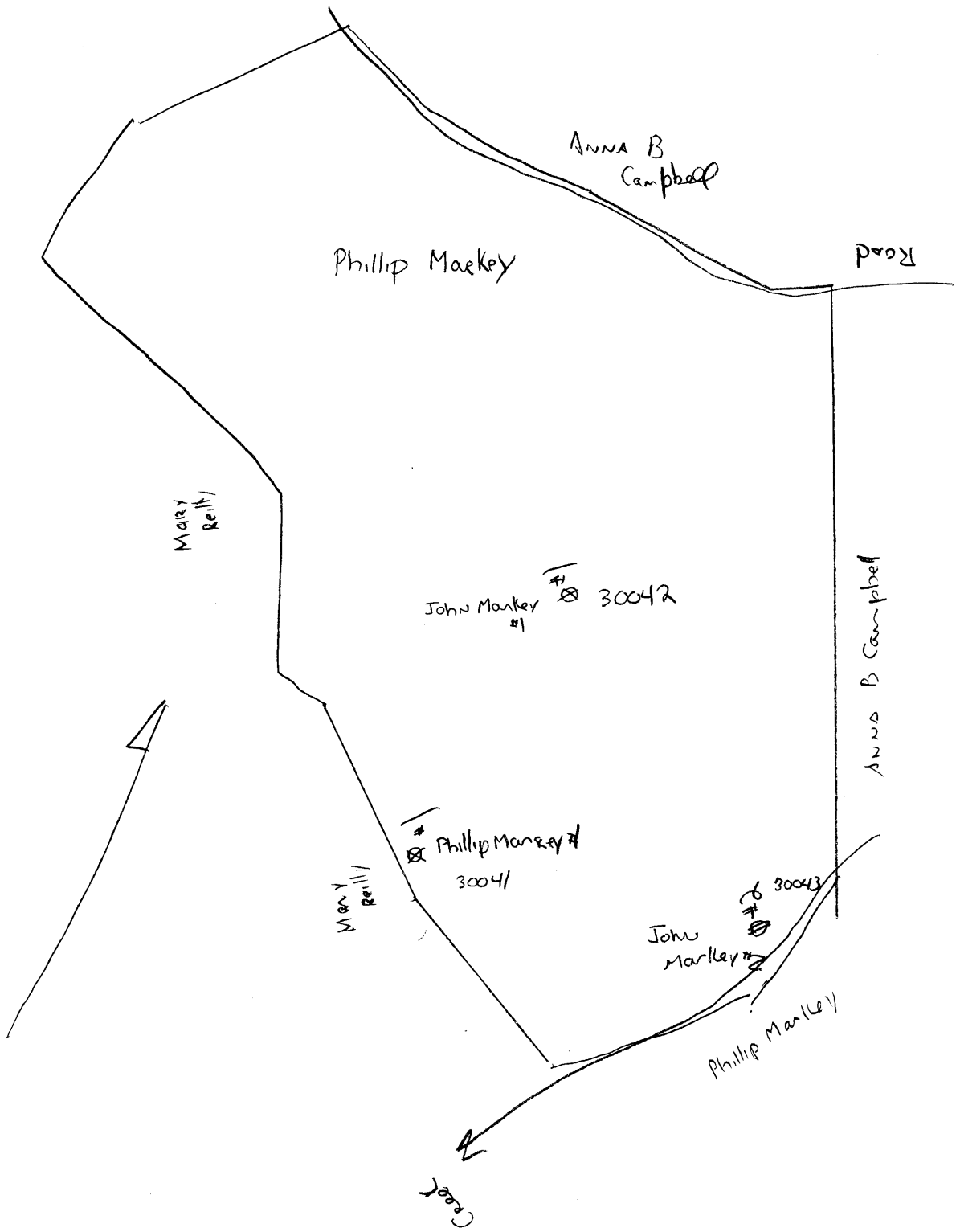

30041 30042

30043

PHILIP MARKEY NO. 1 WELL.

No. 115 O.F.-Marshall

YLA

Union District, Marshall County, W. Va.

The Producers Supply & Tool Co., Marietta, Ohio. (J.E.Schneider).

On 15 acres, surface owned by Philip P. Markey, RD.1, McMechen,  
W. Va., and mineral rights by The Producers Supply & Tool Co.,  
Marietta, Ohio.

Elevation, 1100'.

6-5/8" casing, 1111'; 5-3/16", 1575'.

Abandonment reported to Dept. of Mines Nov. 6, 1934.

	Top.	Bottom.
Dunkard Sand	1086	
Big Injun Sand	1575	1705
Pocket (2 1/2'), to bottom	1705	1707 1/2