

**Latitude**

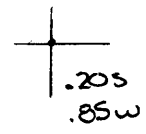

**Longitude**

**Topo Location**

7.5' Loc. \_\_\_\_\_ 15' Loc. \_\_\_\_\_  
 \_\_\_\_\_ (calc.) \_\_\_\_\_

Company Manufact L&H  
 Farm DW McConaughy #1812  
 15' Quad \_\_\_\_\_  
 (sec.)  
 7.5' Quad Cameron  
 District Cameron

**WELL LOCATION PLAT**

County 051 Permit 30033

Cameron dist

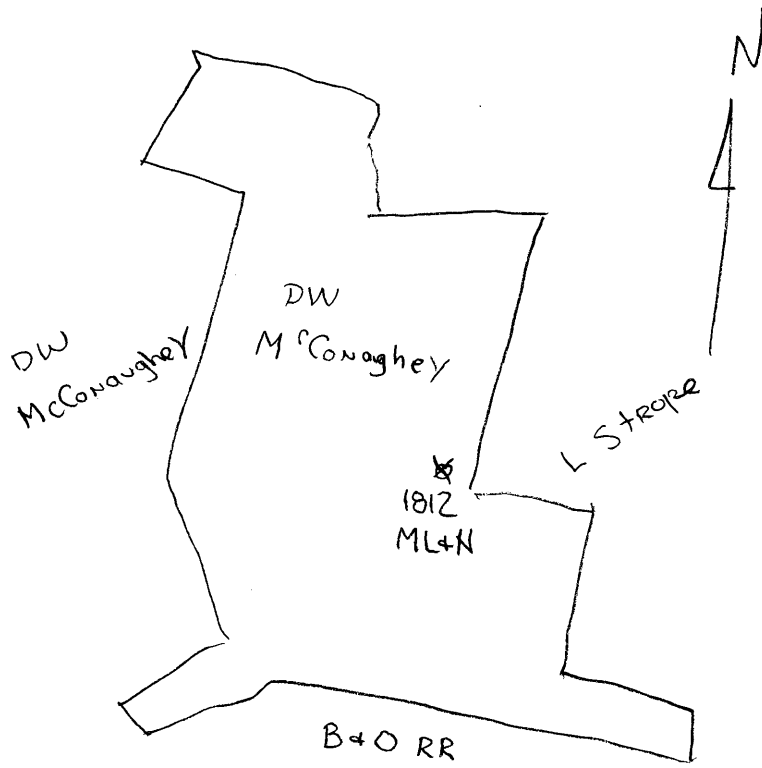

Cameron District, Marshall County, W. Va.  
 Manufacturers Light & Heat Co., 800 Union Tr. Bldg., Pittsburgh, Pa.  
 On 100 acres, surface owned by D. W. McDonoughy, Cameron, W. Va.,  
 and mineral rights by ML&H Co., Pittsburgh, Pa.

Drilled prior to June 1, 1929.

Elevation, 1105' B.

10" casing, 222'; 8 1/2", 1119'; 6-5/8", 1874'.

Coal was encountered at 415-420, 595-600, 695-704'.

Abandonment reported to Dept. of Mines April 18, 1934.

Well was shot in Gordon Stray and 50-Ft. Sands.

(Little gas at 375')?

	Top.	Bottom.
Waynesburg Coal (hole full water)	415	- 420
Mapletown Coal (hole full water)	595	- 600
Pittsburgh Coal (little gas)	695	- 704
Murphy Sand	770	- 800
Big Darkard Sand	1160	- 1210
Gas Sand	1325	- 1390
Sand	1440	- 1490
Sand	1500	- 1565
Sand	1670	- 1730
Maxton Sand	1755	- 1810
Big Lime	1810	- 1835
Big Injun Sand	1835	- 2095
30-Ft. Sand	2455	- 2480
50-Ft. Sand (little gas at 2658')	2658	- 2674
Gordon Stray Sand	2728	- 2753
Gordon Sand (little gas at 2755')	2755	- 2770
Sand shells	2868	- 2875
Total depth		2965

MAAS-33-A