

Latitude

Longitude

2.125
.87w

Topo Location

7.5' Loc. _____ 15' Loc. _____
 _____ (calc.) _____

Company Manufact Lt + HT
 Farm John Thied #1097
 15' Quad _____
 (sec.)
 7.5' Quad Cameron
 District Liberty

WELL LOCATION PLAT

County 051 Permit 30031

Liberty dist

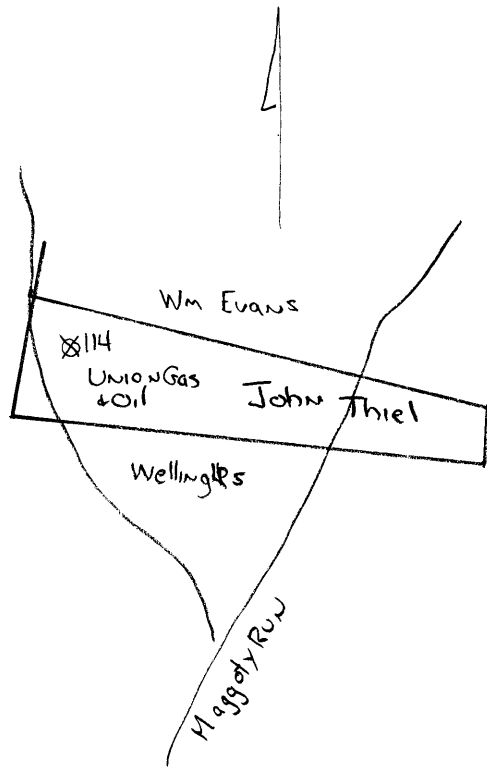

Liberty District, Marshall County, W. Va.
 Union Gasoline & Oil Corp., and The Manufacturers Light & Heat Co.,
 800 Union Trust Bldg., Pittsburgh, Pa.
 On 3/4 acres, surface owned by Balser Thiel, 107 South Third St.,
 Martins Ferry, Ohio, and mineral rights by Union Gasoline & Oil
 Corp., Pittsburgh, Pa.

Drilled prior to June 1, 1929.

Elevation, 1197'.

10" casing, 1346'; 6-5/8", 2076'; 5-3/16", 2912'.

Coal was encountered at 819-825 and 915-922'.

Abandonment reported to Dept. of Mines March 1, 1934.

Oil well. (Gas well at first?)

7725-31-A

	Top.	Bottom.
Conductor	0	15
Bluff Sand	550	630
Mapletown Coal	819	825
Pittsburgh Coal	915	924
Big Dunkard Sand	1415	1475
Gas Sand	1550	1625
Salt Sand (gas, 1840')	1785	
Naxton Sand	1935	1995
Did not find the Big Line sand.		
Big Injun Sand (gas, 2023') (pay, 2029')	2023	
Big Injun Sand (hard at 2047')		
Total depth		2049
COMMENCED DRILLING DEEPER AT		
Big Injun Sand	2049	
50-Ft. Sand	2876	2890
Gordon Stray Sand (gas, 2923'; oil, 2927-? 2963')	2919	
4th Sand	2996	
5th Sand	3060	
Total depth		3082