

Latitude

1.245
.49w

Longitude

Topo Location

7.5' Loc. \_\_\_\_\_ 15' Loc. \_\_\_\_\_  
 \_\_\_\_\_ (calc.) \_\_\_\_\_

Company Manufact G+HT

Farm TC Pipes # 224

15' Quad \_\_\_\_\_  
(sec.)

7.5' Quad Cameron

District Liberty

WELL LOCATION PLAT

County 051 Permit 30018

Liberty

NO  
Affidavit

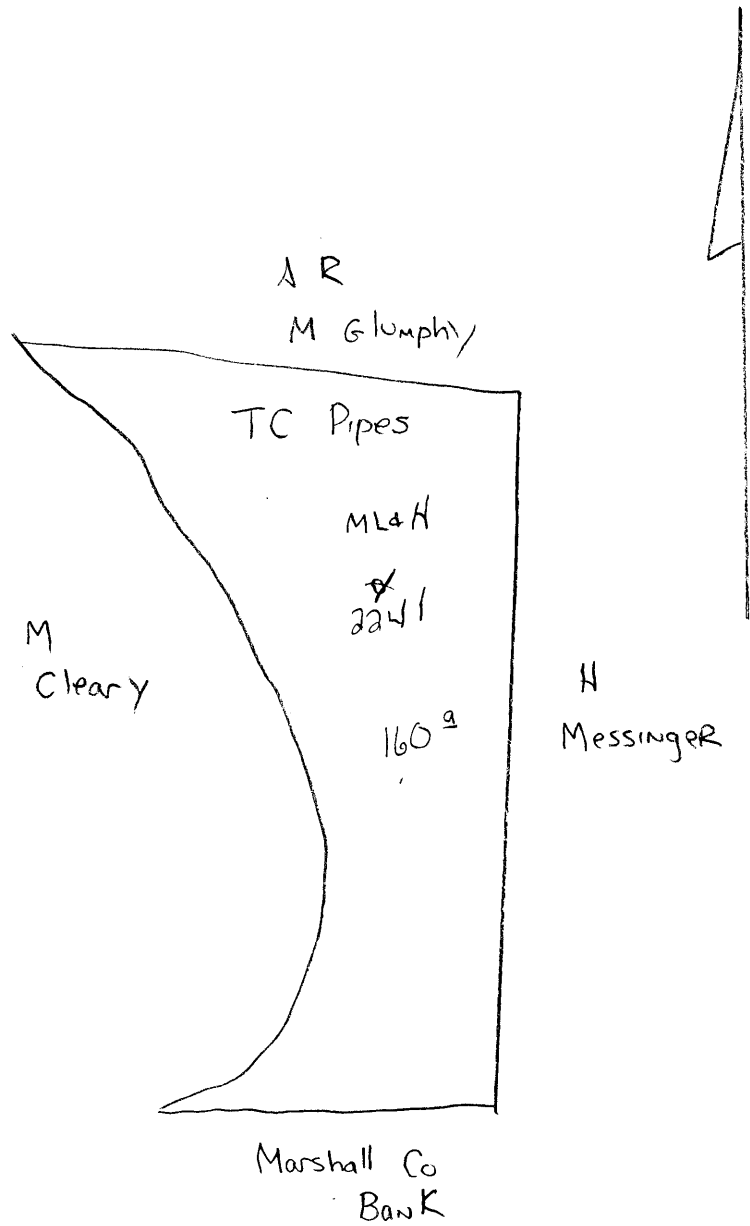

Marsh 18A

Liberty District, Marshall County, W. Va.  
 Manufacturers Light & Heat Co., 800 Union Tr. Bldg., Pittsburgh, Pa.  
 On 160 acres, surface owned by T. C. Pipes, Cameron, W. Va., and  
 mineral rights by ML&H Co., Pittsburgh, Pa.

Drilled prior to June 1, 1929.

Elevation, 1235'.

1 1/2" conductor; 10" casing, 291'; 8 1/2", 1373'; 6-5/8", 2127';  
 2" tubing, 3004'.

Coal was encountered at 863-869, and 970-980'.

Abandonment reported to Dept. of Mines Oct. 16, 1931.

	Top.	Bottom.
Mapletown Coal	863	- 869
Pittsburgh Coal	970	- 980
Murphy Sand	1142	- 1162
Little Dunkard Sand	1372	- 1400
Big Dunkard Sand	1487	- 1509
Sand	1520	- 1580
Salt Sand	1685	- 1705
2nd streak Salt Sand	1755	- 1765
Sand	1935	- 2025
Slate, black	2025	- 2040
Maxton Sand	2040	- 2078
Slate, black	2078	- 2084
Little Lime	2084	- 2088
Pencil Cave	2088	- 2105
Big Lime	2105	- 2165
Big Injan Sand	2165	- 2409
Slate, black	2409	- 2530
Sand, white	2530	- 2560
Slate, white	2560	- 2760
30-Ft. Sand	2760	- 2795
Slate, white	2795	- 2860
Slate, red	2860	- 2895
Sand, white	2895	- 2915
Slate	2915	- 2947
50-Ft. Sand (gas at 2968-2970')	2968	- 3006
Slate	3006	- 3020
Red sand	3020	- 3025
Stray Sand	3025	- 3030
Gordon Sand	3030	- 3055
Slate, white	3055	- 3094
4th Sand (oil, 3096-3110')	3094	- 3110
(second pay, 3101' ?)		
Slate, to bottom	3110	- 3143

MARS-18-A