

Latitude

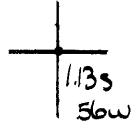

Longitude

Topo Location

7.5' Loc. \_\_\_\_\_ 15' Loc. \_\_\_\_\_  
 \_\_\_\_\_ (calc.) \_\_\_\_\_

Company Manufact Stalt

Farm Wm H Downey (#3041)

15' Quad \_\_\_\_\_  
(sec.)

7.5' Quad Littleton

District Liberty

WELL LOCATION PLAT

County 051 Permit 3007

Liberty

Plugging Affidavit  
1/8/32

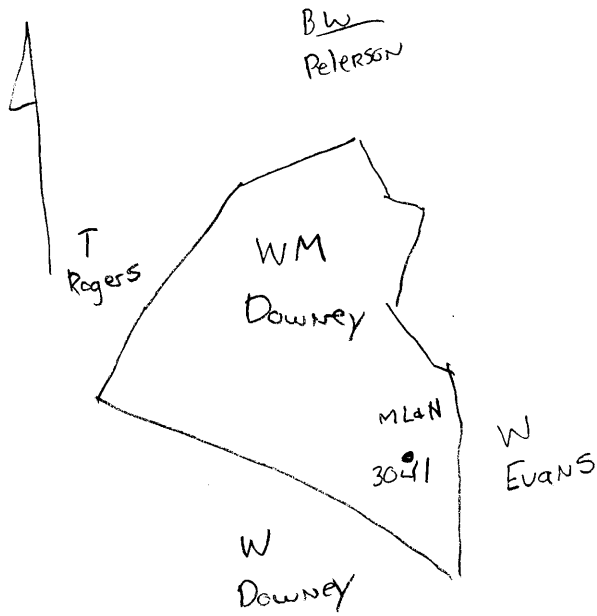

Marsh 17A

Liberty District, Marshall County, W. Va.  
 Manufacturers Light & Heat Co., 800 Union Tr. Bldg., Pittsburgh, Pa.  
 On 50 acres, surface owned by Wm. H. Downey, Board Tree, W. Va., and  
 mineral rights by M&H Co., Pittsburgh, Pa.

Drilled prior to June 1, 1929.

No elevation given.

1 1/2" conductor; 10" casing, 245'; 8 1/2", 1495'; 6-5/8", 2255'.

Coal was encountered at 984-988, and 1085-1092'.

Abandonment reported to Dept. of Mines Sept. 23, 1931.

MARS-17-A

	Top.	Bottom.
Mapletown Coal	984	- 988
Pittsburgh Coal	1085	- 1092
Little Darkard Sand	1490	- 1500
Big Darkard Sand, broken up		
Gas Sand	1755	- 1780
Salt Sand	1855	- 1865
Marion Sand	None	
Little Line	2225	- 2235
Pencil Gave	2235	- 2245
Big Line	2245	- 2287
Big Injun Sand (gas at 2289')	2287	
Total depth		2295