

**Latitude**

.08s  
183w

**Longitude**

06. E6.08

**Topo Location**

7.5' Loc. \_\_\_\_\_ 15' Loc. \_\_\_\_\_  
(calc.) \_\_\_\_\_

**Company** Nat Gas Co of WV

**Farm** Elmina A McConnell #632

**15' Quad** \_\_\_\_\_  
(sec.)

**7.5' Quad** Moundsville

**District** Union

**WELL LOCATION PLAT**

**County** 051 **Permit** 30015

Union Dist.

Plugging Affidavit  
June 26, 1931

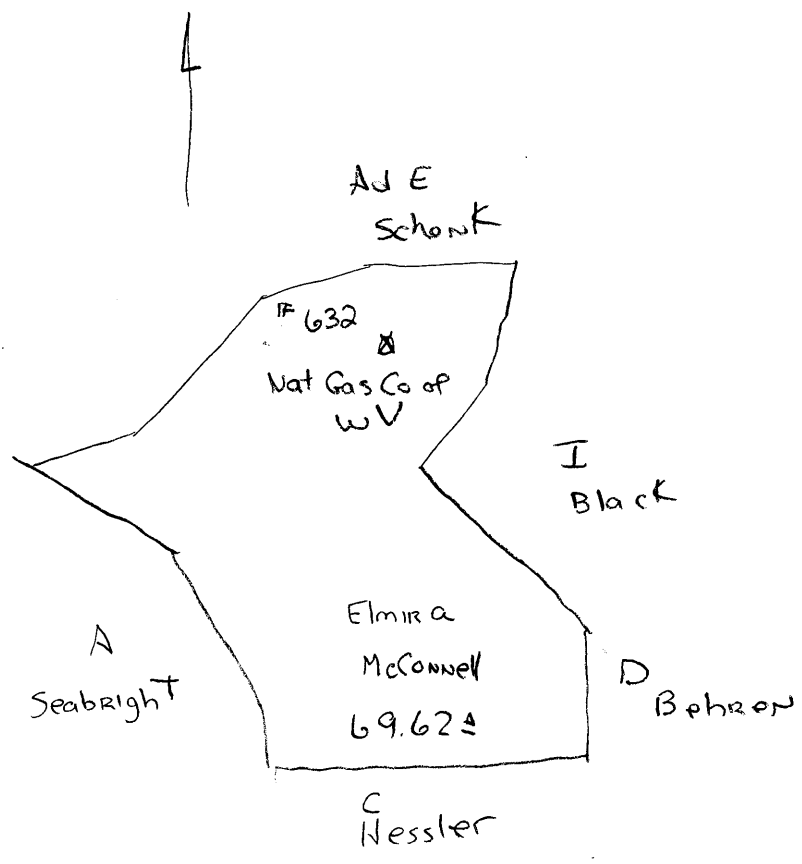

Marsh 15A

Union District, Marshall County, W. Va.  
 Natural Gas Co. of W. Va., 800 Union Tr. Bldg., Pittsburgh, Pa.  
 On 115 acres, surface owned by Elmira A. McConnell, (address not given), and mineral rights by Nat. Gas Co. of W. Va., Pgh., Pa.  
 Drilled prior to July 1, 1929.  
 Elevation, 1255'.  
 1 1/2" conductor, 16"; 10" casing, 202' 10"; 8 1/2", 999'; 6-5/8", 1600'.  
 Coal was encountered at 625-630 and 719-724'.  
 Abandonment reported to Dept. of Mines June 26, 1931.  
 Well was not shot.  
 Salt water in Salt Sand.  
 Gas well, but now abandoned.

MAR 15 - A

	Top.	Bottom.
Mapletown Coal, black, soft	625	- 630
Pittsburgh Coal, black, soft	719	- 724
Dunkard Sand, light, hard	1009	- 1015
Slate and shells, dark, soft	1015	- 1090
Lime, light, hard	1090	- 1135
Slate and shells, dark, soft	1135	- 1230
Gas Sand, light, hard	1230	- 1290
Slate, dark, soft	1290	- 1285
Sand, light, hard	1285	- 1300
Slate, dark, soft	1300	- 1350
Sand, light, hard	1350	- 1370
Slate, dark, soft	1370	- 1425
Sand, light, hard	1425	- 1450
Salt Sand, light, hard (gas)	1450	- 1590
Slate, dark, soft, to bottom	1590	- 1602

Union District, Marshall County, W. Va.

Natural Gas Co. of W. Va.

On 115 acres, surface owned by Elmira A. McConnell, address not given.

Elevation, 1255'.

1 1/2" conductor, 16"; 10" casing, 202' 10"; 8 1/2", 999'; 6-5/8", 1600'.

Abandonment reported to Dept. of Mines, June 26, 1931.

Well was not shot.

Salt water in Salt Sand.

	Top.	Bottom.
Wepietown (Sewickley) Coal, black, soft	625	630
Pittsburgh Coal, black, soft	719	724
Dunkard Sand, light, hard	1009	1015
Slate and shells, dark, soft	1015	1090
Lime, light, hard	1090	1135
Slate and shells, dark, soft	1135	1230
Gas Sand, light, hard	1230	1250
Slate, dark, soft	1250	1285
Sand, light, hard	1285	1300
Slate, dark, soft	1300	1350
Sand, light, hard	1350	1370
Slate, dark, soft	1370	1425
Sand, light, hard	1425	1450
Salt Sand, light, hard (gas)	1450	1590
Slate, dark, soft, to bottom	1590	1602