

LATITUDE 39° 57' 30" TH: 8,870'

LATITUDE 39° 57' 30" BH: 7,320'

LONGITUDE 80° 32' 30" BH: 14,440'

LONGITUDE 80° 32' 30" TH: 11,265'

MAJBAHSM
CNX Gas Company LLC

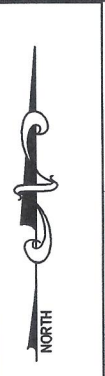

NOTES ON SURVEY

- COORDINATES SYSTEM IS UTM, NAD 83 DATUM, ZONE 17, U.S. FOOT AND WELL COORDINATES ESTABLISHED USING SURVEY GRADE GPS.
- SURFACE AND ROYALTY OWNER INFORMATION AND THEIR BOUNDARIES SHOWN HEREON WERE OBTAINED FROM INFORMATION PROVIDED BY CNX GAS COMPANY LLC AND TAX RECORDS.
- THIS PLAT DOES NOT REPRESENT A BOUNDARY SURVEY OF THE PARCELS SHOWN HEREON.
- NO DWELLINGS AND BUILDINGS WITHIN 625 FEET OF PROPOSED OF CENTER OF PAD.
- NO WATER WELLS OR DEVELOPED SPRINGS WITHIN 250 FEET OF PROPOSED WELL.
- NO PERENNIAL STREAMS, LAKES, PONDS, RESERVOIRS OR WETLANDS WITHIN 100 FEET OF THE LIMITS OF DISTURBANCE.
- NO NATURALLY PRODUCING TROUT STREAM WITHIN 300 FEET OF LIMITS OF DISTURBANCE.

LEGEND

- Active Well
- Plugged Well Location
- Future Use
- Surface Tract Identification
- Proposed Gas Well
- Located Corner, as noted
- Surface Tract Lines
- Reference Line
- Lease Boundary
- Creek or Drain
- WV County Route
- WV State Route

See Page 2 For Surface Owners and Lessors

() Denotes Location of Well on United States Topographic Maps



I, the undersigned, hereby certify that this plat is correct to the best of my knowledge and belief and shows all the information required by law and the regulations issued and prescribed by the Department of Environmental Protection.

L. L. Rowe
L. L. S. 2394

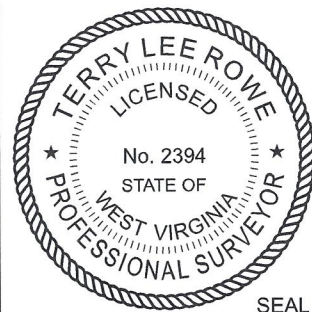

FILE NO: _____
 DRAWING NO: _____
 SCALE: 1" = 2000'
 MINIMUM DEGREE OF ACCURACY: 1:2500
 PROVEN SOURCE OF ELEVATION: NGS CORS Station



DATE: NOVEMBER 11 20 23
 OPERATORS WELL NO: _____
 API WELL NO: _____
 STATE COUNTY PERMIT

WELL TYPE: OIL GAS LIQUID INJECTION WASTE DISPOSAL
 (IF GAS) PRODUCTION: STORAGE DEEP SHALLOW

LOCATION ELEVATION: 1190.5' WATERSHED: Upper Wheeling Creek
 DISTRICT: Webster COUNTY: Marshall

SURFACE OWNER: John S. Kutis and Sylvia M. Kutis, Trustees of the John and Sylvia Kutis 2020 Irrevocable Trust dated March 12, 2020 ACREAGE: 53.20 ±
 ROYALTY OWNER: John and Sylvia Kutis 2020 Irrevocable Trust, dated 03/12/2020 LEASE NO: 192678000 ACREAGE: 53.20 ±

PROPOSED WORK: DRILL CONVERT DRILL DEEPER FRACTURE OR STIMULATE PLUG OFF OLD FORMATION
 PERFORATE NEW FORMATION OTHER PHYSICAL CHANGE IN WELL (SPECIFY)
 PLUG AND ABANDON CLEAN OUT AND REPLUG TARGET FORMATION: Marcellus ESTIMATED DEPTH: TVD: 6,660'

WELL OPERATOR: CNX Gas Company LLC DESIGNATED AGENT: Anthony Kendziora
 ADDRESS: 1000 Horizon Vue Drive ADDRESS: 111 Avondale Road
 Canonsburg, PA 15317 Fairmont, WV 26554

RECEIVED 17
Office Of Oil and Gas
FEB 01 2024
QUADRANT of Gas
Environmental Protection

TRACT ID	SURFACE OWNER	LESSOR	PIN
3B	John S. & Sylvia M. Kutis Irrevocable Trust	John S. Kutis and Sylvia M. Kutis, a/k/a Sylvia M. Kutis, h/w	15-10-1
		Chevron U.S.A., Inc.	
		Chevron U.S.A., Inc.	
		Chesapeake Appalachia, L.L.C.	
		Statoil USA Onshore Properties Inc.	
		SWN Exchange Titleholder, LLC	
		Statoil USA Onshore Properties Inc.	
		SWN Production Company, LLC	
		Equinor USA Onshore Properties Inc.	
TRACT ID	SURFACE OWNER	LESSOR	PIN
1A	Russel W. Strobe, et al	Russell W. Strobe Craig D. Strobe Donna J. Strobe	15-6-19
		Great Lakes Energy Partners, L.L.C.	
		Range Resources -Appalachia, LLC	
		Chesapeake Appalachia, L.L.C.	
		Chesapeake Appalachia, L.L.C.	
		Statoil USA Onshore Properties Inc.	
		SWN Exchange Titleholder, LLC	
		Statoil USA Onshore Properties Inc.	
		SWN Production Company, LLC	
		Equinor USA Onshore Properties Inc.	
TRACT ID	SURFACE OWNER	LESSOR	PIN
1C	Russel W. Strobe, et al	Russell W. Strobe Craig D. Strobe Donna J. Strobe	15-9-15
		Great Lakes Energy Partners, L.L.C.	
		Range Resources -Appalachia, LLC	
		Chesapeake Appalachia, L.L.C.	
		Chesapeake Appalachia, L.L.C.	
		Statoil USA Onshore Properties Inc.	
		SWN Exchange Titleholder, LLC	
		Statoil USA Onshore Properties Inc.	
		SWN Production Company, LLC	
		Equinor USA Onshore Properties Inc.	
TRACT ID	SURFACE OWNER	LESSOR	PIN
17D	Robert Phillip Miner and Karen Marie Clegg	Bounty Minerals, LLC	15-6-42
TRACT ID	SURFACE OWNER	LESSOR	PIN
17F	Robert Phillip Miner and Karen Marie Clegg	Bounty Minerals, LLC	15-10-3
TRACT ID	SURFACE OWNER	LESSOR	PIN
17H	Robert Phillip Miner and Karen Marie Clegg	Bounty Minerals, LLC	15-10-4

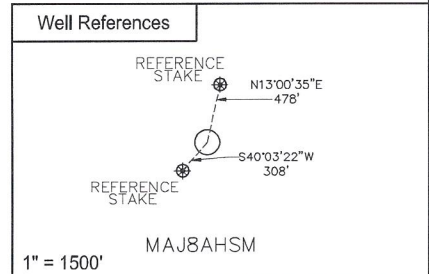
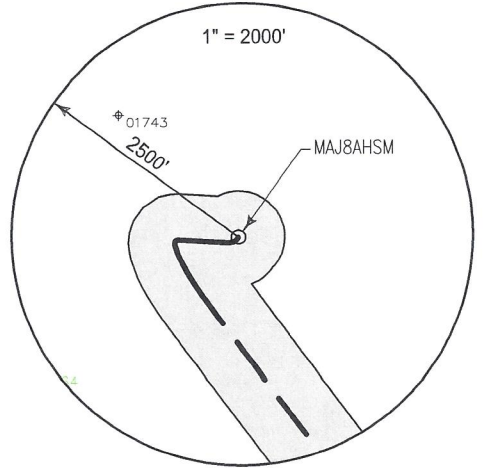

SURFACE HOLE LOCATION (SHL)	
UTM 17 NAD 83	
N: 4419761.19	E: 536400.08
NAD 83, WV NORTH	
N: 521625.669	E: 1667300.458
LAT/LON DATUM NAD 83	
LAT: 39°55'37.828"	LON: 80°34'26.476"
LANDING POINT	
UTM 17 NAD 83	
N: 4419550.96	E: 536297.15
NAD 83, WV NORTH	
N: 520941.472	E: 1666951.153
LAT/LON DATUM NAD 83	
LAT: 39°55'31.025"	LON: 80°34'30.855"

MAJ8 WELL PAD	
UTM 17 NAD 83	
N: 4418797.89	E: 536879.70
NAD 83, WV NORTH	
N: 518438.288	E: 1668821.417
LAT/LON DATUM NAD 83	
LAT: 39°55'06.509"	LON: 80°34'06.467"



I, the undersigned, hereby certify that this plat is correct to the best of my knowledge and belief and shows all the information required by law and the regulations issued and prescribed by the Department of Environmental Protection.

L. L. S. 2394
L. L. S. 2394

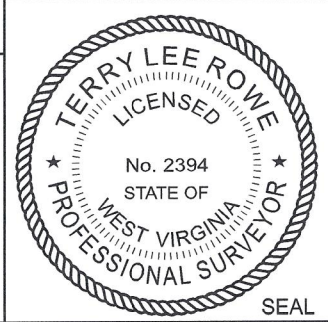

FILE NO: _____
DRAWING NO: _____
SCALE: 1" = 1000'
MINIMUM DEGREE OF ACCURACY: 1:2500
PROVEN SOURCE OF ELEVATION: NGS CORS Station



DATE: NOVEMBER 11 20 23
OPERATORS WELL NO: _____
API WELL NO: 47 - 051 - 02512
STATE COUNTY PERMIT

WELL TYPE: OIL GAS LIQUID INJECTION WASTE DISPOSAL
(IF GAS) PRODUCTION: STORAGE DEEP SHALLOW
LOCATION ELEVATION: 1190.5' WATERSHED: Upper Wheeling Creek QUADRANGLE: Majorsville
DISTRICT: Webster COUNTY: Marshall
SURFACE OWNER: John S. Kutis and Sylvia M. Kutis, Trustees of the John and Sylvia Kutis 2020 Irrevocable Trust dated March 12, 2020 ACREAGE: 53.20 ±
ROYALTY OWNER: John and Sylvia Kutis 2020 Irrevocable Trust, dated 03/12/2020 LEASE NO: 192678000 ACREAGE: 53.20 ±
PROPOSED WORK: DRILL CONVERT DRILL DEEPER FRACTURE OR STIMULATE PLUG OFF OLD FORMATION
 PERFORATE NEW FORMATION OTHER PHYSICAL CHANGE IN WELL (SPECIFY) _____
 PLUG AND ABANDON CLEAN OUT AND REPLUG TARGET FORMATION: Marcellus ESTIMATED DEPTH: TVD: 6,660'

WELL OPERATOR: CNX Gas Company LLC DESIGNATED AGENT: Anthony Kendziora
ADDRESS: 1000 Horizon Vue Drive ADDRESS: 111 Avondale Road
Canonsburg, PA 15317 Fairmont, WV 26554