

JACKSON SURVEYING
 INC.
 2413 EAST PIKE ST. # 112
 Clarksburg, WV 26302
 304-623-5851

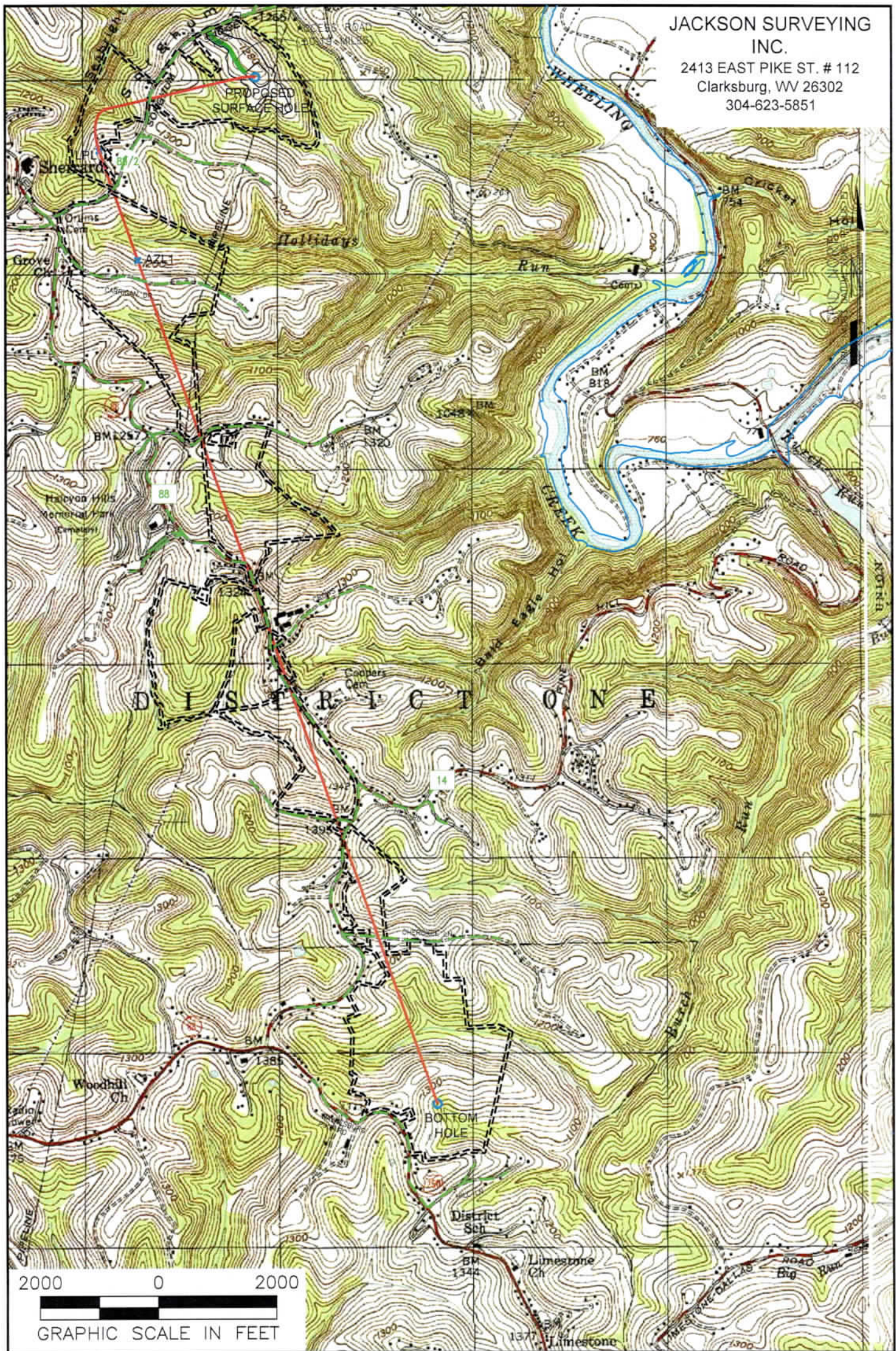

NOTES ON SURVEY

1. SURFACE AND ROYALTY OWNER INFORMATION AND THEIR BOUNDARIES SHOWN HEREON WERE PLOTTED FROM DEEDS AND/OR TAX PARCEL MAPS PROVIDED BY CLIENT AND/OR FIELD LOCATIONS.
2. THIS PLAT DOES NOT REPRESENT A BOUNDARY SURVEY OF THE PARCELS SHOWN HEREON.
4. ALL INSETS ARE GRID NORTH UNLESS OTHERWISE DEPICTED.

LEGEND:

- PROPOSED SURFACE HOLE / BOTTOM HOLE
- ⊗ EXISTING / PRODUCING WELLHEAD
- LPL ✖ LANDING POINT LOCATION
- FLOOD PLAIN
- PUBLIC ROAD
- ACCESS ROAD TO PREV. SITE
- LEASE BOUNDARY
- PROPOSED PATH

08/18/2023

WELL OPERATOR: SWN PRODUCTION COMPANY, LLC	WELL (FARM) NAME: DAVID REINBEAU MSH	WELL # 606H
ADDRESS: 1300 FORT PIERPONT ROAD, SUITE 200 MORGANTOWN, WV 26508	COUNTY - CODE MARSHALL - 051	DISTRICT; UNION
SURFACE OWNER: SHELLY A. & DAVID W. REINBEAU	USGS 7 1/2 QUADRANGLE MAP NAME MOUNDSVILLE, WV	

Latitude: 40°00'00"

SURFACE HOLE 10,242'

Latitude: 39°57'30"

BOTTOM HOLE 7,270'

JACKSON SURVEYING INC.

2413 EAST PIKE ST. # 112
Clarksburg, WV 26302
304-623-5851

SURFACE HOLE LOCATION (SHL):
UTM (NAD83, ZONE 17, METERS): NORTHING: 4,427,007.356 EASTING: 528,892.356
LANDING POINT LOCATION (LPL):
UTM (NAD83, ZONE 17, METERS): NORTHING: 4,426,628.705 EASTING: 528,086.018
AZIMUTH POINT LOCATION (AZL1):
UTM (NAD83, ZONE 17, METERS): NORTHING: 4,426,066.049 EASTING: 528,285.181
BOTTOM HOLE LOCATION (BHL):
UTM (NAD83, ZONE 17, METERS): NORTHING: 4,421,726.136 EASTING: 529,820.230



LINE	BEARING	DISTANCE	DESCRIPTION	MONUMENT
L1	N 17°11'55" W	1,063.87'	SHL TO LANDMARK	FD. FENCE CORNER
L2	N 57°49'21" W	1,267.43'	SHL TO LANDMARK	FD. FENCE CORNER
L4	S19°29'33" E	1,958.21'	LPL TO AZL1	
LINE	BEARING	DISTANCE	CURVE LENGTH	DESCRIPTION
L3	S 64°50'44" W	2922.63'	3,381.47'	SHL TO LP

SURFACE HOLE 4,801'
 BOTTOM HOLE 2,641'
 Longitude: 80°37'30"
 Longitude: 80°37'30"

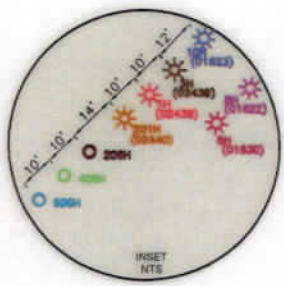
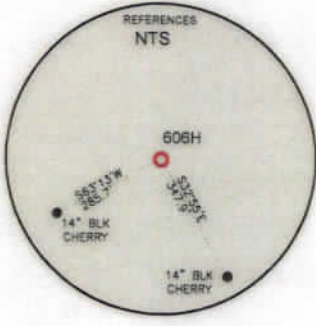
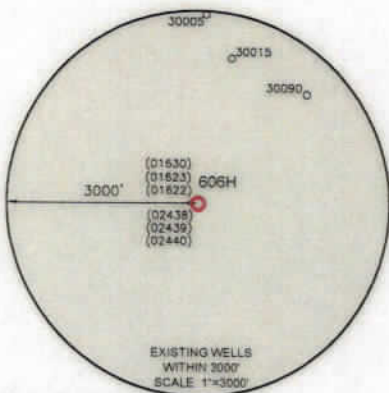

WELL RESTRICTIONS

- NO OCCUPIED DWELLINGS > 2500 SQ FT. WITHIN 625 FEET OF CENTER OF PAD.
- NO AGRICULTURE BUILDINGS > 2500 SQ FT. WITHIN 625 FEET OF CENTER OF PAD.
- NO WATER WELLS OR DEVELOPED SPRINGS ARE WITHIN 250 FEET OF PROPOSED WELL.
- NO PERENNIAL STREAMS, LAKES, PONDS, OR RESERVOIRS WITHIN 100 FEET OF THE LIMITS OF DISTURBANCE.
- NO NATURALLY PRODUCING TROUT STREAM WITHIN 300 FEET OF LIMITS OF DISTURBANCE.
- NO GROUND INTAKE OR PUBLIC WATER SUPPLY WITHIN 1000 FEET OF WELL PAD, LIMITS OF DISTURBANCE, E & S CONTROLS OR PUBLIC WATER SUPPLY.

NOTES ON SURVEY

- SURFACE AND ROYALTY OWNER INFORMATION AND THEIR BOUNDARIES SHOWN HEREON WERE PLOTTED FROM DEEDS AND/OR TAX PARCEL MAPS PROVIDED BY CLIENT AND/OR FIELD LOCATIONS.
- THIS PLAT DOES NOT REPRESENT A BOUNDARY SURVEY OF THE PARCELS SHOWN HEREON.
- ALL INSETS ARE GRID NORTH UNLESS OTHERWISE DEPICTED.

I, THE UNDERSIGNED, HEREBY CERTIFY THAT THIS PLAT IS CORRECT TO THE BEST OF MY KNOWLEDGE AND BELIEF AND SHOWS ALL THE INFORMATION REQUIRED BY LAW AND REGULATIONS ISSUED AND PRESCRIBED BY THE DEPARTMENT OF ENVIRONMENTAL PROTECTION.

P.S. 708

David L Jackson



COMPANY: **SWN** Production Company, LLC

(+) DENOTES LOCATION OF WELL ON UNITED STATES TOPOGRAPHIC MAPS WVDEP OFFICE OF OIL & GAS 601 57TH STREET CHARLESTON, WV 25034	MINIMUM DEGREE OF ACCURACY: 1/200 PROVEN SOURCE OF ELEVATION: SURVEY GRADE GPS (NAVD 88, US FT)	COMPANY: SWN Production Company, LLC OPERATOR'S WELL #: 606H API WELL #: 47 STATE 051 COUNTY 02502 PERMIT
	DAVID REINBEAU MSH	ESTIMATED DEPTH: 6,485 TO 24,567 TMD

WELL TYPE: OIL WASTE DISPOSAL PRODUCTION DEEP GAS LIQUID INJECTION STORAGE SHALLOW

WATERSHED: HOLLIDAYS RUN OF WHEELING CREEK (HUC-10) ELEVATION: 1,250.9'

DISTRICT: UNION COUNTY: MARSHALL QUADRANGLE: MOUNDSVILLE, WV

SURFACE OWNER: SHELLY A. & DAVID W. REINBEAU ACREAGE: ±50.88

OIL & GAS ROYALTY OWNER: SHELLY A. & DAVID W. REINBEAU ACREAGE: ±50.88

DRILL DRILL DEEPER REDRILL FRACTURE OR STIMULATE PLUG OFF OLD FORMATION PERFORATE NEW FORMATION

CONVERT PLUG & ABANDON CLEAN OUT & REPLUG OTHER CHANGE (SPECIFY)

TARGET FORMATION: MARCELLUS

08/18/2023

WELL OPERATOR: SWN PRODUCTION COMPANY, LLC DESIGNATED AGENT: BRITTANY WOODY
 ADDRESS: 1300 FORT PIERPONT ROAD, SUITE 200 ADDRESS: 1300 FORT PIERPONT ROAD, SUITE 200
 CITY: MORGANTOWN STATE: WV ZIP CODE: 26508 CITY: MORGANTOWN STATE: WV ZIP CODE: 26508

LEGEND: ○ PROPOSED SURFACE HOLE / BOTTOM HOLE * EXISTING / PRODUCING WELLHEAD LPL * LANDING POINT LOCATION * EXISTING WATER WELL * EXISTING SPRING	SURVEYED BOUNDARY DRILLING UNIT LEASE BOUNDARY PROPOSED PATH	REVISIONS: DATE: 03-13-2023 DRAWN BY: N. MANO SCALE: 1" = 2000' DRAWING NO: WELL LOCATION PLAT
--	---	--

JACKSON SURVEYING
 INC.
 2413 EAST PIKE ST. # 112
 Clarksburg, WV 26302
 304-623-5851

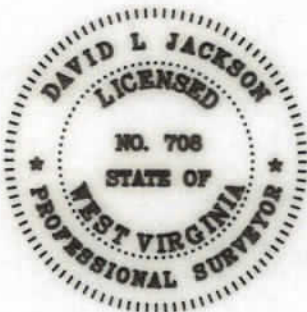
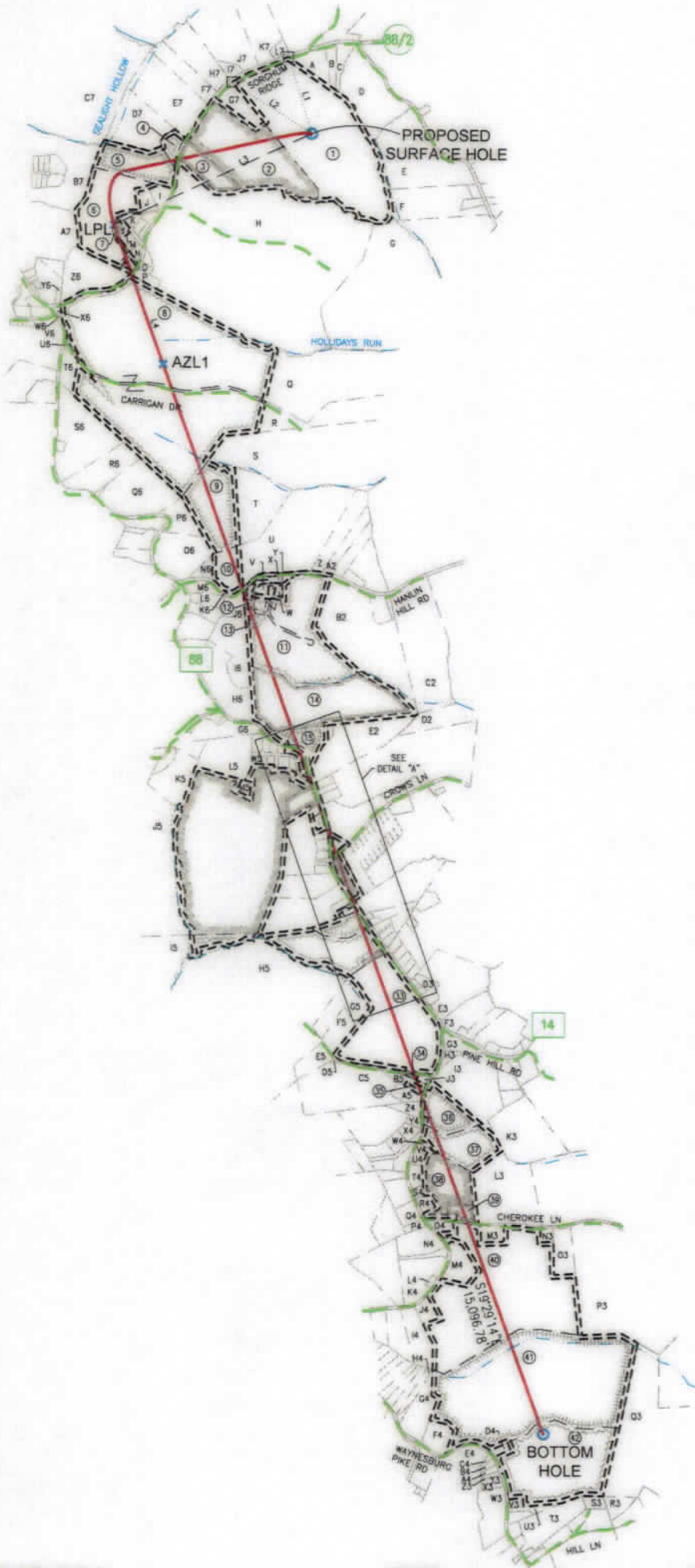

I, THE UNDERSIGNED, HEREBY CERTIFY THAT THIS PLAT IS CORRECT TO THE BEST OF MY KNOWLEDGE AND BELIEF AND SHOWS ALL THE INFORMATION REQUIRED BY LAW AND REGULATIONS ISSUED AND PRESCRIBED BY THE DEPARTMENT OF ENVIRONMENTAL PROTECTION.

P.S. 708

David L Jackson

2000 0 2000

GRAPHIC SCALE IN FEET

08/18/2023

REVISIONS:	COMPANY:	 	
	OPERATOR'S	DAVID REINBEAU MSH	
	WELL #:	47-091-02802 606H	
	DISTRICT:	COUNTY:	STATE:
	UNION	MARSHALL	WV
			DATE: 03-13-2023
			DRAWN BY: N. MANO
			SCALE: N/A
			DRAWING NO:
			WELL LOCATION PLAT 2

**JACKSON SURVEYING
INC.**

2413 EAST PIKE ST. # 112
Clarksburg, WV 26302
304-623-5851

WELL BORE TRACTS		
TRACT	SURFACE OWNER (S) / ROYALTY OWNER (R)	TAX PARCEL
1	REINBEAU SHELLY A & DAVID W (S/R)	13-8-29
SURFACE OWNER (S)		
2	REINBEAU SHELLY A & DAVID W (S)	13-8-27
3	REINBEAU RONALD W & FRIEDA A - LIFE (S)	13-07-22.2
4	SHEPHERD JAMES LEE II (S)	13-07-23
5	MCCLINTOCK JOSIE & LARRY (S)	13-07-22.4
6	PATTERSON DANIEL & MICHELLE (S)	13-07-22
7	SBERNA JOHN L (S)	13-7E-04
8	HIERONIMUS C KEITH ET UX (S)	13-08-15
9	CARTER KELLY J (S)	13-10-19
10	WISE CLARA L (S)	13-10-18
11	MERINAR KENNETH LEE ET UX (S)	13-10-21.6
12	MERINAR KENNETH LEE & LEEANN (S)	13-10B-08
13	SPIELVOGEL HARRY C ET UX (S)	13-10B-10
14	METS PROPERTIES LLC (S)	13-10-22
15	STURGILL JULIE L & JOE D (S)	13-10-24
16	GELNAR GARY (S)	13-13A-04
17	GELNER GARY (S)	13-13A-03
18	HENDERSON SHERYL LYNN (S)	13-13A-02
19	SIBURT ERIC R & CARLA M (S)	13-13A-01
20	SCHABER LESLIE B & LORI D (S)	13-13-10
21	HARVEY JOSHUA STEVEN (S)	13-13-11.1
22	AVILA EDWARD A (S)	13-13-11.4
23	HAIGHT DONNA JEAN (S)	13-13-11.2
24	PENNINGTON KAREN LYNN (S)	13-09-32.5
25	HACKATHORN JUDITH ANN - LIFE (S)	13-09-31.2
26	COOPER TIM L (S)	13-09-31.3
27	TH EXPLORATION LLC (S)	13-13-13.3
28	TH EXPLORATION LLC (S)	13-13-13.1
29	ANDERSON MICHAEL L (S)	13-13-14
30	BROWN ROSEMARY M (S)	13-13-15
31	GODDARD RUSSELL E & MICHELE L (S)	13-13-16
32	GODDARD RUSSELL E & MICHELE L (S)	13-13-17.1
33	LILLEY PAUL THOMAS (S)	13-13-17
34	CUNNINGHAM TOYA A - TOD (S)	13-14-48.1
35	SCOTT RANDALL C ET UX (S)	13-14-48
36	OLDFIELD KAREN KAY (S)	13-14-33
37	GUNTO CARL M ET UX (S)	13-14-34
38	WALTER DANA F & VINCENT LORETTO (S)	13-14-38
39	THOMAS WAYNE L - THOMAS MARILYN (S)	13-14-39
40	KOONTZ CARL JR ET AL (S)	14-05-24
41	FRANCIS LISA JANE (S)	14-05-37
42	TATICH DANIEL EDWARD TRUST (S)	14-05-36

ADJOINING OWNERS TABLE		
TRACT	SURFACE OWNER	TAX PARCEL
A	NARRISH KEVIN	13-08-30
B	SOUTH CHRISTOPHER C	13-08-31
C	KOSTELECKY JOSEPH J JR & CAROLYN - TOD	13-08-31.1
D	FUNK CHARLES D ET UX	13-08-32
E	LOY EUGENE EST ET AL	13-08-01
F	LIBERTY JOHN ET UX	13-08-10
G	MCCOMBS JOHN A SR, THOMAS E & BETH	13-08-11
H	MCCOMBS JOHN A SR, THOMAS E & BETH	13-08-26
I	CAIN ROGER L II	13-7E-10
J	MALARSKI CHAD	13-7E-09
K	SANDRETH ELIZABETH A	13-7E-05
L	SBERNA SANDRA	13-7E-03
M	SBERNA JOSEPH L JR & TAMMY L	13-7E-02
N	SBERNA JOSEPH L JR & TAMMY	13-7E-01
O	PERRY JOSEPH P JR	13-08-24
P	MCLAUGHLIN SHAWN & ELIZABETH	13-08-23
Q	CONNER AMBER D & DAVID HANES JR	13-08-14
R	CONNER AMBER D & DAVID HANES JR	13-08-13
S	CONNER AMBER D & DAVID HANES JR	13-08-12
T	CARTER KELLY J	13-10-20
U	MELNIK BRUCE A ET UX	13-10-21
V	GAST COREY M & JOLIE A	13-10-21.10
W	BOWERS MARY L	13-10B-37
X	SHAW SIDNEY S & ROBIN MARIE	13-10B-02
Y	SHAW SIDNEY S & ROBIN MARIE	13-10B-01
Z	MELNIK BRUCE A ET UX	13-10-21.1
A2	MONTGOMERY TORIE	13-10-21.2
B2	JONES NICHOLAS & EVELINE J	13-10-21.8

*Highlighted Parcels may be impacted during drilling.

DETAIL "A"



08/18/2023



I, THE UNDERSIGNED, HEREBY CERTIFY THAT THIS PLAT IS CORRECT TO THE BEST OF MY KNOWLEDGE AND BELIEF AND SHOWS ALL THE INFORMATION REQUIRED BY LAW AND REGULATIONS ISSUED AND PRESCRIBED BY THE DEPARTMENT OF ENVIRONMENTAL PROTECTION.

P.S. 708

David L Jackson

REVISIONS:	COMPANY:	SWN Production Company, LLC	SWN <i>R-V+</i> Production Company™
	OPERATOR'S	DAVID REINBEAU MSH	
	WELL #:	47-081-02502 606H	
	DISTRICT:	COUNTY:	STATE:
	UNION	MARSHALL	WV
			DATE: 03-13-2023
			DRAWN BY: N. MANO
			SCALE: N/A
			DRAWING NO:
			WELL LOCATION PLAT 3

**JACKSON SURVEYING
INC.**

2413 EAST PIKE ST. # 112
Clarksburg, WV 26302
304-623-5851

ADJOINING OWNERS TABLE		
TRACT	SURFACE OWNER	TAX PARCEL
C2	JONES NICHOLAS & EVELINE J	13-09-08
D2	EDISON MARK C ET UX	13-09-09
E2	METS PROPERTIES LLC	13-10-23
F2	METS PROPERTIES LLC	13-10-24.1
G2	MILLER KENNETH LEE - TOD	13-09-33
H2	CHAMBERS ROBIN L & DENICE E	13-09-33.1
I2	CHAMBERS ROBIN L & DENICE E	13-09-33.2
J2	EAGLE LTD	13-09-32.1
K2	DEMURI HOME & GARDEN LLC	13-09-34
L2	FRYE JACQUELINE L & CHARLES G	13-09-31.1
M2	PARSONS JAY D ET UX	13-14-01
N2	CAMPBELL CODIE JOHNELLE	13-14-02
O2	FREEMAN RAYMOND CHRISTOPHER	13-14-03
P2	TROWBRIDGE ROBEYN & JOSHUA SKIDGEL	13-14-05
Q2	TROWBRIDGE ROBEYN & JOSHUA SKIDGEL	13-14-6.1
R2	CLOVIS JUSTIN	13-14-6.3
S2	KENDZIERSKI ALAN B ET UX	13-14-6.4
T2	GIVENS BRUCE E ET UX	13-14-06
U2	GIVENS BRUCE E ET UX	13-14-7.2
V2	CHAMBERS DOROTHY-LIFE	13-14-07
W2	COTTRELL COLE T	13-14-7.5
X2	DORAN BRIAN W ET UX	13-14-7.4
Y2	LEWEY CHARLES L & MARGARET A	13-14-7.1
Z2	BECKNER DAVID E & DEBORAH K	13-14-7.3
A3	GANTZER MARCIA L & JAMES E	13-14-8.2
B3	GANTZER MARCIA L & JAMES E	13-14-8.1
C3	YOHO RONNIE E	13-14-8.3
D3	YOHO GAIL L & RONNIE E	13-14-8.4
E3	ROVER PIPELINE LLC	13-14-08
F3	ROVER PIPELINE LLC	13-14-09
G3	DRAKE JASON T & DEANNA J	13-14-31.1
H3	LYONS BRENT G ET UX	13-14-31
I3	HENRY GH & JANET FAMILY TRUST	13-14-32
J3	GRAY DARYL J	13-14-49
K3	HENRY GH & JANET FAMILY TRUST	13-14-29
L3	FOSTER CHARLES S & BRENDA	13-14-38.2
M3	EBERT BRADLEY	14-05-24.9
N3	WILSON ROBERT J & REBECCA S	14-05-24.6
O3	FOSTER CAITLIN E	13-14-50
P3	SMITH EDWARD LEE II	14-05-26
Q3	HILL KAY F ET AL	14-05-28
R3	HILL KAY F ET AL	14-05-29
S3	LILLEY ROGER W ET UX	14-05-32.5
T3	YOHO KIM MARLENE	14-05-33
U3	WHIPKEY ROGER ET UX	14-05-35
V3	SIMONS JORDAN M & VICTORIA G BENLINE SIMONS	14-05-36.1
W3	DERROW SAMUEL R ET UX	14-05-39
X3	KELLEY RODNEY & BONNIE	14-05-38.1
Y3	KELLEY RODNEY & BONNIE	14-05-38
Z3	KELLEY RODNEY & BONNIE	14-05-38.2
A4	KELLEY RODNEY & BONNIE	14-05-38.3
B4	WALTER DANA F	14-05-38.4
C4	WALTER DANA F	14-05-38.5
D4	FRANCIS LISA JANE	14-05-36.2
E4	BISHOP PENNY S ET VIR	14-05-39.1
F4	FRANCIS LISA JANE	14-05-37.1
G4	GALLOWAY HARRY L	14-05-11
H4	J & R DEVELOPMENT LLC	14-05-11.3
I4	SMITH MARK ALLEN ET UX	14-05-23
J4	KOONTZ COLE	14-05-24.8
K4	WILLIAMS CARL R & RHONDA L	14-05-24.5
L4	WILLIAMS CARL R & RHONDA L	14-05-24.4
M4	KOONTZ JOHN R	14-05-24.3
N4	WOODS JOHN E SR & FRANCES J	14-05-24.2
O4	KOONTZ CARL E JR	14-05-24.1
P4	SNYDER DAVID L - LIFE	13-14-40
Q4	SNYDER DAVID L - LIFE	13-14-44
R4	HEWITT MARTIN O ET UX	13-14-38.3
S4	SMITH CARROLYN - TOD	13-14-38.4
T4	GUMP CHRISTINA H	13-14-37

ADJOINING OWNERS TABLE		
TRACT	SURFACE OWNER	TAX PARCEL
U4	WEST THOMAS J JR & KATHY ANN	13-14-36
V4	WEST THOMAS J JR & KATHY ANN	13-14-35
W4	WEST THOMAS J JR & KATHY ANN	13-14-34.1
X4	POLANSKI LYNDISAY N	13-14-41.2
Y4	FERDA BRIAN T	13-14-46.2
Z4	BOWIE CHRISTOPHER E	13-14-46.1
A5	CUNNINGHAM CHAD	13-14-47
B5	KOONTZ HELEN - TOD	13-14-48.2
C5	CUNNINGHAM CHAD L & JEFFREY H	13-14-47.1
D5	CUNNINGHAM JEFFREY H & CHAD	13-13-20
E5	CUNNINGHAM JEFFREY H & CHAD	13-13-19
F5	HELLER AMBER R & EDGAR D JR	13-13-18.1
G5	HELLER AMBER R & EDGAR D JR	13-13-18
H5	HELLER EDGAR D JR TRUST	13-13-21
I5	HELLER EDGAR D JR TRUST	13-13-23
J5	HELLER EDGAR D JR TRUST	13-13-09
K5	KOCH JOHN E & BARBARA A - TOD	13-13-9.3
L5	SCHABER LESLIE B & LORI D	13-13-10.1
M5	SCHABER LESLIE B & LORI D	13-13-10.2
N5	NORRIS TABITHA L	13-13-13.2
O5	GROSS COBER R ET UX	13-13-13
P5	SHANNON WILLIAM JAMES	13-13-12
Q5	BURTON ERIC & LEE ANN	13-13-11.7
R5	SCARNECHIA DAVID W	13-13-11.6
S5	SCARNECHIA DAVID W	13-13-11
T5	SCARNECHIA DAVID W	13-13-11.5
U5	HAIGHT DONNA JEAN	13-13-11.8
V5	SHANNON WILLIAM JAMES	13-13-11.3
W5	BACH WILBERT H II ET UX	13-13A-10
X5	BACH WILBERT H II ET UX	13-13A-11
Y5	SCHABER LESLIE B & LORI D	13-13A-12
Z5	SCHABER LESLIE B & LORI D	13-13A-13.1
A6	KNOBLICH RICHARD KARL ET UX	13-13A-13
B6	WARD ROBERT C JR & VICKY LINN	13-13A-15
C6	SCHABER LESLIE B & LORI	13-13-10.3
D6	CARR PHYLLIS J	13-13A-06
E6	HESS GEORGE JR ET UX	13-13A-07
F6	WHIPKEY ROBERT	13-13A-08
G6	MARSH DAVID A ET UX	13-10-28
H6	THORN RONNIE L & BETH A	13-10-30.1
I6	ELLIOTT GLENN F	13-10-30
J6	LOY JEFFREY A & JULIE M	13-10-31
K6	MANUFACTURING LIGHT & HEAT CO	13-10-18.2
L6	RUSH J LARRY & LINDA M	13-10-32.1
M6	RUSH JOSEPH L & LINDA M	13-10-32
N6	MOSA BLAIR P ET UX	13-10-18.1
O6	TARGOSKY ROSEMARY & MCCOY-GOOGEL BARAK	13-10-16
P6	CARTER KELLY J	13-10-15.1
Q6	WALTON DANIEL JR & THERESA	13-08-17
R6	WALTON DANIEL JR & THERESA	13-08-18
S6	MCCOMBS THOMAS E & BETH E - TOD	13-08-19
T6	PRESBYTERIAN CHURCH	13-08-20
U6	ALLEN GROVE PRESBYTERIAN CHURCH	13-08-15.1
V6	KAHLBAUGH DAVID W & DELORES- TOD	13-07-24
W6	HIERONIMUS C KEITH ET UX	13-7A-23
X6	SHARRARD CEMETERY	13-7A-22
Y6	JOHNSON GILBERT	13-7A-03
Z6	MCCOMBS THOMAS E & BETH E - TOD	13-08-16
A7	CMK REALTY LLC	13-7A-09
B7	BOARD OF EDUCATION	13-07-16
C7	BOARD OF EDUCATION	13-07-17
D7	MCCOMBS JOHN A SR & MARILYN S	13-07-22.1
E7	REINBEAU DAVID W & SHELLY A	13-07-22.3
F7	REINBEAU DAVID W & SHELLY A	13-07-21.1
G7	BOWMAN MICHAEL ET UX	13-08-28
H7	BOWMAN MICHAEL J & CONSTANCE G	13-07-21
I7	ALEXANDER LORRAINE	13-07-20
J7	ALEXANDER LORRAINE	13-07-18.1
K7	ALEXANDER LORRAINE	13-07-18
L7	SAMPSON EDITH VIRGINIA EST	13-07-19

*Highlighted Parcels may be impacted during drilling.

08/18/2023

REVISIONS:	COMPANY:	 	
	OPERATOR'S	DAVID REINBEAU MSH	
	WELL #:	47-061-02502 606H	
	DISTRICT:	COUNTY:	STATE:
	UNION	MARSHALL	WV
			DATE: 03-13-2023
			DRAWN BY: N. MANO
			SCALE: N/A
			DRAWING NO:
			WELL LOCATION PLAT 4