

Latitude: 40°00'00"

SURFACE HOLE 10,250'

JACKSON SURVEYING INC.

2413 EAST PIKE ST. # 112
Clarksburg, WV 26302
304-623-5851

Latitude: 39°57'30" BOTTOM HOLE

3,856'

Table with 2 columns: Location Type (SHL, LPL, BHL) and UTM Coordinates (Northings, Eastings).

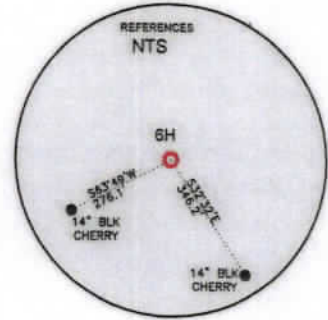
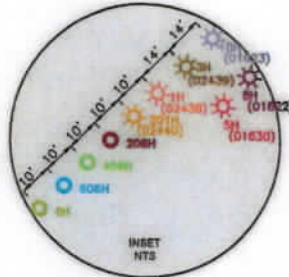
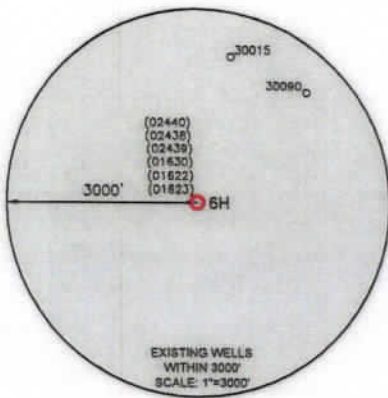

Table with 5 columns: LINE, BEARING, DISTANCE, DESCRIPTION, MONUMENT. Contains data for lines L1 through L5.



Longitude: 80°37'30"
Longitude: 80°37'30" SURFACE HOLE 2,648'

GRID NORTH
UTM, NAD83 DATUM, ZONE 17, US FT



WELL RESTRICTIONS

- 1. NO OCCUPIED DWELLINGS > 2500 SQ FT. WITHIN 625 FEET OF CENTER OF PAD.
2. NO AGRICULTURE BUILDINGS > 2500 SQ FT. WITHIN 625 FEET OF CENTER OF PAD.
3. NO WATER WELLS OR DEVELOPED SPRINGS ARE WITHIN 250 FEET OF PROPOSED WELL.
4. NO PERENNIAL STREAMS, LAKES, PONDS, OR RESERVOIRS WITHIN 100 FEET OF THE LIMITS OF DISTURBANCE.
5. NO NATURALLY PRODUCING TROUT STREAM WITHIN 300 FEET OF LIMITS OF DISTURBANCE.
6. NO GROUND INTAKE OR PUBLIC WATER SUPPLY WITHIN 1000 FEET OF WELL PAD, LIMITS OF DISTURBANCE, E & S CONTROLS OR PUBLIC WATER SUPPLY.

NOTES ON SURVEY

- 1. SURFACE AND ROYALTY OWNER INFORMATION AND THEIR BOUNDARIES SHOWN HEREON WERE PLOTTED FROM DEEDS AND/OR TAX PARCEL MAPS PROVIDED BY CLIENT AND/OR FIELD LOCATIONS.
2. THIS PLAT DOES NOT REPRESENT A BOUNDARY SURVEY OF THE PARCELS SHOWN HEREON.
4. ALL INSETS ARE GRID NORTH UNLESS OTHERWISE DEPICTED.

I, THE UNDERSIGNED, HEREBY CERTIFY THAT THIS PLAT IS CORRECT TO THE BEST OF MY KNOWLEDGE AND BELIEF AND SHOWS ALL THE INFORMATION REQUIRED BY LAW AND REGULATIONS ISSUED AND PRESCRIBED BY THE DEPARTMENT OF ENVIRONMENTAL PROTECTION.

P.S. 708

David L Jackson

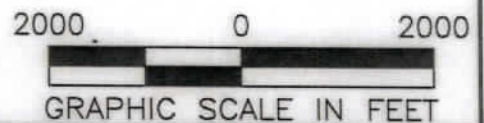

COMPANY: SWN Production Company, LLC SWN Production Company™



(+) DENOTES LOCATION OF WELL ON UNITED STATES TOPOGRAPHIC MAPS
WVDEP
OFFICE OF OIL & GAS
601 57TH STREET
CHARLESTON, WV 25034

MINIMUM DEGREE OF ACCURACY: 1/200
PROVEN SURVEY SOURCE OF GRADE GPS ELEVATION: (NAVD 88, US FT)

DAVID REINBEAU MSH
OPERATOR'S WELL #: 6H
API WELL #: 47 051 02500
STATE COUNTY PERMIT

Form with fields for WELL TYPE (Oil, Gas, etc.), WATERSHED (HOLLIDAYS RUN OF WHEELING CREEK), DISTRICT (UNION), COUNTY (MARSHALL), SURFACE OWNER (SHELLY A. & DAVID W. REINBEAU), OIL & GAS ROYALTY OWNER (SHELLY A. & DAVID W. REINBEAU), DRILL (checked), TARGET FORMATION (MARCELLUS), ESTIMATED DEPTH (6,507 TVD 27,841 TMD).

Form with fields for WELL OPERATOR (SWN PRODUCTION COMPANY, LLC), ADDRESS (1300 FORT PIERPONT ROAD, SUITE 200), CITY (MORGANTOWN), STATE (WV), ZIP CODE (26508), DESIGNATED AGENT (BRITTANY WOODY).

Table with 2 columns: LEGEND (Proposed surface hole, Existing wellhead, LPL, Existing water well, Existing spring, Surveyed boundary, Drilling unit, Lease boundary, Proposed path) and REVISIONS (Date: 04-13-2023, Drawn by: N. MANO, Scale: 1" = 2000', Drawing no., Well location plat).

**JACKSON SURVEYING**

**INC.**

2413 EAST PIKE ST. # 112

Clarksburg, WV 26302

304-623-5851

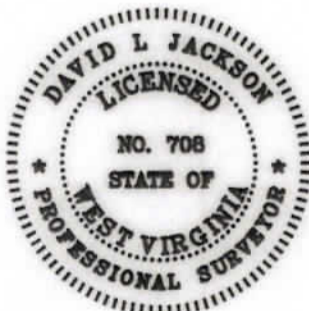

I, THE UNDERSIGNED, HEREBY CERTIFY THAT THIS PLAT IS CORRECT TO THE BEST OF MY KNOWLEDGE AND BELIEF AND SHOWS ALL THE INFORMATION REQUIRED BY LAW AND REGULATIONS ISSUED AND PRESCRIBED BY THE DEPARTMENT OF ENVIRONMENTAL PROTECTION.

P.S. 708

*David L Jackson*

47-051-02500

06/23/2023

REVISIONS:	COMPANY:			DATE: 04-13-2023
				DRAWN BY: N. MANO
	OPERATOR'S	DAVID REINBEAU MSH		SCALE: N/A
	WELL #:	6H		DRAWING NO:
	DISTRICT:	COUNTY:	STATE:	WELL LOCATION PLAT 2
	UNION	MARSHALL	WV	

**JACKSON SURVEYING  
INC.**

2413 EAST PIKE ST. # 112  
Clarksburg, WV 26302  
304-623-5851

WELL BORE TRACTS		
TRACT	SURFACE OWNER (S) / ROYALTY OWNER (R)	TAX PARCEL
1	REINBEAU SHELLY A & DAVID W (S/R)	13-8-29
TRACT	SURFACE OWNER (S)	TAX PARCEL
2	REINBEAU SHELLY A & DAVID W (S)	13-8-27
3	MCCOMBS JOHN A SR, THOMAS E & BETH (S)	13-8-26
4	MCCOMBS JOHN A SR, THOMAS E & BETH (S)	13-8-11
5	CONNER AMBER D & DAVID HANES JR (S)	13-8-14
6	CONNER AMBER D & DAVID HANES JR (S)	13-8-13
7	CONNER AMBER D & DAVID HANES JR (S)	13-8-12
8	ROCKY PEARL FARM LLC (S)	13-9-6
9	JONES NICHOLAS & EVELINE J (S)	13-9-8
10	EDISON MARK C ET UX (S)	13-9-9
11	ELIAS GRANT THOMAS ET UX (S)	13-9-32
12	BERTRAM BRIAN B & ADDIE L (S)	13-9-30
13	HUCK LAURA LEE & MARY L (S)	13-9-29.2
14	KELCH SCOTT EDWARD ET UX (S)	13-9-29.5
15	CHAMBERS DOROTHY - LIFE (S)	13-14-7
16	MCWHORTER LELAND & DEBORAH 2018 IRREVOCABLE TRUST (S)	13-14-10
17	BRIGGS ANDREW & MAXCINE (S)	13-14-11
18	BENSON CHAZ M (S)	13-14-28
19	D'CAGNA LUNN L (S)	13-14-29.5
20	FOSTER AARON M & MARSHA ANN (S)	13-14-29.8
21	FOSTER CHARLES S ET UX (S)	13-14-38.1
22	SMITH EDWARD LEE II (S)	14-5-26
23	BLED SOE DAVID R & KIMBERLY K (S)	14-5-26.1
24	BLED SOE BILLY JAMES SR & NORA; LIFE - BLED SOE TIMOTHY & BLED SOE DAVID (S)	14-5-26.2
25	HILL KAY F ET AL (S)	14-5-28
26	GORAKSHYA-SEVA & ENV EDU TR OF AMERICA INC (S)	15-2-18.2
27	HILL KAY F ET AL (S)	14-5-30
28	GORAKSHYA-SEVA & ENV EDU TR OF AMERICA INC (S)	15-7-2
29	MILLER R CRAIG & DONITA D (S)	15-7-2.4
30	WEISNER GEORGE LET UX - TOD (S)	15-7-1.3

ADJOINING OWNERS TABLE		
TRACT	SURFACE OWNER	TAX PARCEL
A	ALEXANDER LORRAINE	13-7-20
B	ALEXANDER LORRAINE	13-7-18.1
C	ALEXANDER LORRAINE	13-7-18
D	SAMPSON EDITH VIRGINIA EST	13-7-19
E	NARRISH KEVIN	13-8-30
F	SOUTH CHRISTOPHER R	13-8-31
G	KOSTELECKY JOSEPH J JR & CAROLYN - TOD	13-8-31.1
H	KOSEM DEBBIE & KARL	13-8-32
I	ARCHEY RICK L ET AL	13-8-1
J	LIBERTY JOHN ET UX	13-8-10
K	BIRKETT WILLIAM N III & CHASITY A	13-8-10.2
L	LILLEY CONSTANCE E - TOD	13-8-10.1
M	LILLEY CONSTANCE E - TOD	13-8-7.7
N	KINNEER JAMIE ET UX	13-8-7.9
O	KINNEER VERNON A JR & JAMIE	13-8-6
P	CUNNINGHAM GEORGE A	13-9-3
Q	CUNNINGHAM GEORGE A	13-9-5
R	LOY CHARLES E SR - TOD	13-9-5.2
S	WILSON RONALD A ET UX	13-9-5.3
T	LOY CHARLES E SR - TOD	13-9-5.1
U	EDISON MARK C ET UX	13-9-9.1
V	LOY CHARLES E SR - TOD	13-9-4
W	EDISON MARK C ET UX	13-9-10
X	CUNNINGHAM BESSIE JANE	13-9-11
Y	SHERMAN FAMILY TRUST	13-9-26
Z	BERTRAM BRIAN B & ADDIE	13-9-29
A2	HUCK MARY L & HUCK MIA MARIE	13-9-29.4
B2	ZUKOFF JACOB P ET UX	13-9-29.6
C2	FANKHAUSER TERRY NEAL ET UX	13-9-29.3
D2	FANKHAUSER TERRY NEAL ET UX	13-9-29.1
E2	GOMPERS SHANNON	13-9-28
F2	MYSLUWIEC JOHN A & MARY ANN	13-9-27
G2	MYSLUWIEC JOHN A & MARY ANN	13-9-26.2
H2	THOMPSON MICHAEL C & CRYSTAL M	13-14-13
I2	ROGERSON CHESTER ET AL - LIFE	13-14-12
J2	MOORE NANCY ROGERSON	13-14-27.3
K2	ROGERSON CHESTER ET AL - LIFE	13-14-27
L2	GRAY CAROLYN L	13-14-24
M2	GRAY CAROLYN L	13-14-24.2
N2	FOSTER CHARLES S ET UX	13-14-38.5
O2	SMITH RICHARD A	14-5-27
P2	BLED SOE DAVID R & KIMBERLY K	14-5-26.3
Q2	BLED SOE BILLY J JR & CLARA M	14-5-26.4
R2	ECO VRINDABAN INC	15-2-18
S2	HUNTT DAVID	15-2-18.1
T2	SAWYER ANGELA MARIE	15-7-2.6
U2	FRIED GABRIEL	15-7-2.3
V2	PHILLIPS MARIAN E	15-7-2.5
W2	MEBERG MARY P - TOD	15-7-2.2
X2	WIESNER GEORGE L ET UX - TOD	15-7-2.1
Y2	SOFSKY EMIL P JR ET AL	15-7-6.4
Z2	ISKCON NEW VRINDABAN INC	15-7-1.4

ADJOINING OWNERS TABLE		
TRACT	SURFACE OWNER	TAX PARCEL
A3	ISKCON NEW MATHURA VRINDABAN	15-7-1.2
B3	MOORE DAVID & SHIRLEY	14-5-77
C3	PETTIT DIANA LYNN	14-5-31.2
D3	HILL KAY F ET UX	14-5-32.4
E3	LILLEY ROGER W JR & TRICIA	14-5-32.6
F3	HILL HOWARD B EST	14-5-29.2
G3	HILL KAY F ET UX	14-5-29.1
H3	HILL KAY F ET UX	14-5-29
I3	LILLEY ROGER W ET UX	14-5-32.5
J3	TATICH DANIEL EDWARD TRUST	14-5-36
K3	FRANCIS LISA JANE	14-5-37
L3	KOONTZ CARL JR ET AL	14-5-24
M3	FOSTER CAITLIN E	13-14-50
N3	WILSON ROBERT J & REBECCA S	14-5-24.6
O3	FOSTER CHARLES S & BREANNA	13-14-38.2
P3	HENRY G H & JANET FAMILY TRUST	13-14-29
Q3	SNIDER LINDA ELIZABETH	13-14-29.11
R3	MASON CURTIS G ET UX	13-14-29.7
S3	ANDERSON ROBERT P & BECKI L	13-14-29.6
T3	ANDERSON ROBERT P & BECKI L	13-14-29.1
U3	MCDIFFITT CLYDE J & KAREN - TOD	13-14-9.1
V3	GODDARD RUSSELL E	13-14-9.3
W3	COULTER JAMES G & SONDR A K	13-14-9.7
X3	ROVER PIPELINE LLC	13-14-9
Y3	ROVER PIPELINE LLC	13-14-8
Z3	BECKNER DAVID E & DEBORAH K	13-14-7.3
A4	LEWEY CHARLES L & MARGARET A	13-14-7.1
B4	DORAN BRIAN W ET UX	13-14-7.4
C4	COTTRELL COLE T	13-14-7.5
D4	GIVENS BRUCE E ET UX	13-14-7.2
E4	CHAMBERS DOROTHY	13-14-6.2
F4	MURPHY MICHAEL A & BLACK AMY S	13-14-7.6
G4	FREEMAN RAYMOND CHRISTOPHER	13-14-4
H4	SUNDERHAUS TINA M & STEPHEN G	13-14-7.7
I4	PARSONS JAY D ET UX	13-14-1
J4	LILLEY KENNETH R & CARLOTTA J	13-9-31
K4	CUNNINGHAM JOHN F	13-9-29.7
L4	PHILLIPS JANET M	13-9-32.6
M4	PHILLIPS JANET M	13-9-32.8
N4	WRIGHT DAVID JAMES	13-9-32.4
O4	CRAKE ROBERT J & SHELLEY S	13-9-32.7
P4	CRAKE ROBERT J & SHELLEY S	13-9-32.3
Q4	ZUKOFF LISA B ET AL	13-9-32.2
R4	EAGLE LTD	13-9-32.1
S4	CHAMBERS ROBIN L & DENICE E	13-9-33.2
T4	CHAMBERS ROBIN L & DENICE E	13-9-33.1
U4	MILLER KENNETH LEE - TOD	13-9-33
V4	METS PROPERTIES LLC	13-10-23
W4	METS PROPERTIES LLC	13-10-22
X4	JONES NICHOLAS & EVELINE J	13-10-21.8
Y4	JONES NICHOLAS & EVELINE J	13-10-21.7
Z4	GANTZER THOMAS P & JILL N	13-10-21.3

47-051-02 06/23/2023

REVISIONS:	COMPANY:	 	
	OPERATOR'S	DAVID REINBEAU MSH	
	WELL #:	6H	
	DISTRICT:	COUNTY:	STATE:
	UNION	MARSHALL	WV
			DATE: 04-13-2023
			DRAWN BY: N. MANO
			SCALE: N/A
			DRAWING NO:
			WELL LOCATION PLAT 3

**JACKSON SURVEYING  
INC.**

2413 EAST PIKE ST. # 112  
Clarksburg, WV 26302  
304-623-5851

ADJOINING OWNERS TABLE		
TRACT	SURFACE OWNER	TAX PARCEL
A5	RIGGLE STACY L	13-10-21.9
B5	MONTGOMERY TORIE	13-10-21.2
C5	MELNIK BRUCE A ET UX	13-10-21.1
D5	MELNIK BRUCE A ET UX	13-10-21
E5	CARTER KELLY J	13-10-20
F5	CARTER KELLY J	13-10-19
G5	HIERONIMUS C KEITH ET UX	13-8-15
H5	MCLAUGHLIN SHAWN & ELIZABETH	13-8-23
I5	PERRY JOSEPH P JR	13-8-24
J5	THORN JACLYN A & JASON K	13-8-25
K5	CRAWFORD GARY J	13-7E-7
L5	JOSEPH WILLIAM F & SUSAN L	13-7E-8
M5	CAIN ROGER L II	13-7E-10
N5	MCCLINTOCK JOSIE & LARRY	13-7-22.4
O5	SHEPHERD JAMES LEE II	13-7-23
P5	REINBEAU RONALD W & FRIEDA A - LIFE	13-7-22.2
Q5	REINBEAU DAVID W & SHELLY A	13-7-22.3
R5	REINBEAU DAVID W & SHELLY A	13-7-21.1
S5	BOWMAN MICHAEL ET UX	13-8-28
T5	BOWMAN MICHAEL J & CONSTANCE G	13-7-21

47-051 06/23/2023

REVISIONS:	COMPANY:	 	
	OPERATOR'S	DAVID REINBEAU MSH	
	WELL #:	6H	
	DISTRICT:	COUNTY:	STATE:
	UNION	MARSHALL	WV
			DATE: 04-13-2023
			DRAWN BY: N. MANO
			SCALE: N/A
			DRAWING NO:
			WELL LOCATION PLAT 4