



EQT (Chevron Data) 02-13-21

Marshall County, WV Chevron

Freeland

M05H Plat

Wellbore #1

Design: Freeland M05H As Drilled

Standard Survey Report

23 August, 2021



EQT
Survey Report

Database:	EDM_Definitive	Local Co-ordinate Reference:	Well M05H Plat
Company:	EQT (Chevron Data) 02-13-21	TVD Reference:	KB@27 @ 1301.000usft
Project:	Marshall County, WV Chevron	MD Reference:	KB@27 @ 1301.000usft
Site:	Freeland	North Reference:	True
Well:	M05H Plat	Survey Calculation Method:	Minimum Curvature
Wellbore:	Wellbore #1		
Design:	Freeland M05H As Drilled		

Project	Marshall County, WV Chevron		
Map System:	US State Plane 1983	System Datum:	Mean Sea Level
Geo Datum:	North American Datum 1983		
Map Zone:	West Virginia Northern Zone		

Site	Freeland				
Site Position:		Northing:	500,572.528 usft	Latitude:	39.87
From:	Lat/Long	Easting:	1,614,533.947 usft	Longitude:	-80.76
Position Uncertainty:	0.000 usft	Slot Radius:	13-3/16 "	Grid Convergence:	-0.8043 °

Well	M05H Plat					
Well Position	+N/-S	0.000 usft	Northing:	500,621.700 usft	Latitude:	39.8676351
	+E/-W	0.000 usft	Easting:	1,614,535.720 usft	Longitude:	80.7610961°W
Position Uncertainty		0.000 usft	Wellhead Elevation:	usft	Ground Level:	1,274.000 usft

Wellbore	Wellbore #1				
Magnetics	Model Name	Sample Date	Declination (°)	Dip Angle (°)	Field Strength (nT)
	User Defined	9/26/2019	-7.9000	66.8500	52,295.90000000

Design	Freeland M05H As Drilled				
Audit Notes:					
Version:	1.0	Phase:	ACTUAL	Tie On Depth:	0.000
Vertical Section:	Depth From (TVD) (usft)	+N/-S (usft)	+E/-W (usft)	Direction (°)	
	0.000	0.000	0.000	212.325	

Survey Program	Date	8/23/2021			
From (°)	To (usft)	Survey (Wellbore)	Tool Name	Description	
0.00	634.998	Freeland M05H Gyro (Wellbore #1)	53_SDI_Keeper_WL_NS+CTSDI_101Ga	- SDI Keep static gyrocompass with con c	

Survey											
Measured Depth (usft)	Inclination (°)	Azimuth (°)	Vertical Depth (usft)	Subsea Depth (usft)	+N/-S (usft)	+E/-W (usft)	Vertical Section (usft)	Dogleg Rate (°/100usft)	Build Rate (°/100usft)	Turn Rate (°/100usft)	
0.000	0.000	0.000	0.000	-1,301.000	0.000	0.000	0.000	0.00000	0.00000	0.00000	
274.999	0.480	222.270	274.996	-1,026.004	-0.852	-0.775	1.135	0.17455	0.17455	0.00000	
299.999	0.420	219.690	299.995	-1,001.005	-1.000	-0.904	1.329	0.25326	-0.24000	-10.32004	
324.999	0.330	210.150	324.994	-976.006	-1.133	-0.998	1.491	0.43697	-0.36000	-38.16014	
349.999	0.340	204.620	349.994	-951.006	-1.263	-1.065	1.637	0.13531	0.04000	-22.12008	
374.999	0.310	200.600	374.993	-926.007	-1.394	-1.120	1.777	0.15066	-0.12000	-16.08006	
399.998	0.330	190.090	399.993	-901.007	-1.528	-1.157	1.909	0.24763	0.08000	-42.04016	
424.998	0.260	197.610	424.992	-876.008	-1.653	-1.186	2.031	0.31940	-0.28000	30.08011	
449.998	0.240	187.030	449.992	-851.008	-1.759	-1.210	2.133	0.20086	-0.08000	-42.32016	



EQT
Survey Report

Database:	EDM_Definitive	Local Co-ordinate Reference:	Well M05H Plat
Company:	EQT (Chevron Data) 02-13-21	TVD Reference:	KB@27 @ 1301.000usft
Project:	Marshall County, WV Chevron	MD Reference:	KB@27 @ 1301.000usft
Site:	Freeland	North Reference:	True
Well:	M05H Plat	Survey Calculation Method:	Minimum Curvature
Wellbore:	Wellbore #1		
Design:	Freeland M05H As Drilled		

Survey											
Measured Depth (usft)	Inclination (°)	Azimuth (°)	Vertical Depth (usft)	Subsea Depth (usft)	+N/-S (usft)	+E/-W (usft)	Vertical Section (usft)	Dogleg Rate (°/100usft)	Build Rate (°/100usft)	Turn Rate (°/100usft)	
474.998	0.350	203.120	474.992	-826.008	-1.881	-1.246	2.256	0.54671	0.44000	64.36024	
499.998	0.380	193.300	499.991	-801.009	-2.032	-1.295	2.410	0.27705	0.12000	-39.28015	
524.998	0.300	176.900	524.990	-776.010	-2.178	-1.311	2.541	0.50082	-0.32000	-65.60025	
549.998	0.150	230.020	549.990	-751.010	-2.264	-1.332	2.626	0.96737	-0.60000	212.48079	
574.998	0.200	230.030	574.990	-726.010	-2.313	-1.391	2.699	0.20000	0.20000	0.04000	
599.998	0.460	213.920	599.989	-701.011	-2.425	-1.480	2.840	1.09417	1.04000	-64.44024	
624.998	0.410	226.540	624.989	-676.011	-2.569	-1.601	3.027	0.43105	-0.20000	50.48019	
634.998	0.400	232.330	634.988	-666.012	-2.615	-1.655	3.095	0.42111	-0.10000	57.90022	

Design Annotations					
Measured Depth (usft)	Vertical Depth (usft)	Local Coordinates		Comment	
		+N/-S (usft)	+E/-W (usft)		
635.000				Final Gyro Survey=635' MD/TVD	

Checked By: _____ Approved By: _____ Date: _____



KB Elevation= KB@27 @ 1301.000usft
 Ground Elevation= 1274.000
 All measurements were taken from KB Elevation

Project: Marshall County, WV Chevron
 Site: Freeland
 Well: M05H Plat
 Wellbore: Wellbore #1
 Design: Freeland M05H As Drilled

EQT (Chevron Data) 02-13-21

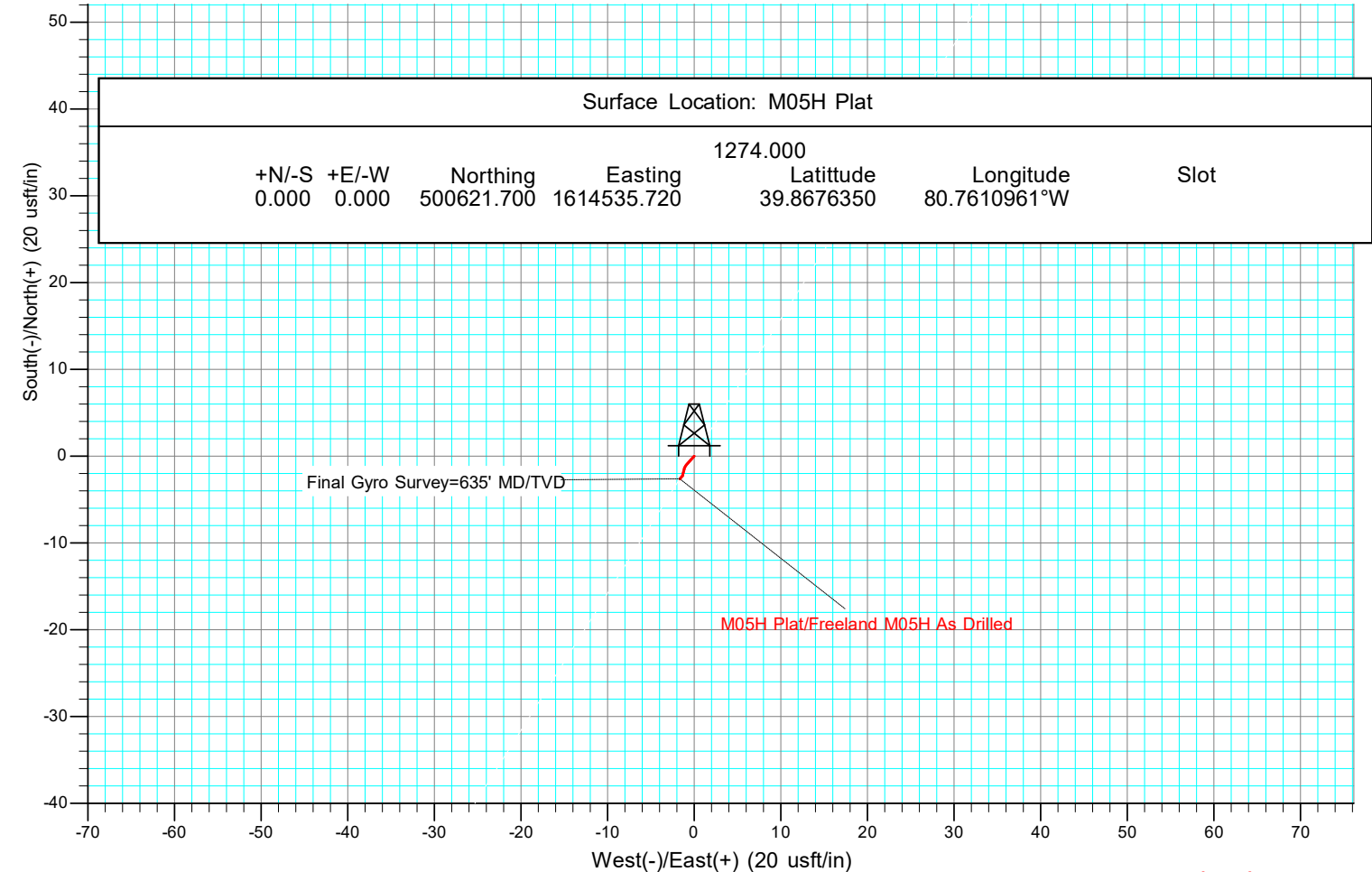
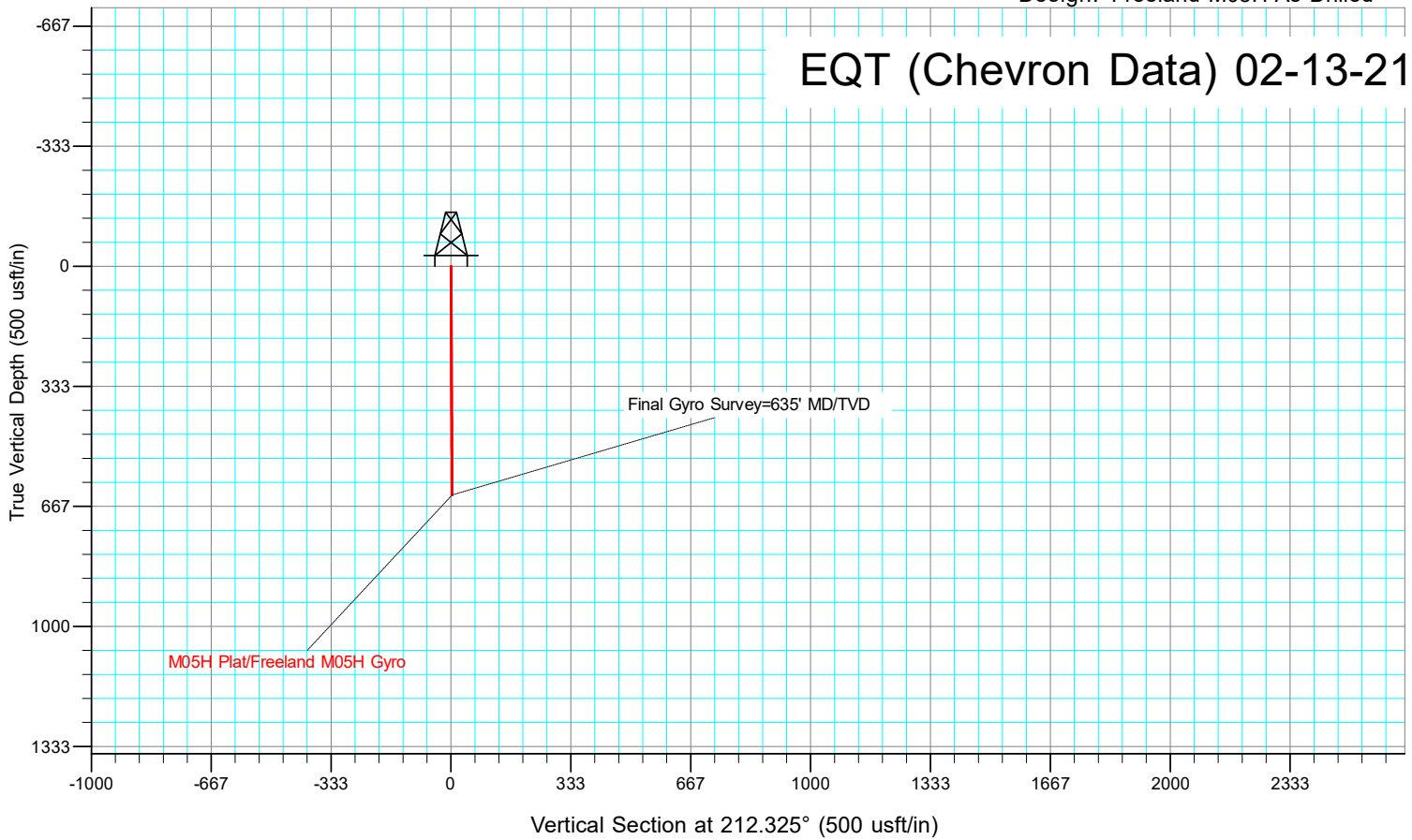

11/19/2021