

SURFACE HOLE DEC. LONG: 80.617175
SURVEYED LONG: 80° 37' 01.8"

9,520'

Latitude: 40° 00' 00" (NAD27)

Longitude: 80° 35' 00" (NAD27)

WATER WELLS

- #1 N 50°47'06" W 983'
- #2 N 00°20'18" E 1019'
- #3 N 11°53'08" W 1154'
- #4 N 17°32'04" W 1359'

WELLS WITHIN 3000'

1 DEEP WELL WITHIN 3000'

LEGEND

- TOPO SURFACE HOLE
- TOPO BOTTOM HOLE
- PROPOSED WELL
- WATER SOURCE
- PERMIT
- LEASID NUMBER BASED ON ATTACHED WMSAT
- PROPOSED HORIZONTAL LATERAL
- SURFACE & MINERAL PARCEL BOUNDARY
- WELL PERMIT
- STREAM / WATERWAY
- UNIT BOUNDARY
- 3000' BUFFER
- FORCED POOLED PARCELS

LINE TABLE

LINE	BEARING	DISTANCE
R1	N 67°27'29" W	457'
R2	N 60°14'09" E	229'
R3	N 69°58'44" E	1,302'
R4	S 75°00'51" E	718'
R5	N 82°23'48" W	1,272'

01/18/2019

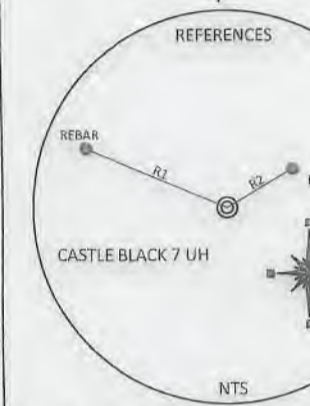
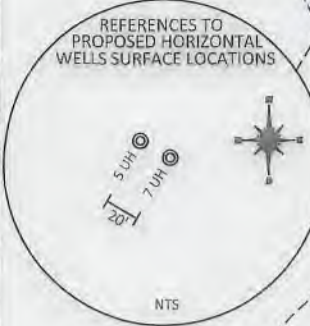

- NOTES:**
- There are no water wells or developed springs within 250' of proposed well. There are no existing buildings within 625' of proposed well.
 - Proposed well is greater than 100' from perennial stream, wetland, pond, reservoir or lake.
 - There are no native trout streams within 300' of proposed well.
 - Proposed well is greater than 1000' from surface/groundwater intake or public water supply.
 - It is not the purpose or intention of this plat to represent surveyed locations of the surface or mineral parcels depicted hereon. The location of the boundary lines, as shown were provided by American Petroleum Partners Operating LLC.
 - Mineral and Surface parcel lines are the same.

SURFACE HOLE LOCATION (SHL)	APPROX. LANDING POINT	BOTTOM HOLE LOCATION
UTM 17 - NAD83 N) 4424208.8 E) 532710.6	UTM 17 - NAD83 N) 4424089.8 E) 532801.9	UTM 17 - NAD83 N) 4422037.8 E) 534238.6
NAD27: WV NORTH N) 536386.2 E) 1686872.7	NAD27: WV NORTH N) 535990.5 E) 1687165.6	NAD27: WV NORTH N) 529178.1 E) 1691767.8
LAT/LON DATUM - NAD83 LAT: 39.967397 LONG: -80.616974	LAT/LON DATUM - NAD83 LAT: 39.966320 LONG: -80.615911	LAT/LON DATUM - NAD83 LAT: 39.947776 LONG: -80.599196

TOTAL UNIT ACRES
390.91

FILE #: APP001
DRAWING #: 2823
SCALE: PLAT: 1" = 2000'
TICK: 1" = 2000'

MINIMUM DEGREE OF ACCURACY: 1/200

PROVEN SOURCE OF ELEVATION: SUBMETER MAPPING GRADE GPS

I, THE UNDERSIGNED, HEREBY CERTIFY THAT THIS PLAT IS CORRECT TO THE BEST OF MY KNOWLEDGE AND BELIEF AND SHOWS ALL THE INFORMATION REQUIRED BY LAW AND THE REGULATIONS ISSUED AND PRESCRIBED BY THE DEPARTMENT OF ENVIRONMENTAL PROTECTION.

Signed: *[Signature]*
L.L.S. #2124: Ernest J. Benchek III

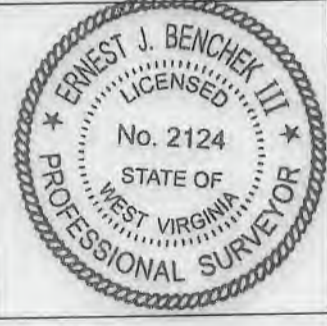

(+) DENOTES LOCATION OF WELL ON UNITED STATES TOPOGRAPHIC MAPS WYDEP

OFFICE OF OIL & GAS
601 57TH STREET
CHARLESTON, WV 25304

Well Type: Oil Waste Diposal Production Deep
 Gas Liquid Injection Storage Shallow

WATERSHED: UPPER OHIO SOUTH

COUNTY/DISTRICT: MARSHALL / WEBSTER

SURFACE OWNER: ECO-VRINDABAN, INC., DBA GORAKSHYA-SEVA & ENVIRONMENTAL EDUCATION TRUST OF AMERICA, INC.

OIL & GAS ROYALTY OWNER: ECO-VRINDABAN, INC.

LEASE NUMBERS:

DRILL CONVERT DRILL DEEPER REDRILL FRACTURE OR STIMULATE
PLUG OFF FORMATION PERFORATE NEW FORMATION PLUG & ABANDON
CLEAN OUT & REPLUG OTHER CHANGE (SPECIFY):

TARGET FORMATION: POINT PLEASANT

WELL OPERATOR: AMERICAN PETROLEUM PARTNERS OPERATING, LLC
ADDRESS: 4600 J. BARRY COURT, SUITE 310
CITY: CANONSBURG STATE: PA ZIP CODE: 15317

DATE: AUGUST 29, 2018

OPERATOR'S WELL #: CASTLE BLACK 7 UH

API WELL #: 47 51 02119 H6A

STATE COUNTY PERMIT
PROPOSED ELEVATION: 1,041.65'
CURRENT ELEVATION: 1,044'

QUADRANGLE: MAJORSVILLE, WV

ACREAGE: 89.017 +/-

ACREAGE: 89.017 +/-

ESTIMATED DEPTH: TVD: 11,395' TMD: 19,954'

DESIGNATED AGENT: STEVEN GREEN
ADDRESS: 300 SUMMERS ST. SUITE 1000
CITY: CHARLESTON STATE: WV ZIP CODE: 25301



01/18/2019

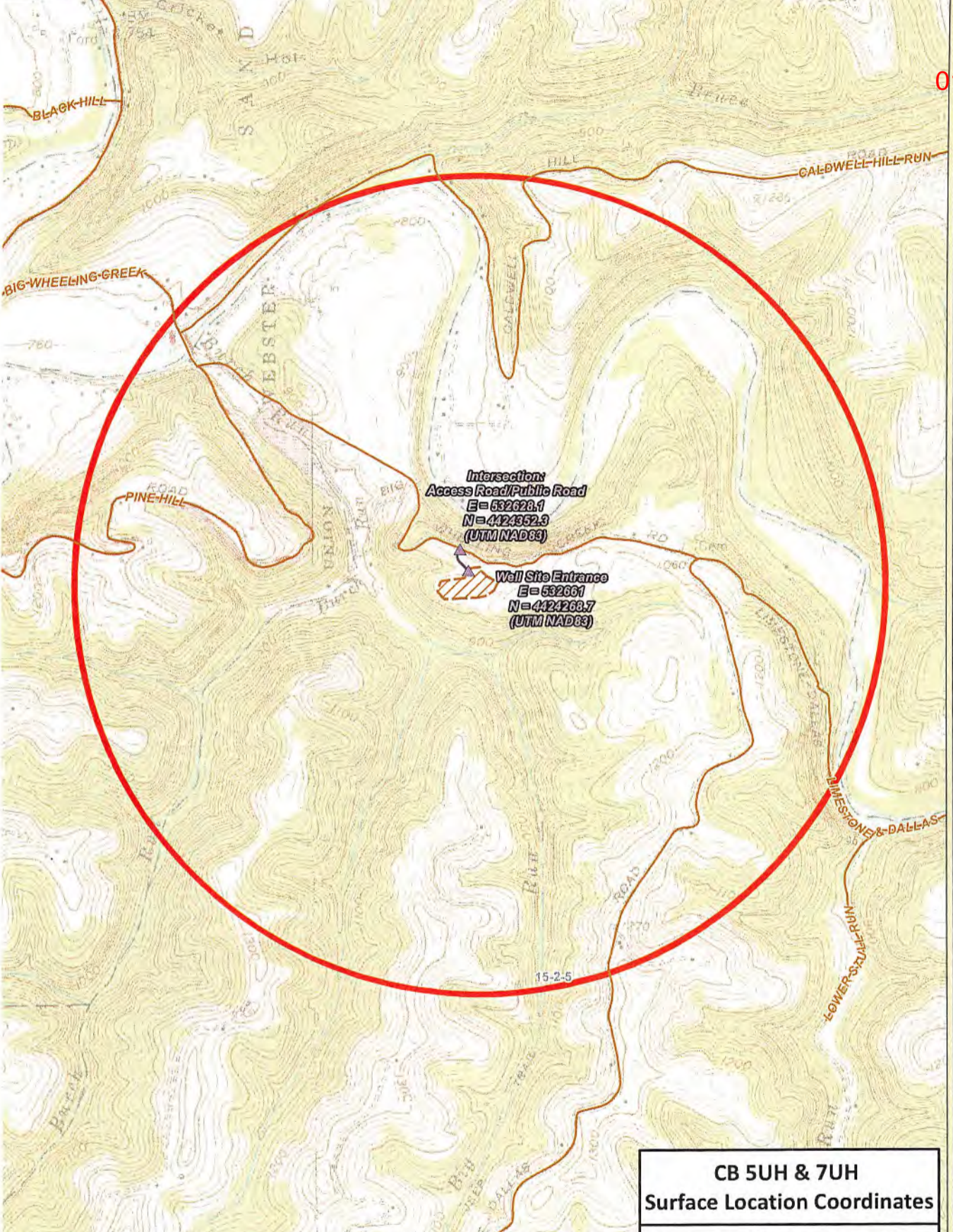

**Castle Black Drill Pad 911 Address:
6583 Big Wheeling Creek Rd, Moundsville, WV 26041**

**CB 5UH & 7UH
Surface Location Coordinates**
5UH: -80.617036, 39.967423
7UH: -80.616974, 39.967397

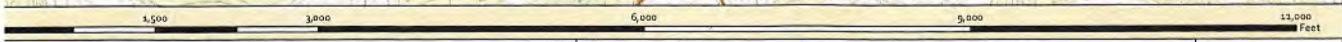

CB 5UH & 7UH - Well Site

Marshall County
West Virginia

Coordinate System:
North American 1983
Linear Units: Meter

Map Scale Units:
1:18,000
1 inch = 1,500 feet

Map Author: JKS
Map Date: 8/2/2018

- Well SHL
- Well Pad
- 1 mile buffer
- Access Rd Intersection
- Access Road
- County Road



RECEIVED
Office of Oil and Gas

AUG 29 2018

WV Department of
Environmental Protection