

State of West Virginia
Department of Environmental Protection - Office of Oil and Gas
Well Operator's Report of Well Work

API 47 - 051 - 02056 County Marshall District Franklin
Quad New Martinsville 7.5' Pad Name Accettolo Field/Pool Name _____
Farm name Louis J. & Patricia Accettolo, et al Well Number Evad 1HM
Operator (as registered with the OOG) Tug Hill Operating, LLC
Address 380 Southpointe Boulevard, Plaza II, Suite 200 City Canonsburg State PA Zip 15317

As Drilled location NAD 83/UTM Attach an as-drilled plat, profile view, and deviation survey
Top hole Northing 4,399,407.88 Easting 517,711.36
Landing Point of Curve Northing 4,399,098.09 Easting 517,586.49
Bottom Hole Northing 4,396,794.38 Easting 518,924.11

Elevation (ft) 1280.7' GL Type of Well New Existing Type of Report Interim Final
Permit Type Deviated Horizontal Horizontal 6A Vertical Depth Type Deep Shallow
Type of Operation Convert Deepen Drill Plug Back Redrilling Rework Stimulate
Well Type Brine Disposal CBM Gas Oil Secondary Recovery Solution Mining Storage Other _____
Type of Completion Single Multiple Fluids Produced Brine Gas NGL Oil Other _____
Drilled with Cable Rotary

Drilling Media Surface hole Air Mud Fresh Water Intermediate hole Air Mud Fresh Water Brine
Production hole Air Mud Fresh Water Brine

Mud Type(s) and Additive(s)
SOBM; Base oil, osmotic inhibitor, weighting agent, viscosifier, emulsifier, hardness buffer, fluid loss additive, LCM, Shale inhibitor, de-foamer, soaping agent, coagulant, flocculant; specific additives per WSSP and Permit.

Date permit issued 8/29/218 Date drilling commenced 2/27/2019 Date drilling ceased 3/18/2019
Date completion activities began 6/3/2019 Date completion activities ceased 1/13/2020
Verbal plugging (Y/N) N Date permission granted N/A Granted by N/A **RECEIVED**
Office of Oil and Gas

JUL 20 2020

Please note: Operator is required to submit a plugging application within 5 days of verbal permission to plug

WV Department of
Environmental Protection

Freshwater depth(s) ft 70' Open mine(s) (Y/N) depths N
Salt water depth(s) ft 1595' Void(s) encountered (Y/N) depths N
Coal depth(s) ft 789-795', 889-895' Cavern(s) encountered (Y/N) depths N
Is coal being mined in area (Y/N) N

Reviewed by: *J. Urbahn*
7/27/2020

API 47-051 - 02056 Farm name Louis J. & Patricia Accettolo, et al Well number Evad 1HM

CASING STRINGS	Hole Size	Casing Size	Depth	New or Used	Grade wt/fl	Basket Depth(s)	Did cement circulate (Y/N) * Provide details below*
Conductor	36"	30"	120'	NEW	94.5#	N/A	Y
Surface	17 1/2"	13 3/8"	1,019'	NEW	54.5#	N/A	Y
Coal	17 1/2"	13 3/8"	1,019'	NEW	54.5#	N/A	Y
Intermediate 1	12 1/4"	9 5/8"	2,838'	NEW	36#	N/A	Y
Intermediate 2							
Intermediate 3							
Production	8 3/4"	5 1/2"	15,763'	NEW	20#	N/A	Y
Tubing		2 3/8"	7,882'	NEW	4.7#	N/A	YA
Packer type and depth set							

Comment Details

CEMENT DATA	Class/Type of Cement	Number of Sacks	Slurry wt (ppg)	Yield (fl ³ /sks)	Volume (fl ³)	Cement Top (MD)	WOC (hrs)
Conductor	A		15.6	1.19		0	8
Surface	A	1043	15.6	1.19	1247	0	8
Coal	A	1043	15.6	1.19	1247	0	8
Intermediate 1	A	1105	15.6	1.19	1311	0	8
Intermediate 2							
Intermediate 3							
Production	A	3718	14.5	1.17	4369	0	8
Tubing							

Drillers TD (ft) 15,800' Loggers TD (ft) n/a
 Deepest formation penetrated Marcellus Plug back to (ft) n/a
 Plug back procedure n/a

Kick off depth (ft) 5,858'

Check all wireline logs run caliper density deviated/directional induction
 neutron resistivity gamma ray temperature sonic

Well cored Yes No Conventional Sidewall Were cuttings collected Yes No

DESCRIBE THE CENTRALIZER PLACEMENT USED FOR EACH CASING STRING 3 centralizers on surface casing at equal distance.

Intermediate - 1 centralizer every other joint

Production - one centralizer every other joint in lateral, one centralizer every joint through curve, one centralizer every other joint to surface.

RECEIVED
Office of Oil and Gas

JUL 20 2020

WAS WELL COMPLETED AS SHOT HOLE Yes No DETAILS WV Department of Environmental Protection

WAS WELL COMPLETED OPEN HOLE? Yes No DETAILS _____

WERE TRACERS USED Yes No TYPE OF TRACER(S) USED _____

EVAD 1HM

LITHOLOGY/FORMATION	TOP DEPTH IN FT/ Name TVD	BOTTOM DEPTH IN FT TVD	TOP DEPTH IN FT MD	BOTTOM DEPTH IN FT MD	DESCRIBE ROCK TYPE AND RECORD QUANTITY AND TYPE OF FLUID
Maxton	1969	2064	1971	2067	Sandstone
Big Lime	2064	2119	2067	2122	Limestone
Big Injun	2119	2421	2122	2425	Sandstone
Weir	2421	2604	2425	2609	Sandstone
Berea	2604	2915	2609	2921	Sandstone
Gordon	2915	2974	2921	2980	Sandstone
Fifty Foot	2974	3552	2980	3565	Sandstone
Speechley	3552	4943	3565	4988	Sandstone
Benson	4943	5319	4988	5374	Sandstone
Alexander	5319	5923	5374	5992	Siltstone
Rhinestreet	5923	6351	5992	6479	Black shale
Middlesex	6351	6429	6479	6593	Black shale
Geneseo/Burkett	6429	6453	6593	6634	Black shale
Tully	6453	6484	6634	6691	Limestone
Hamilton	6484	6527	6691	6799	Grey shale
Marcellus	6527	-	6799	-	Black shale

RECEIVED
 Office of Oil and Gas
 JUL 20 2020
 WV Department of
 Environmental Protection

**EVAD 1HM
PEFORATION RECORD**

Stage No.	Perforation Date	Perforated from MD ft.	Perforated to MD. Ft.	Number of Perforations	Formation(s)
1	11/14/2019	15371	15532	48	Marcellus
2	11/15/2019	15196	15356	48	Marcellus
3	11/15/2019	15020	15181	48	Marcellus
4	11/16/2019	14845	15005	48	Marcellus
5	11/16/2019	14669	14830	48	Marcellus
6	11/16/2019	14494	14655	48	Marcellus
7	11/16/2019	14319	14479	48	Marcellus
8	11/17/2019	14143	14304	48	Marcellus
9	11/17/2019	13968	14128	48	Marcellus
10	11/17/2019	13792	13953	48	Marcellus
11	11/18/2019	13617	13778	48	Marcellus
12	11/18/2019	13442	13602	48	Marcellus
13	11/18/2019	13266	13427	48	Marcellus
14	11/18/2019	13091	13251	48	Marcellus
15	11/18/2019	12915	13076	48	Marcellus
16	11/18/2019	12740	12901	48	Marcellus
17	11/19/2019	12565	12725	48	Marcellus
18	11/19/2019	12389	12550	48	Marcellus
19	11/19/2019	12214	12374	48	Marcellus
20	11/20/2019	12038	12199	48	Marcellus
21	11/20/2019	11863	12024	48	Marcellus
22	11/20/2019	11688	11848	48	Marcellus
23	11/20/2019	11512	11673	48	Marcellus
24	11/20/2019	11337	11497	48	Marcellus
25	11/20/2019	11161	11322	48	Marcellus
26	11/21/2019	10986	11147	48	Marcellus
27	11/21/2019	10811	10971	48	Marcellus
28	11/21/2019	10635	10796	48	Marcellus
29	11/21/2019	10460	10620	48	Marcellus
30	11/21/2019	10284	10445	48	Marcellus
31	11/22/2019	10109	10270	48	Marcellus
32	11/22/2019	9934	10094	48	Marcellus
33	11/22/2019	9758	9919	48	Marcellus
34	11/22/2019	9583	9743	48	Marcellus
35	11/22/2019	9407	9568	48	Marcellus
36	11/23/2019	9232	9393	48	Marcellus
37	11/23/2019	9057	9217	48	Marcellus
38	11/23/2019	8881	9042	48	Marcellus
39	11/23/2019	8706	8866	48	Marcellus
40	11/23/2019	8530	8691	48	Marcellus
41	11/24/2019	8355	8516	48	Marcellus

RECEIVED
Office of Oil and Gas
JUL 20 2020
WV Department of
Environmental Protection

Stage No.	Perforation Date	Perforated from MD ft.	Perforated to MD. Ft.	Number of Perforations	Formation(s)
42	11/24/2019	8180	8340	48	Marcellus
43	11/24/2019	8004	8165	48	Marcellus
44	11/24/2019	7829	7989	48	Marcellus
45	11/24/2019	7653	7814	48	Marcellus
46	11/24/2019	7478	7639	48	Marcellus
47	11/25/2019	7303	7463	48	Marcellus
48	11/25/2019	7127	7288	48	Marcellus
49	11/25/2019	6952	7112	48	Marcellus

RECEIVED
 Office of Oil and Gas
 JUL 20 2020
 WV Department of
 Environmental Protection

RECEIVED
 Office of Oil and Gas
 JUL 20 2020
 WV Department of
 Environmental Protection

**EVAD 1HM
STIMULATION INFORMATION PER STAGE**

Stage No.	Ave. Pump Rate (BPM)	Ave Treatment Pressure (PSI)	Max Breakdown Pressure (PSI)	ISIP (PSI)	Amount of Proppant (lbs)	Amount of Water (bbls)	Amount of Nitrogen/other (units)
1	87.9	7602	5344	3901	222800	7790	0
2	88.3	7512	5493	4682	441370	9574	0
3	88.9	7638	5422	4840	445160	9266	0
4	89	7634	5291	5043	446220	10879	0
5	89.1	7566	5113	5371	438185	9214	0
6	89	7601	5313	4922	439075	9077	0
7	88.7	7586	5174	4893	410700	8909	0
8	89.4	7397	5202	5240	441200	8997	0
9	89	7342	5035	5130	444160	9104	0
10	88.8	7651	5132	5055	447040	9280	0
11	89.2	7372	5212	4684	439020	8930	0
12	88.2	7341	5098	5239	436260	8983	0
13	89	7428	5194	4955	446180	9063	0
14	89.6	7208	5110	4883	447400	9594	0
15	88.9	7413	5306	4765	445580	9033	0
16	89.5	7438	5232	5004	435655	8916	0
17	89	7290	4965	4933	443300	9206	0
18	88.8	7301	5764	5205	428195	9244	0
19	88.5	6970	5114	5186	446570	9081	0
20	88.6	7034	5161	5126	437525	8858	0
21	87.4	6907	5060	5140	443025	8944	0
22	88.6	7142	5381	4911	449440	8672	0
23	86.7	7373	5399	4970	449240	9022	0
24	88.2	7077	5209	4861	439490	9126	0
25	88.7	6983	5279	5072	446000	9196	0
26	89.7	6973	5066	4714	442200	9220	0
27	88.3	7094	5213	5279	426140	8675	0
28	88.3	6887	5034	5085	448030	8754	0
29	88.9	6882	5446	4846	447420	9114	0

Stage No.	Ave. Pump Rate (BPM)	Ave Treatment Pressure (PSI)	Max Breakdown Pressure (PSI)	ISIP (PSI)	Amount of Proppant (lbs)	Amount of Water (bbbls)	Amount of Nitrogen/other (units)
30	89	6876	4942	4687	372675	8086	0
31	88	6861	5009	4861	424030	8874	0
32	85.3	6638	5064	5168	433880	8873	0
33	89	7018	5313	4924	324920	7115	0
34	89	7016	4875	4914	335895	8268	0
35	88.5	6850	4903	4702	407780	8966	0
36	89	6633	5125	4852	447530	9492	0
37	89.1	6770	5044	4774	381330	8465	0
38	88.9	6665	5151	4325	446840	9319	0
39	88.8	6587	5060	4831	403880	8642	0
40	88.3	6731	4823	4727	444620	9807	0
41	87.7	6911	4849	4084	382580	8933	0
42	88.3	6541	5003	5062	401180	8763	0
43	88.7	6552	5123	4825	292460	6923	0
44	88.5	6706	5135	4645	404190	9654	0
45	89.1	6636	5162	5045	397370	9060	0
46	88.1	6255	5068	4840	434220	9754	0
47	87.6	6493	5544	4290	441700	10060	0
48	88.7	6400	5206	4899	442340	9870	0
49	89.3	6293	5032	4973	444860	9277	0

RECEIVED
 Office of Oil and Gas
 JUL 20 2020
 WV Department of
 Environmental Protection



Well: Evad 01HM (G)
 Site: Accetolo/Evad Pad
 Project: Marshall County, West Virginia
 Design: rev2

SECTION DETAILS

Sec	MD	Inc	Azi	TVD	+N/-S	+E/-W	Dleg	TFace	Vsect	Annotation
1	0.00	0.00	0.00	0.00	0.00	0.00	0.00	0.00	0.00	
2	1218.00	0.00	0.00	1218.00	0.00	0.00	0.00	0.00	0.00	KOP Begin 2°/100' build
3	1468.00	5.00	250.00	1467.68	-3.73	-10.24	2.00	250.00	-0.92	Begin 5.00° tangent
4	3124.62	5.00	250.00	3118.00	-53.11	-145.92	0.00	0.00	-13.14	Begin 2°/100' build/turn
5	3486.70	12.14	240.95	3475.82	-77.02	-194.09	2.00	-15.20	-11.69	Begin 12.14° tangent
6	5957.63	12.14	240.95	5891.51	-329.26	-648.27	0.00	0.00	26.28	Begin 8°/100' build/turn
7	6578.88	50.00	157.50	6429.00	-597.87	-612.00	8.00	-93.74	285.26	Begin 10°/100' build/turn
8	6975.82	89.10	149.99	6565.18	-923.29	-447.95	10.00	-11.81	649.49	Begin 89.10° lateral
9	15819.48	89.10	149.99	6704.00	-8580.41	3974.68	0.00	0.00	9456.29	PBHL/TD 15819.48 MD:6704.00 TVD

ANNOTATIONS SURVEYS

MD	Inc	Azi	TVD	+N/-S	+E/-W	Vsect	Annotation
158.00	0.23	98.76	158.00	-0.05	0.31	0.18	MWD surveys
15749.00	89.10	148.19	6622.56	-8531.14	3951.97	9402.04	Survey @ 15749.00 MD 6622.56 TVD
15800.00	89.10	148.19	6623.36	-8574.47	3978.84	9452.66	Survey projected to 15800.00 MD 6623.36 TVD

Geodetic System: Universal Transverse Mercator (US Survey Feet)
 Datum: NAD83 West Virginia - HARN
 Ellipsoid: GRS 1980
 Zone: Zone 17N (84 W to 78 W)

System Datum: Mean Sea Level
 Depth Reference: RKB=1291+18 @ 1309.00ft (PD 528)

Northing: 14433724.12 Easting: 1698524.31 Latitude: 39.74438861 Longitude: -80.79327927

Total Corr (M->G): To convert a Magnetic Direction to a Grid Direction, Subtract 8.78'



Azimuths to Grid North
 True North: -0.13°
 Magnetic North: -8.78°

Magnetic Field
 Strength: 52057.8nT
 Dip Angle: 66.86°
 Date: 5/11/2018
 Model: IGRF2015



RECEIVED
 Office of Oil and Gas
 JUL 20 2020
 WV Department of
 Environmental Protection

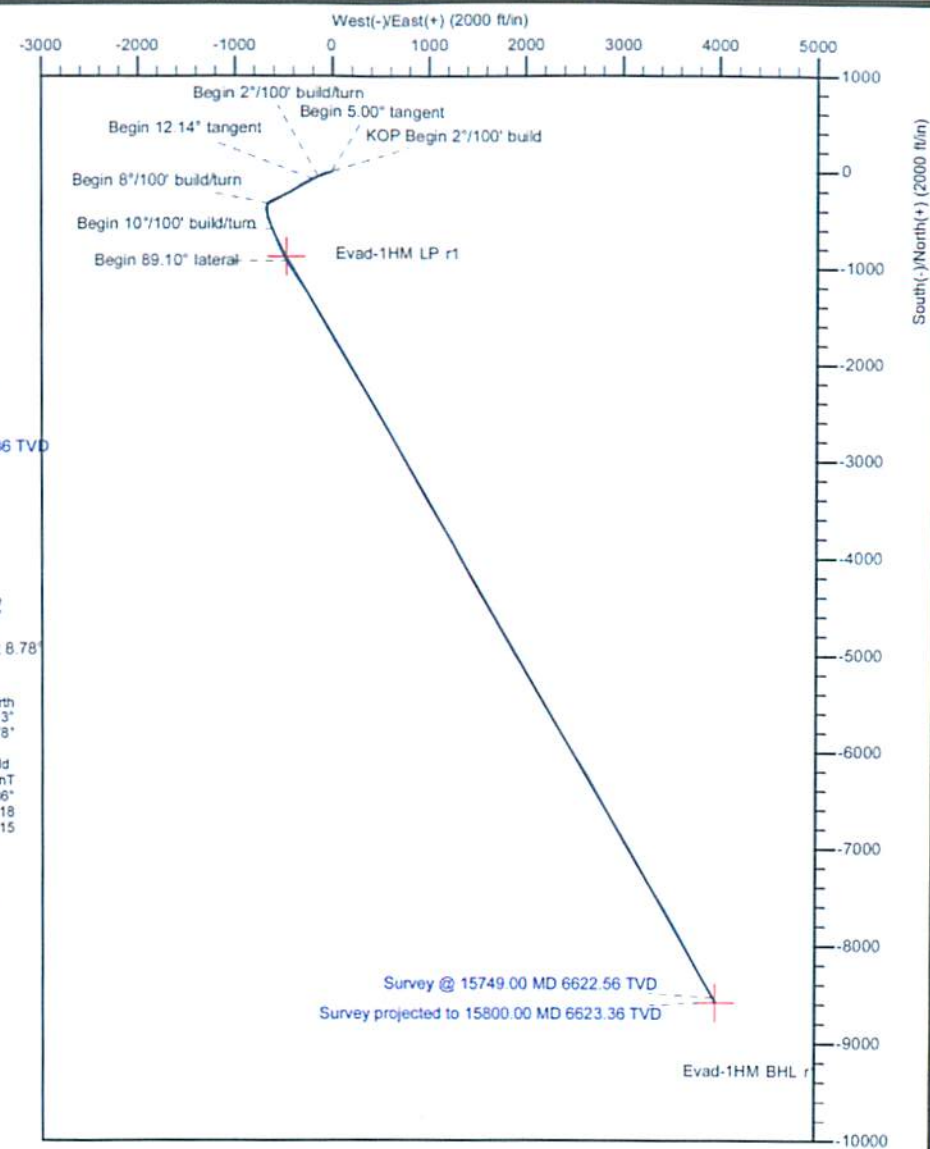
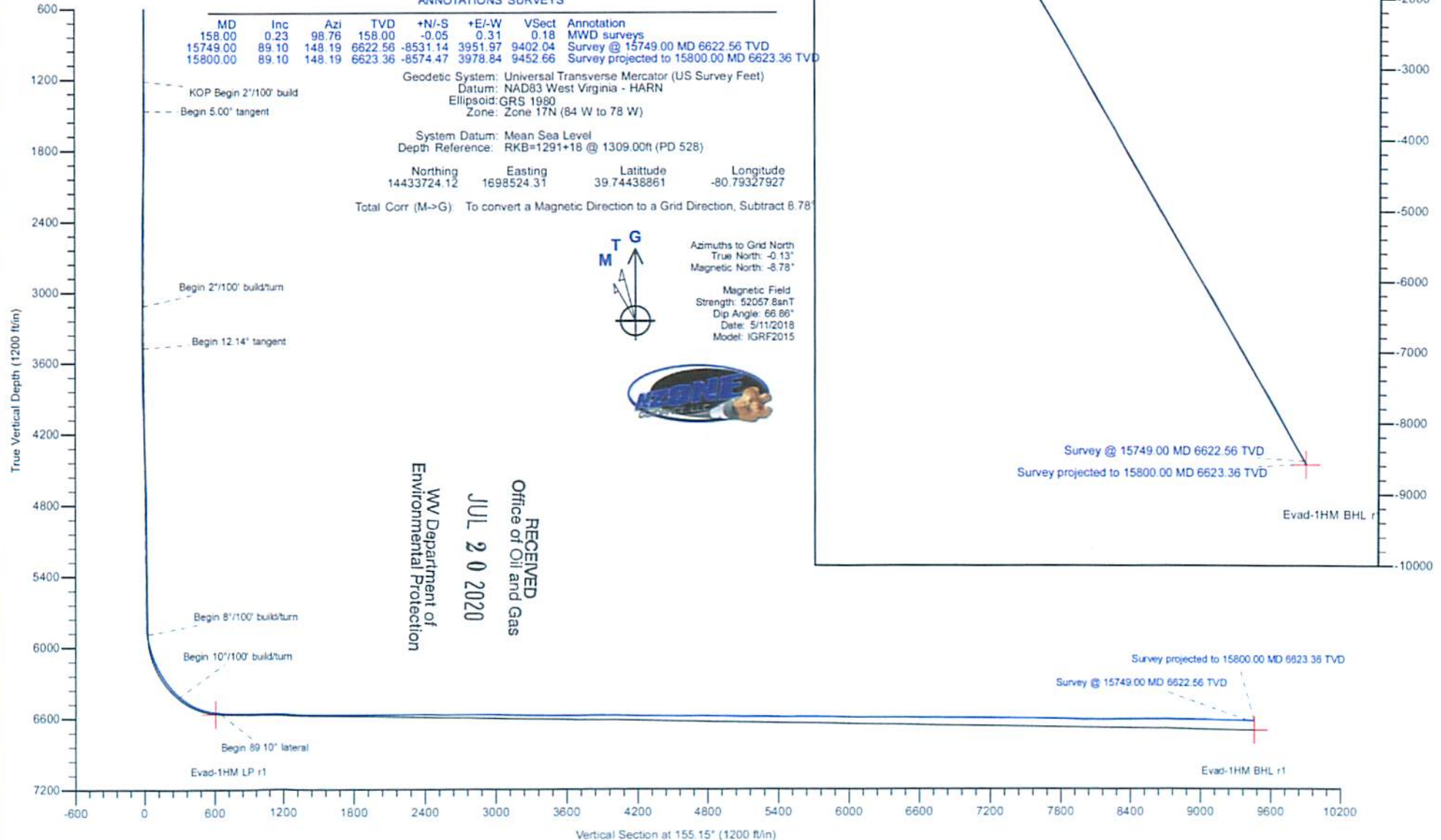

Hydraulic Fracturing Fluid Product Component Information Disclosure

Job Start Date:	11/14/2019
Job End Date:	11/25/2019
State:	West Virginia
County:	Marshall
API Number:	47-051-02056-00-00
Operator Name:	Tug Hill Operating, LLC
Well Name and Number:	Evad 1HM
Latitude:	39.74438860
Longitude:	-80.79327920
Datum:	NAD83
Federal Well:	NO
Indian Well:	NO
True Vertical Depth:	6,615
Total Base Water Volume (gal):	19,096,557
Total Base Non Water Volume:	0

RECEIVED
Office of Oil and Gas

JUL 20 2020

WV Department of
Environmental Protection



Hydraulic Fracturing Fluid Composition:

Trade Name	Supplier	Purpose	Ingredients	Chemical Abstract Service Number (CAS #)	Maximum Ingredient Concentration in Additive (% by mass)**	Maximum Ingredient Concentration in HF Fluid (% by mass)**	Comments
Produced Mixture	Halliburton	Base Fluid					
			Water	7732-18-5	100.00000	88.38106	Density = 8.50
Ingredients	Listed Above	Listed Above					
			Water	7732-18-5	100.00000	0.34333	

Sand-Premium White-40/70	Halliburton	Proppant					
				Listed Below			
HYDROCHLORIC ACID, 22 BAUME	Halliburton	Solvent					
				Listed Below			
Sand-Premium White-30/50	Halliburton	Proppant					
				Listed Below			
FDP-S1296-17	Halliburton	Acid Corrosion Inhibitor					
				Listed Below			
LEGEND(TM) LD-7750W	MultiChem	Scale Control					
				Listed Below			
Sand-Common White-100 Mesh, SSA-2	Halliburton	Proppant					
				Listed Below			
MC MX 8-4743	MultiChem	Additive					
				Listed Below			
OilPerm A	Halliburton	Non-ionic Surfactant					
				Listed Below			
LD-2950	MultiChem	Friction Reducer					

RECEIVED
Office of Oil and Gas

JUL 20 2020

WV Department of
Environmental Protection

				Listed Below			
Items above are Trade Names with the exception of Base Water . Items below are the individual ingredients.							
			Crystalline silica, quartz	14808-60-7	100.00000	11.23644	
			Hydrochloric acid	7647-01-0	30.00000	0.07244	
			Complex Amine Compound	Proprietary	60.00000	0.05754	
			Hydrotreated light petroleum distillate	64742-47-8	30.00000	0.02877	
			Sodium nitrate	7631-99-4	60.00000	0.02226	
			Methanol	67-56-1	100.00000	0.00561	
			Ethoxylated alcohols	Proprietary	5.00000	0.00479	
			Sodium molybdate	10102-40-6	5.00000	0.00186	
			Adipic acid	124-04-9	1.00000	0.00096	
			Poly(oxy-1,2-ethanediyl), alpha-tridecyl-omega-hydroxy-, branched	69011-36-5	1.00000	0.00096	
			Sodium chloride	7647-14-5	5.00000	0.00047	
			Phosphoric Acid Salt	Proprietary	5.00000	0.00043	
			Ethanol	64-17-5	60.00000	0.00025	
			Heavy aromatic petroleum naphtha	64742-94-5	30.00000	0.00012	
			Oxyalkylated nonyl phenolic resin	Proprietary	30.00000	0.00012	
			Modified thiourea polymer	Proprietary	30.00000	0.00012	
			Mixture of dimer and trimer fatty acids of indefinite composition derived from tall oil	61790-12-3	30.00000	0.00012	
			Oxyalkylated phenolic resin	Proprietary	10.00000	0.00004	
			Yeast extract	8013-01-2	0.10000	0.00004	
			Sodium acetate	127-09-3	0.10000	0.00004	
			Monopotassium phosphate	7778-77-0	0.10000	0.00004	
			Sodium lactate	72-17-3	0.10000	0.00004	

RECEIVED
 Office of Oil and Gas
 JUL 20 2020
 WV Department of
 Environmental Protection

			Poly(oxy-1,2-ethanediyl), alpha-(4-nonylphenyl)- omega-hydroxy-, branched	127087-87-0	5.00000	0.00002	
			Naphthalene	91-20-3	5.00000	0.00002	
			Hexadecene	629-73-2	5.00000	0.00002	
			Propargyl alcohol	107-19-7	5.00000	0.00002	
			Ethoxylated alcohols	Proprietary	5.00000	0.00002	
			Formaldehyde	50-00-0	0.10000	0.00001	
			1,2,4 Trimethylbenzene	95-63-6	1.00000	0.00000	

* Total Water Volume sources may include various types of water including fresh water, produced water, and recycled water

** Information is based on the maximum potential for concentration and thus the total may be over 100%

*** If you are calculating a percentage of total ingredients do not add the water volume below the green line to the water volume above the green line

Note: For Field Development Products (products that begin with FDP), MSDS level only information has been provided.

Ingredient information for chemicals subject to 29 CFR 1910.1200(i) and Appendix D are obtained from suppliers Material Safety Data Sheets (MSDS)

RECEIVED
Office of Oil and Gas

JUL 20 2020

WV Department of
Environmental Protection

EVAD LEASE WELL 1HM 708.59± ACRES

(+) DENOTES LOCATION ON UNITED STATES TOPOGRAPHIC MAPS

TOP HOLE LATITUDE: 39°45'00"
BOTTOM HOLE LATITUDE: 39°45'00"

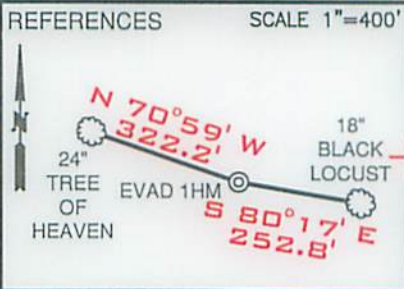

DETAIL SKETCH "A" SCALE 1"=100'



GRID NORTH

- NOTES
- BORE PATH BASED ON GRID NORTH.
 - NO WATER WELLS WITHIN 250' OF WELL WERE FOUND, NO DWELLINGS WITHIN 625' OF PAD CENTER WERE FOUND.
 - OWNERSHIP TAKEN FROM PUBLIC RECORDS OF MARSHALL COUNTY, WV IN MARCH, 2017. COORDINATES AND WELL TIES BASED UPON DIFFERENTIAL GPS MEASUREMENTS.
 - WELL LOCATION REFERENCES ARE BASED UPON THE MAGNETIC MERIDIAN.

LINE	BEARING	DISTANCE
L1	N 01°37' E	2920.25'
L2	N 40°45' E	2164.85'
L3	S 65°50' W	35.28'
L4	S 67°01' W	45.28'
L5	S 61°47' W	133.89'
L6	S 64°35' W	105.87'
L7	S 24°17' E	93.49'
L8	N 81°28' W	411.13'

LEGEND

- LEASED TRACTS
- SURFACE TRACTS
- UNIT BOUNDARY
- (A) LEASE # (SEE 6A1 FORM)

CURVE	CHORD BEARING	CHORD LENGTH	RADIUS	ARC LENGTH
C1	S 76°33' W	23.31'	28.87'	23.99'
C2	S 79°54' W	38.16'	72.48'	38.62'
C3	S 69°04' W	64.12'	363.15'	64.21'
C4	S 61°26' W	265.29'	948.59'	266.16'
C5	S 25°28' W	91.08'	82.94'	96.42'
C6	S 15°10' E	179.62'	503.46'	180.59'
C7	S 21°13' E	236.51'	5400.10'	236.53'
C8	S 29°23' E	167.17'	1409.45'	167.27'

SURFACE HOLE
UTM. NAD83, ZONE 17
IN METERS
N) 4,399,407.88
E) 517,711.36

LANDING POINT 1
UTM. NAD83, ZONE 17
IN METERS
N) 4,399,098.09
E) 517,586.49

BOTTOM HOLE
UTM. NAD83, ZONE 17
IN METERS
N) 4,396,794.38
E) 518,924.11

FILE NUMBER _____
DRAWING NUMBER EVAD_WP_1HM
SCALE 1" = 2000'
MINIMUM DEGREE OF ACCURACY 1/200
PROVEN SOURCE OF ELEVATION SUBMETER MAPPING
GRADE GPS

I, THE UNDERSIGNED, HEREBY CERTIFY THAT THIS PLAT IS CORRECT TO THE BEST OF MY KNOWLEDGE AND BELIEF AND SHOWS ALL THE INFORMATION REQUIRED BY LAW AND THE RULES ISSUED AND PRESCRIBED BY THE DEPARTMENT OF ENVIRONMENTAL PROTECTION

David L Jackson

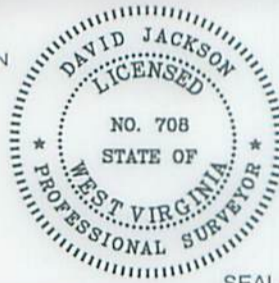

JACKSON SURVEYING INC.
P.O. Box 1460
Clarksburg, WV 26302
304-623-5851

WVDEP
OFFICE OF OIL & GAS
601 57TH STREET, SE
CHARLESTON, WV 25304

WELL TYPE: OIL ___ GAS X LIQUID INJECTION ___ WASTE DISPOSAL ___
(IF "GAS") PRODUCTION X STORAGE ___ DEEP ___ SHALLOW X
DATE: July 8, 2020
OPERATORS WELL NO. EVAD 1HM
API WELL NO. 47-051-02056
STATE COUNTY PERMIT

LOCATION ELEVATION 1280.7' WATERSHED (HUC 10) FRENCH CREEK - OHIO RIVER
DISTRICT FRANKLIN COUNTY MARSHALL
QUADRANGLE NEW MARTINSVILLE 7.5' LEASE NUMBER SEE WW-6A1 Form

SURFACE OWNER LOUIS J. & PATRICIA ACCETTOLO ET AL ACREAGE 146.66
OIL & GAS ROYALTY OWNER SEE WW-6A1 Form LEASE ACREAGE 146.66
PROPOSED WORK: DRILL ___ CONVERT ___ DRILL DEEPER ___ REDRILL ___ FRACTURE OR STIMULATE ___ PLUG OFF OLD FORMATION ___
PERFORATE NEW FORMATION ___ OTHER PHYSICAL CHANGE (SPECIFY) ASDRILLED
PLUG & ABANDON ___ CLEAN OUT & REPLUG ___
TARGET FORMATION MARCELLUS ESTIMATED DEPTH TVD 6,623' TMD: 15,800'
WELL OPERATOR TUG HILL OPERATING, LLC DESIGNATED AGENT DIANNA STAMPER
ADDRESS 1320 SOUTH UNIVERSITY DRIVE, SUITE 500 ADDRESS 5400 D BIG TYLER ROAD
FORT WORTH, TX 76107 CHARLESTON, WV 25313

COUNTY NAME
PERMIT

**EVAD LEASE
WELL 1HM
708.59± ACRES**

SURFACE HOLE UTM. NAD83, ZONE 17 IN METERS N) 4,399,407.91 E) 517,711.25
LANDING POINT 1 UTM. NAD83, ZONE 17 IN METERS N) 4,399,137.94 E) 517,568.06
BOTTOM HOLE UTM. NAD83, ZONE 17 IN METERS N) 4,396,792.60 E) 518,922.73

Number	TAX MAP -PARCEL	ADJOINER OWNER	ACRES
S1	05-22-7.1	The Exploration II LLC & Antinum Marcellus I LLC	20.68
S2	05-22-8	PPG Industries Inc.	48.44
S3	05-22-6	CNX RCPC LLC	64.7
S4	05-22-5	CNX RCPC LLC	134.425
S5	05-22-5.1	Williams Ohio Valley Midstream LLC	12.875
S6	05-19-18	Mark E. Yoho Et Ux	55.948
S7	05-18-21.2	David P. Lassar Et Ux - Life	1.0
S8	05-23-2.1	William L. & Janice M. Wayne	2.364
S9	05-23-2.2	Jessica N. & Andrew L. Jones	7.636
S10	05-23-4.2	James S. & Jeanne B. Hall	1.169
S11	05-23-4.1	James S. & Jeanna B. Hall	2.1575
S12	05-23-16	Roy Friend Yoho Sr.	18.03
S13	05-23-16.1	Doanld B. Henry	1.97
S14	05-23-15	Henry Virginia Ethel Est.	15.5
S15	05-23-9.2	Linda D. Greathouse	25.58
S16	05-23-9.4	Jackson R. Davis Sr. & Deanna L. Davis	2.087
S17	05-23-9.1	John W. Van Orden Et Ux	23.376
S18	05-23-13	Linda D. Greathouse	14.24
S19	05-23-12	Mark A. Yoho	3.05
S20	05-25-18	Joseph Johnson Et Ux - Life	37.746
S21	05-25-18.1	Pamela Joan Ferrel Et Vir	2.491
S22	05-23-8	Carl David & Suzanne L. Guseman	29.5
S23	05-23-18	Abe J. Hochstetler	35.382
S24	05-23-13.1	James R. & Pamela J. Ferrel	0.7625
S25	05-23-11.3	Colin R. Yoho	11.29
S26	05-23-11.5	Zachary R. Stevey	9.25
S27	05-23-11.2	Evelyn Hudson	1.154
S28	05-23-11	Roy F. Yoho	5.28
S29	05-25-20.3	James A. & Jo C. Estep	4.49
S30	05-25-19	Joseph Johnson Et Ux - Life	1.973
S31	05-25-17	Emily Jones Irrevocable Trust	22.79
S32	05-25-16	Emily Jones Irrevocable Trust	23.5
S33	05-26-12.1	Alvin F. Stoneking Jr. & Kristen R. Stoneking	2.011
S34	05-26-14	Robert D. & Bonnie L. Oliver Family Trust	27.56
S35	05-26-9	Robert D. & Bonnie L. Oliver Family Trust	21.75
S36	05-26-23	Richard Joseph Otte Et Ux	11.34
S37	05-26-8	Richard Joseph Otte Et Ux	18.27
S38	05-26-20	Doanld Lee Anderson Et Al	4.2
S39	05-26-22	Richard Joseph Otte Et Ux	8.3
S40	05-26-21	Richard Josphe Otte Et Ux	1.25
S41	05-23-17.3	William & Catherine Flewelling	5.018
S42	05-23-17	Thomas E. & Tammy Brown	4.62
S43	05-23-17.4	Tammy D. Meadows	2.605
S44	05-23-17.2	Dick Rowan Jr & Carol J. Rowan	14.92
S45	05-23-17.1	Curtis E. Hall Et Ux	10.051
S46	05-23-22	Daniel D. Rhyand & Laurel R. Greene	6.25
S47	05-23-25	Arthur A. Wiley	0.43
S48	05-23-24	Michael J. Wiley Et Al	0.25
S49	05-23-23	Michael J. Wiley Et Al	1.0
S50	05-23-29	James Wiley	0.25
S51	05-23-21	Mark A. & Mark E. Yoho	0.588
S52	05-23-19	Doty Cemetery	1.0
S53	05-23-20	Christian Church	0.17
S54	05-23-18.1	Mark A. Yoho	7.8
S55	05-23-28.2	Mark W. & Carolyn L. Tennant	10.8
S56	05-23-28.1	Troy W. & Erin M. Thomas	1.0
S57	12-02-06	Clifford W. & Alberta B. Johnson	36.0
S58	12-02-05	Clifford W. & Alberta B. Johnson	75.96
S59	12-02-24	Mark Booth, et al	13.1
S60	05-26-18	Eric Jay Booth	94.0
S61	05-26-4.4	Otis F. & Glenda M. Rush	39.436
S62	05-26-4.6	Otis F. Rush, Jr.	12.268
S63	05-26-02	Edwin Booth Anderson & Mark Booth	67.50
S64	05-26-01	Edwin Booth Anderson & Mark Booth	12.94
S65	05-26-06	Ula F. Nelson	70.0
S66	05-26-09	PPG Industries, Inc.	63.44

RECEIVED
Office of Oil and Gas
JUL 20 2020
WV Department of
Environmental Protection



P.S. 708 *David L Jackson*



**TUG HILL
OPERATING**

OPERATOR'S
WELL #: EVAD 1HM
DISTRICT: Franklin
COUNTY: Marshall
STATE: WV
API #: 47-051-02056

WELL PLAT
PAGE 2 OF 2
DATE: *07/08/2020*