

State of West Virginia
Department of Environmental Protection - Office of Oil and Gas
Well Operator's Report of Well Work

API 47-051-02044 County Marshall District Webster
Quad Majorsville Pad Name Castle Black Field/Pool Name N/A
Farm name Eco-Vrindaban, Inc, DBA Goraskshya-Seva & Environm Well Number Castle Black 5UH
Operator (as registered with the OOG) Tug Hill Operating LLC
Address 380 Southpointe Blvd. St. 300 City Canonsburg State PRA Zip 15317

As Drilled location NAD 83/UTM Attach an as-drilled plat, profile view, and deviation survey
Top hole Northing 4,424,211.95 Easting 532,705.51
Landing Point of Curve Northing _____ Easting _____
Bottom Hole Northing _____ Easting _____

Elevation (ft) 1,042.9' GL Type of Well New Existing Type of Report Interim Final
Permit Type Deviated Horizontal Horizontal 6A Vertical Depth Type Deep Shallow
Type of Operation Convert Deepen Drill Plug Back Redrilling Rework Stimulate
Well Type Brine Disposal CBM Gas Oil Secondary Recovery Solution Mining Storage Other _____
Type of Completion Single Multiple Fluids Produced Brine Gas NGL Oil Other _____
Drilled with Cable Rotary

Drilling Media Surface hole Air Mud Fresh Water Intermediate hole Air Mud Fresh Water Brine
Production hole Air Mud Fresh Water Brine
Mud Type(s) and Additive(s)

Date permit issued 10/01/2018 Date drilling commenced 05/18/2019 Date drilling ceased 05/18/2019
Date completion activities began _____ Date completion activities ceased _____
Verbal plugging (Y/N) N/A Date permission granted _____ Granted by _____

Please note: Operator is required to submit a plugging application within 5 days of verbal permission to plug

Freshwater depth(s) ft N/A Open mine(s) (Y/N) depths _____
Salt water depth(s) ft N/A Void(s) encountered (Y/N) depths N
Coal depth(s) ft N/A Cavern(s) encountered (Y/N) depths N
Is coal being mined in area (Y/N) N

RECEIVED
Office of Oil and Gas
SEP 30 2024
WV Department of
Environmental Protection

APPROVED

Reviewed by:
SG
10/11/2024
10/4/2024

API 47-051 - 02044 Farm name Eco-Vrindaban, Inc, DBA G+ Well number Castle Black 5UH

CASING STRINGS	Hole Size	Casing Size	Depth	New or Used	Grade wt/ft	Basket Depth(s)	Did cement circulate (Y/ N) * Provide details below*
Conductor	36"	30"	40'			N/A	Y
Surface							
Coal							
Intermediate 1							
Intermediate 2							
Intermediate 3							
Production							
Tubing							
Packer type and depth set							

Comment Details _____

CEMENT DATA	Class/Type of Cement	Number of Sacks	Slurry wt (ppg)	Yield (ft ³ /sks)	Volume (ft ³)	Cement Top (MD)	WOC (hrs)
Conductor		71 (Calculated)		1.21	86	0	8
Surface							
Coal							
Intermediate 1							
Intermediate 2							
Intermediate 3							
Production							
Tubing							

Drillers TD (ft) 40' Loggers TD (ft) _____
 Deepest formation penetrated Sand/Shale Plug back to (ft) _____
 Plug back procedure _____

Kick off depth (ft) N/A

Check all wireline logs run caliper density deviated/directional induction
 neutron resistivity gamma ray temperature sonic

Well cored Yes No Conventional Sidewall Were cuttings collected Yes No

DESCRIBE THE CENTRALIZER PLACEMENT USED FOR EACH CASING STRING _____
CONDUCTOR - NONE

RECEIVED
Office of Oil and Gas

SEP 30 2024

WAS WELL COMPLETED AS SHOT HOLE Yes No DETAILS _____

WV Department of
Environmental Protection

WAS WELL COMPLETED OPEN HOLE? Yes No DETAILS _____

WERE TRACERS USED Yes No TYPE OF TRACER(S) USED _____

10/11/2024

Well # CASTLE BLACK 5UH Final Formations API# 47-051-02044				
Formation Name	Drill Top MD (ftGRD)	Drill Top (TVD) (ftGRD)	Drill Btm MD (ftGRD)	Drill Btm (TVD) (ftGRD)
Sand/Shale	1	1	40	40

RECEIVED
Office of Oil and Gas
SEP 30 2024
WV Department of
Environmental Protection

10/11/2024

CASTLE BLACK 5UH 47-051-02044 (AS-DRILLED)

LATITUDE 40°00'00"

LONGITUDE 80°35'00"

11,866' AS DRILLED

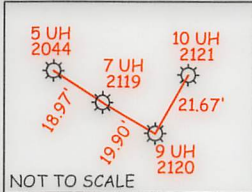

15-1-6.3
KENNETH L. MERINAR, ET AL
16.961 AC± (ASSESSED)

CASTLE BLACK 5UH
47-057-02044
(AS DRILLED)

BURCH RUN

S 80°08' W
1879.64'

S 74°32' E
1835.51'

5/8" REBAR FOUND

15-1-20
GEETA
30 AC± (ASSESSED)

15-1-6
GEETA
89.01 AC± (ASSESSED)

STUMP AT FENCE CORNER

15-1-21
DEBORAH S. WHITLATCH & BRENDA J. HARRIS
13 AC± (ASSESSED)

15-1-19
TATIA J. ROSE
151.503 AC± (ASSESSED)

15-2-2
ISKCON - NEW MATHURA VRINDABAN INC
132.77 AC± (ASSESSED)

(S.P.C. NORTH ZONE) (UTM(M) ZONE 17)
 NAD'83 S.P.C.(FT) N. 536,433.65 E. 1,655,421.06
 NAD'83 GEO. LAT-(N) 39.967425 LONG-(W) 80.617033
 NAD'83 UTM (M) N. 4,424,211.95 E. 532,705.51

NOTES ON SURVEY

1. NO WATER WELLS WERE FOUND WITHIN 250' OF PROPOSED GAS WELL. NO AGRICULTURAL BUILDINGS ≥ 2500 SQ. FT. OR DWELLINGS WERE FOUND WITHIN 625' OF THE CENTER OF PROPOSED WELL PAD.
2. WELL SPOT CIRCLE & TOPO MARK SCALE IS 1"=2000'
3. PURPOSE OF PLAT IS TO SHOW AS-DRILLED LOCATION OF WELL.
4. ONLY THE WELL CONDUCTOR HAS BEEN SET AT THIS TIME.

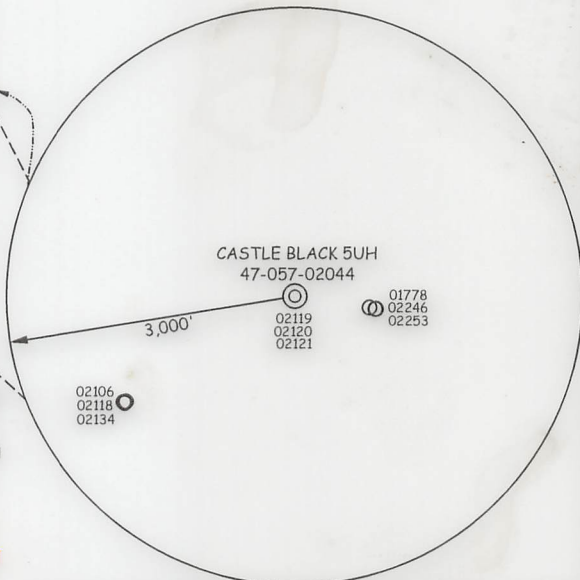

12 Vanhorn Drive | P.O. Box 150 | Glenville, WV 26351 | 304.462.5634
 1412 Kanawha Boulevard, East | Charleston, WV 25301 | 304.346.3952
 254 East Beckley Bypass | Beckley, WV 25801 | 304.255.5296
 slsvv.com

I THE UNDERSIGNED, HEREBY CERTIFY THAT THIS PLAT IS CORRECT TO THE BEST OF MY KNOWLEDGE AND BELIEF AND SHOWS ALL THE INFORMATION REQUIRED BY LAW AND THE REGULATIONS ISSUED AND PRESCRIBED BY THE DIVISION OF ENVIRONMENTAL PROTECTION.

P.S. 677 *Gregory A. Smith*

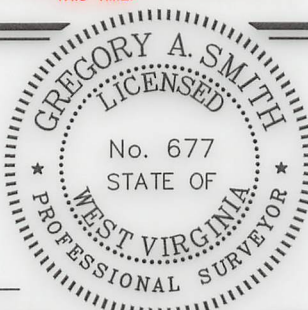

(+) DENOTES LOCATION OF WELL ON UNITED STATES TOPOGRAPHIC MAPS

DATE SEPTEMBER 17, 20 24

REVISED _____, 20 _____

OPERATORS WELL NO. 5 UH

API WELL NO. 47 — 051 — 02044
 STATE COUNTY PERMIT

MINIMUM DEGREE OF ACCURACY 1 / 2500 FILE NO. 9262P5HUADR.dwg
 HORIZONTAL & VERTICAL CONTROL DETERMINED BY: DGPS (SURVEY GRADE TIE TO CORS NETWORK) SCALE 1" = 500'

STATE OF WEST VIRGINIA
 DIVISION OF ENVIRONMENTAL PROTECTION
 OFFICE OF OIL AND GAS



WELL TYPE: OIL ___ GAS X LIQUID INJECTION ___ WASTE DISPOSAL ___ IF "GAS" PRODUCTION X STORAGE ___ DEEP X SHALLOW ___

LOCATION: ELEVATION 1,042.90' WATERSHED WHEELING CREEK-UPPER OHIO RIVER

DISTRICT WEBSTER COUNTY MARSHALL QUADRANGLE MAJORSVILLE 7.5'

SURFACE OWNER GEETA ACREAGE 89.017±

ROYALTY OWNER ECO-VRINDABAN, INC. ACREAGE 89.017±

PROPOSED WORK: DRILL X CONVERT ___ DRILL DEEPER ___ REDRILL ___ FRACTURE OR STIMULATE X PLUG OFF OLD FORMATION ___ PERFORATE NEW FORMATION ___ PLUG AND ABANDON ___ CLEAN OUT AND REPLUG ___ OTHER ___

PHYSICAL CHANGE IN WELL (SPECIFY) ___ TARGET FORMATION POINT PLEASANT

ESTIMATED DEPTH 40'

WELL OPERATOR TUG HILL OPERATING, LLC ADDRESS 1320 SOUTH UNIVERSITY DRIVE, SUITE 500 FORT WORTH, TX 76107
 DESIGNATED AGENT DARREN BROWN CT CORPORATION ADDRESS 5098 WASHINGTON ST. W, STE 407 CHARLESTON, WV 25313-1561

COUNTY NAME

PERMIT

10/11/2024