

Well is located on topo map 15,173 feet south of Latitude: 40° 00' 00"

Well is located on topo map 632 feet west of Longitude: 80° 35' 00"

SURFACE HOLE LOCATION (SHL)
 PAD CENTER EL = 1153.60
 UTM 17 - NAD83
 N: 4423216.155
 E: 535395.557
 NAD27, WY NORTH
 N: 532981.280
 E: 1695628.719
 LAT/LON DATUM-NAD83
 LAT: 39.958345
 LON: -80.585589

APPROX. LANDING POINT
 UTM 17 - NAD83
 N: 4423216.145
 E: 535557.845
 NAD27, WY NORTH
 N: 532978.907
 E: 1696160.706
 LAT/LON DATUM-NAD83
 LAT: 39.958356
 LON: -80.583691

BOTTOM HOLE LOCATION
 UTM 17 - NAD83
 N: 4425143.005
 E: 534742.236
 NAD27, WY NORTH
 N: 539340.189
 E: 1693590.579
 LAT/LON DATUM-NAD83
 LAT: 39.975732
 LON: -80.593135

- NOTES:
1. There are no water wells or developed springs within 250' of proposed well.
 2. There are no existing buildings within 625' of proposed well.
 3. Proposed well is greater than 100' from perennial stream, wetland, pond, reservoir or lake.
 4. There are no native trout streams within 300' of proposed well.
 5. Proposed well is greater than 1000' from surface/groundwater intake or public water supply.
 6. It is not the purpose or intention of this plat to represent surveyed locations of the surface or mineral parcels depicted hereon. The location of the boundary lines, as shown, and based on record deed descriptions, field evidence found and/or tax map position, unless otherwise noted.

LEGEND

- SURFACE HOLE LOCATION
- PROPOSED WELL
- WATER SOURCE
- LEASED NUMBER BASED ON ATTACHED WMA#1 ALL ARE POINTS UNLESS OTHERWISE NOTED
- MINERAL TRACT BOUNDARY
- PARCEL LINES
- PROPOSED HORIZONTAL WELL
- WELL REFERENCE
- STREAM/WATERWAY
- ROAD

WELLS WITHIN 3000'

- EXISTING GAS WELL
- RECORD GAS WELL



LINE TABLE

| LINE | BEARING | DISTANCE |
|------|-------------|----------|
| R1 | N21°41'32"W | 292.72' |
| R2 | N34°25'44"W | 417.57' |
| R3 | S80°34'11"W | 369.42' |
| R4 | N16°15'12"W | 1001.48' |
| R5 | S70°27'18"W | 350.28' |

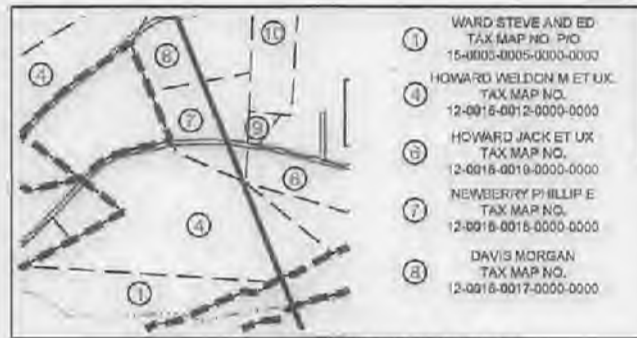

NORTH BONNIE J & GEORGE K GRAY
 TAX MAP NO. 12-0016-0014-0000-0000
 NORTH BONNIE J & GEORGE K GRAY
 TAX MAP NO. 12-0016-0013-0000-0000

FILE #: SHL 27 MHS
 DRAWING #: SHL 27 MHS
 SCALE: 1"=2000'
 MINIMUM DEGREE OF ACCURACY: 1/2500
 PROVEN SOURCE: USGS MONUMENT OF ELEVATION: U 124: 951.16'

I, THE UNDERSIGNED, HEREBY CERTIFY THAT THIS PLAT IS CORRECT TO THE BEST OF MY KNOWLEDGE AND BELIEF AND SHOWS ALL THE INFORMATION REQUIRED BY LAW AND THE REGULATIONS ISSUED AND PRESCRIBED BY THE DEPARTMENT OF ENVIRONMENTAL PROTECTION.

SIGNED:
 R.P.E.: L.L.S.: P.S. NO.



(+) DENOTES LOCATION OF WELL ON UNITED STATES TOPOGRAPHIC MAPS
 WVDEP
 OFFICE OF OIL & GAS
 601 57TH STREET
 CHARLESTON, WV 25304

Well Type: Oil Waste Disposal Production Deep
 Gas Liquid Injection Storage Shallow

WATERSHED: WHEELING CREEK
 COUNTY/DISTRICT: MARSHALL / WEBSTER
 SURFACE OWNER: STEVE WARD AND ED WARD
 OIL & GAS ROYALTY OWNER: BOUNTY MINERALS, LLC



DATE: NOVEMBER 18, 2014 - REV. JULY 20, 2017
 OPERATOR'S WELL #: SHL 27 MHS
 API WELL # 47 051 01990
 STATE COUNTY PERMIT
 H/OA

ELEVATION: 1,153.60'
 QUADRANGLE: MAJORSVILLE, W VA.
 ACREAGE: 122.47

DRILL CONVERT DRILL DEEPER REDRILL FRACTURE OR STIMULATE
 PLUG OFF OLD FORMATION PERFORATE NEW FORMATION PLUG AND ABANDON
 CLEAN OUT & REPLUG OTHER CHANGE (SPECIFY)

TARGET FORMATION: MARCELLUS
 WELL OPERATOR: HG ENERGY II APPALACHIA, LLC
 Address: 5260 DUPONT ROAD
 City PARKERSBURG State WV Zip Code 26101

ESTIMATED DEPTH TVD: 6,203' ± TMD: 13,756' ±
 DESIGNATED AGENT: DIANE C. WHITE
 Address: 5260 DUPONT ROAD
 City PARKERSBURG State WV Zip Code 26101

03/02/2018



Civil Engineering | Land Development | Window Design
 Land Planning | Landscape Architecture | Environmental

Bottom hole is located on topo map 8842 feet south of Latitude: 40° 00' 00"

Bottom hole is located on topo map 2750 Feet west of Longitude: 80° 35' 00"

| | | |
|-----|----------------------------------|------------------------------------|
| 200 | HICKEY GLENN M | TAX MAP NO. 15-0001-0005-0001-0000 |
| 201 | HICKEY GLENN M | TAX MAP NO. 12-0010-0008-0000-0000 |
| 202 | TOLAND DOROTHY J WINNER SANDRA J | TAX MAP NO. 12-0011-0003-0000-0000 |
| 203 | MILLER DOROTHY T ET AL | TAX MAP NO. 12-0011-0004-0000-0000 |
| 204 | GRAY DONALD G & DAVID G | TAX MAP NO. 12-0011-0008-0000-0000 |
| 205 | HILLBERRY PAUL E JR | TAX MAP NO. 12-0011-0009-0003-0000 |
| 210 | HOWARD WELDON M ET UX | TAX MAP NO. 12-0015-0005-0000-0000 |
| 211 | HOWARD WELDON M ET UX | TAX MAP NO. 12-0015-0010-0000-0000 |
| 213 | WHEELING CREEK WATERSHED COMM | TAX MAP NO. 12-0015-0020-0000-0000 |
| 214 | WHEELING CREEK WATERSHED COMM | TAX MAP NO. 12-0015-0022-0000-0000 |
| 220 | KELLER ROBERT LEE & MARY KAY | TAX MAP NO. 15-0003-0004-0002-0000 |
| 221 | ZACHEUS PROPERTIES LLC | TAX MAP NO. 12-0015-0005-0000-0000 |
| 222 | TERRY JOHN G II | TAX MAP NO. 12-0015-0007-0000-0000 |
| 222 | HOWARD WELDON M ET UX | TAX MAP NO. 12-0015-0008-0000-0000 |
| 224 | KUPFER PHILLIP A | TAX MAP NO. 12-0015-0002-0003-0000 |
| 227 | HOWARD WELDON M ET UX | TAX MAP NO. 12-0015-0011-0000-0000 |
| 226 | HOWARD WELDON M ET UX | TAX MAP NO. 12-0015-0012-0001-0000 |
| 233 | HALLER ROY & LISBETH E | TAX MAP NO. 12-0015-0015-0000-0000 |
| 234 | HALLER ROY & LISBETH E | TAX MAP NO. 12-0015-0021-0000-0000 |
| 237 | THOMAS K CLARK | TAX MAP NO. 12-0015-0026-0000-0000 |
| 241 | ISKCON - NEW MATHURA VRINDABAN | TAX MAP NO. 15-0001-0015-0000-0000 |
| 242 | ISKCON - NEW MATHURA VRINDABAN | TAX MAP NO. 15-0001-0012-0000-0000 |
| 243 | ISKCON - NEW MATHURA VRINDABAN | TAX MAP NO. 15-0001-0005-0000-0000 |
| 244 | JAMES L CLEMONS | TAX MAP NO. 12-0015-0029-0000-0000 |
| 245 | JAMES L CLEMONS | TAX MAP NO. 12-0015-0030-0000-0000 |
| 246 | JAMES L CLEMONS | TAX MAP NO. 12-0015-0031-0000-0000 |
| 247 | JAMES L CLEMONS | TAX MAP NO. 12-0015-0032-0000-0000 |
| 248 | RICHARD E HARTLEY SR ET UX | TAX MAP NO. 12-0015-0028-0000-0000 |

LEGEND

- SURFACE HOLE LOCATION
- PROPOSED WELL
- WATER SOURCE
- LEASED NUMBER BASED ON ATTACHED WMSA
ALL ARE POINTS UNLESS OTHERWISE NOTED
- MINERAL TRACT BOUNDARY
- PARCEL LINES
- PROPOSED HORIZONTAL WELL
- WELL REFERENCE
- STREAM/WATERWAY
- ROAD
- BOTTOM HOLE LOCATION

WELLS WITHIN 3000'

- EXISTING GAS WELL
- RECORD GAS WELL

- NOTES:
- There are no water wells or developed springs within 250' of proposed well.
 - There are no existing buildings within 625' of proposed well.
 - Proposed well is greater than 100' from perennial stream, wetland, pond, reservoir or lake.
 - There are no native trout streams within 300' of proposed well.
 - Proposed well is greater than 1000' from surface/groundwater intake or public water supply.
 - It is not the purpose or intention of this plat to represent surveyed locations of the surface or mineral parcels depicted hereon. The location of the boundary lines, as shown, and based on record deed descriptions, field evidence found and/or tax map position, unless otherwise noted.

Wellbore Corporate Park 16, Suite 101
2000 Georgetown Drive
Shelley, PA 15143

P: 724-444-1100
F: 724-444-1524
www.pve.com



Civil Engineering | Land Development | Structure Design
Land Planning | Landscape Architecture | Environmental

FILE #: SHL 27 MHS

DRAWING #: SHL 27 MHS

SCALE: 1"=2000'

MINIMUM DEGREE OF ACCURACY: 1/2500

PROVEN SOURCE USGS MONUMENT
OF ELEVATION U 124: 951.18'

I, THE UNDERSIGNED, HEREBY CERTIFY THAT THIS PLAT IS CORRECT TO THE BEST OF MY KNOWLEDGE AND BELIEF AND SHOWS ALL THE INFORMATION REQUIRED BY LAW AND THE REGULATIONS ISSUED AND PRESCRIBED BY THE DEPARTMENT OF ENVIRONMENTAL PROTECTION.

SIGNED:
R.P.E.: _____ L.L.S.: P.S. NO. _____



(+) DENOTES LOCATION OF WELL ON UNITED STATES TOPOGRAPHIC MAPS
WVDEP
OFFICE OF OIL & GAS
601 57TH STREET
CHARLESTON, WV 25304



DATE: NOVEMBER 18, 2014 - REV JULY 20, 2017

OPERATOR'S WELL #: SHL 27 MHS

API WELL # 47 051 01990
STATE COUNTY PERMIT
HGA

Well Type: Oil Waste Disposal Production Deep
 Gas Liquid Injection Storage Shallow

SHEET: 2 OF 2

WATERSHED: WHEELING CREEK ELEVATION: 1,153.60'

COUNTY/DISTRICT: MARSHALL / WEBSTER QUADRANGLE: MAJORSVILLE, W. VA.

SURFACE OWNER: STEVE WARD AND ED WARD ACREAGE: 122.47

OIL & GAS ROYALTY OWNER: BOUNTY MINERALS, LLC ACREAGE: 122.47

03/02/2018

DRILL CONVERT DRILL DEEPER REDRILL FRACTURE OR STIMULATE
PLUG OFF OLD FORMATION PERFORATE NEW FORMATION PLUG AND ABANDON
CLEAN OUT & REPLUG OTHER CHANGE (SPECIFY)

TARGET FORMATION: MARCELLUS ESTIMATED DEPTH: TVD: 6,203' ± TMD: 13,756' ±

WELL OPERATOR: HG ENERGY II APPALACHIA, LLC DESIGNATED AGENT: DIANE C. WHITE

Address: 5280 DUPONT ROAD

City PARKERSBURG State WV Zip Code 26101 City PARKERSBURG State WV Zip Code 26101