

Well is located on topo map 15,143 feet south of Latitude: 40° 00' 00"

Well is located on topo map 629

feet west of Longitude: 80° 35' 00"

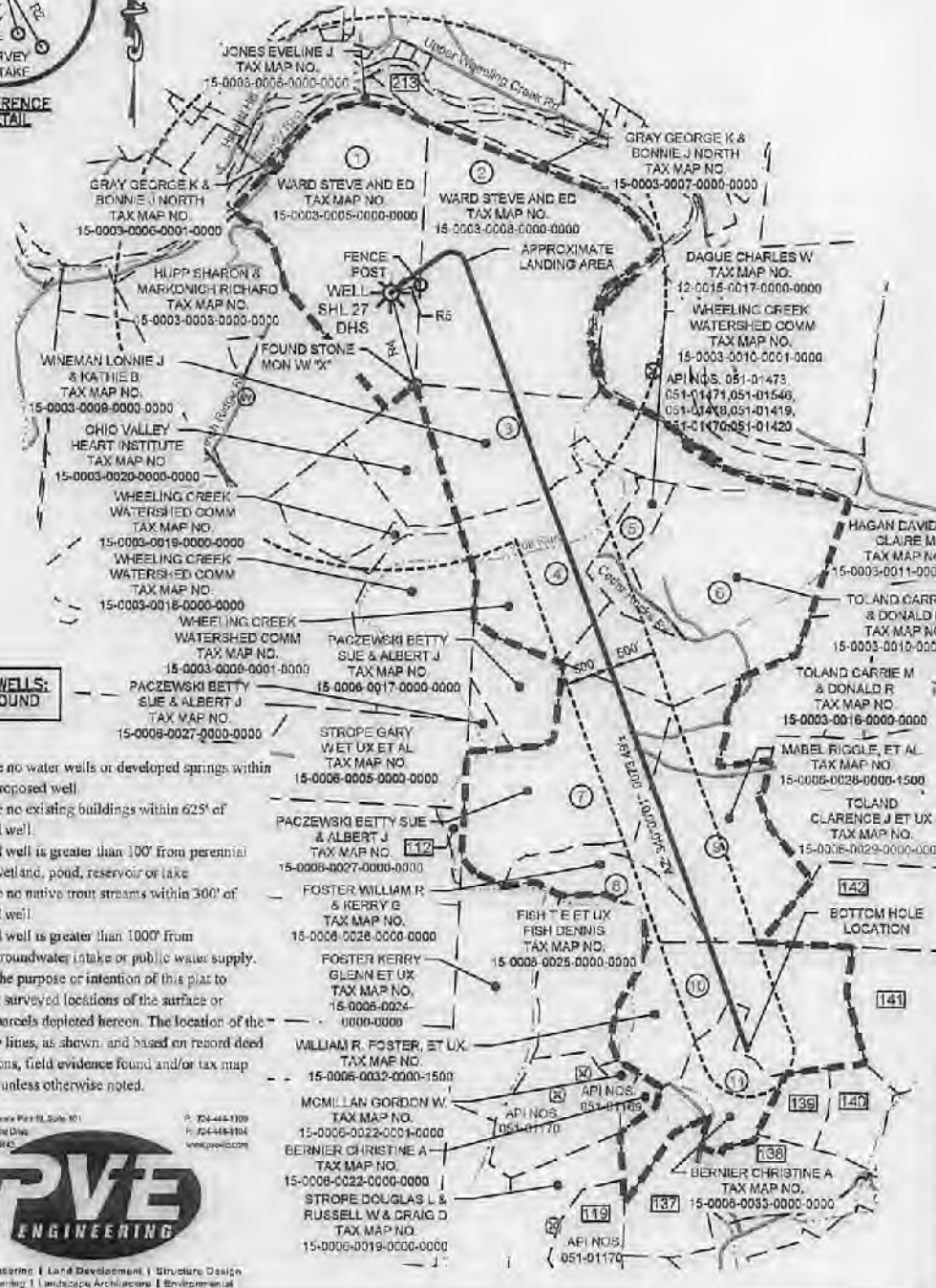

SURFACE HOLE LOCATION (SHL)
 PAD CENTER EL. = 1153.60
 UTM 17 - NAD83
 N: 4423225.419
 E: 535396.218
 NAD27, WV NORTH
 N: 533011.642
 E: 1695631.398
 LAT/LON DATUM=NAD83
 LAT: 39.958429
 LON: -80.585581

APPROX. LANDING POINT
 UTM 17 - NAD83
 N: 4423332.811
 E: 535642.051
 NAD27, WV NORTH
 N: 533350.544
 E: 1696443.962
 LAT/LON DATUM=NAD83
 LAT: 39.959386
 LON: -80.582697

BOTTOM HOLE LOCATION
 UTM 17 - NAD83
 N: 4420751.042
 E: 536630.945
 NAD27, WV NORTH
 N: 524824.077
 E: 1699547.341
 LAT/LON DATUM=NAD83
 LAT: 39.936083
 LON: -80.571264

LINE TABLE

LINE	BEARING	DISTANCE
R1	N15°52'34"W	326.58'
R2	N25°20'17"W	449.66'
R3	S75°08'53"W	338.71'
R4	N15°08'15"W	1029.94'
R5	S75°08'53"W	338.71'

LEGEND

- SURFACE HOLE LOCATION
- PROPOSED WELL
- WATER SOURCE
- LEASED NUMBER BASED ON ATTACHED WMS&I
- ALL ARE POINTS UNLESS OTHERWISE NOTED
- MINERAL TRACT BOUNDARY
- PARCEL LINES
- PROPOSED HORIZONTAL WELL
- WELL REFERENCE
- STREAM/WATERWAY
- ROAD

WELLS WITHIN 3000'

- EXISTING GAS WELL
- RECORD GAS WELL

WATER WELLS: NONE FOUND

NOTES:

1. There are no water wells or developed springs within 250' of proposed well.
2. There are no existing buildings within 625' of proposed well.
3. Proposed well is greater than 100' from perennial stream, wetland, pond, reservoir or lake.
4. There are no native trout streams within 300' of proposed well.
5. Proposed well is greater than 1000' from surface/groundwater (stake or public water supply).
6. It is not the purpose or intention of this plan to represent surveyed locations of the surface or mineral parcels depicted herein. The location of the boundary lines, as shown, and based on record deed descriptions, field evidence found and/or tax map position, unless otherwise noted.

Waterford Corporate Park II, Site 101
 2600 Gallopstone Drive
 Sewersburg, PA, 15143

P: 724-444-1100
 F: 724-444-1104
 www.pve.com

Civil Engineering | Land Development | Structures Design
 Land Planning | Landscape Architecture | Environmental

FILE #: SHL 27 DHS
 DRAWING #: SHL 27 DHS
 SCALE: 1"=2000'
 MINIMUM DEGREE OF ACCURACY: 1/2500
 PROVEN SOURCE: USGS MONUMENT OF ELEVATION: U 124: 951.16'

I, THE UNDERSIGNED, HEREBY CERTIFY THAT THIS PLAT IS CORRECT TO THE BEST OF MY KNOWLEDGE AND BELIEF AND SHOWS ALL THE INFORMATION REQUIRED BY LAW AND THE REGULATIONS ISSUED AND PRESCRIBED BY THE DEPARTMENT OF ENVIRONMENTAL PROTECTION.

SIGNED:

R.P.E.: 18766 L.L.S.: P.S. NO.



(+) DENOTES LOCATION OF WELL ON UNITED STATES TOPOGRAPHIC MAPS WVDEP OFFICE OF OIL & GAS 601 57TH STREET CHARLESTON, WV 25304

Well Type: Oil Waste Disposal Production Deep Gas Liquid Injection Storage Shallow SHEET: 1 OF 2

WATERSHED: WHEELING CREEK ELEVATION: 1,153.60'
 COUNTY/DISTRICT: MARSHALL / WEBSTER QUADRANGLE: MAJORSVILLE, W. VA
 SURFACE OWNER: STEVE WARD AND ED WARD ACREAGE: 122.47
 OIL & GAS ROYALTY OWNER: BOUNTY MINERALS, LLC ACREAGE: 122.47

DATE: OCTOBER 16, 2014 - REV. JULY 20, 2017
 OPERATOR'S WELL #: SHL 27 DHS
 API WELL # 47 051 01987
 STATE COUNTY PERMIT H6A

DRILL CONVERT DRILL DEEPER REDRILL FRACTURE OR STIMULATE
 PLUG OFF OLD FORMATION PERFORATE NEW FORMATION PLUG AND ABANDON
 CLEAN OUT & REPLUG OTHER CHANGE (SPECIFY)

TARGET FORMATION: MARCELLUS ESTIMATED DEPTH: TVD: 6,203' ± TMD: 15,937' ±
 WELL OPERATOR: HG ENERGY II APPALACHIA, LLC DESIGNATED AGENT: DIANE C. WHITE
 Address: 5260 DUPONT ROAD Address: 5260 DUPONT ROAD
 City PARKERSBURG State WV Zip Code 26101 City PARKERSBURG State WV Zip Code 26101

03/02/2018

Bottom hole is located on topo map 8105 feet south of Latitude: 39° 57' 30"

Bottom hole is located on topo map 8292 feet west of Longitude: 80° 37' 30"

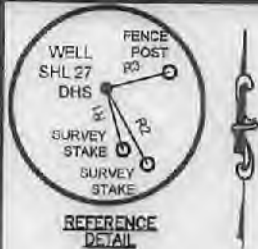

112	WHEELING CREEK WATERSHED COMM	TAX MAP NO. 15-0006-0006-0000-0000
119	KUTIS JOHN S & SYLVIA M	TAX MAP NO. 15-0006-0020-0000-0000
125	TOLAND CARRIE M & DONALD R	TAX MAP NO. 15-0003-0010-0000-0000
137	KUTIS JOHN S & SYLVIA M	TAX MAP NO. 15-0006-0021-0000-0000
138	BUSH KENNETH ROGER & JERI LYNN	TAX MAP NO. 15-0006-0035-0000-0000
139	BERNIER CHRISTINE A	TAX MAP NO. 15-0006-0034-0000-0000
140	BUSH KENNETH ROGER & JERI LYNN	TAX MAP NO. 15-0006-0050-0000-0000
141	BUSH KENNETH ROGER & JERI LYNN	TAX MAP NO. 15-0006-0051-0000-0000
142	BUSH KENNETH ROGER & JERI LYNN	TAX MAP NO. 15-0006-0030-0000-0000
213	WHEELING CREEK WATERSHED COMM	TAX MAP NO. 12-0015-0020-0000-0000



WATER WELLS:
NONE FOUND

NOTES:

1. There are no water wells or developed springs within 250' of proposed well.
2. There are no existing buildings within 625' of proposed well.
3. Proposed well is greater than 100' from perennial stream, wetland, pond, reservoir or lake.
4. There are no native trout streams within 300' of proposed well.
5. Proposed well is greater than 1000' from surface/groundwater intake or public water supply.
6. It is not the purpose or intention of this plat to represent surveyed locations of the surface or mineral parcels depicted herein. The location of the boundary lines, as shown, and based on record deed descriptions, field evidence found and/or tax map position, unless otherwise noted.

Waterford Commons Park II, Suite 101
2002 Georgetown Drive
Georgetown, PA 17133

P. 724-444-1100
F. 724-444-1108
www.pve.com



Civil Engineering | Land Development | Structural Design
Land Planning | Landscape Architecture | Environmentals

LINE TABLE		
LINE	BEARING	DISTANCE
R1	N15°52'54"W	325.53'
R2	N29°20'17"W	443.86'
R3	S75°08'53"W	338.71'
R4	N15°39'15"W	1029.94'
R5	S75°08'53"W	338.71'

LEGEND	
	SURFACE HOLE LOCATION
	PROPOSED WELL
	WATER SOURCE
	LEASED NUMBER BASED ON ATTACHED WABA:1
	ALL ARE POINTS UNLESS OTHERWISE NOTED
	MINERAL TRACT BOUNDARY
	PARCEL LINES
	PROPOSED HORIZONTAL WELL
	WELL REFERENCE
	STREAM/WATERWAY
	ROAD
	BOTTOM HOLE LOCATION
WELLS WITHIN 3000'	
	EXISTING GAS WELL
	RECORD GAS WELL

FILE #: SHL 27 DHS
DRAWING #: SHL 27 DHS
SCALE: 1"=2000'
MINIMUM DEGREE OF ACCURACY: 1/2500
PROVEN SOURCE: USGS MONUMENT U 124: 951.18'

I, THE UNDERSIGNED, HEREBY CERTIFY THAT THIS PLAT IS CORRECT TO THE BEST OF MY KNOWLEDGE AND BELIEF AND SHOWS ALL THE INFORMATION REQUIRED BY LAW AND THE REGULATIONS ISSUED AND PRESCRIBED BY THE DEPARTMENT OF ENVIRONMENTAL PROTECTION.

SIGNED:
R.P.E.: 18766 L.L.S.: P.S. NO. _____



(+) DENOTES LOCATION OF WELL ON UNITED STATES TOPOGRAPHIC MAPS
WVDEP
OFFICE OF OIL & GAS
601 57TH STREET
CHARLESTON, WV 25304



DATE: OCTOBER 16, 2014 - REV. JULY 20, 2017

OPERATOR'S WELL #: SHL 27 DHS

API WELL # 47 051 01987
STATE COUNTY PERMIT
H6A

Well Type: Oil Waste Disposal Production Deep
 Gas Liquid Injection Storage Shallow

SHEET: 2 OF 2

WATERSHED: WHEELING CREEK ELEVATION: 1,153.60'
COUNTY/DISTRICT: MARSHALL / WEBSTER QUADRANGLE: MAJORSVILLE, W. VA
SURFACE OWNER: STEVE WARD AND ED WARD ACREAGE: 122.47
OIL & GAS ROYALTY OWNER: BOUNTY MINERALS, LLC ACREAGE: 122.47

03/02/2018

DRILL CONVERT DRILL DEEPER REDRILL FRACTURE OR STIMULATE
PLUG OFF OLD FORMATION PERFORATE NEW FORMATION PLUG AND ABANDON
CLEAN OUT & REPLUG OTHER CHANGE (SPECIFY)

TARGET FORMATION: MARCELLUS ESTIMATED DEPTH: TVD: 6,203' ± TMD: 15,937' ±
WELL OPERATOR: HG ENERGY II APPALACHIA, LLC DESIGNATED AGENT: DIANE C. WHITE
Address: 5260 DUPONT ROAD
City PARKERSBURG State WV Zip Code 26101