

Well is located on topo map 8,476 feet south of Latitude: 39° 52' 30"

Well is located on topo map 3,180 feet west of Longitude: 80° 47' 30"

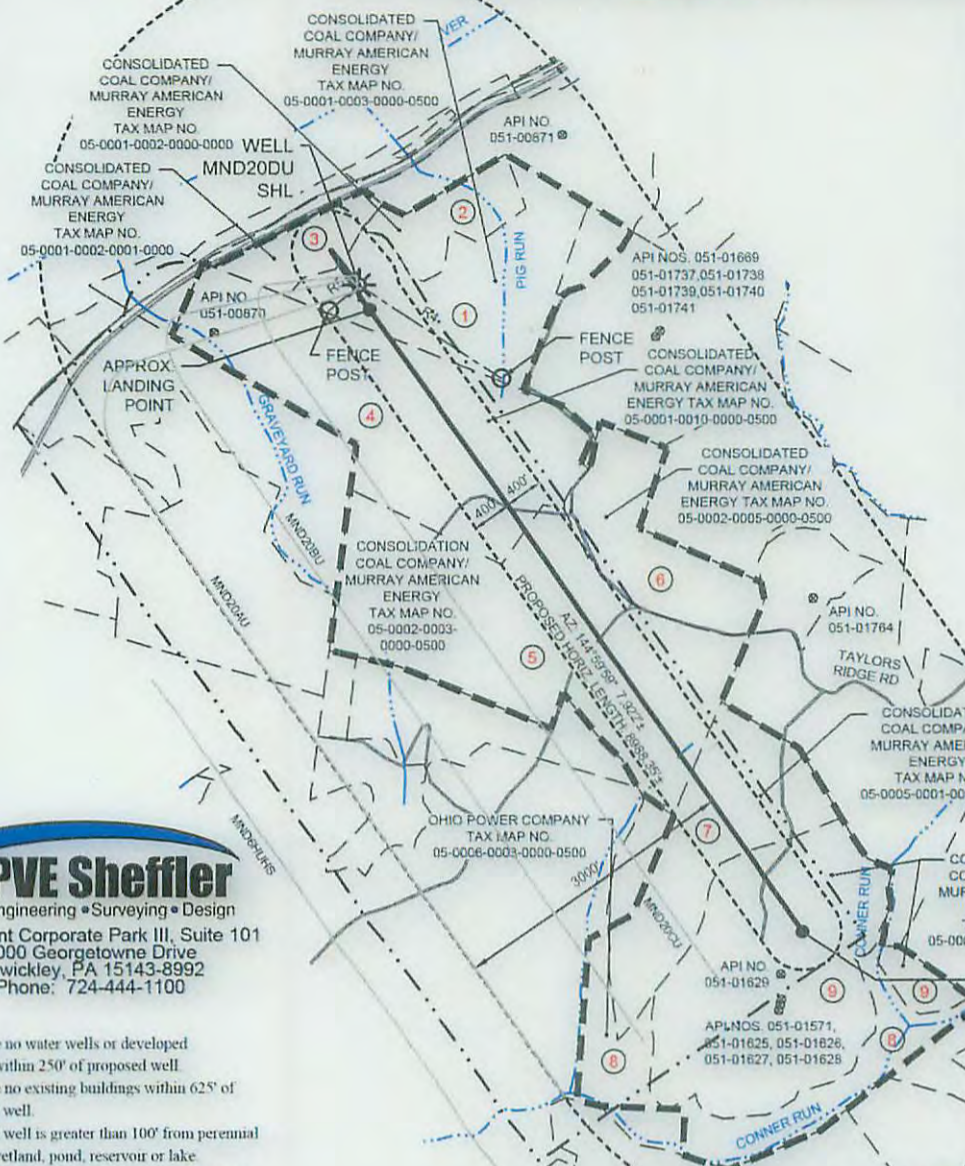

LEGEND

- TOPO MAP POINT
- PROPOSED WELL
- WATER SOURCE
- LEASED NUMBER BASED ON ATTACHED WWS#1 ALL ARE POINTS UNLESS OTHERWISE NOTED
- MINERAL TRACT BOUNDARY
- PARCEL LINES
- PROPOSED HORIZONTAL WELL
- WELL REFERENCE
- STREAM/WATERWAY
- ROAD
- UNIT BOUNDARY
- EXISTING GAS WELL
- TOPO MAP BOTTOM HOLE

LINE TABLE

LINE	BEARING	DISTANCE
R1	N89°03'48"E	317.67'
R2	N83°43'12"W	131.55'
R3	N01°54'08"W	141.25'
R4	N56°34'15"W	1746.79'
R5	N50°07'06"E	407.29'

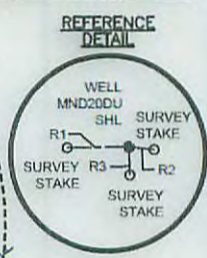

PVE Sheffler
 Engineering • Surveying • Design
 Waterfront Corporate Park III, Suite 101
 2000 Georgetowne Drive
 Sewickley, PA 15143-8992
 Phone: 724-444-1100

- NOTES:**
- There are no water wells or developed springs within 250' of proposed well
 - There are no existing buildings within 625' of proposed well
 - Proposed well is greater than 100' from perennial stream, wetland, pond, reservoir or lake
 - There are no native front streams within 300' of proposed well
 - Proposed well is greater than 1000' from surface/groundwater intake or public water supply.
 - It is not the purpose or intention of this plat to represent surveyed locations of the surface or mineral parcels depicted hereon. The location of the boundary lines, as shown, and based on record deed descriptions, field evidence found and/or tax map position, unless otherwise noted.

WATER WELLS:
NONE FOUND

SURFACE HOLE LOCATION (SHL)	APPROX. LANDING POINT	BOTTOM HOLE LOCATION
UTM 17 - NAD83 N: 4411319.580 E: 516852.621 NAD27, WV NORTH N: 494960.840 E: 1634129.630 LAT/LON DATUM-NAD83 LAT: 39.851731 LON: -80.802995	UTM 17 - NAD83 N: 4411243.842 E: 516886.587 NAD27, WV NORTH N: 494710.440 E: 1634236.940 LAT/LON DATUM-NAD83 LAT: 39.851048 LON: -80.802600	UTM 17 - NAD83 N: 4409315.016 E: 518285.783 NAD27, WV NORTH N: 488304.190 E: 1638722.640 LAT/LON DATUM-NAD83 LAT: 39.833640 LON: -80.786297

FILE #: MND 20 DU
 DRAWING #: MND 20 DU
 SCALE: 1"=2000'
 MINIMUM DEGREE OF ACCURACY: 1/2500
 PROVEN SOURCE OF ELEVATION: U.S.G.S. MONUMENT H 138: 638.58'

I, THE UNDERSIGNED, HEREBY CERTIFY THAT THIS PLAT IS CORRECT TO THE BEST OF MY KNOWLEDGE AND BELIEF AND SHOWS ALL THE INFORMATION REQUIRED BY LAW AND THE REGULATIONS ISSUED AND PRESCRIBED BY THE DEPARTMENT OF ENVIRONMENTAL PROTECTION.

SIGNED:

R.P.E.: 21452 L.L.S.: P.S. NO.



(+) DENOTES LOCATION OF WELL ON UNITED STATES TOPOGRAPHIC MAPS WVDEP OFFICE OF OIL & GAS 601 57TH STREET CHARLESTON, WV 25304



DATE: AUGUST 19, 2015 - REV. OCTOBER 15, 2015
 OPERATOR'S WELL #: MND 20 DU
 API WELL # 47 051 H6A
 STATE COUNTY PERMIT 01870

Well Type: Oil Waste Disposal Production Deep
 Gas Liquid Injection Storage Shallow

WATERSHED: SHORT CREEK-OHIO RIVER ELEVATION: 1078.89'
 COUNTY/DISTRICT: MARSHALL / CLAY QUADRANGLE: POWHATAN POINT, W. VA./OHIO
 SURFACE OWNER: CONSOLIDATION COAL COMPANY/ MURRAY ENERGY ACREAGE: 70.55
 OIL & GAS ROYALTY OWNER: CNX GAS COMPANY ACREAGE: 70.55

DRILL CONVERT DRILL DEEPER REDRILL FRACTURE OR STIMULATE
 PLUG OFF OLD FORMATION PERFORATE NEW FORMATION PLUG AND ABANDON
 CLEAN OUT & REPLUG OTHER CHANGE (SPECIFY)

TARGET FORMATION: POINT PLEASANT ESTIMATED DEPTH: TVD: 10,742' ± TMD: 19,027±
 WELL OPERATOR: NOBLE ENERGY, INC. DESIGNATED AGENT: JESSICA ALSOP
 Address: 1000 NOBLE ENERGY DRIVE Address: 1031 BRETTWALD DRIVE
 City CANONSBURG State PA Zip Code 15317 City MORGANTOWN State WV Zip Code 26508

12/11/2015

NO WATER PURVEYORS WITHIN 1,500'

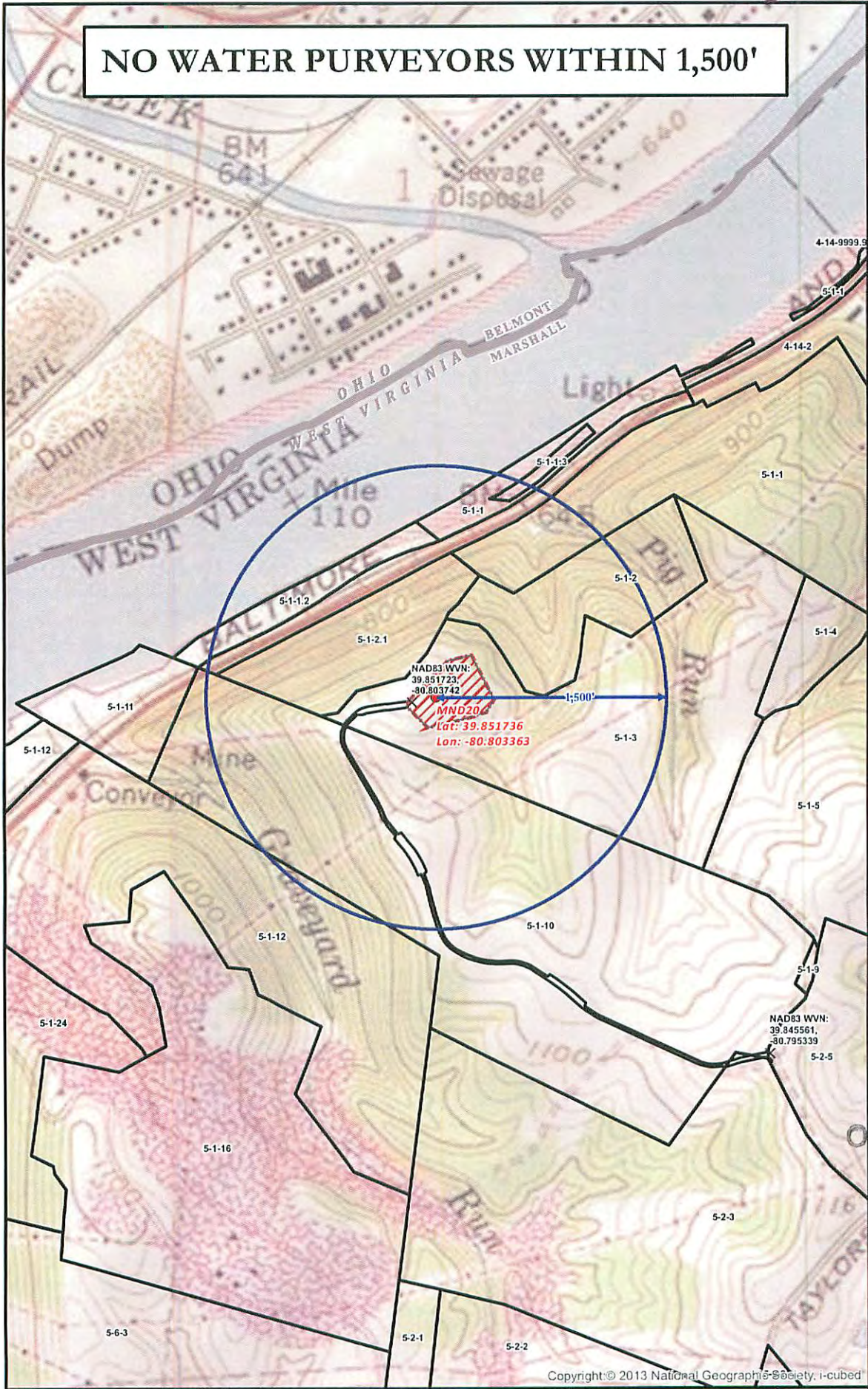

Received
Office of Oil & G
SEP 02 2015

MND 20 SITE SAFETY PLAN - WATER WELL PURVEYORS -

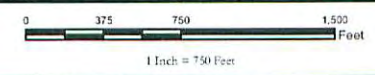

- Well Pad
- ⊕ Casem
- ⊙ Water Well
- X Access Road Intersect
- Well Pad Boundary
- 1500' Water Wells Buffer
- Access Road

Projection: NAD 1927 StatePlane West Virginia North FIPS 4701
Units: Foot US

****Disclaimer: All data is licensed for use by Noble Energy Inc. use only.****



Date: 8/17/2015
Author: Christopher Glover



12/11/2015
6