

Well is located on topo map 6,616 feet south of Latitude: 39° 52' 30"

NOTES:

1. There are no water wells or developed springs within 250' of proposed well.
2. There are no existing buildings within 625' of proposed well.
3. Proposed well is greater than 100' from perennial stream, wetland, pond, reservoir or lake.
4. There are no native trout streams within 300' of proposed well.
5. Proposed well is greater than 1000' from surface/groundwater intake or public water supply.
6. It is not the purpose or intention of this plat to represent surveyed locations of the surface or mineral parcels depicted hereon. The location of the boundary lines, as shown, are based on record deed descriptions, field evidence found and/or tax map position unless otherwise noted.

LINE	BEARING	DISTANCE
R1	S 32°08'58" W	272.53'
R2	N 37°23'19" E	120.40'
R3	N 80°59'38" E	103.42'
R4	N 26°24'35" E	1298.84'
R5	S 85°55'13" E	1092.22'
R6	S 03°41'30" E	1071.24'

Well is located on topo map 5,939 feet west of Longitude: 80° 40' 00"

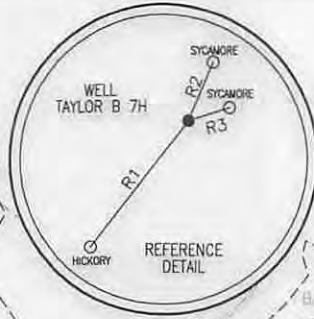

LEGEND

- TOPO MAP POINT
- WELL
- ALL ARE POINTS UNLESS OTHERWISE NOTED.
- MINERAL TRACT BOUNDARY
- PARCEL LINES
- WELL REFERENCE
- PROPOSED HORIZONTAL WELL
- ROAD
- STREAM CENTER LINE
- LESSORS
- SURFACE OWNERS
- GAS WELLS**
- EXISTING WELLS
- PLUGGED WELLS

Blue Mountain Inc.
11023 MASON DIXON HIGHWAY
BURTON, WV 26562
PHONE: (304) 662-6486

SURFACE HOLE LOCATION (SHL)
UTM 17-NAD83(M)
N:4411914.41
E:526703.02
NAD 83, WV NORTH
N:496408.66
E:1635049.09
LAT/LON DATUM-NAD83
LAT:39.856839
LON:-80.687822

APPROX. LANDING POINT
UTM 17-NAD83(M)
N:4411929.19
E:526352.84
NAD 83, WV NORTH
N:496476.36
E:1633900.79
LAT/LON DATUM-NAD83
LAT:39.856981
LON:-80.691914

BOTTOM HOLE LOCATION (BHL)
UTM 17-NAD83(M)
N:4413984.38
E:524631.46
NAD 83, WV NORTH
N:503314.87
E:1628364.81
LAT/LON DATUM-NAD83
LAT:39.875550
LON:-80.711961

SEE PAGE 2 FOR SURFACE OWNERS AND LESSORS

FILE #: TAYLOR B 7H
DRAWING #: TAYLOR B 7H
SCALE: 1" = 2000'
MINIMUM DEGREE OF ACCURACY: 1/2500
PROVEN SOURCE OF ELEVATION: U.S.G.S. MONUMENT THOMAS 1498.81'

I, THE UNDERSIGNED, HEREBY CERTIFY THAT THIS PLAT IS CORRECT TO THE BEST OF MY KNOWLEDGE AND BELIEF AND SHOWS ALL THE INFORMATION REQUIRED BY LAW AND THE REGULATIONS ISSUED AND PRESCRIBED BY THE DEPARTMENT OF ENVIRONMENTAL PROTECTION.

Signed: *George D. Six*
R.P.E.: _____ L.L.S.: P.S. No. 2000

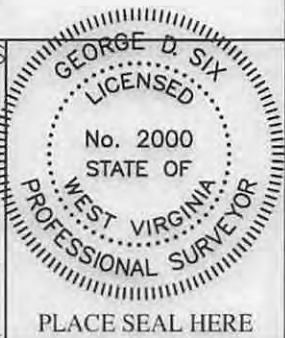

(+) DENOTES LOCATION OF WELL ON UNITED STATES TOPOGRAPHIC MAPS WVDEP
OFFICE OF OIL & GAS
601 57TH STREET
CHARLESTON, WV 25304

DATE: SEPTEMBER 25, 2014
OPERATOR'S WELL #: TAYLOR B 7H
API WELL #: 47 51 01797
STATE COUNTY PERMIT

Well Type: Oil Waste Disposal Production Deep
 Gas Liquid Injection Storage Shallow

WATERSHED: MIDDLE GRAVE CREEK - GRAVE CREEK ELEVATION: 1222.00'
COUNTY/DISTRICT: MARSHALL / CLAY QUADRANGLE: GLEN EASTON, WV 7.5'
SURFACE OWNER: WILLIAMS OHIO VALLEY MIDSTREAM LLC ACREAGE: 91.93±
OIL & GAS ROYALTY OWNER: LEE R. & SHERRI L. TAYLOR ACREAGE: 836.923±

DRILL CONVERT DRILL DEEPER REDRILL FRACTURE OR STIMULATE
PLUG OFF OLD FORMATION PERFORATE NEW FORMATION PLUG & ABANDON
CLEAN OUT & REPLUG OTHER CHANGE (SPECIFY): _____

TARGET FORMATION: MARCELLUS ESTIMATED DEPTH: TVD: 6,533'± TMD: 16,103'±
WELL OPERATOR CHEVRON APPALACHIA, LLC DESIGNATED AGENT KENNETH E. TAWNEY
Address 800 MOUNTAIN VIEW DRIVE Address 500 LEE STREET, EAST SUITE 1600
City SMITHFIELD State PA Zip Code 15478 City CHARLESTON State WV Zip Code 25301-3202

04/10/2015

WATER SUPPLY EXHIBIT TAYLOR UNIT B

4705101797
Blue Mountain Inc.

Date: 9/19/2014

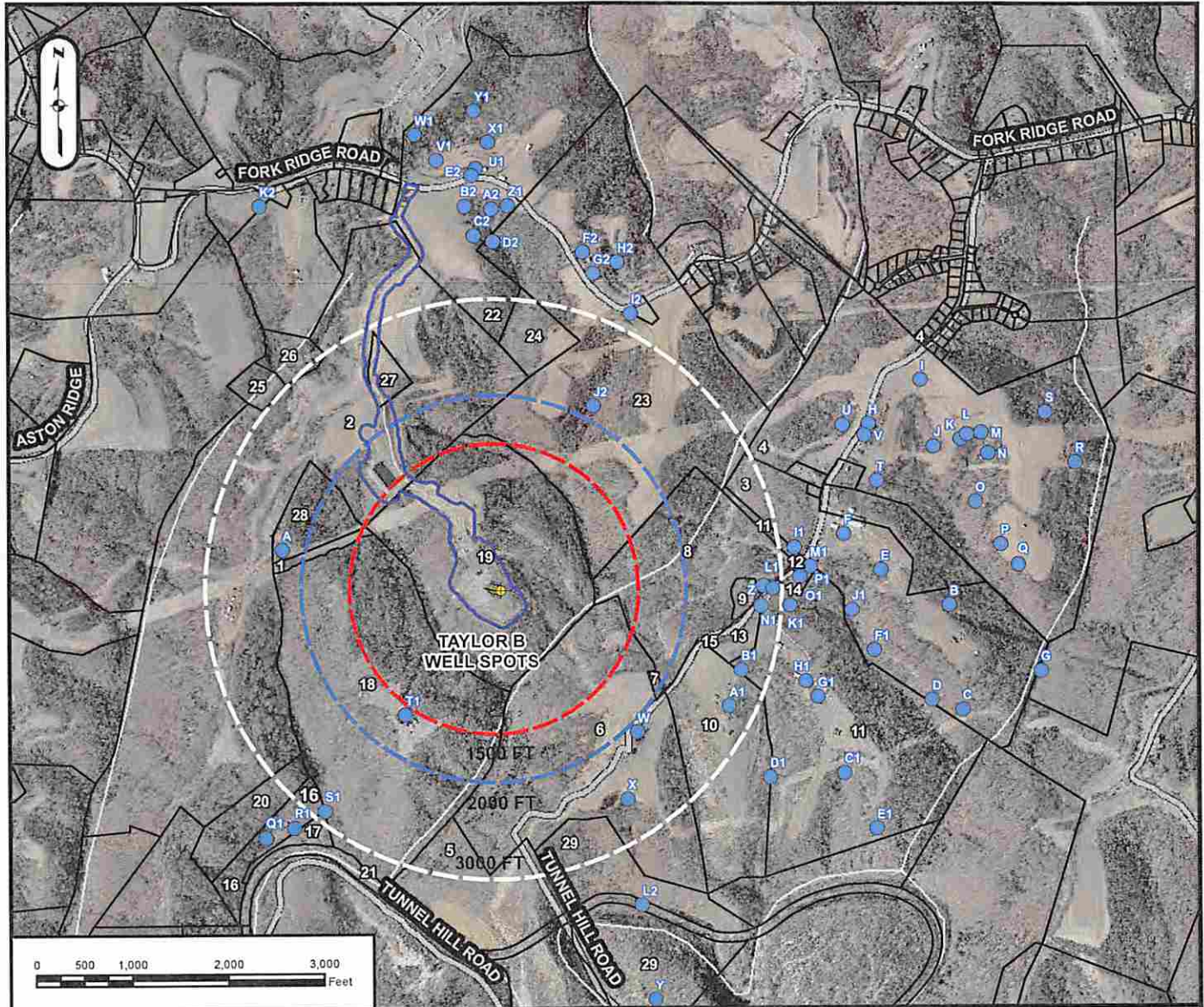

1	Wilson, Cary & Trudy Taylor, Lee et ux	4-10-19.2	9	Kuhn, Howard	3-12-3.1	17	Consolidation Coal Company	4-10-17	25	Aston, Lewis A. Jr. et ux	4-9-23
2	Williams Energy Co. Hudson, Brandy Jo & Douglas	4-10-21	10	Hardman, Mary	3-12-3.2	18	McCarthy, Brendan & Joseph Bojalad III	4-10-19	26	Standiford, William Roger et ux	4-9-23.8
3	Blake, Herman & Evelyn Kuhn, Philip Est- Life/Howard Kuhn	3-11-7	11	Bungard, John	3-12-4	19	Taylor, Lee et ux Williams Energy Co.	4-10-20	27	Taylor, Lee et ux Williams Energy Co.	4-9-27
4	Kuhn, Philip Est- Life/Howard Kuhn	3-11-8	12	Kuhn, Howard & Mary	3-12-4.2	20	Sullivan, Robert Morris	4-10-22	28	Wilson, Cary & Trudy	4-10-19.1
5	Kuhn, Hubert & Andrea	3-12-1	13	Wells, Roger Dale et al	3-12-4.3	21	Consolidation Coal Company	4-10-23	29	Conkle, Lawrence & Shirley Ests (Roy Conkle)	9-2-4
6	Kuhn, Hubert & Andrea	3-12-2	14	Kuhn, Hubert & Andrea	3-12-4.4	22	Fletcher, Nelson et ux - life Rulong, James	4-9-19			
7	Kuhn, Hubert & Andrea	3-12-2.1	15	Wells, Roger Dale et al	3-12-4.5	23	Standiford, William - exec. Rulong, James	4-9-20			
8	Kuhn, Hubert & Andrea	3-12-3	16	Conner, David Shawn	4-10-16	24	Standiford, William - exec.	4-9-22			

RECEIVED

SURFACE OWNER: LEE TAYLOR, ET UX.
OIL/GAS OWNER: LEE R. & SHERRI L. TAYLOR
WELL OPERATOR: CHEVRON APPALACHIA, LLC
**ADDRESS: 800 MOUNTAIN VIEW DRIVE
SMITHFIELD, PA 15478**
PHONE: 724-564-3700

COUNTY: MARSHALL
DISTRICT: CLAY NOV 14 2014
SURVEYOR: BLUE MOUNTAIN INC.
**ADDRESS: 11023 MASON DIXON HIGHWAY
BURTON, WV 26562**
PHONE: 304-662-6486