

State of West Virginia
Department of Environmental Protection - Office of Oil and Gas
Well Operator's Report of Well Work

RECEIVED
Office of Oil and Gas

AUG 01 2017

WV Department of
Environmental Protection

API 47 - 051 - 01768 County Marshall District Clay
Quad Powhatan Point Pad Name MND 1 Field/Pool Name Marcellus
Farm name CNX Gas Company, LLC ET AL Well Number MND 1 BHS
Operator (as registered with the OOG) Noble Energy, Inc.
Address 1001 Noble Energy Way City Houston State Texas Zip 77070

As Drilled location NAD 83/UTM Attach an as-drilled plat, profile view, and deviation survey
Top hole Northing 39.849970 Easting -80.774304
Landing Point of Curve Northing _____ Easting _____
Bottom Hole Northing _____ Easting _____

Elevation (ft) 1152.08 GL Type of Well New Existing Type of Report Interim Final
Permit Type Deviated Horizontal Horizontal 6A Vertical Depth Type Deep Shallow
Type of Operation Convert Deepen Drill Plug Back Redrilling Rework Stimulate
Well Type Brine Disposal CBM Gas Oil Secondary Recovery Solution Mining Storage Other _____
Type of Completion Single Multiple Fluids Produced Brine Gas NGL Oil Other _____
Drilled with Cable Rotary

Drilling Media Surface hole Air Mud Fresh Water Intermediate hole Air Mud Fresh Water Brine
Production hole Air Mud Fresh Water Brine
Mud Type(s) and Additive(s)

Date permit issued 10/31/2014 Date drilling commenced 07/31/2015 Date drilling ceased 07/31/2015
Date completion activities began na Date completion activities ceased na
Verbal plugging (Y/N) n Date permission granted _____ Granted by _____

Please note: Operator is required to submit a plugging application within 5 days of verbal permission to plug

Freshwater depth(s) ft 521' Open mine(s) (Y/N) depths na
Salt water depth(s) ft na Void(s) encountered (Y/N) depths na
Coal depth(s) ft 687-697 Cavern(s) encountered (Y/N) depths na

Is coal being mined in area (Y/N) Yes

APPROVED

NAME: Jan [Signature]
DATE: 8/16/2017

Reviewed by: [Signature]

API 47- 051 - 01768 Farm name CNX Gas Company, LLC ET AL Well number MND 1 BHS

CASING STRINGS	Hole Size	Casing Size	Depth	New or Used	Grade wt/ft	Basket Depth(s)	Did cement circulate (Y/ N) * Provide details below*
Conductor	36"	30"	40'	New	LS/117#		
Surface							
Coal							
Intermediate 1							
Intermediate 2							
Intermediate 3							
Production							
Tubing							
Packer type and depth set							

Comment Details *set only the conductor.

CEMENT DATA	Class/Type of Cement	Number of Sacks	Slurry wt (ppg)	Yield (ft ³ /sks)	Volume (ft ³)	Cement Top (MD)	WOC (hrs)
Conductor							
Surface							
Coal							
Intermediate 1							
Intermediate 2							
Intermediate 3							
Production							
Tubing							

Drillers TD (ft) 40' Loggers TD (ft) 40'
 Deepest formation penetrated _____ Plug back to (ft) _____
 Plug back procedure _____

Kick off depth (ft) NA

Check all wireline logs run caliper density deviated/directional induction
 neutron resistivity gamma ray temperature sonic

Well cored Yes No Conventional Sidewall Were cuttings collected Yes No

DESCRIBE THE CENTRALIZER PLACEMENT USED FOR EACH CASING STRING _____

WAS WELL COMPLETED AS SHOT HOLE Yes No DETAILS _____

WAS WELL COMPLETED OPEN HOLE? Yes No DETAILS _____

WERE TRACERS USED Yes No TYPE OF TRACER(S) USED _____

RECEIVED
Office of Oil and Gas
AUG 01 2017
WV Department of
Environmental Protection

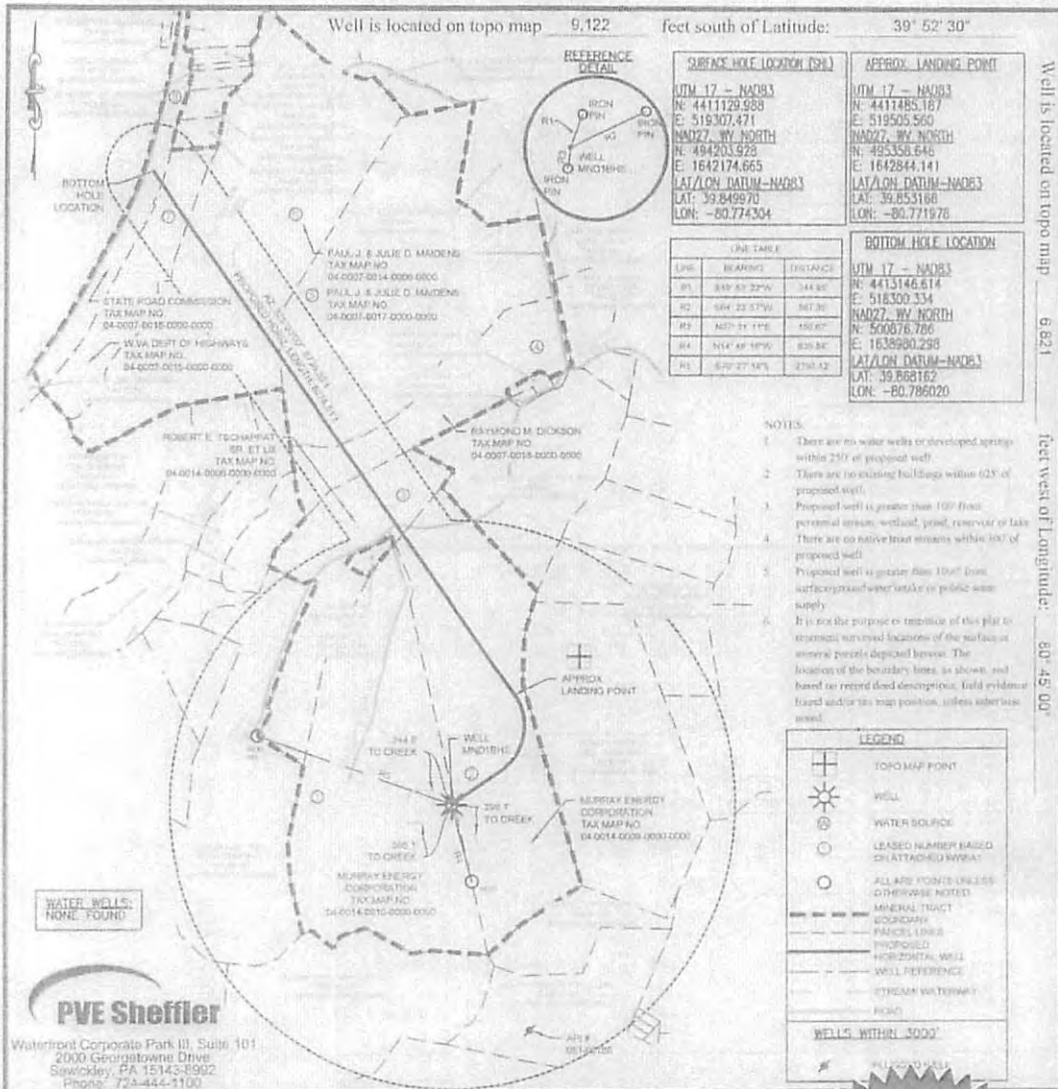

FILE# MND 1 BHS

DRAWING# MND 1 BHS

SCALE 1"=1500'

MINIMUM DEGREE OF ACCURACY 1/2500

PROVEN SOURCE U.S.G.S. MONUMENT
OF ELEVATION H 138 638.58

I, THE UNDERSIGNED, HEREBY CERTIFY THAT THIS PLAN IS CORRECT TO THE BEST OF MY KNOWLEDGE AND BELIEF AND SHOWS ALL THE INFORMATION REQUIRED BY LAW AND THE REGULATIONS ISSUED AND PRESCRIBED BY THE DEPARTMENT OF ENVIRONMENTAL PROTECTION.

SIGNED: Charles Robert Davidson

R.P.E.: _____ L.L.S.: P.S. NO. 819



(+) DENOTES LOCATION OF WELL ON UNITED STATES TOPOGRAPHIC MAPS WVDEP

OFFICE OF OIL & GAS
601 5TH STREET
CHARLESTON, WV 25304

Well Type: Oil Waste Disposal Production Deep
 Gas Liquid Injection Storage Shallow

WATERSHED: OHIO RIVER ELEVATION 1152.00'

COUNTY/DISTRICT MARSHALL / CLAY QUADRANGLE POW-HATAN POINT W. VA/OHIO

SURFACE OWNER: MURRAY ENERGY CORPORATION ACRAGE 128.99

OIL & GAS ROYALTY OWNER: CHX GAS COMPANY, LLC ET AL ACRAGE 128.99

DRILL CONVERT DRILL DEEPER REDRILL FRACTURE OR STIMULATE
PLUG OFF OLD FORMATION PERFORATE NEW FORMATION PLUG AND ABANDON
CLEAN OUT & REPLUG OTHER CHANGE (SPECIFY)

TARGET FORMATION: MARCELLUS ESTIMATED DEPTH: TVD 5,380 ± TMD 15,774 ±

WELL OPERATOR: NOBLE ENERGY, INC DESIGNATED AGENT: STEVEN M. GREEN
Address: 533 TECHNOLOGY DRIVE, SUITE 116 Address: 500 VIRGINIA STREET EAST, UNITED CENTER SUITE 100
City: CANNONSBURG State: PA Zip Code: 15317 City: CHARLESTON State: WV Zip Code: _____

DATE: JULY 30, 2014 REV. AUGUST 4, 2014

OPERATOR'S WELL #: MND 1 BHS

API WELL # 47 051 H6A 01768

STATE: _____ COUNTY: _____ PERMIT: _____

RECEIVED
Office of Oil and Gas
AUG 01 2017
WV Department of Environmental Protection