

**REFERENCE NOTES**  
Boundaries as shown taken from deeds, tax maps and field locations. A full boundary survey is not expressed nor implied. All bearings are based on true north. Ownership taken from public records Ohio County, West Virginia MARCH 2013  
State Plane Coordinates & NAD 83 Lat/Long by differential submeter mapping grade GPS  
Drafted by: E.A.M.

SURFACE HOLE LOCATION	LANDING POINT LOCATION	BOTTOM HOLE LOCATION
UTM 17-NAD 83 N) 4419288.53 E) 541050.03	UTM 17-NAD 83 N) 4419075.29 E) 541054.50	UTM 17-NAD 83 N) 4417854.53 E) 541940.10
NAD 27, WV NORTH N) 519781.99 E) 1713967.84	NAD 27, WV NORTH N) 519081.98 E) 1713970.82	NAD 27, WV NORTH N) 515027.38 E) 1716809.88

FILE #: NOB 001  
DRAWING #: 2265  
SCALE: PLAT - 1"=1400'  
TICK MARK - 1"=2000'  
MINIMUM DEGREE OF ACCURACY: 1/200  
PROVEN SOURCE OF ELEVATION: SUBMETER MAPPING GRADE GPS

I, THE UNDERSIGNED, HEREBY CERTIFY THAT THIS PLAT IS CORRECT TO THE BEST OF MY KNOWLEDGE AND BELIEF AND SHOWS ALL THE INFORMATION REQUIRED BY LAW AND THE REGULATIONS ISSUED AND PRESCRIBED BY THE DEPARTMENT OF ENVIRONMENTAL PROTECTION.  
Signed: [Signature]  
L.L.S. #2124 : Ernest J. Benchek III

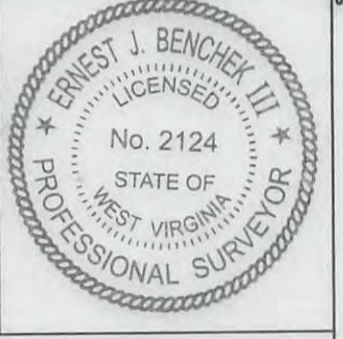

(+) DENOTES LOCATION OF WELL ON UNITED STATES TOPOGRAPHIC MAPS WVDEP  
OFFICE OF OIL & GAS  
601 57TH STREET  
CHARLESTON, WV 25304

Well Type:  Oil  Waste Diposal  Production  Deep  
 Gas  Liquid Injection  Storage  Shallow

WATERSHED: DUNKARD FORK AUG 10  
COUNTY/DISTRICT: MARSHALL / WEBSTER  
SURFACE OWNER: TIM M. TURLEY AND TAMMY JENKINS  
OIL & GAS ROYALTY OWNER: TIM M. TURLEY AND TAMMY JENKINS  
LEASE NUMBERS: \_\_\_\_\_

DATE: AUGUST 21, 2013  
OPERATOR'S WELL #: WEB22 JHS  
API WELL #: 47 51 01723H6A  
STATE COUNTY PERMIT

ELEVATION: 1,325'  
QUADRANGLE: MAJORSVILLE WV-PA  
ACREAGE: 137.42 +/-  
ACREAGE: 522.36 +/-

TARGET FORMATION: MARCELLUS  
WELL OPERATOR: NOBLE ENERGY, INC.  
ADDRESS: 333 TECHNOLOGY DRIVE SUITE 116  
CITY: CANONSBURG STATE: PA ZIP CODE: 15317

ESTIMATED DEPTH: TVD: 6,913' TMD: 12,182'  
DESIGNATED AGENT: STEVEN M. GREEN  
ADDRESS: 500 VIRGINIA STREET EAST  
CITY: CHARLESTON STATE: WV ZIP CODE: 25301

DRILL  CONVERT  DRILL DEEPER  REDRILL  FRACTURE OR STIMULATE   
PLUG OFF FORMATION  PERFORATE NEW FORMATION  PLUG & ABANDON   
CLEAN OUT & REPLUG  OTHER CHANGE  (SPECIFY): \_\_\_\_\_

12/13/2013

SURFACE HOLE DEC. LAT: 39.922826 SURVEYED LAT: 39° 56' 21.5"

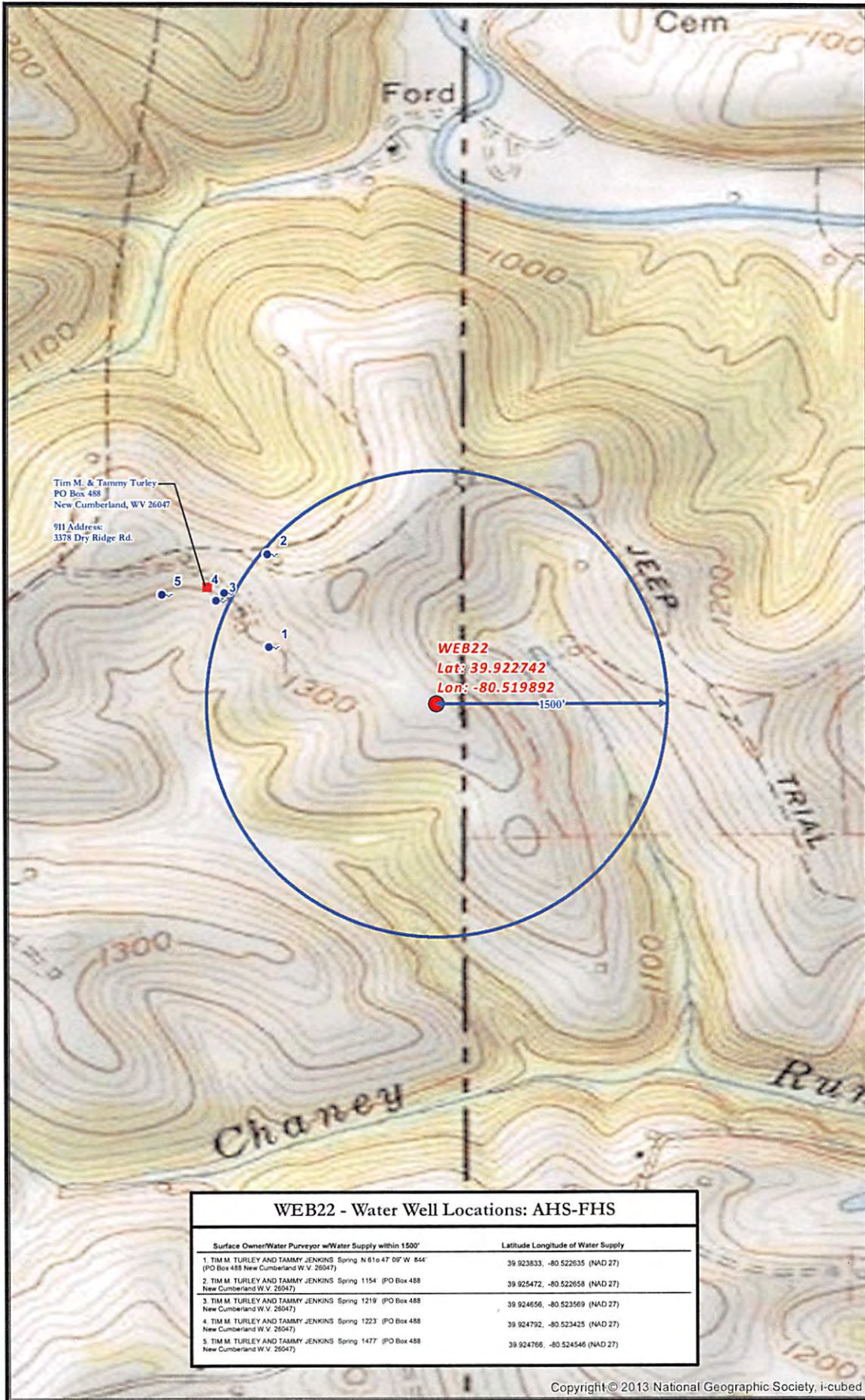

**WEB22 SITE SAFETY PLAN**  
- WATER WELLS PROXIMITY -

■ 911 Address  
● Spring  
● Well Pad  
W Water Well

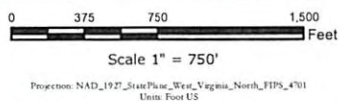

**noble energy**

Date: 7/18/2013  
Author: Christopher Glover

Disclaimer: All data is licensed for use by Noble Energy Inc. use only.

6/6