

3.335
2.000

+ 3.335
2.00W

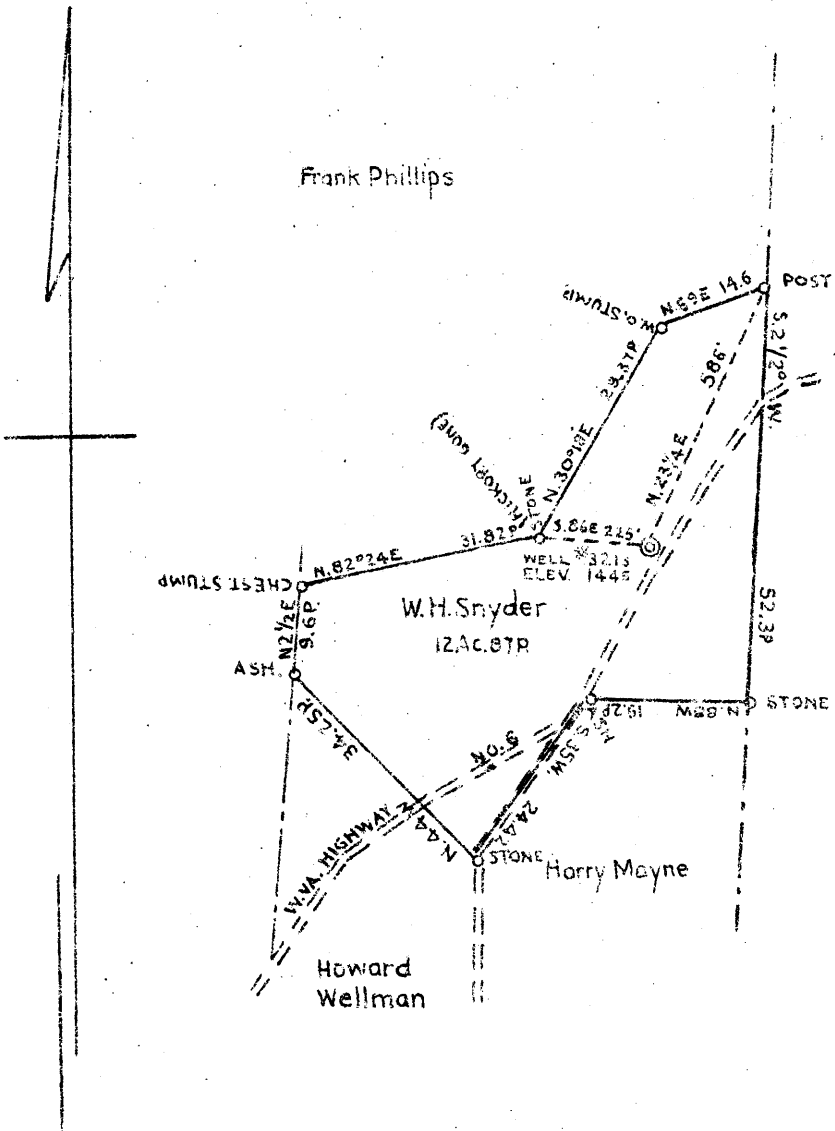

COAL OWNED BY J.C. Snyder, 1069 Allison Ave. Washington Pa.

NEW LOCATION
 DRILL DEEPER
 ABANDONMENT

COMPANY The Manufacturers Light and Heat Company
 ADDRESS 800 Union Trust Building Pittsburgh Pa.
 FARM W.H. Snyder now Harry Mayne
 TRACT _____ ACRES 12 Ac. 87 Per LEASE NO. 6647
 WELL (FARM) NO. 1 SERIAL NO. 3213
 ELEVATION (SPIRIT LEVEL) 1445'
 QUADRANGLE Cameron EC
 COUNTY Marshall DISTRICT Cameron
 ENGINEER J. Mercer
 ENGINEER'S REGISTRATION NO. _____
 FILE NO. _____ DRAWING NO. Y-11-294
 DATE January 14 1947 SCALE 1" = 400'

STATE OF WEST VIRGINIA
 DEPARTMENT OF MINES
 OIL AND GAS DIVISION
 CHARLESTON

WELL LOCATION MAP

FILE NO. MARS-259-A

NOV 05 1939

— DENOTES LOCATION OF WELL ON UNITED STATES TOPOGRAPHIC MAPS. SCALE 1 TO 62,500. LATITUDE AND LONGITUDE LINES BEING REPRESENTED BY BORDER LINES AS SHOWN.
 — DENOTES ONE INCH SPACES ON BORDER LINE OF ORIGINAL TRACING.

Cameron District, Marshall County, W. Va.
 By Manufacturers Light & Heat Co.
 Completed Oct. 25, 1927.
 Record from Mr. Schillheim Sept. 30, 1939.

→ 1339

	Top.	Bottom.
Pittsburgh Coal	937	945
Little Darkred Sand	1332	1370
Big Darkred Sand	1400	1456
Freeport Coal	1456	1460
Coal	1560	1563
Gas Sand (gas show, 1565')	1563	1555
1st Salt Sand	1625	1655
2nd Salt Sand	1708	1814
Horton Sand (gas show, 1965')	1910	1975
Little Lino	1985	2005
Big Lino	2017	2075
Big Injun Sand (water, 2162'; gas, 2091, 2157')(break, 2235-2245')	2075	2287
Gantz Sand	2655	2695
30-Foot? Sand	2710	2740
50-Foot Sand (pay gas, 2880-2883')	2761	2887
Total depth		2909



308

STATE OF WEST VIRGINIA
DEPARTMENT OF MINES
OIL AND GAS DIVISION

WELL RECORD

Permit No. 259-A

Oil or Gas Well Gas (kind)

Company The Manufacturers Light & Heat Company
Address 800 Union Trust Bldg., Pgh., Penna.
Farm W. H. Snyder Acres 13
Location (waters)
Well No. 1-3213 Elev. 1145'
District Cameron County Marshall
The surface of tract is owned in fee by Harry Mayne
Address Cameron, W. V.
Mineral rights are owned by The Mfrs. Light & Heat Co.
800 Union Trust Bldg. Address Pittsburgh, Penna.
Drilling commenced August 18th, 1927
Drilling completed October 25th, 1927
Date Shot From To
With

Table with columns: Casing and Tubing, Used in Drilling, Left in Well, Packers. Includes rows for Size, Kind of Packer, Size of, Depth set, Perf. top, Perf. bottom, Liners Used.

Open Flow /10ths Water in Inch
/10ths Merc. in Inch
Volume 698,000 Cu. Ft.
Rock Pressure lbs. hrs.
Oil bbls., 1st 24 hrs.
Fresh water 2162' feet feet
Salt water feet feet

CASING CEMENTED SIZE No. Ft.
COAL WAS ENCOUNTERED AT 505 FEET 36 INCHES
650 FEET 60 INCHES 838 FEET 60 INCHES
937 FEET 96 INCHES 1456 FEET 48 INCHES

Main well log table with columns: Formation, Color, Hard or Soft, Top, Bottom, Oil, Gas or Water, Depth Found, Remarks. Lists geological layers from Slate & Lime to Fifty Foot Sand, with depths and gas/water findings.

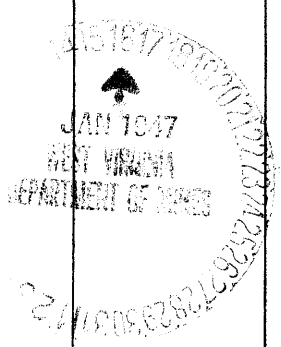

Formation	Color	Hard or Soft	Top	Bottom	Oil, Gas or Water	Depth Found	Remarks

Date January 15th, 1947

APPROVED THE MANUFACTURERS LIGHT & HEAT CO., Owner

By Paul Cooper LAND AGENT
(Title)