

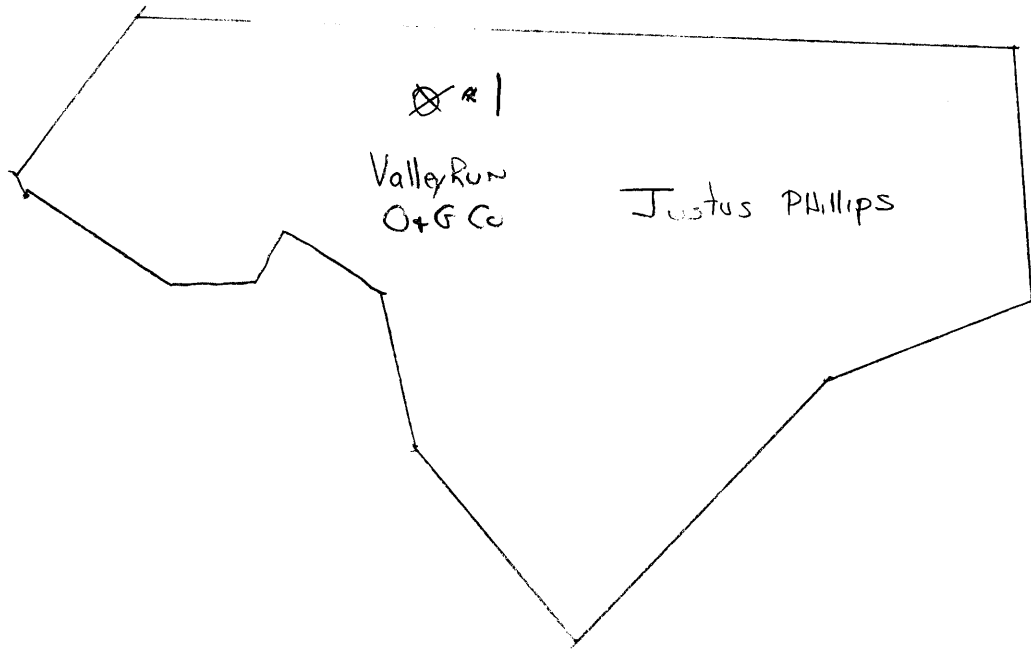

Cameron dist



was  
OSI 34A

now  
OSI 1337

*Cameron*

Liberty District, Marshall County, W. Va.  
 Valley Sun Oil & Gas Co., Cameron, W. Va. (Chauncey E. Wineman, Secy.)  
 On 64.55 acres, surface and mineral rights owned by Justus Phillips,  
 R. P. 110, 4, Cameron, W. Va.

Drilled under permit issued November, 1929.

No elevation given.

1 1/2" conductor, 16'; 10" casing, 200'; 8 1/4", 1640'; 6-5/8", 2225';  
 5-3/16", 3060'.

Coal was encountered at 870-875, 1070-1076, and 1155-1160'.

Abandonment? reported to Dept. of Mines June 19, 1934.

Well was shot at 3142'.

Salt water at 2065'.

Gas well (at 3142').

MARS-34-A  
 91337

	Top.	Bottom.
Waynesburg Coal, black, soft	870	- 875
Mapletown Coal, black, soft	1070	- 1076
Pittsburgh Coal, black, soft	1155	- 1160
Little Darkard Sand, light, hard	1550	- 1570
Big Darkard Sand, light, hard	1640	- 1695
Gas Sand, light, hard	1805	- 1830
1st Salt Sand, light, hard	1955	- 1975
2nd Salt Sand, light, hard (water, 2065')	2055	- 2105
Maxton Sand, light, hard	2125	- 2130
Little Linc, light, hard	2200	- 2217
Pencil Cave, dark, soft	2219	- 2225
Big Linc, light, hard	2225	- 2264
Big Injun Sand, light, hard (water)	2264	- 2530
30-Ft. Sand, light, hard	2890	- 2925
50-Ft. Sand, light, hard	3060	- 3065
Gordon Stray and Gordon Sands, light, hard (gas at 3142' and oil)	3132	- 3172
Total depth		3172

*Cameron*

34A >

1387

~~Liberty~~ District, Marshall County, W. Va.  
 Valley Run Oil & Gas Co., Cameron, W. Va.  
 On 64.95 acres, surface and mineral rights owned by Justus  
 Phillips, ED 4, Cameron, W. Va.

Drilled under permit issued Nov. 1929, no number given.  
 No elevation given.

1 1/2" conductor, 16'; 10" casing, 200'; 8 1/4", 1640'; 6-5/8", 2225';  
 5-1/16", 3060'.

Well was shot at 3141'.

Salt water at 2065'.

Gas at 3142'.

Completion report dated Nov. 1929, but not filed until June 23, 1934. with Dept. of Mines

	Top.	Bottom.
Waynesburg Coal, black, soft	870	875
Hopletown (Sewickley) Coal, black, soft	1070	1076
Pittsburgh Coal, black, soft	1155	1160
Little Dunkard Sand, light, hard	1550	1570
Big Dunkard Sand, light, hard	1640	1695
Gas Sand, light, hard	1835	1830
1st Salt Sand, light, hard	1955	1975
2nd Salt Sand, light, hard (water, 2065')	2055	2105
Maxton Sand, light, hard	2125	2130
Little Line, light, hard	2200	2217
Pencil Cove, dark, soft	2219	2225
Big Line, light, hard	2225	2264
Big Injun Sand, light, hard (water)	2264	2530
30-Ft. Sand, light, hard (50-Ft.)	2890	2925
50-Ft. Sand, light, hard (30-Ft.)	3060	3065
Gordon Stray and Gordon Sands, light, hard, (gas and oil), to bottom	3132	3172