

Latitude: 39°47'30"

Longitude: 80°32'30"

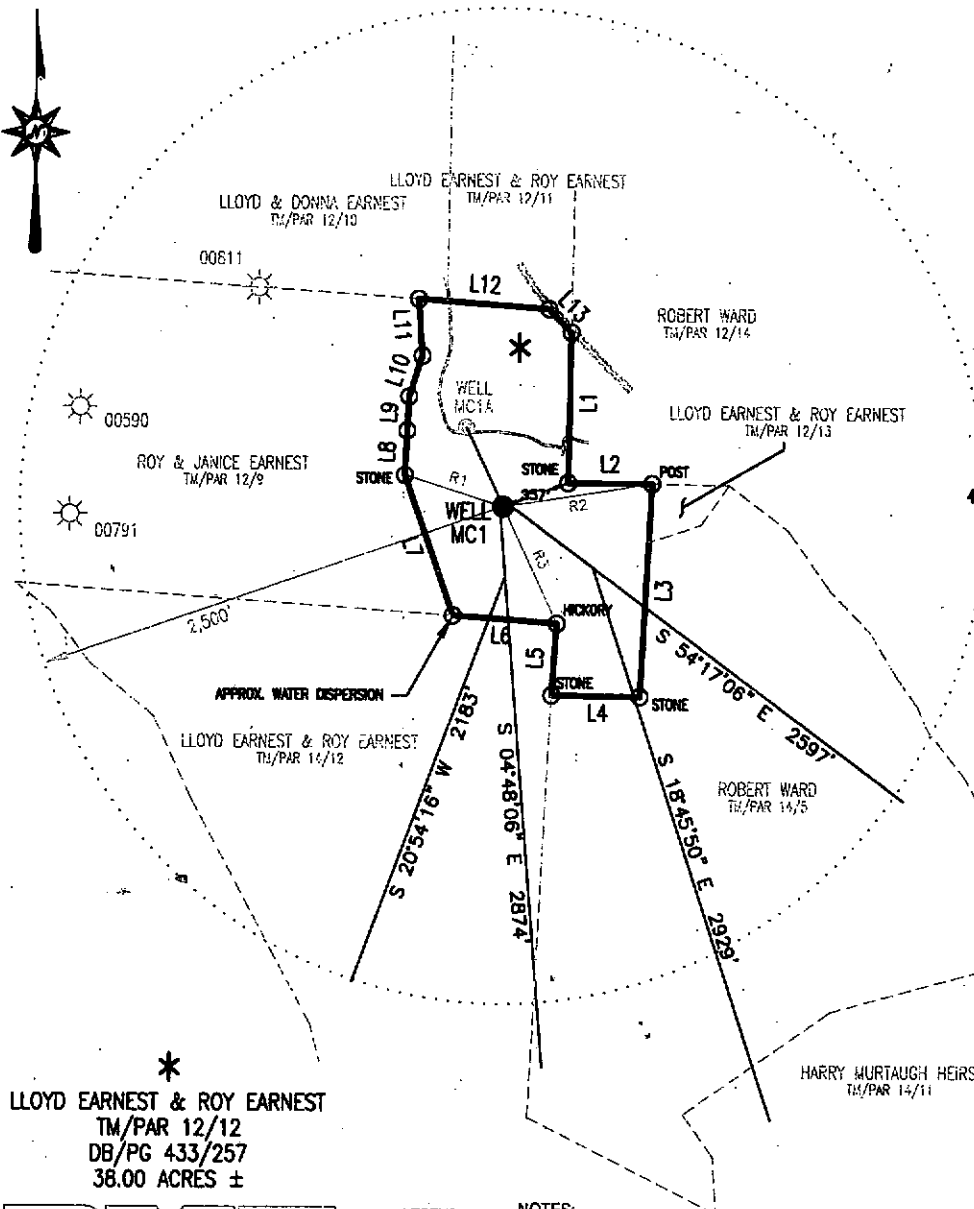

COORDINATES:
2,023' WEST (80°32'57.04")
4,912' SOUTH (39°46'41.99")

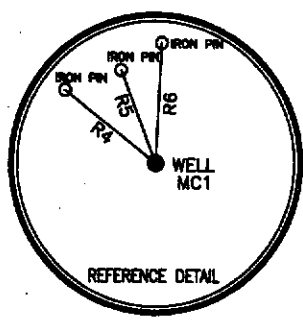

REFERENCE LINES		
LINE	BEARING	DISTANCE
R1	N 72°51'33" W	533.24'
R2	N 81°12'42" E	781.53'
R3	S 25°43'55" E	651.62'
R4	N 52°01'22" W	249.17'
R5	N 20°56'39" W	210.00'
R6	N 02°55'49" E	253.53'

LINE	BEARING	DISTANCE
L1	S 00°52'10" W	758.48'
L2	S 89°43'25" E	436.63'
L3	S 02°59'00" W	1075.80'
L4	N 89°16'00" W	458.70'
L5	N 03°59'00" E	362.94'
L6	N 86°01'00" W	540.20'
L7	N 19°44'24" W	750.75'
L8	N 02°45'36" E	224.40'
L9	N 02°45'36" E	173.25'
L10	N 18°15'36" E	214.50'
L11	N 04°14'24" W	286.00'
L12	S 86°03'12" E	676.31'
L13	S 45°01'00" E	185.24'

*
LLOYD EARNEST & ROY EARNEST
TM/PAR 12/12
DB/PG 433/257
38.00 ACRES ±

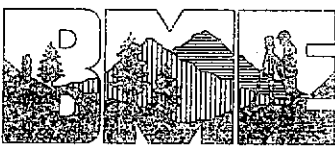

Blue Mountain Engineering
11023 MASON DIXON HIGHWAY
BURTON, WV 26582
PHONE: (304) 662-6486

- LEGEND**
(WELLS WITHIN 2500')
- ☀ - ACTIVE
 - ⬛ - ABANDONED
 - ⊛ - PLUGGED
 - - NEVER DRILLED
 - ⊙ - UNDER CONSTRUCTION
 - ⊕ - NEW WELL

- NOTES:**
- There are no dwellings within 200' of proposed well.
 - Proposed well is greater than 100' from the mineral line
 - It is not the purpose or intention of this plat to represent surveyed locations of the surface or mineral parcels depicted hereon. The location of the boundary lines, as shown, are based on record deed descriptions, field evidence found and/or tax map position, unless otherwise noted.

FILE #: MC1
DRAWING #: MC1
SCALE: 1" = 1000'
MINIMUM DEGREE OF ACCURACY: 1/2500
PROVEN SOURCE OF ELEVATION: U.S.G.S. MONUMENT THOMAS 1498.81'

I, THE UNDERSIGNED, HEREBY CERTIFY THAT THIS PLAT IS CORRECT TO THE BEST OF MY KNOWLEDGE AND BELIEF AND SHOWS ALL THE INFORMATION REQUIRED BY LAW AND THE REGULATIONS ISSUED AND PRESCRIBED BY THE DEPARTMENT OF ENVIRONMENTAL PROTECTION.

Signed: _____
R.P.E.: _____ L.L.S.: P.S. No. 2000

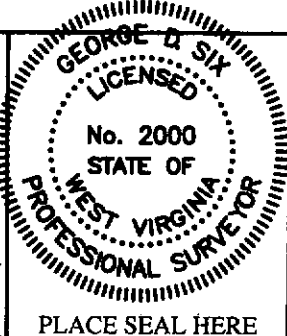

(+) DENOTES LOCATION OF WELL ON UNITED STATES TOPOGRAPHIC MAPS WVDEP

OFFICE OF OIL & GAS
601 57TH STREET
CHARLESTON, WV 25304



DATE: FEBRUARY 22, 2008
OPERATOR'S WELL #: MC1
API WELL #: 47 051 0118C
STATE COUNTY PERMIT

Well Type: Oil Waste Disposal Production Deep
 Gas Liquid Injection Storage Shallow

WATERSHED: UNNAMED TRIBUTARY TO HARTS RUN ELEVATION: 1290.86'
COUNTY/DISTRICT: MARSHALL/LIBERTY QUADRANGLE: CAMERON, WV-PA 7.5'
SURFACE OWNER: LLOYD EARNEST & ROY EARNEST ACREAGE: 38.00±
OIL & GAS ROYALTY OWNER: SEE ATTACHED ACREAGE: 38.00±
DRILL CONVERT DRILL DEEPER REDRILL FRACTURE OR STIMULATE
PLUG OFF OLD FORMATION PERFORATE NEW FORMATION PLUG & ABANDON
CLEAN OUT & REPLUG OTHER CHANGE (SPECIFY): _____
TARGET FORMATION: PITTSBURGH ESTIMATED DEPTH: 1287'
WELL OPERATOR CNX Gas Company LLC DESIGNATED AGENT JOHN H. JOHNSTON
Address 2481 JOHN NASH BLVD. Address CHASE CENTER, PO BOX 1588
City BLUEFIELD State WV Zip Code 24701 City CHARLESTON State WV Zip Code 25326-1598

State of West Virginia
Department of Environmental Protection
Office of Oil and Gas

51-01118

118

Well Operator's Report of Well Work

Farm name: LLOYD & ROY EARNEST Operator Well No.: MC-1

LOCATION: Elevation: 1290.86' Quadrangle: CAMERON WV-PA 7.5'

District: LIBERTY County: MARSHALL
Latitude: 4,912 Feet South of 39' Deg. 46' Min. 41.99 Sec.
Longitude: 2,023 Feet West of 80' Deg. 32' Min. 57.04 Sec.

Company: CNX Gas Company, LLC

	Casing & Tubing	Used in drilling	Left in well	Cement Fill Up (# of Sacks)
Address: 2481 John Nash BLVD	13 3/8"	42.0'	42.0'	SADED IN
Bluefield Wv 24701	9 5/8"	350.6'	350.6'	125 SKS
Agent: Les Arrington	7"	1267.9'	1267.9'	130 SKS
Inspector: Bill Hatfield				
Date Permit Issued: 3/24/08				
Date Well Work Commenced: 4/17/08				
Date Well Work Completed: 5/13/08				
Verbal Plugging:				
Date Permission granted on:				
Rotary Cable <input checked="" type="radio"/> Rig				
Total Depth (feet): 1480'				
Fresh Water Depth (ft.): 300'				
Salt Water Depth (ft.): N/A				
Is coal being mined in area (N/Y)? No				
Coal Depths (ft.): 880', 1095', 1198'				

RECEIVED
Office of Oil & Gas

JAN 16 2009

WV Department of
Environmental Protection

OPEN FLOW DATA

Producing formation Pittsburgh COAL SEAM depth (ft) 1198'-1204'
Gas: Initial open flow _____ MCF/d Oil: Initial open flow _____ Bbl/d
Final open flow _____ MCF/d Final open flow _____ Bbl/d
Time of open flow between initial and final tests _____ Hours
Static rock Pressure _____ psig (surface pressure) after _____ Hours

Second producing formation _____ Pay zone depth (ft) _____
Gas: Initial open flow _____ MCF/d Oil: Initial open flow _____ Bbl/d
Final open flow _____ MCF/d Final open flow _____ Bbl/d
Time of open flow between initial and final tests _____ Hours
Static rock Pressure _____ psig (surface pressure) after _____ Hours

NOTE: ON BACK OF THIS FORM PUT THE FOLLOWING: 1). DETAILS OF PERFORATED INTERVALS, FRACTURING OR STIMULATING, PHYSICAL CHANGE, ETC. 2). THE WELL LOG WHICH IS A SYSTEMATIC DETAILED GEOLOGICAL RECORD OF ALL FORMATIONS, INCLUDING COAL ENCOUNTERED BY THE WELLBORE.

Gas Well DOE MC 1 (API No. 47-101118) is a horizontal well for CNX Gas Company, LLC. Refer to the attached information for additional information.

Signed: Geoff Fanning
By: Geoff Fanning Drilling Manager
Date: 1/9/09

ATTACHMENT A

Marshall County CBM Well No. MC-1 Drill Log

API # 47-101118

Depth	Description
GL-0	FILL
0-15	SAND
15-30	SHALE
30-38	R.R
38-42	SHALE
42-68	SAND
68-102	SHALE
102-150	RR
150-153	SAND
153-198	RR
198-203	SHALE
203-256	SAND
256-293	SHALE
293-330	RR
330-334	SHALE
334-420	SAND
420-553	SHALE
553-685	SAND
685-720	SHALE
720-760	SAND
760-880	COAL
880-883	SAND
883-930	RR
930-934	SAND

934-987	SHALE
987-1092	SAND
1092-1095	COAL
1095-1198	SHALE
1198-1204	PG COAL
1204-1206	SHALE
1206-1320	SAND
1320-1402	SHALE
T.D 8 7/8 @	1480'



Scientific Drilling
CBM Directional Operations

CNX Gas Company, LLC

Field: MARSHALL COUNTY, WV
Site: MC 1 WELL LOCATION
Well: ACCESS MC1 A2
Wellpath: West Leg



TARGET DETAILS

Name	TVD	+N/-S	+E/-W	Northing	Easting	Shape
WEST LEG TD	1117.78	-2803.03	-576.84	464899.22	1704303.97	Rectangle (1661x200)
EAST CENTER TD	1117.00	-1881.22	227.47	465821.03	1707158.28	Rectangle (1758x200)
EAST CENTER TD	1117.78	-3414.50	1494.88	464287.75	1706375.69	Rectangle (3052x200)
WEST CENTER TD	1117.78	-3228.72	409.16	464473.53	1705289.97	Rectangle (2388x200)

SITE DETAILS

MC 1 WELL LOCATION
Marshall Co., WV

Site Centre Northing: 467696.22
Easting: 1704867.47

Ground Level: 1371.91
Positional Uncertainty: 0.00
Convergence: -0.67

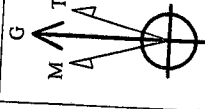

Azimuths to Grid North
True North: 0.67°
Magnetic North: -7.81°
Magnetic Field Strength: 53250nT
Dip Angle: 67.76°
Date: 5/1/2008
Model: igr42005

REFERENCE INFORMATION

Co-ordinate (NVE) Reference: Well Centre: ACCESS MC1 A2, Grid North
Vertical (TVD) Reference: GL 1372.69 + 10 1382.69
Section (VS) Reference: Slot - (0.00N,0.00E)
Measured Depth Reference: GL 1372.69 + 10 1382.69
Calculation Method: Minimum Curvature

Plot Date: 5/16/2008
By: Bob Feeney
Scientific Drilling, Inc.
800-876-7302
bob.feeney@scientificdrilling.com

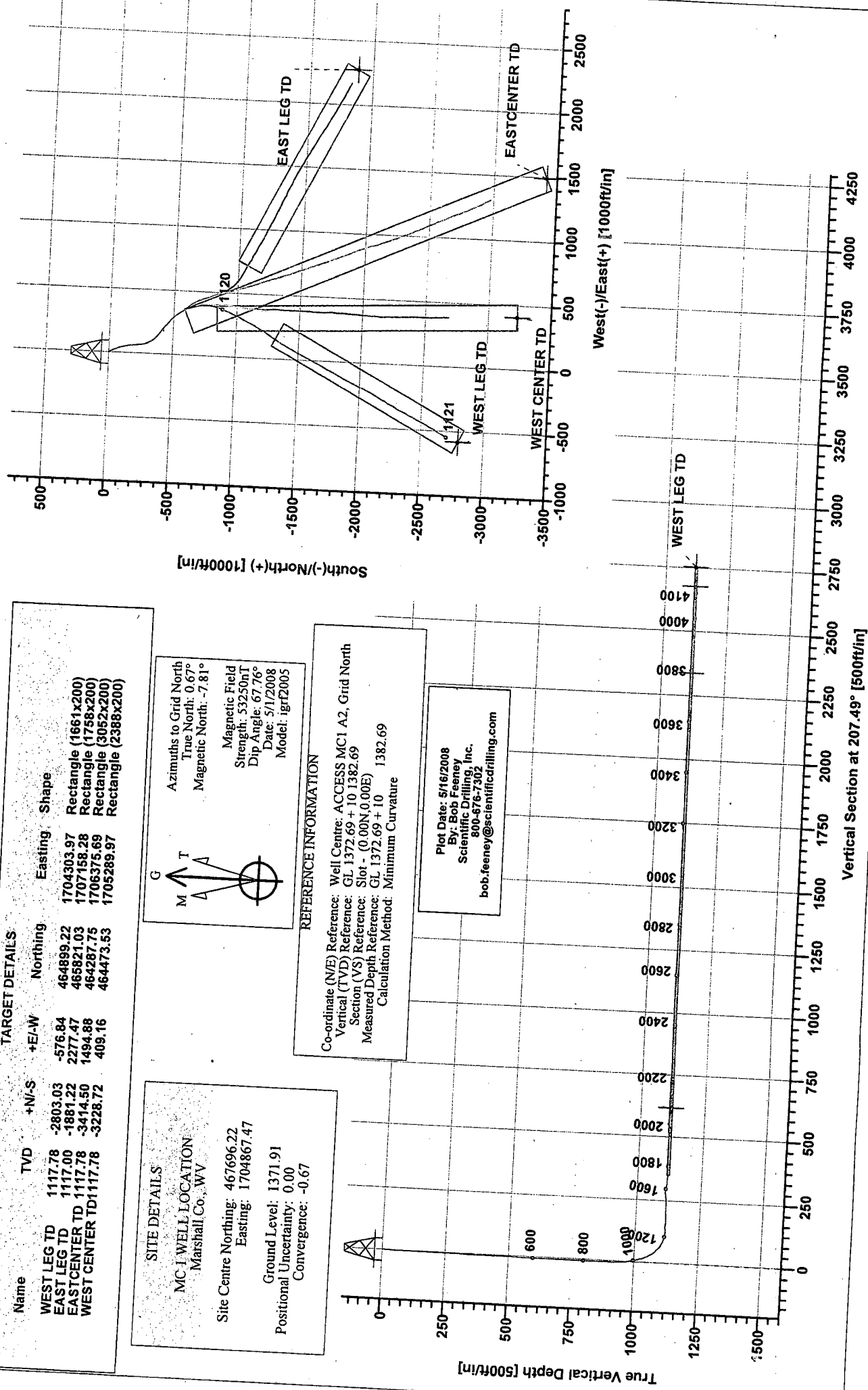

Scientific Drilling Survey Report

Company: CNX Gas Company, LLC	Date: 5/16/2008	Time: 08:39:40	Page: 1
Field: MARSHALL COUNTY, WV	Co-ordinate(NE) Reference: Well: ACCESS MC1 A2, Grid North		
Site: MC 1 WELL LOCATION	Vertical (TVD) Reference: GL 1372.69 + 10 1382.7		
Well: ACCESS MC1 A2	Section (VS) Reference: Well (0.00N,0.00E,207.49Azi)		
Wellpath: West Leg	Survey Calculation Method: Minimum Curvature	Db: Sybase	

Field: MARSHALL COUNTY, WV Northern West Virginia and Pennsylvania Operations U.S.A.	Map Zone: West Virginia, Northern Zone
Map System: US State Plane Coordinate System 1927	Coordinate System: Well Centre
Geo Datum: NAD27 (Clarke 1866)	Geomagnetic Model: igrf2005
Sys Datum: Mean Sea Level	

Site: MC 1 WELL LOCATION

Marshall Co., WV

Site Position:	Northing: 467696.22 ft	Latitude: 39 46 45.674 N	
From: Map	Easting: 1704867.47 ft	Longitude: 80 33 0.412 W	
Position Uncertainty: 0.00 ft		North Reference: Grid	
Ground Level: 1371.91 ft		Grid Convergence: -0.67 deg	

Well: ACCESS MC1 A2	Slot Name:
Well Position:	
+N/-S 6.03 ft	Northing: 467702.25 ft
+E/-W 13.34 ft	Easting: 1704880.81 ft
Position Uncertainty: 0.00 ft	
	Latitude: 39 46 45.735 N
	Longitude: 80 33 0.242 W

Wellpath: West Leg	Drilled From: EAST LEG
Current Datum: GL 1372.69 + 10	Tie-on Depth: 824.00 ft
Magnetic Data: 5/1/2008	Above System Datum: Mean Sea Level
Field Strength: 53250 nT	Declination: -8.48 deg
Vertical Section: Depth From (TVD)	Mag Dip Angle: 67.76 deg
ft	+N/-S
	ft
	+E/-W
	ft
	Direction
	deg
1117.00	0.00
	0.00
	207.49

Survey Program for Definitive Wellpath				
Date: 5/8/2008	Validated: No	Version: 1		
Actual From	To	Survey	Toolcode	Tool Name
ft	ft			
50.00	824.00	Survey #1 (0)	Drop Gyro-SYS	Drop Gyro Systematic
824.00	4100.00	Survey #1	MWD-SDI-SYS	Scientific MWD Systematic

MD ft	Incl deg	Azim deg	TVD ft	+N/-S ft	+E/-W ft	VS ft	DLS deg/100ft	Build deg/100ft	Turn deg/100ft	Tool/Comment
0.00	0.81	90.30	0.00	0.00	0.00	0.00	0.00	0.00	0.00	TIE LINE
100.00	0.93	348.00	99.99	0.80	0.50	-0.94	1.36	0.12	-102.30	Drop Gyro-SYS
200.00	0.56	300.40	199.98	1.81	-0.28	-1.48	0.69	-0.37	-47.60	Drop Gyro-SYS
300.00	0.78	301.50	299.98	2.41	-1.28	-1.54	0.22	0.22	1.10	Drop Gyro-SYS
400.00	0.51	349.50	399.97	3.14	-1.73	-1.99	0.58	-0.27	48.00	Drop Gyro-SYS
500.00	0.62	349.80	499.97	4.28	-1.61	-3.05	0.11	0.11	0.30	Drop Gyro-SYS
600.00	0.22	267.70	599.96	4.90	-2.00	-3.42	0.63	-0.40	-82.10	Drop Gyro-SYS
700.00	0.29	29.80	699.96	4.98	-2.00	-3.49	0.45	0.07	122.10	Drop Gyro-SYS
800.00	0.54	125.60	799.96	5.14	-2.02	-3.63	0.64	0.25	95.80	Drop Gyro-SYS
900.00	0.48	310.23	899.96	4.55	-1.68	-3.26	1.02	-0.06	-175.37	MWD-SDI-SYS
1000.00	22.15	151.20	997.96	-8.78	5.90	5.07	22.60	21.67	-159.03	MWD-SDI-SYS
1100.00	51.37	158.30	1076.78	-62.49	32.01	40.66	29.49	29.22	7.10	MWD-SDI-SYS
1200.00	82.80	167.17	1115.59	-149.59	57.46	106.18	32.43	31.43	8.87	MWD-SDI-SYS
1300.00	90.86	170.79	1116.78	-248.60	70.69	187.90	8.83	8.06	3.61	MWD-SDI-SYS
1400.00	92.22	143.79	1115.85	-340.61	107.18	252.68	27.02	1.36	-26.99	MWD-SDI-SYS
1500.00	90.52	126.52	1111.50	-407.68	180.67	278.25	17.35	-1.70	-17.27	MWD-SDI-SYS
1600.00	87.36	130.97	1112.80	-468.13	260.22	295.16	5.46	-3.16	4.45	MWD-SDI-SYS
1700.00	88.42	144.65	1116.02	-541.68	327.53	329.33	13.71	1.06	13.67	MWD-SDI-SYS
1800.00	90.24	160.65	1116.92	-630.17	373.39	386.66	16.11	1.82	16.01	MWD-SDI-SYS
1900.00	91.34	175.85	1114.99	-727.55	394.69	463.21	15.23	1.10	15.19	MWD-SDI-SYS
2000.00	86.26	191.39	1116.13	-826.97	387.89	554.55	16.34	-5.08	15.54	MWD-SDI-SYS
2100.00	91.23	202.69	1120.34	-921.54	356.43	652.97	12.35	4.98	11.31	MWD-SDI-SYS

Scientific Drilling Survey Report

Company: CNX Gas Company, LLC
Field: MARSHALL COUNTY, WV
Site: MC 1 WELL LOCATION
Well: ACCESS MC1 A2
Wellpath: West Leg

Date: 5/16/2008 **Time:** 08:39:40 **Page:** 2
Co-ordinate(NE) Reference: Well: ACCESS MC1 A2, Grid North
Vertical (TVD) Reference: GL 1372.69 + 10 1382.7
Section (VS) Reference: Well (0.00N,0.00E,207.49Azi)
Survey Calculation Method: Minimum Curvature **Db:** Sybase

Survey

MD ft	Incl deg	Azim deg	TVD ft	+N/-S ft	+E/-W ft	VS ft	DLS deg/100ft	Build deg/100ft	Turn deg/100ft	Tool/Comment
2200.00	89.66	204.26	1119.90	-1013.14	316.34	752.72	2.22	-1.57	1.56	MWD-SDI-SYS
2300.00	90.35	206.89	1119.81	-1103.10	272.70	852.68	2.73	0.69	2.64	MWD-SDI-SYS
2400.00	90.24	209.74	1119.73	-1191.50	225.99	952.66	2.85	-0.11	2.85	MWD-SDI-SYS
2500.00	90.42	212.02	1120.62	-1277.65	175.25	1052.50	2.29	0.18	2.28	MWD-SDI-SYS
2600.00	92.35	209.73	1116.40	-1362.21	122.07	1152.06	3.00	1.93	-2.29	MWD-SDI-SYS
2700.00	90.44	206.21	1114.80	-1451.39	76.92	1252.01	4.01	-1.91	-3.52	MWD-SDI-SYS
2800.00	87.36	206.44	1117.22	-1540.90	32.49	1351.93	3.08	-3.07	0.23	MWD-SDI-SYS
2900.00	90.83	204.89	1119.69	-1631.01	-10.77	1451.83	3.80	3.47	-1.55	MWD-SDI-SYS
3000.00	88.96	206.37	1118.99	-1721.13	-54.07	1551.76	2.38	-1.87	1.48	MWD-SDI-SYS
3100.00	93.12	207.45	1116.70	-1810.53	-98.76	1651.69	4.30	4.16	1.08	MWD-SDI-SYS
3200.00	89.49	204.38	1113.22	-1900.25	-142.70	1751.56	4.75	-3.63	-3.07	MWD-SDI-SYS
3300.00	90.02	204.64	1115.01	-1991.39	-183.79	1851.38	0.59	0.54	0.25	MWD-SDI-SYS
3400.00	89.26	205.82	1115.38	-2082.01	-226.07	1951.28	1.40	-0.76	1.18	MWD-SDI-SYS
3500.00	89.42	208.68	1116.00	-2170.49	-272.62	2051.27	2.87	0.16	2.86	MWD-SDI-SYS
3600.00	89.16	207.42	1117.24	-2258.75	-319.62	2151.25	1.28	-0.26	-1.26	MWD-SDI-SYS
3700.00	90.20	204.44	1117.42	-2348.09	-364.51	2251.22	3.15	1.04	-2.98	MWD-SDI-SYS
3800.00	90.81	205.66	1117.10	-2439.09	-405.91	2351.06	1.36	0.61	1.21	MWD-SDI-SYS
3900.00	89.13	207.41	1118.53	-2528.97	-449.70	2451.00	2.42	-1.67	1.75	MWD-SDI-SYS
4000.00	89.61	208.77	1120.29	-2617.50	-496.15	2550.98	1.44	0.48	1.36	MWD-SDI-SYS
4100.00	89.33	208.39	1121.22	-2705.34	-543.93	2650.96	0.47	-0.28	-0.38	MWD-SDI-SYS

Targets

Name	Description	TVD ft	+N/-S ft	+E/-W ft	Map Northing ft	Map Easting ft	<--- Latitude ---> Deg Min Sec	<--- Longitude ---> Deg Min Sec
WEST LEG TD	-Rectangle (1661x200)	1117.78	-2803.03	-576.84	464899.22	1704303.97	39 46 17.966 N	80 33 7.210 W
EAST LEG TD	-Rectangle (1758x200)	1117.00	-1881.22	2277.47	465821.03	1707158.28	39 46 27.405 N	80 32 30.793 W
EASTCENTER TD	-Rectangle (3052x200)	1117.78	-3414.50	1494.88	464287.75	1706375.69	39 46 12.162 N	80 32 40.587 W
WEST CENTER TD	-Rectangle (2388x200)	1117.78	-3228.72	409.16	464473.53	1705289.97	39 46 13.873 N	80 32 54.519 W

Scientific Drilling Survey Report - Geographic

Company: CNX Gas Company, LLC	Date: 5/16/2008	Time: 08:41:35	Page: 1
Field: MARSHALL COUNTY, WV	Co-ordinate(NE) Reference: Well: ACCESS MC1 A2, Grid North		
Site: MC 1 WELL LOCATION	Vertical (TVD) Reference: GL 1372.69 + 10 1382.7		
Well: ACCESS MC1 A2	Section (VS) Reference: Well (0.00N,0.00E,207.49Azi)		
Wellpath: West Leg	Survey Calculation Method: Minimum Curvature	Db: Sybase	

Field: MARSHALL COUNTY, WV Northern West Virginia and Pennsylvania Operations U.S.A.		
Map System: US State Plane Coordinate System 1927	Map Zone: West Virginia, Northern Zone	
Geo Datum: NAD27 (Clarke 1866)	Coordinate System: Well Centre	
Sys Datum: Mean Sea Level	Geomagnetic Model: igrf2005	

Site: MC 1 WELL LOCATION			
Marshall Co., WV			
Site Position:	Northing: 467696.22 ft	Latitude: 39 46 45.674 N	
From: Map	Easting: 1704867.47 ft	Longitude: 80 33 0.412 W	
Position Uncertainty: 0.00 ft		North Reference: Grid	
Ground Level: 1371.91 ft		Grid Convergence: -0.67 deg	

Well: ACCESS MC1 A2				Slot Name:			
Well Position:	+N-/S 6.03 ft	Northing: 467702.25 ft	Latitude: 39 46 45.735 N				
	+E-/W 13.34 ft	Easting: 1704880.81 ft	Longitude: 80 33 0.242 W				
Position Uncertainty: 0.00 ft							

Wellpath: West Leg				Drilled From: EAST LEG			
Current Datum: GL 1372.69 + 10	Height 1382.69 ft			Tie-on Depth: 824.00 ft			
Magnetic Data: 5/1/2008				Above System Datum: Mean Sea Level			
Field Strength: 53250 nT				Declination: -8.48 deg			
Vertical Section: Depth From (TVD)	+N-/S	+E-/W	Mag Dip Angle:	Direction			
ft	ft	ft	ft	deg			
1117.00	0.00	0.00	207.49				

Survey Program for Definitive Wellpath						
Date: 5/8/2008		Validated: No		Version: 1		
Actual From	To	Survey	Toolcode	Tool Name		
ft	ft					
50.00	824.00	Survey #1 (0)	Drop Gyro-SYS	Drop Gyro Systematic		
824.00	4100.00	Survey #1	MWD-SDI-SYS	Scientific MWD Systematic		

MD ft	Incl deg	Azim deg	TVD ft	+N-/S ft	+E-/W ft	Map Northing ft	Map Easting ft	← Latitude →		← Longitude →					
								Deg	Min	Sec	Deg	Min	Sec		
0.00	0.81	90.30	0.00	0.00	0.00	467702.25	1704880.81	39	46	45.735	N	80	33	0.242	W
100.00	0.93	348.00	99.99	0.80	0.50	467703.05	1704881.31	39	46	45.743	N	80	33	0.236	W
200.00	0.56	300.40	199.98	1.81	-0.28	467704.06	1704880.53	39	46	45.753	N	80	33	0.246	W
300.00	0.78	301.50	299.98	2.41	-1.28	467704.66	1704879.53	39	46	45.758	N	80	33	0.259	W
400.00	0.51	349.50	399.97	3.14	-1.73	467705.39	1704879.08	39	46	45.766	N	80	33	0.265	W
500.00	0.62	349.80	499.97	4.28	-1.61	467706.53	1704879.20	39	46	45.777	N	80	33	0.263	W
600.00	0.22	267.70	599.96	4.90	-2.00	467707.15	1704878.81	39	46	45.783	N	80	33	0.268	W
700.00	0.29	29.80	699.96	4.98	-2.00	467707.23	1704878.81	39	46	45.784	N	80	33	0.268	W
800.00	0.54	125.60	799.96	5.14	-2.02	467707.39	1704878.79	39	46	45.785	N	80	33	0.269	W
900.00	0.48	310.23	899.96	4.55	-1.68	467706.80	1704879.13	39	46	45.779	N	80	33	0.264	W
1000.00	22.15	151.20	997.96	-8.78	5.90	467693.47	1704886.71	39	46	45.649	N	80	33	0.165	W
1100.00	51.37	158.30	1076.78	-62.49	32.01	467639.76	1704912.82	39	46	45.121	N	80	32	59.823	W
1200.00	82.80	167.17	1115.59	-149.59	57.46	467552.66	1704938.27	39	46	44.263	N	80	32	59.484	W
1300.00	90.86	170.79	1116.78	-248.60	70.69	467453.65	1704951.50	39	46	43.286	N	80	32	59.299	W
1400.00	92.22	143.79	1115.85	-340.61	107.18	467361.64	1704987.99	39	46	42.381	N	80	32	58.818	W
1500.00	90.52	126.52	1111.50	-407.68	180.67	467294.57	1705061.48	39	46	41.727	N	80	32	57.867	W
1600.00	87.36	130.97	1112.80	-468.13	260.22	467234.12	1705141.03	39	46	41.138	N	80	32	56.839	W
1700.00	88.42	144.65	1116.02	-541.68	327.53	467160.57	1705208.34	39	46	40.419	N	80	32	55.966	W
1800.00	90.24	160.65	1116.92	-630.17	373.39	467072.08	1705254.20	39	46	39.550	N	80	32	55.366	W
1900.00	91.34	175.85	1114.99	-727.55	394.69	466974.70	1705275.50	39	46	38.590	N	80	32	55.078	W
2000.00	86.26	191.39	1116.13	-826.97	387.89	466875.28	1705268.70	39	46	37.607	N	80	32	55.150	W

Scientific Drilling Survey Report - Geographic

Company: CNX Gas Company, LLC
 Field: MARSHALL COUNTY, WV
 Site: MC 1 WELL LOCATION
 Well: ACCESS MC1 A2
 Wellpath: West Leg

Date: 5/16/2008 Time: 08:41:35 Page: 2
 Co-ordinate(NE) Reference: Well: ACCESS MC1 A2, Grid North
 Vertical (TVD) Reference: GL 1372.69 + 10 1382.7
 Section (VS) Reference: Well (0.00N,0.00E,207.49Azi)
 Survey Calculation Method: Minimum Curvature Db: Sybase

Survey

MD ft	Incl deg	Azim deg	TVD ft	+N/-S ft	+E/-W ft	Map Northing ft	Map Easting ft	Latitude Deg Min Sec		Longitude Deg Min Sec	
2100.00	91.23	202.69	1120.34	-921.54	356.43	466780.71	1705237.24	39	46	36.669 N	80 32 55.539 W
2200.00	89.66	204.26	1119.90	-1013.14	316.34	466689.11	1705197.15	39	46	35.759 N	80 32 56.039 W
2300.00	90.35	206.89	1119.81	-1103.10	272.70	466599.15	1705153.51	39	46	34.865 N	80 32 56.584 W
2400.00	90.24	209.74	1119.73	-1191.50	225.99	466510.75	1705106.80	39	46	33.986 N	80 32 57.169 W
2500.00	90.42	212.02	1120.62	-1277.65	175.25	466424.60	1705056.06	39	46	33.128 N	80 32 57.806 W
2600.00	92.35	209.73	1116.40	-1362.21	122.07	466340.04	1705002.88	39	46	32.286 N	80 32 58.475 W
2700.00	90.44	206.21	1114.80	-1451.39	76.92	466250.86	1704957.73	39	46	31.400 N	80 32 59.040 W
2800.00	87.36	206.44	1117.22	-1540.90	32.49	466161.35	1704913.30	39	46	30.510 N	80 32 59.595 W
2900.00	90.83	204.89	1119.69	-1631.01	-10.77	466071.24	1704870.04	39	46	29.615 N	80 33 0.136 W
3000.00	88.96	206.37	1118.99	-1721.13	-54.07	465981.12	1704826.74	39	46	28.719 N	80 33 0.677 W
3100.00	93.12	207.45	1116.70	-1810.53	-98.76	465891.72	1704782.05	39	46	27.830 N	80 33 1.236 W
3200.00	89.49	204.38	1113.22	-1900.25	-142.70	465802.00	1704738.11	39	46	26.939 N	80 33 1.785 W
3300.00	90.02	204.64	1115.01	-1991.39	-183.79	465710.86	1704697.02	39	46	26.033 N	80 33 2.298 W
3400.00	89.26	205.82	1115.38	-2082.01	-226.07	465620.24	1704654.74	39	46	25.133 N	80 33 2.826 W
3500.00	89.42	208.68	1116.00	-2170.49	-272.62	465531.76	1704608.19	39	46	24.253 N	80 33 3.409 W
3600.00	89.16	207.42	1117.24	-2258.75	-319.62	465443.50	1704561.19	39	46	23.375 N	80 33 3.997 W
3700.00	90.20	204.44	1117.42	-2348.09	-364.51	465354.16	1704516.30	39	46	22.487 N	80 33 4.559 W
3800.00	90.81	205.66	1117.10	-2439.09	-405.91	465263.16	1704474.90	39	46	21.583 N	80 33 5.075 W
3900.00	89.13	207.41	1118.53	-2528.97	-449.70	465173.28	1704431.11	39	46	20.690 N	80 33 5.623 W
4000.00	89.61	208.77	1120.29	-2617.50	-496.15	465084.75	1704384.66	39	46	19.809 N	80 33 6.204 W
4100.00	89.33	208.39	1121.22	-2705.34	-543.93	464996.91	1704336.88	39	46	18.936 N	80 33 6.803 W

Targets

Name	Description	TVD ft	+N/-S ft	+E/-W ft	Map Northing ft	Map Easting ft	Latitude Deg Min Sec		Longitude Deg Min Sec	
WEST LEG TD	-Rectangle (1661x200)	1117.78	-2803.03	-576.84	464899.22	1704303.97	39	46	17.966 N	80 33 7.210 W
EAST LEG TD	-Rectangle (1758x200)	1117.00	-1881.22	2277.47	465821.03	1707158.28	39	46	27.405 N	80 32 30.793 W
EASTCENTER TD	-Rectangle (3052x200)	1117.78	-3414.50	1494.88	464287.75	1706375.69	39	46	12.162 N	80 32 40.587 W
WEST CENTER TD	-Rectangle (2388x200)	1117.78	-3228.72	409.16	464473.53	1705289.97	39	46	13.873 N	80 32 54.519 W



Scientific Drilling
CBM Directional Operations

CNX Gas Company, LLC

Field: MARSHALL COUNTY, WV
Site: MC 1 WELL LOCATION
Well: ACCESS MC1 A2
Wellpath: West Center OH



TARGET DETAILS

Name	TVD	+N/S	+E/W	Northing	Easting	Shape
WEST CENTER TD1117.78	-3228.72	409.16	464473.53	1705289.97	1704303.97	Rectangle (2388x200)
WEST LEG TD	1117.78	-2803.03	-576.84	464899.22	1706375.69	Rectangle (1661x200)
EASTCENTER TD	1117.78	-3414.50	1494.88	464287.75	1707158.28	Rectangle (3052x200)
EAST LEG TD	1117.00	-1881.22	2277.47	465821.03	1707158.28	Rectangle (1758x200)

SITE DETAILS
MC-1 WELL LOCATION
Marshall Co., WV

Site Centre Northing: 467696.22
Easting: 1704867.47

Ground Level: 1371.91
Positional Uncertainty: 0.00
Convergence: -0.67

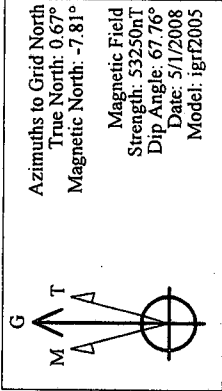

REFERENCE INFORMATION

Co-ordinate (N/E) Reference: Well Centre: ACCESS MC1 A2, Grid North
Vertical (TVD) Reference: GL 1372.69 + 10 1382.69
Section (VS) Reference: Slot - (0.00N,0.00E)
Measured Depth Reference: GL 1372.69 + 10 1382.69
Calculation Method: Minimum Curvature

Plot Date: 5/16/2008
By: Bob Feeney
Scientific Drilling, Inc.
800-876-7302
bob.feeney@scientificdrilling.com

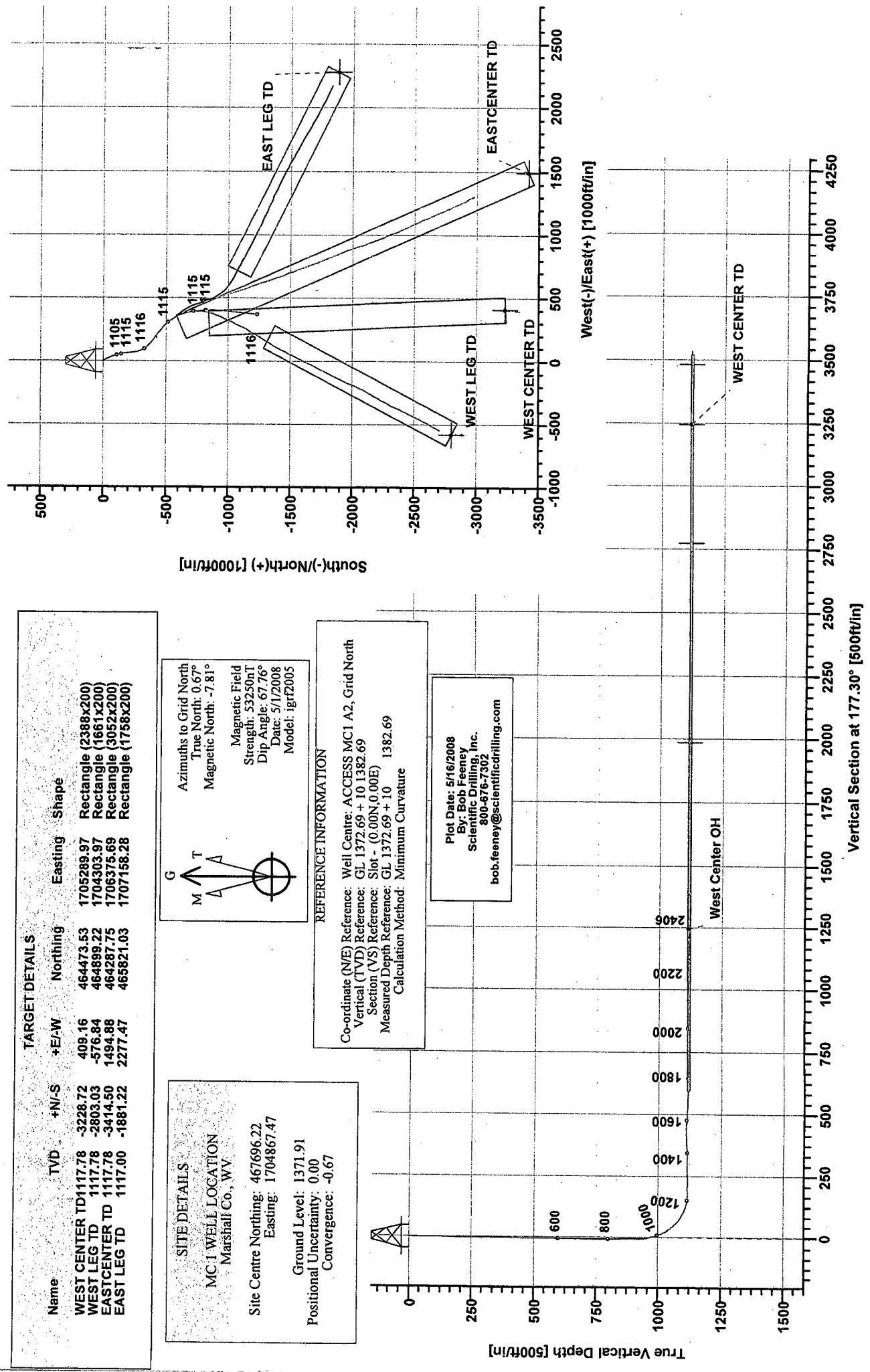

Scientific Drilling Survey Report

Company: CNX Gas Company, LLC Field: MARSHALL COUNTY, WV Site: MC 1 WELL LOCATION Well: ACCESS MC1 A2 Wellpath: West Center OH	Date: 5/16/2008 Co-ordinate(NE) Reference: Well: ACCESS MC1 A2, Grid North Vertical (TVD) Reference: GL 1372.69 + 10 1382.7 Section (VS) Reference: Well (0.00N,0.00E,177.30Azi) Survey Calculation Method: Minimum Curvature	Time: 08:59:51 Db: Sybase	Page: 1
---	--	--	----------------

Field: MARSHALL COUNTY, WV Northern West Virginia and Pennsylvania Operations U.S.A. Map System: US State Plane Coordinate System 1927 Geo Datum: NAD27 (Clarke 1866) Sys Datum: Mean Sea Level	Map Zone: West Virginia, Northern Zone Coordinate System: Well Centre Geomagnetic Model: igrf2005
--	--

Site: MC 1 WELL LOCATION
 Marshall Co., WV

Site Position:	From: Map	Northing: 467696.22 ft	Latitude: 39 46 45.674 N
Position Uncertainty:	0.00 ft	Easting: 1704867.47 ft	Longitude: 80 33 0.412 W
Ground Level:	1371.91 ft		North Reference: Grid
			Grid Convergence: -0.67 deg

Well: ACCESS MC1 A2	Slot Name:
Well Position:	Well Position:
+N/-S 6.03 ft	Northing: 467702.25 ft
+E/-W 13.34 ft	Easting: 1704880.81 ft
Position Uncertainty: 0.00 ft	Latitude: 39 46 45.735 N
	Longitude: 80 33 0.242 W

Wellpath: West Center OH	Drilled From: West Leg
Current Datum: GL 1372.69 + 10	Tie-on Depth: 1924.00 ft
Magnetic Data: 5/1/2008	Above System Datum: Mean Sea Level
Field Strength: 53250 nT	Declination: -8.48 deg
Vertical Section: Depth From (TVD)	Mag Dip Angle: 67.76 deg
ft	+N/-S
0.00	ft
	+E/-W
	ft
	Direction
	deg
	177.30

Survey Program for Definitive Wellpath			Version: 2		
Date:	Validated:	Actual From	To	Toolcode	Tool Name
5/11/2008	No	ft	ft		
		50.00	824.00	Survey #1 (0)	Drop Gyro-SYS
		824.00	1924.00	Survey #1 (2)	MWD-SDI-SYS
		1924.00	2406.00	Survey #1	MWD-SDI-SYS

MD	Incl	Azim	TVD	+N/-S	+E/-W	VS	DLS	Build	Turn	Tool/Comment
ft	deg	deg	ft	ft	ft	ft	deg/100ft	deg/100ft	deg/100ft	
0.00	0.81	90.30	0.00	0.00	0.00	0.00	0.00	0.00	0.00	TIE LINE
100.00	0.93	348.00	99.99	0.80	0.50	-0.77	1.36	0.12	-102.30	Drop Gyro-SYS
200.00	0.56	300.40	199.98	1.81	-0.28	-1.83	0.69	-0.37	-47.60	Drop Gyro-SYS
300.00	0.78	301.50	299.98	2.41	-1.28	-2.47	0.22	0.22	1.10	Drop Gyro-SYS
400.00	0.51	349.50	399.97	3.14	-1.73	-3.22	0.58	-0.27	48.00	Drop Gyro-SYS
500.00	0.62	349.80	499.97	4.28	-1.61	-4.35	0.11	0.11	0.30	Drop Gyro-SYS
600.00	0.22	267.70	599.96	4.90	-2.00	-4.99	0.63	-0.40	-82.10	Drop Gyro-SYS
700.00	0.29	29.80	699.96	4.98	-2.00	-5.06	0.45	0.07	122.10	Drop Gyro-SYS
800.00	0.54	125.60	799.96	5.14	-2.02	-5.23	0.64	0.25	95.80	Drop Gyro-SYS
900.00	0.48	310.23	899.96	4.55	-1.68	-4.62	1.02	-0.06	-175.37	MWD-SDI-SYS
1000.00	22.15	151.20	997.96	-8.78	5.90	9.05	22.60	21.67	-159.03	MWD-SDI-SYS
1100.00	51.37	158.30	1076.78	-62.49	32.01	63.92	29.49	29.22	7.10	MWD-SDI-SYS
1200.00	82.80	167.17	1115.59	-149.59	57.46	152.13	32.43	31.43	8.87	MWD-SDI-SYS
1300.00	90.86	170.79	1116.78	-248.60	70.69	251.65	8.83	8.06	3.61	MWD-SDI-SYS
1400.00	92.22	143.79	1115.85	-340.61	107.18	345.28	27.02	1.36	-26.99	MWD-SDI-SYS
1500.00	90.52	126.52	1111.50	-407.68	180.67	415.74	17.35	-1.70	-17.27	MWD-SDI-SYS
1600.00	87.36	130.97	1112.80	-468.13	260.22	479.87	5.46	-3.16	4.45	MWD-SDI-SYS
1700.00	88.42	144.65	1116.02	-541.68	327.53	556.51	13.71	1.06	13.67	MWD-SDI-SYS
1800.00	90.24	160.65	1116.92	-630.17	373.39	647.06	16.11	1.82	16.01	MWD-SDI-SYS
1900.00	91.34	175.85	1114.99	-727.55	394.69	745.33	15.23	1.10	15.19	MWD-SDI-SYS
2000.00	89.18	174.67	1115.11	-827.28	400.90	845.25	2.46	-2.16	-1.18	MWD-SDI-SYS

Scientific Drilling Survey Report

Company: CNX Gas Company, LLC Field: MARSHALL COUNTY, WV Site: MC 1 WELL LOCATION Well: ACCESS MC1 A2 Wellpath: West Center OH	Date: 5/16/2008 Co-ordinate(NE) Reference: Vertical (TVD) Reference: Section (VS) Reference: Survey Calculation Method:	Time: 08:59:51 Well: ACCESS MC1 A2, Grid North GL 1372.69 + 10 1382.7 Well (0.00N,0.00E,177.30Azi) Minimum Curvature	Page: 2 Db: Sybase
---	--	--	-------------------------------------

Survey

MD ft	Incl deg	Azim deg	TVD ft	+N/-S ft	+E/-W ft	VS ft	DLS deg/100ft	Build deg/100ft	Turn deg/100ft	Tool/Comment
2100.00	88.29	184.41	1119.07	-927.05	401.58	944.93	9.78	-0.89	9.74	MWD-SDI-SYS
2200.00	90.80	185.68	1118.84	-1026.59	392.17	1043.93	2.82	2.52	1.27	MWD-SDI-SYS
2300.00	91.09	184.99	1117.91	-1126.14	382.72	1142.92	0.74	0.29	-0.68	MWD-SDI-SYS
2400.00	90.84	185.13	1116.33	-1225.73	373.85	1241.98	0.29	-0.25	0.14	MWD-SDI-SYS
2406.00	90.84	185.13	1116.24	-1231.71	373.31	1247.93	0.00	0.00	0.00	MWD-SDI-SYS

Targets

Name	Description	TVD ft	+N/-S ft	+E/-W ft	Map Northing ft	Map Easting ft	<--- Latitude --->			<--- Longitude --->				
							Deg	Min	Sec	Deg	Min	Sec		
WEST CENTER TD	-Rectangle (2388x200)	1117.78	-3228.72	409.16	464473.53	1705289.97	39	46	13.873	N	80	32	54.519	W
WEST LEG TD	-Rectangle (1661x200)	1117.78	-2803.03	-576.84	464899.22	1704303.97	39	46	17.966	N	80	33	7.210	W
EASTCENTER TD	-Rectangle (3052x200)	1117.78	-3414.50	1494.88	464287.75	1706375.69	39	46	12.162	N	80	32	40.587	W
EAST LEG TD	-Rectangle (1758x200)	1117.00	-1881.22	2277.47	465821.03	1707158.28	39	46	27.405	N	80	32	30.793	W

Scientific Drilling Survey Report - Geographic

Company: CNX Gas Company, LLC	Date: 5/16/2008	Time: 09:01:37	Page: 1
Field: MARSHALL COUNTY, WV	Co-ordinate(NE) Reference: Well: ACCESS MC1 A2, Grid North		
Site: MC 1 WELL LOCATION	Vertical (TVD) Reference: GL 1372.69 + 10 1382.7		
Well: ACCESS MC1 A2	Section (VS) Reference: Well (0.00N,0.00E,177.30Azi)		
Wellpath: West Center OH	Survey Calculation Method: Minimum Curvature		Db: Sybase

Field: MARSHALL COUNTY, WV Northern West Virginia and Pennsylvania Operations U.S.A.	
Map System: US State Plane Coordinate System 1927	Map Zone: West Virginia, Northern Zone
Geo Datum: NAD27 (Clarke 1866)	Coordinate System: Well Centre
Sys Datum: Mean Sea Level	Geomagnetic Model: igrf2005

Site: MC 1 WELL LOCATION
Marshall Co., WV

Site Position:	Northing: 467696.22 ft	Latitude: 39 46 45.674 N
From: Map	Easting: 1704867.47 ft	Longitude: 80 33 0.412 W
Position Uncertainty: 0.00 ft		North Reference: Grid
Ground Level: 1371.91 ft		Grid Convergence: -0.67 deg

Well: ACCESS MC1 A2	Slot Name:	
Well Position: +N/-S 6.03 ft	Northing: 467702.25 ft	Latitude: 39 46 45.735 N
+E/-W 13.34 ft	Easting: 1704880.81 ft	Longitude: 80 33 0.242 W
Position Uncertainty: 0.00 ft		

Wellpath: West Center OH	Drilled From: West Leg		
Current Datum: GL 1372.69 + 10	Tie-on Depth: 1924.00 ft		
Magnetic Data: 5/1/2008	Above System Datum: Mean Sea Level		
Field Strength: 53250 nT	Declination: -8.48 deg		
Vertical Section: Depth From (TVD)	Mag Dip Angle: 67.76 deg		
ft	+N/-S	+E/-W	Direction
	ft	ft	deg
0.00	0.00	0.00	177.30

Survey Program for Definitive Wellpath		Version: 2
Date: 5/11/2008	Validated: No	Toolcode
Actual From	To	Tool Name
ft	ft	
50.00	824.00	Survey #1 (0) Drop Gyro-SYS Drop Gyro Systematic
824.00	1924.00	Survey #1 (2) MWD-SDI-SYS Scientific MWD Systematic
1924.00	2406.00	Survey #1 MWD-SDI-SYS Scientific MWD Systematic

Survey

MD ft	Incl deg	Azim deg	TVD ft	+N/-S ft	+E/-W ft	Map Northing ft	Map Easting ft	<--- Latitude --->			<--- Longitude --->		
								Deg	Min	Sec	Deg	Min	Sec
0.00	0.81	90.30	0.00	0.00	0.00	467702.25	1704880.81	39	46	45.735 N	80	33	0.242 W
100.00	0.93	348.00	99.99	0.80	0.50	467703.05	1704881.31	39	46	45.743 N	80	33	0.236 W
200.00	0.56	300.40	199.98	1.81	-0.28	467704.06	1704880.53	39	46	45.753 N	80	33	0.246 W
300.00	0.78	301.50	299.98	2.41	-1.28	467704.66	1704879.53	39	46	45.758 N	80	33	0.259 W
400.00	0.51	349.50	399.97	3.14	-1.73	467705.39	1704879.08	39	46	45.766 N	80	33	0.265 W
500.00	0.62	349.80	499.97	4.28	-1.61	467706.53	1704879.20	39	46	45.777 N	80	33	0.263 W
600.00	0.22	267.70	599.96	4.90	-2.00	467707.15	1704878.81	39	46	45.783 N	80	33	0.268 W
700.00	0.29	29.80	699.96	4.98	-2.00	467707.23	1704878.81	39	46	45.784 N	80	33	0.268 W
800.00	0.54	125.60	799.96	5.14	-2.02	467707.39	1704878.79	39	46	45.785 N	80	33	0.269 W
900.00	0.48	310.23	899.96	4.55	-1.68	467706.80	1704879.13	39	46	45.779 N	80	33	0.264 W
1000.00	22.15	151.20	997.96	-8.78	5.90	467693.47	1704886.71	39	46	45.649 N	80	33	0.165 W
1100.00	51.37	158.30	1076.78	-62.49	32.01	467639.76	1704912.82	39	46	45.121 N	80	32	59.823 W
1200.00	82.80	167.17	1115.59	-149.59	57.46	467552.66	1704938.27	39	46	44.263 N	80	32	59.484 W
1300.00	90.86	170.79	1116.78	-248.60	70.69	467453.65	1704951.50	39	46	43.286 N	80	32	59.299 W
1400.00	92.22	143.79	1115.85	-340.61	107.18	467361.64	1704987.99	39	46	42.381 N	80	32	58.818 W
1500.00	90.52	126.52	1111.50	-407.68	180.67	467294.57	1705061.48	39	46	41.727 N	80	32	57.867 W
1600.00	87.36	130.97	1112.80	-468.13	260.22	467234.12	1705141.03	39	46	41.138 N	80	32	56.839 W
1700.00	88.42	144.65	1116.02	-541.68	327.53	467160.57	1705208.34	39	46	40.419 N	80	32	55.966 W
1800.00	90.24	160.65	1116.92	-630.17	373.39	467072.08	1705254.20	39	46	39.550 N	80	32	55.366 W
1900.00	91.34	175.85	1114.99	-727.55	394.69	466974.70	1705275.50	39	46	38.590 N	80	32	55.078 W

Scientific Drilling Survey Report - Geographic

Company: CNX Gas Company, LLC Field: MARSHALL COUNTY, WV Site: MC 1 WELL LOCATION Well: ACCESS MC1 A2 Wellpath: West Center OH	Date: 5/16/2008 Co-ordinate(NE) Reference: Vertical (TVD) Reference: Section (VS) Reference: Survey Calculation Method:	Time: 09:01:37 Well: ACCESS MC1 A2, Grid North GL 1372.69 + 10 1382.7 Well (0.00N,0.00E,177.30Azi) Minimum Curvature	Page: 2 Db: Sybase
---	--	---	-------------------------------------

Survey

MD ft	Incl deg	Azim deg	TVD ft	+N/-S ft	+E/-W ft	Map Northing ft	Map Easting ft	<--- Latitude --->			<--- Longitude --->				
								Deg	Min	Sec	Deg	Min	Sec		
2000.00	89.18	174.67	1115.11	-827.28	400.90	466874.97	1705281.71	39	46	37.605	N	80	32	54.984	W
2100.00	88.29	184.41	1119.07	-927.05	401.58	466775.20	1705282.39	39	46	36.619	N	80	32	54.960	W
2200.00	90.80	185.68	1118.84	-1026.59	392.17	466675.66	1705272.98	39	46	35.634	N	80	32	55.066	W
2300.00	91.09	184.99	1117.91	-1126.14	382.72	466576.11	1705263.53	39	46	34.650	N	80	32	55.172	W
2400.00	90.84	185.13	1116.33	-1225.73	373.85	466476.52	1705254.66	39	46	33.664	N	80	32	55.271	W
2406.00	90.84	185.13	1116.24	-1231.71	373.31	466470.54	1705254.12	39	46	33.605	N	80	32	55.277	W

Targets

Name	Description	TVD ft	+N/-S ft	+E/-W ft	Map Northing ft	Map Easting ft	<--- Latitude --->			<--- Longitude --->				
							Deg	Min	Sec	Deg	Min	Sec		
WEST CENTER TD	-Rectangle (2388x200)	1117.78	-3228.72	409.16	464473.53	1705289.97	39	46	13.873	N	80	32	54.519	W
WEST LEG TD	-Rectangle (1661x200)	1117.78	-2803.03	-576.84	464899.22	1704303.97	39	46	17.966	N	80	33	7.210	W
EASTCENTER TD	-Rectangle (3052x200)	1117.78	-3414.50	1494.88	464287.75	1706375.69	39	46	12.162	N	80	32	40.587	W
EAST LEG TD	-Rectangle (1758x200)	1117.00	-1881.22	2277.47	465821.03	1707158.28	39	46	27.405	N	80	32	30.793	W



Scientific Drilling
CBM Directional Operations

CNX Gas Company, LLC

Field: MARSHALL COUNTY, WV
Site: MC 1 WELL LOCATION
Well: ACCESS MC1 A2
Wellpath: WEST CENTER STK



TARGET DETAILS						
Name	TVD	+N/-S	+E/-W	Northing	Eastng	Shape
PROPERTY LINE	1117.78	-3487.66	1519.44	464208.56	1706386.91	Point
EASTCENTER TD	1117.78	-3414.50	1494.88	464281.72	1706362.35	Rectangle (3052x200)
WEST CENTER TD	1117.78	-3228.72	409.16	464467.50	1705276.63	Rectangle (2388x200)
EAST LEG TD	1117.00	-1881.22	2277.47	465845.00	1707144.94	Rectangle (1756x200)
INTERCEPT TD	1117.00	-424.48	183.06	467271.74	1705050.53	Circle (Radius: 1)
WEST LEG TD	1117.78	-2803.03	-576.84	464893.19	1704290.63	Rectangle (1661x200)

SITE DETAILS

MC 1 WELL LOCATION
Marshall Co., WV

Site Centre Northing: 467696.22
Eastng: 1704867.47

Ground Level: 1371.91
Positional Uncertainty: 0.00
Convergence: -0.67

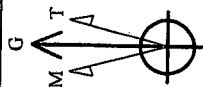

Azimuths to Grid North
True North: 0.67°
Magnetic North: -7.81°
Magnetic Field
Strength: 53247nT
Dip Angle: 67.76°
Date: 5/11/2008
Model: :igr2005

REFERENCE INFORMATION

Co-ordinate (N/E) Reference: Well Centre: ACCESS MC1 A2, Grid North
Vertical (TVD) Reference: GL 1372.69 + 10 1382.69
Section (VS) Reference: Slot - (0.00N,0.00E)
Measured Depth Reference: GL 1372.69 + 10 1382.69
Calculation Method: Minimum Curvature

Plot Date: 5/16/2008
By: Bob Feeney
Scientific Drilling, Inc.
800-676-7302
bob.feeney@scientificdrilling.com

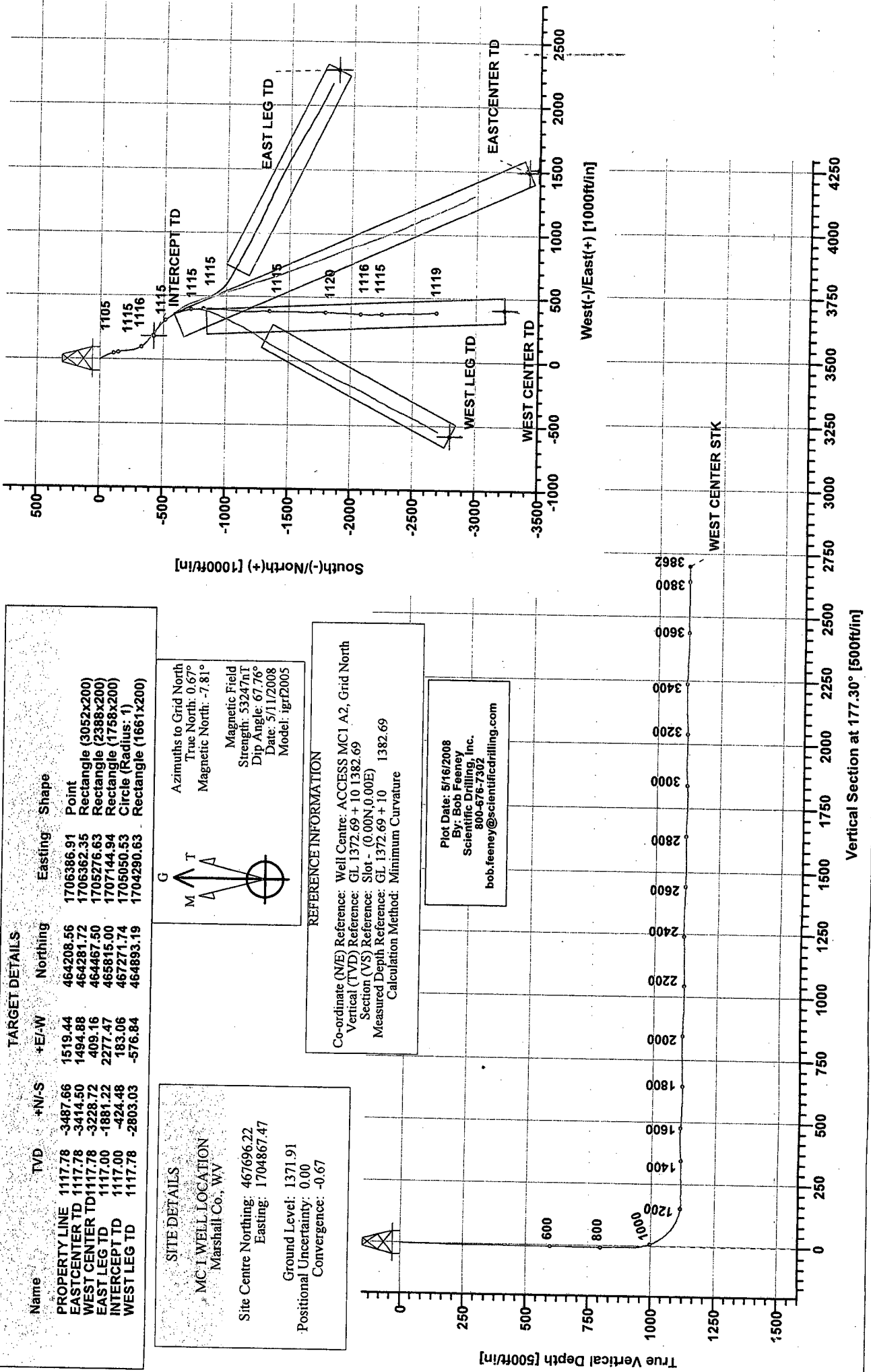

Scientific Drilling Survey Report

Company: CNX Gas Company, LLC	Date: 5/16/2008	Time: 09:19:23	Page: 1
Field: MARSHALL COUNTY, WV	Co-ordinate(NE) Reference: Well: ACCESS MC1 A2, Grid North		
Site: MC 1 WELL LOCATION	Vertical (TVD) Reference: GL 1372.69 + 10 1382.7		
Well: ACCESS MC1 A2	Section (VS) Reference: Well (0.00N,0.00E,177.30Azi)		
Wellpath: WEST CENTER STK	Survey Calculation Method: Minimum Curvature	Db: Sybase	

Field: MARSHALL COUNTY, WV Northern West Virginia and Pennsylvania Operations U.S.A.	
Map System: US State Plane Coordinate System 1927	Map Zone: West Virginia, Northern Zone
Geo Datum: NAD27 (Clarke 1866)	Coordinate System: Well Centre
Sys Datum: Mean Sea Level	Geomagnetic Model: igrf2005

Site: MC 1 WELL LOCATION
Marshall Co., WV

Site Position:	Northing: 467696.22 ft	Latitude: 39 46 45.674 N
From: Map	Easting: 1704867.47 ft	Longitude: 80 33 0.412 W
Position Uncertainty: 0.00 ft		North Reference: Grid
Ground Level: 1371.91 ft		Grid Convergence: -0.67 deg

Well: ACCESS MC1 A2	Slot Name:
Well Position: +N/-S 6.03 ft	Latitude: 39 46 45.735 N
+E/-W 13.34 ft	Longitude: 80 33 0.242 W
Position Uncertainty: 0.00 ft	

Wellpath: WEST CENTER STK	Drilled From: West Center OH		
Current Datum: GL 1372.69 + 10	Tie-on Depth: 2271.00 ft		
Magnetic Data: 5/11/2008	Above System Datum: Mean Sea Level		
Field Strength: 53247 nT	Declination: -8.48 deg		
Vertical Section: Depth From (TVD)	Mag Dip Angle: 67.76 deg		
ft	+N/-S	+E/-W	Direction
	ft	ft	deg
0.00	0.00	0.00	177.30

Survey Program for Definitive Wellpath					
Date: 5/11/2008		Validated: No		Version: 0	
Actual From	To	Survey	Toolcode	Tool Name	
ft	ft				
50.00	824.00	Survey #1 (0)	Drop Gyro-SYS	Drop Gyro Systematic	
824.00	1924.00	Survey #1 (2)	MWD-SDI-SYS	Scientific MWD Systematic	
1924.00	2271.00	Survey #1 (3)	MWD-SDI-SYS	Scientific MWD Systematic	
2271.00	3862.00	Survey #1	MWD-SDI-SYS	Scientific MWD Systematic	

Survey										
MD	Incl	Azim	TVD	+N/-S	+E/-W	VS	DLS	Build	Turn	Tool/Comment
ft	deg	deg	ft	ft	ft	ft	deg/100ft	deg/100ft	deg/100ft	
0.00	0.81	90.30	0.00	0.00	0.00	0.00	0.00	0.00	0.00	TIE LINE
100.00	0.93	348.00	99.99	0.80	0.50	-0.77	1.36	0.12	-102.30	Drop Gyro-SYS
200.00	0.56	300.40	199.98	1.81	-0.28	-1.83	0.69	-0.37	-47.60	Drop Gyro-SYS
300.00	0.78	301.50	299.98	2.41	-1.28	-2.47	0.22	0.22	1.10	Drop Gyro-SYS
400.00	0.51	349.50	399.97	3.14	-1.73	-3.22	0.58	-0.27	48.00	Drop Gyro-SYS
500.00	0.62	349.80	499.97	4.28	-1.61	-4.35	0.11	0.11	0.30	Drop Gyro-SYS
600.00	0.22	267.70	599.96	4.90	-2.00	-4.99	0.63	-0.40	-82.10	Drop Gyro-SYS
700.00	0.29	29.80	699.96	4.98	-2.00	-5.06	0.45	0.07	122.10	Drop Gyro-SYS
800.00	0.54	125.60	799.96	5.14	-2.02	-5.23	0.64	0.25	95.80	Drop Gyro-SYS
900.00	0.48	310.23	899.96	4.55	-1.68	-4.62	1.02	-0.06	-175.37	MWD-SDI-SYS
1000.00	22.15	151.20	997.96	-8.78	5.90	9.05	22.60	21.67	-159.03	MWD-SDI-SYS
1100.00	51.37	158.30	1076.78	-62.49	32.01	63.92	29.49	29.22	7.10	MWD-SDI-SYS
1200.00	82.80	167.17	1115.59	-149.59	57.46	152.13	32.43	31.43	8.87	MWD-SDI-SYS
1300.00	90.86	170.79	1116.78	-248.60	70.69	251.65	8.83	8.06	3.61	MWD-SDI-SYS
1400.00	92.22	143.79	1115.85	-340.61	107.18	345.28	27.02	1.36	-26.99	MWD-SDI-SYS
1500.00	90.52	126.52	1111.50	-407.68	180.67	415.74	17.35	-1.70	-17.27	MWD-SDI-SYS
1600.00	87.36	130.97	1112.80	-468.13	260.22	479.87	5.46	-3.16	4.45	MWD-SDI-SYS
1700.00	88.42	144.65	1116.02	-541.68	327.53	556.51	13.71	1.06	13.67	MWD-SDI-SYS
1800.00	90.24	160.65	1116.92	-630.17	373.39	647.06	16.11	1.82	16.01	MWD-SDI-SYS
1900.00	91.34	175.85	1114.99	-727.55	394.69	745.33	15.23	1.10	15.19	MWD-SDI-SYS

Scientific Drilling Survey Report

Company: CNX Gas Company, LLC
Field: MARSHALL COUNTY, WV
Site: MC 1 WELL LOCATION
Well: ACCESS MC1 A2
Wellpath: WEST CENTER STK

Date: 5/16/2008 **Time:** 09:19:23 **Page:** 2
Co-ordinate(NE) Reference: Well: ACCESS MC1 A2, Grid North
Vertical (TVD) Reference: GL 1372.69 + 10 1382.7
Section (VS) Reference: Well (0.00N,0.00E,177.30Azi)
Survey Calculation Method: Minimum Curvature **Db:** Sybase

Survey

MD ft	Incl deg	Azim deg	TVD ft	+N/-S ft	+E/-W ft	VS ft	DLS deg/100ft	Build deg/100ft	Turn deg/100ft	Tool/Comment
2000.00	89.18	174.67	1115.11	-827.28	400.90	845.25	2.46	-2.16	-1.18	MWD-SDI-SYS
2100.00	88.29	184.41	1119.07	-927.05	401.58	944.93	9.78	-0.89	9.74	MWD-SDI-SYS
2200.00	90.80	185.68	1118.84	-1026.59	392.17	1043.93	2.82	2.52	1.27	MWD-SDI-SYS
2300.00	90.97	185.21	1117.95	-1126.14	382.67	1142.91	0.50	0.17	-0.47	MWD-SDI-SYS
2400.00	92.66	175.17	1115.09	-1225.94	382.40	1242.59	10.17	1.69	-10.04	MWD-SDI-SYS
2500.00	89.18	180.91	1114.50	-1325.74	387.05	1342.50	6.72	-3.48	5.75	MWD-SDI-SYS
2600.00	89.13	180.20	1117.30	-1425.68	385.33	1442.25	0.71	-0.05	-0.71	MWD-SDI-SYS
2700.00	90.48	181.37	1119.37	-1525.65	384.72	1542.08	1.78	1.35	1.17	MWD-SDI-SYS
2800.00	89.58	180.20	1117.23	-1625.59	382.41	1641.79	1.47	-0.90	-1.17	MWD-SDI-SYS
2900.00	88.76	179.15	1120.22	-1725.52	383.82	1741.69	1.33	-0.82	-1.05	MWD-SDI-SYS
3000.00	92.05	180.99	1119.14	-1825.43	381.22	1841.36	3.76	3.29	1.84	MWD-SDI-SYS
3100.00	88.67	182.58	1116.26	-1925.32	378.15	1940.99	3.73	-3.38	1.59	MWD-SDI-SYS
3200.00	90.87	184.35	1117.73	-2025.16	373.07	2040.49	2.83	2.20	1.78	MWD-SDI-SYS
3300.00	90.54	181.26	1114.70	-2124.85	366.17	2139.74	3.10	-0.33	-3.09	MWD-SDI-SYS
3400.00	89.96	177.47	1114.95	-2224.79	368.74	2239.69	3.84	-0.58	-3.80	MWD-SDI-SYS
3500.00	87.59	176.55	1117.03	-2324.63	373.77	2339.66	2.53	-2.36	-0.92	MWD-SDI-SYS
3600.00	90.91	178.92	1118.91	-2424.50	378.12	2439.62	4.07	3.32	2.37	MWD-SDI-SYS
3700.00	88.62	179.54	1118.19	-2524.48	379.19	2539.54	2.37	-2.29	0.62	MWD-SDI-SYS
3800.00	90.90	176.56	1119.26	-2624.38	382.28	2639.48	3.75	2.28	-2.98	MWD-SDI-SYS
3862.00	90.20	176.05	1118.92	-2686.24	386.46	2701.46	1.41	-1.14	-0.83	MWD-SDI-SYS

Scientific Drilling Survey Report - Geographic

Company: CNX Gas Company, LLC	Date: 5/16/2008	Time: 09:21:20	Page: 1
Field: MARSHALL COUNTY, WV	Co-ordinate(NE) Reference:	Well: ACCESS MC1 A2, Grid North	
Site: MC 1 WELL LOCATION	Vertical (TVD) Reference:	GL 1372.69 + 10 1382.7	
Well: ACCESS MC1 A2	Section (VS) Reference:	Well (0.00N,0.00E,177.30Azi)	
Wellpath: WEST CENTER STK	Survey Calculation Method:	Minimum Curvature	Db: Sybase

Field: MARSHALL COUNTY, WV Northern West Virginia and Pennsylvania Operations U.S.A.		Map Zone: West Virginia, Northern Zone
Map System: US State Plane Coordinate System 1927	Geo Datum: NAD27 (Clarke 1866)	Coordinate System: Well Centre
Sys Datum: Mean Sea Level		Geomagnetic Model: igrf2005

Site: MC 1 WELL LOCATION

Marshall Co., WV

Site Position:	Northing: 467696.22 ft	Latitude: 39 46 45.674 N
From: Map	Easting: 1704867.47 ft	Longitude: 80 33 0.412 W
Position Uncertainty: 0.00 ft		North Reference: Grid
Ground Level: 1371.91 ft		Grid Convergence: -0.67 deg

Well: ACCESS MC1 A2

Slot Name:

Well Position: +N-S 6.03 ft	Northing: 467702.25 ft	Latitude: 39 46 45.735 N
+E-W 13.34 ft	Easting: 1704880.81 ft	Longitude: 80 33 0.242 W
Position Uncertainty: 0.00 ft		

Wellpath: WEST CENTER STK

Current Datum: GL 1372.69 + 10	Height 1382.69 ft	Drilled From: West Center OH
Magnetic Data: 5/11/2008		Tie-on Depth: 2271.00 ft
Field Strength: 53247 nT		Above System Datum: Mean Sea Level
Vertical Section: Depth From (TVD)	+N-S	Declination: -8.48 deg
ft	ft	Mag Dip Angle: 67.76 deg
		+E-W
		Direction
		deg
0.00	0.00	0.00
		177.30

Survey Program for Definitive Wellpath

Date: 5/11/2008	Validated: No	Version: 0
Actual From To	Survey	Toolcode
ft ft		Tool Name
50.00 824.00	Survey #1 (0)	Drop Gyro-SYS
824.00 1924.00	Survey #1 (2)	MWD-SDI-SYS
1924.00 2271.00	Survey #1 (3)	MWD-SDI-SYS
2271.00 3862.00	Survey #1	MWD-SDI-SYS
		Drop Gyro Systematic
		Scientific MWD Systematic
		Scientific MWD Systematic
		Scientific MWD Systematic

Survey

MD ft	Incl deg	Azim deg	TVD ft	+N-S ft	+E-W ft	Map Northing ft	Map Easting ft	←←← Latitude →→→			←←← Longitude →→→		
								Deg	Min	Sec	Deg	Min	Sec
0.00	0.81	90.30	0.00	0.00	0.00	467702.25	1704880.81	39	46	45.735 N	80	33	0.242 W
100.00	0.93	348.00	99.99	0.80	0.50	467703.05	1704881.31	39	46	45.743 N	80	33	0.236 W
200.00	0.56	300.40	199.98	1.81	-0.28	467704.06	1704880.53	39	46	45.753 N	80	33	0.246 W
300.00	0.78	301.50	299.98	2.41	-1.28	467704.66	1704879.53	39	46	45.758 N	80	33	0.259 W
400.00	0.51	349.50	399.97	3.14	-1.73	467705.39	1704879.08	39	46	45.766 N	80	33	0.265 W
500.00	0.62	349.80	499.97	4.28	-1.61	467706.53	1704879.20	39	46	45.777 N	80	33	0.263 W
600.00	0.22	267.70	599.96	4.90	-2.00	467707.15	1704878.81	39	46	45.783 N	80	33	0.268 W
700.00	0.29	29.80	699.96	4.98	-2.00	467707.23	1704878.81	39	46	45.784 N	80	33	0.268 W
800.00	0.54	125.60	799.96	5.14	-2.02	467707.39	1704878.79	39	46	45.785 N	80	33	0.269 W
900.00	0.48	310.23	899.96	4.55	-1.68	467706.80	1704879.13	39	46	45.779 N	80	33	0.264 W
1000.00	22.15	151.20	997.96	-8.78	5.90	467693.47	1704886.71	39	46	45.649 N	80	33	0.165 W
1100.00	51.37	158.30	1076.78	-62.49	32.01	467639.76	1704912.82	39	46	45.121 N	80	32	59.823 W
1200.00	82.80	167.17	1115.59	-149.59	57.46	467552.66	1704938.27	39	46	44.263 N	80	32	59.484 W
1300.00	90.86	170.79	1116.78	-248.60	70.69	467453.65	1704951.50	39	46	43.286 N	80	32	59.299 W
1400.00	92.22	143.79	1115.85	-340.61	107.18	467361.64	1704987.99	39	46	42.381 N	80	32	58.818 W
1500.00	90.52	126.52	1111.50	-407.68	180.67	467294.57	1705061.48	39	46	41.727 N	80	32	57.867 W
1600.00	87.36	130.97	1112.80	-468.13	260.22	467234.12	1705141.03	39	46	41.138 N	80	32	56.839 W
1700.00	88.42	144.65	1116.02	-541.68	327.53	467160.57	1705208.34	39	46	40.419 N	80	32	55.966 W
1800.00	90.24	160.65	1116.92	-630.17	373.39	467072.08	1705254.20	39	46	39.550 N	80	32	55.366 W
1900.00	91.34	175.85	1114.99	-727.55	394.69	466974.70	1705275.50	39	46	38.590 N	80	32	55.078 W

Scientific Drilling Survey Report - Geographic

Company: CNX Gas Company, LLC Field: MARSHALL COUNTY, WV Site: MC 1 WELL LOCATION Well: ACCESS MC1 A2 Wellpath: WEST CENTER STK	Date: 5/16/2008 Co-ordinate(NE) Reference: Vertical (TVD) Reference: Section (VS) Reference: Survey Calculation Method:	Time: 09:21:20 Well: ACCESS MC1 A2, Grid North GL 1372.69 + 10 1382.7 Well (0.00N,0.00E,177.30Azi) Minimum Curvature	Page: 2 Db: Sybase
--	--	---	-------------------------------------

Survey

MD ft	Incl deg	Azim deg	TVD ft	+N/-S ft	+E/-W ft	Map Northing ft	Map Easting ft	<--- Latitude --->			<--- Longitude --->		
								Deg	Min	Sec	Deg	Min	Sec
2000.00	89.18	174.67	1115.11	-827.28	400.90	466874.97	1705281.71	39	46	37.605 N	80	32	54.984 W
2100.00	88.29	184.41	1119.07	-927.05	401.58	466775.20	1705282.39	39	46	36.619 N	80	32	54.960 W
2200.00	90.80	185.68	1118.84	-1026.59	392.17	466675.66	1705272.98	39	46	35.634 N	80	32	55.066 W
2300.00	90.97	185.21	1117.95	-1126.14	382.67	466576.11	1705263.48	39	46	34.650 N	80	32	55.173 W
2400.00	92.66	175.17	1115.09	-1225.94	382.40	466476.31	1705263.21	39	46	33.663 N	80	32	55.161 W
2500.00	89.18	180.91	1114.50	-1325.74	387.05	466376.51	1705267.86	39	46	32.677 N	80	32	55.087 W
2600.00	89.13	180.20	1117.30	-1425.68	385.33	466276.57	1705266.14	39	46	31.690 N	80	32	55.094 W
2700.00	90.48	181.37	1119.37	-1525.65	384.72	466176.60	1705265.53	39	46	30.702 N	80	32	55.086 W
2800.00	89.58	180.20	1117.23	-1625.59	382.41	466076.66	1705263.22	39	46	29.714 N	80	32	55.101 W
2900.00	88.76	179.15	1120.22	-1725.52	383.82	465976.73	1705264.63	39	46	28.726 N	80	32	55.068 W
3000.00	92.05	180.99	1119.14	-1825.43	381.22	465876.82	1705262.03	39	46	27.738 N	80	32	55.087 W
3100.00	88.67	182.58	1116.26	-1925.32	378.15	465776.93	1705258.96	39	46	26.751 N	80	32	55.111 W
3200.00	90.87	184.35	1117.73	-2025.16	373.07	465677.09	1705253.88	39	46	25.764 N	80	32	55.161 W
3300.00	90.54	181.26	1114.70	-2124.85	366.17	465577.40	1705246.98	39	46	24.778 N	80	32	55.235 W
3400.00	89.96	177.47	1114.95	-2224.79	368.74	465477.46	1705249.55	39	46	23.790 N	80	32	55.187 W
3500.00	87.59	176.55	1117.03	-2324.63	373.77	465377.62	1705254.58	39	46	22.804 N	80	32	55.107 W
3600.00	90.91	178.92	1118.91	-2424.50	378.12	465277.75	1705258.93	39	46	21.818 N	80	32	55.037 W
3700.00	88.62	179.54	1118.19	-2524.48	379.19	465177.77	1705260.00	39	46	20.830 N	80	32	55.008 W
3800.00	90.90	176.56	1119.26	-2624.38	382.28	465077.87	1705263.09	39	46	19.843 N	80	32	54.953 W
3862.00	90.20	176.05	1118.92	-2686.24	386.46	465016.01	1705267.27	39	46	19.232 N	80	32	54.891 W



Scientific Drilling
CBM Directional Operations

CNX Gas Company, LLC

Field: MARSHALL COUNTY, WV
Site: MC 1 WELL LOCATION
Well: ACCESS MC1 A2
Wellpath: EAST LEG



TARGET DETAILS

Name	TVD	+N/S	+E/W	Northing	Easting	Shape
PROPERTY LINE	1117.78	-3487.66	1519.44	464208.56	1706386.91	Point
EASTCENTER TD	1117.78	-3414.50	1494.88	464281.72	1706362.35	Rectangle (3052x200)
WEST CENTER TD	1117.78	-3228.72	409.16	464467.50	1705276.63	Rectangle (2388x200)
EAST LEG TD	1117.00	-1881.22	2277.47	465815.00	1707144.94	Rectangle (1758x200)
INTERCEPT TD	1117.00	-424.48	183.06	467271.74	1705050.53	Circle (Radius: 1)
WEST LEG TD	1117.78	-2803.03	-576.84	464893.19	1704290.63	Rectangle (1661x200)

SITE DETAILS

MC 1 WELL LOCATION
Marshall Co., WV

Site Centre Northing: 467696.22
Easting: 1704867.47

Ground Level: 1371.91
Positional Uncertainty: 0.00
Convergence: -0.67

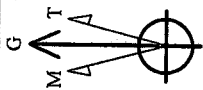

Azimuths to Grid North
True North: 0.67°
Magnetic North: -7.81°
Magnetic Field
Strength: 5325 nT
Dip Angle: 67.76°
Date: 4/30/2008
Model: igrf2005

REFERENCE INFORMATION

Co-ordinate (N/E) Reference: Well Centre: ACCESS MC1 A2, Grid North
Vertical (TVD) Reference: GL 1372.69 + 10 1382.69
Section (VS) Reference: Slot - (0.00N,0.00E)
Measured Depth Reference: GL 1372.69 + 10 1382.69
Calculation Method: Minimum Curvature

Plot Date: 5/19/2008
By: Bob Feeney
Scientific Drilling, Inc.
800-576-7302
bob.feeney@scientificdrilling.com

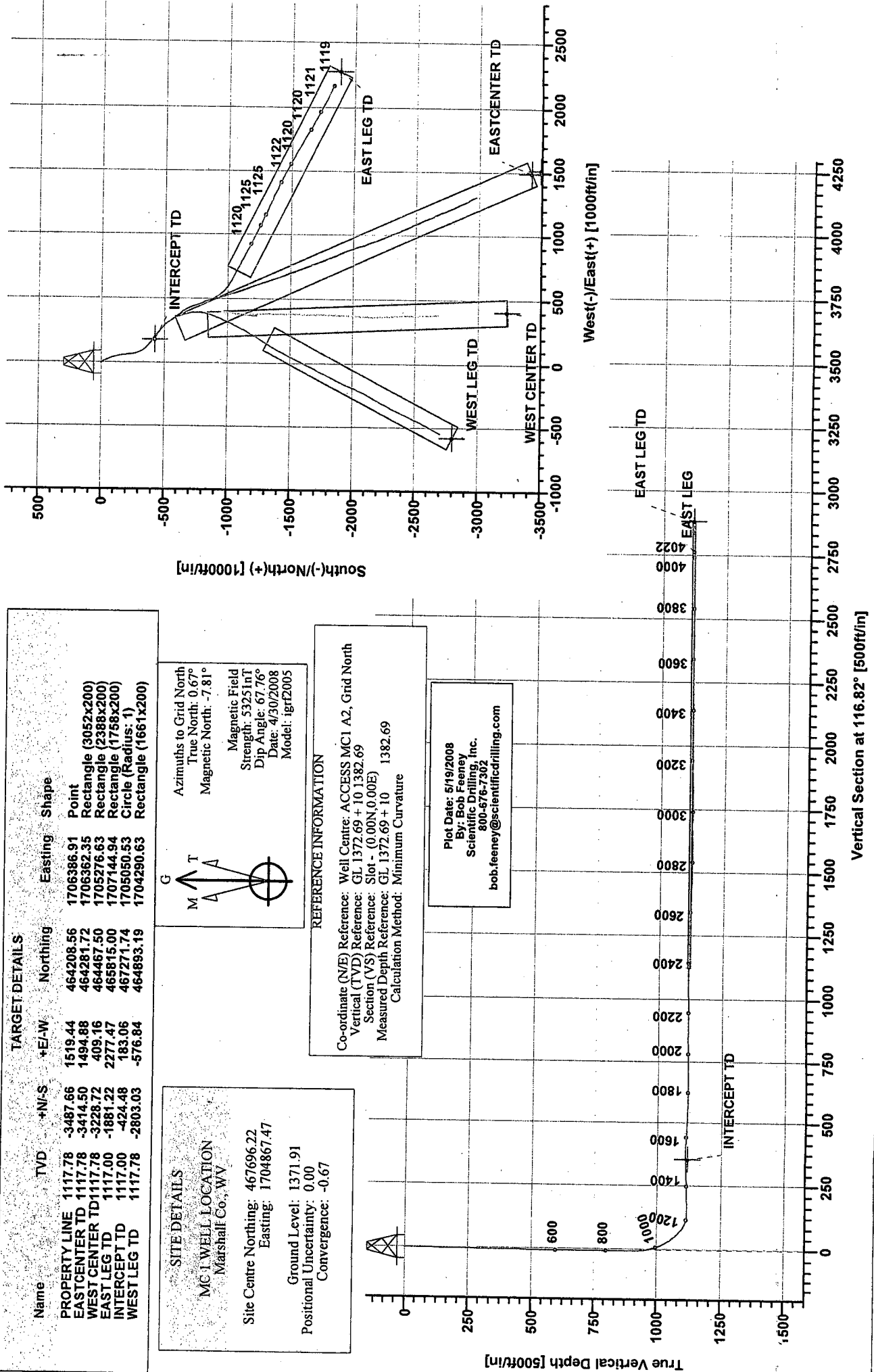

Scientific Drilling Survey Report

Company: CNX Gas Company, LLC	Date: 5/19/2008	Time: 07:23:34	Page: 1
Field: MARSHALL COUNTY, WV	Co-ordinate(NE) Reference:	Well: ACCESS MC1 A2, Grid North	
Site: MC 1 WELL LOCATION	Vertical (TVD) Reference:	GL 1372.69 + 10 1382.7	
Well: ACCESS MC1 A2	Section (VS) Reference:	Well (0.00N,0.00E,116.82Azi)	
Wellpath: EAST LEG	Survey Calculation Method:	Minimum Curvature	Db: Sybase

Field: MARSHALL COUNTY, WV Northern West Virginia and Pennsylvania Operations U.S.A.		Map Zone: West Virginia, Northern Zone
Map System: US State Plane Coordinate System 1927	Map Zone:	West Virginia, Northern Zone
Geo Datum: NAD27 (Clarke 1866)	Coordinate System:	Well Centre
Sys Datum: Mean Sea Level	Geomagnetic Model:	igrf2005

Site: MC 1 WELL LOCATION

Marshall Co., WV

Site Position:	Northing: 467696.22 ft	Latitude: 39 46 45.674 N
From: Map	Easting: 1704867.47 ft	Longitude: 80 33 0.412 W
Position Uncertainty: 0.00 ft		North Reference: Grid
Ground Level: 1371.91 ft		Grid Convergence: -0.67 deg

Well: ACCESS MC1 A2

Slot Name:

Well Position: +N/-S 6.03 ft	Northing: 467702.25 ft	Latitude: 39 46 45.735 N
+E/-W 13.34 ft	Easting: 1704880.81 ft	Longitude: 80 33 0.242 W
Position Uncertainty: 0.00 ft		

Wellpath: EAST LEG

Current Datum: GL 1372.69 + 10	Height 1382.69 ft	Drilled From: East Center	
Magnetic Data: 4/30/2008		Tie-on Depth: 2048.00 ft	
Field Strength: 53251 nT		Above System Datum: Mean Sea Level	
Vertical Section: Depth From (TVD)	+N/-S	Declination: -8.48 deg	
ft	ft	Mag Dip Angle: 67.76 deg	
		+E/-W	Direction
		ft	deg
1382.69	0.00	0.00	116.82

Survey Program for Definitive Wellpath

Date: 5/16/2008	Validated: No	Version: 7	
Actual From	To	Survey	Toolcode
ft	ft		Tool Name
50.00	824.00	Survey #1	Drop Gyro-SYS
824.00	1734.00	Survey #1 (2)	Drop Gyro Systematic
1734.00	2048.00	Survey #1 (1)	MWD-SDI-SYS
2082.00	4022.00	Survey #2	MWD-SDI-SYS
			Scientific MWD Systematic
			Scientific MWD Systematic
			Scientific MWD Systematic

Survey

MD ft	Incl deg	Azim deg	TVD ft	+N/-S ft	+E/-W ft	VS ft	DLS deg/100ft	Build deg/100ft	Turn deg/100ft	Tool/Comment
0.00	0.81	90.30	0.00	0.00	0.00	0.00	0.00	0.00	0.00	TIE LINE
100.00	0.93	348.00	99.99	0.80	0.50	0.09	1.36	0.12	-102.30	Drop Gyro-SYS
200.00	0.56	300.40	199.98	1.81	-0.28	-1.07	0.69	-0.37	-47.60	Drop Gyro-SYS
300.00	0.78	301.50	299.98	2.41	-1.28	-2.23	0.22	0.22	1.10	Drop Gyro-SYS
400.00	0.51	349.50	399.97	3.14	-1.73	-2.96	0.58	-0.27	48.00	Drop Gyro-SYS
500.00	0.62	349.80	499.97	4.28	-1.61	-3.37	0.11	0.11	0.30	Drop Gyro-SYS
600.00	0.22	267.70	599.96	4.90	-2.00	-3.99	0.63	-0.40	-82.10	Drop Gyro-SYS
700.00	0.29	29.80	699.96	4.98	-2.00	-4.03	0.45	0.07	122.10	Drop Gyro-SYS
800.00	0.54	125.60	799.96	5.14	-2.02	-4.13	0.64	0.25	95.80	Drop Gyro-SYS
900.00	0.48	310.23	899.96	4.55	-1.68	-3.55	1.02	-0.06	-175.37	MWD-SDI-SYS
1000.00	22.15	151.20	997.96	-8.78	5.90	9.23	22.60	21.67	-159.03	MWD-SDI-SYS
1100.00	51.37	158.30	1076.78	-62.49	32.01	56.76	29.49	29.22	7.10	MWD-SDI-SYS
1200.00	82.80	167.17	1115.59	-149.59	57.46	118.77	32.43	31.43	8.87	MWD-SDI-SYS
1300.00	90.86	170.79	1116.78	-248.60	70.69	175.25	8.83	8.06	3.61	MWD-SDI-SYS
1400.00	92.22	143.79	1115.85	-340.61	107.18	249.33	27.02	1.36	-26.99	MWD-SDI-SYS
1500.00	90.52	126.52	1111.50	-407.68	180.67	345.17	17.35	-1.70	-17.27	MWD-SDI-SYS
1600.00	87.36	130.97	1112.80	-468.13	260.22	443.45	5.46	-3.16	4.45	MWD-SDI-SYS
1700.00	88.42	144.65	1116.02	-541.68	327.53	536.70	13.71	1.06	13.67	MWD-SDI-SYS
1800.00	90.75	140.39	1117.66	-623.51	384.71	624.65	4.85	2.33	-4.26	MWD-SDI-SYS
1900.00	88.44	156.75	1117.49	-708.19	437.16	709.66	16.52	-2.31	16.36	MWD-SDI-SYS

Scientific Drilling Survey Report - Geographic

Company: CNX Gas Company, LLC	Date: 5/19/2008	Time: 07:25:32	Page: 1
Field: MARSHALL COUNTY, WV	Co-ordinate(NE) Reference: Well: ACCESS MC1 A2, Grid North		
Site: MC 1 WELL LOCATION	Vertical (TVD) Reference: GL 1372.69 + 10 1382.7		
Well: ACCESS MC1 A2	Section (VS) Reference: Well (0.00N,0.00E,116.82Azi)		
Wellpath: EAST LEG	Survey Calculation Method: Minimum Curvature	Db: Sybase	

Field: MARSHALL COUNTY, WV Northern West Virginia and Pennsylvania Operations U.S.A.		
Map System: US State Plane Coordinate System 1927	Map Zone: West Virginia, Northern Zone	
Geo Datum: NAD27 (Clarke 1866)	Coordinate System: Well Centre	
Sys Datum: Mean Sea Level	Geomagnetic Model: igrf2005	

Site: MC 1 WELL LOCATION Marshall Co., WV			
Site Position:	Northing: 467696.22 ft	Latitude: 39 46 45.674 N	
From: Map	Easting: 1704867.47 ft	Longitude: 80 33 0.412 W	
Position Uncertainty: 0.00 ft		North Reference: Grid	
Ground Level: 1371.91 ft		Grid Convergence: -0.67 deg	

Well: ACCESS MC1 A2				Slot Name:			
Well Position:	+N/-S 6.03 ft	Northing: 467702.25 ft	Latitude: 39 46 45.735 N	+E/-W 13.34 ft	Easting: 1704880.81 ft	Longitude: 80 33 0.242 W	
Position Uncertainty: 0.00 ft							

Wellpath: EAST LEG				Drilled From: East Center			
				Tie-on Depth: 2048.00 ft			
Current Datum: GL 1372.69 + 10				Above System Datum: Mean Sea Level			
Magnetic Data: 4/30/2008				Declination: -8.48 deg			
Field Strength: 53251 nT				Mag Dip Angle: 67.76 deg			
Vertical Section:	Depth From (TVD)	+N/-S	+E/-W	Direction			
	ft	ft	ft	deg			
	1382.69	0.00	0.00	116.82			

Survey Program for Definitive Wellpath					
Date: 5/16/2008		Validated: No		Version: 7	
Actual From	To	Survey	Toolcode	Tool Name	
ft	ft				
50.00	824.00	Survey #1	Drop Gyro-SYS	Drop Gyro Systematic	
824.00	1734.00	Survey #1 (2)	MWD-SDI-SYS	Scientific MWD Systematic	
1734.00	2048.00	Survey #1 (1)	MWD-SDI-SYS	Scientific MWD Systematic	
2082.00	4022.00	Survey #2	MWD-SDI-SYS	Scientific MWD Systematic	

Survey

MD ft	Incl deg	Azim deg	TVD ft	+N/-S ft	+E/-W ft	Map Northing ft	Map Easting ft	←← Latitude →→			←← Longitude →→		
								Deg	Min	Sec	Deg	Min	Sec
0.00	0.81	90.30	0.00	0.00	0.00	467702.25	1704880.81	39	46	45.735 N	80	33	0.242 W
100.00	0.93	348.00	99.99	0.80	0.50	467703.05	1704881.31	39	46	45.743 N	80	33	0.236 W
200.00	0.56	300.40	199.98	1.81	-0.28	467704.06	1704880.53	39	46	45.753 N	80	33	0.246 W
300.00	0.78	301.50	299.98	2.41	-1.28	467704.66	1704879.53	39	46	45.758 N	80	33	0.259 W
400.00	0.51	349.50	399.97	3.14	-1.73	467705.39	1704879.08	39	46	45.766 N	80	33	0.265 W
500.00	0.62	349.80	499.97	4.28	-1.61	467706.53	1704879.20	39	46	45.777 N	80	33	0.263 W
600.00	0.22	267.70	599.96	4.90	-2.00	467707.15	1704878.81	39	46	45.783 N	80	33	0.268 W
700.00	0.29	29.80	699.96	4.98	-2.00	467707.23	1704878.81	39	46	45.784 N	80	33	0.268 W
800.00	0.54	125.60	799.96	5.14	-2.02	467707.39	1704878.79	39	46	45.785 N	80	33	0.269 W
900.00	0.48	310.23	899.96	4.55	-1.68	467706.80	1704879.13	39	46	45.779 N	80	33	0.264 W
1000.00	22.15	151.20	997.96	-8.78	5.90	467693.47	1704886.71	39	46	45.649 N	80	33	0.165 W
1100.00	51.37	158.30	1076.78	-62.49	32.01	467639.76	1704912.82	39	46	45.121 N	80	32	59.823 W
1200.00	82.80	167.17	1115.59	-149.59	57.46	467552.66	1704938.27	39	46	44.263 N	80	32	59.484 W
1300.00	90.86	170.79	1116.78	-248.60	70.69	467453.65	1704951.50	39	46	43.286 N	80	32	59.299 W
1400.00	92.22	143.79	1115.85	-340.61	107.18	467361.64	1704987.99	39	46	42.381 N	80	32	58.818 W
1500.00	90.52	126.52	1111.50	-407.68	180.67	467294.57	1705061.48	39	46	41.727 N	80	32	57.867 W
1600.00	87.36	130.97	1112.80	-468.13	260.22	467234.12	1705141.03	39	46	41.138 N	80	32	56.839 W
1700.00	88.42	144.65	1116.02	-541.68	327.53	467160.57	1705208.34	39	46	40.419 N	80	32	55.966 W
1800.00	90.75	140.39	1117.66	-623.51	384.71	467078.74	1705265.52	39	46	39.617 N	80	32	55.222 W
1900.00	88.44	156.75	1117.49	-708.19	437.16	466994.06	1705317.97	39	46	38.786 N	80	32	54.537 W

Scientific Drilling Survey Report - Geographic

Company: CNX Gas Company, LLC Field: MARSHALL COUNTY, WV Site: MC 1 WELL LOCATION Well: ACCESS MC1 A2 Wellpath: EAST LEG	Date: 5/19/2008 Co-ordinate(NE) Reference: Vertical (TVD) Reference: Section (VS) Reference: Survey Calculation Method:	Time: 07:25:32 Well: ACCESS MC1 A2, Grid North GL 1372.69 + 10 1382.7 Well (0.00N,0.00E,116.82Azi) Minimum Curvature	Page: 2 Db: Sybase
---	--	---	-------------------------------------

Survey

MD ft	Incl deg	Azim deg	TVD ft	+N/-S ft	+E/-W ft	Map Northing ft	Map Easting ft	Latitude		Longitude					
								Deg	Min	Sec	Deg	Min	Sec		
2000.00	90.75	160.67	1117.56	-802.13	471.36	466900.12	1705352.17	39	46	37.862	N	80	32	54.085	W
2100.00	89.71	153.01	1116.65	-895.18	507.75	466807.07	1705388.56	39	46	36.947	N	80	32	53.605	W
2200.00	89.21	133.91	1117.11	-975.67	566.28	466726.58	1705447.09	39	46	36.158	N	80	32	52.843	W
2300.00	90.01	119.41	1116.03	-1032.74	648.02	466669.51	1705528.83	39	46	35.603	N	80	32	51.788	W
2400.00	90.28	118.68	1115.59	-1080.28	735.99	466621.97	1705616.80	39	46	35.144	N	80	32	50.654	W
2500.00	89.82	118.46	1116.46	-1127.56	824.10	466574.69	1705704.91	39	46	34.686	N	80	32	49.519	W
2600.00	87.18	117.79	1119.11	-1174.78	912.19	466527.47	1705793.00	39	46	34.230	N	80	32	48.383	W
2700.00	88.97	115.67	1123.25	-1219.56	1001.49	466482.69	1705882.30	39	46	33.798	N	80	32	47.233	W
2800.00	87.85	115.22	1125.70	-1262.32	1091.85	466439.93	1705972.66	39	46	33.385	N	80	32	46.069	W
2900.00	92.51	115.41	1124.06	-1305.06	1182.17	466397.19	1706062.98	39	46	32.973	N	80	32	44.906	W
3000.00	88.22	113.24	1124.56	-1347.06	1272.88	466355.19	1706153.69	39	46	32.569	N	80	32	43.738	W
3100.00	91.49	114.84	1123.91	-1388.83	1363.72	466313.42	1706244.53	39	46	32.166	N	80	32	42.569	W
3200.00	92.13	117.74	1119.50	-1434.19	1452.71	466268.06	1706333.52	39	46	31.728	N	80	32	41.422	W
3300.00	88.00	119.34	1119.17	-1481.46	1540.80	466220.79	1706421.61	39	46	31.271	N	80	32	40.287	W
3400.00	90.22	119.38	1122.18	-1530.24	1628.03	466172.01	1706508.84	39	46	30.799	N	80	32	39.162	W
3500.00	90.39	119.75	1120.99	-1580.42	1714.51	466121.83	1706595.32	39	46	30.313	N	80	32	38.047	W
3600.00	89.85	120.77	1120.53	-1630.59	1801.01	466071.66	1706681.82	39	46	29.827	N	80	32	36.932	W
3700.00	89.21	119.65	1120.06	-1681.18	1887.27	466021.07	1706768.08	39	46	29.337	N	80	32	35.820	W
3800.00	91.16	118.80	1120.63	-1729.35	1974.89	465972.90	1706855.70	39	46	28.871	N	80	32	34.690	W
3900.00	89.47	116.79	1119.02	-1776.40	2063.09	465925.85	1706943.90	39	46	28.416	N	80	32	33.554	W
4000.00	90.39	116.53	1119.29	-1821.25	2152.47	465881.00	1707033.28	39	46	27.983	N	80	32	32.403	W
4022.00	91.00	116.53	1119.03	-1831.08	2172.15	465871.17	1707052.96	39	46	27.889	N	80	32	32.149	W

Targets

Name	Description	TVD ft	+N/-S ft	+E/-W ft	Map Northing ft	Map Easting ft	Latitude		Longitude					
							Deg	Min	Sec	Deg	Min	Sec		
EAST LEG TD	-Rectangle (1758x200)	1117.00	-1881.22	2277.47	465821.03	1707158.28	39	46	27.405	N	80	32	30.793	W
INTERCEPT TD	-Circle (Radius: 1)	1117.00	-424.48	183.06	467277.77	1705063.87	39	46	41.561	N	80	32	57.834	W