

RECEIVED
WV Division of
Environmental Protection
AUG 26 93
Permitting
Office of Oil & Gas

80 32 30

5 AM

DATE August 23, 1993
OPERATORS WELL NO. CALVERT 1
API WELL NO. 051-0788
Applying For

STATE OF WEST VIRGINIA
DEPARTMENT OF ENERGY
OIL AND GAS DIVISION

7.5' Tick

1.08
0.38

WELL TYPE: OIL ___ GAS X LIQUID INJECTION ___ WASTE DISPOSAL ___
(IE "GAS" PRODUCTION X STORAGE ___ DEEP ___ SHALLOW ___)

LOCATION: ELEVATION 1390 WATER SHED ___
DISTRICT Liberty (P) COUNTY Marshall
QUADRANGLE Littleton 438 (??)

SURFACE OWNER Thomas E. Conway ACREAGE 55
George D. Hinerman, Alliance, OH 44601
OIL & GAS ROYALTY OWNER Betty E. Russell, Akron, OH 44305 LEASE ACREAGE 55
LEASE NO. _____

PRODUCING FORMATION Gordon TOTAL DEPTH 3223

WELL OPERATOR The Interstate Pipe & Supply Co. DESIGNATED AGENT Rodney C. Windom
ADDRESS P. O. Box 548 ADDRESS 202 E. Main St.
Marietta, OH 45750 2345 Harrisville, WV 26362

Littleton 2

17871

Littleton NE

1.085
2.66W

was 30/47

NOV 23 1993

6-6

(042)

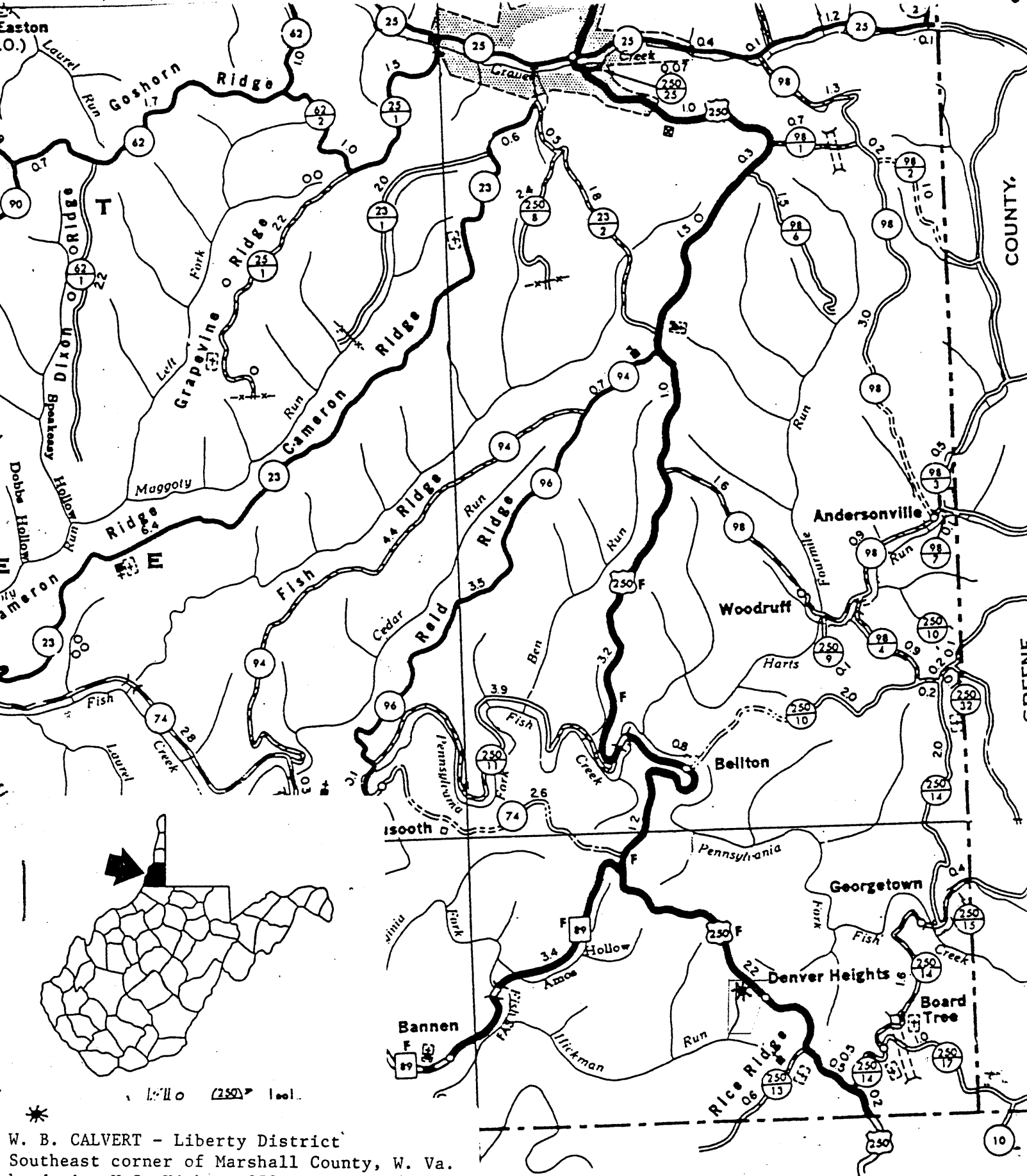

*
 W. B. CALVERT - Liberty District
 Southeast corner of Marshall County, W. Va.
 bordering U.S. Highway 250, about 3-1/2 mi.
 northwest of Littleton (Whetzel County),
 W. Va.

ANTHROPOMETRIC HISTORICAL PARK
 County - see pages 72 and 73

on Oct. 10, 1774, at the confluence of the
 Kanawha Rivers.

NOV 23 1893

THE INTERSTATE PIPE & SUPPLY CO.

Calvert Lease

Liberty District

Marshall County, W. Va.

○ Oil Well

⊖ Dry Hole

* Gas Well

⊘ Abandoned Well

Map Scale: One Inch = 400'

The Interstate Pipe & Supply Co.

* Calvert No. 1

Big Lime 2310 (-920)

Big Injun 2357-2371 Gas 2359-2371

Gordon 3198-3223/Gas 3215-3218

TD 2371 - (1-1-26)

TD 3223 - (7-1-27)

Elev. 1390 - Topo.

Ethel Conaway

55.0 Ac.

Homer L. Pierce

3.67 Ac.

81.0 ac.

Thomas E. Conaway

Lizzie Thomas

890 Bandy Rd.
Deerfield, Ohio
44411

Thomas M. Prendergast
18 Hollen Circle

247.4 Ac.

Consolidated Gas Supply Corporation
Clarksburg W. Va.

NOV 23 1993

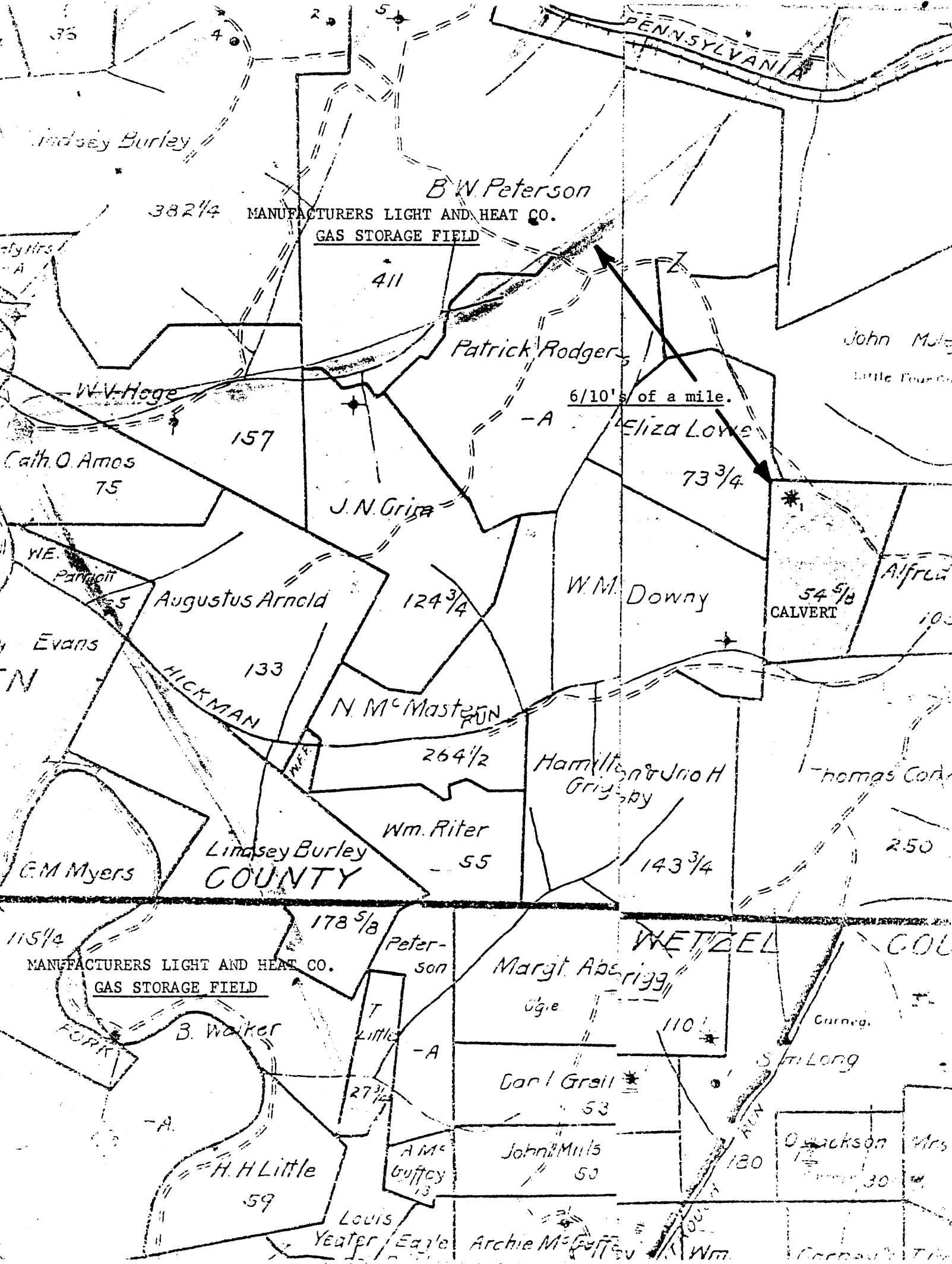

NOV 23 1993

Wiley Evans



Stewart
Newman
& Maloy

Walnut

S 58 E - 1650

Beech

S 57 E - 250

N 85 1/2 E - 1442

Well No. 64
El. 1409.0

State
Route
No 250

To Littleton

W. B. Calvert & Emma Calvert
54 Acres 69 Poles
Coal not operated

Edman Conaway

N 2 1/2 E - 1980

S 25 W - 2211

McCuskey Mrs.

State

N 88 1/2 W - 751

Small
W.O.

Edman Conaway

C, P, O, P

New Location
Drill Deeper
Abandonment



DEC 24 1940

0.84 S
2.72 W

2 177 W

0185

Company The Interstate Pipe & Supply Co.
 Address Box 611 Marietta Ohio
 Farm W. B. & Emma Calvert
 Tract Acres 54.8 - 69 Lease No. _____
 Well (Farm) No. 64 Serial No. _____
 Elevation (Spirit Level) 1409.0
 Quadrangle Littleton
 County Marshall District Liberty
 Engineer C. O. Manning
 Engineer's Registration No. 811
 File No. _____ Drawing No. _____
 Date Nov. 22, 1940 Scale 1" = 300'

STATE OF WEST VIRGINIA
 DEPARTMENT OF MINES
 OIL AND GAS DIVISION
 CHARLESTON

WELL LOCATION MAP
 FILE NO. MARS-147A

◆ Denotes location of well on United States Topographic Maps, scale 1 to 62,500. latitude and longitude lines being represented by border lines as shown.

— Denotes one inch spaces on border line of original tracing

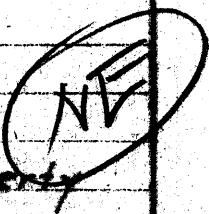

788

WEST VIRGINIA DEPARTMENT OF MINES
OIL AND GAS DIVISION

192

WELL RECORD

Permit No. 147-A-051988

Oil or Gas Well Oil
(Kind)

Company The Interstate Pipe & Supply Company
Address Marietta, Ohio
Farm W. B. and Emma Calvert Acres 55
Location (waters).....
Well No. 64 Elev. 1409
District Liberty County Marshall
The surface of tract is owned in fee by W. B. & Emma Calvert
Address Cameron, W. Va.
Mineral rights are owned by T. L. Rogerson
Cor. 5th & Tomlinson St. Address Moundsville, W. Va.
Drilling commenced December 3, 1925
Drilling completed January 1, 1926
Date shot..... Depth of shot.....
Open Flow /10ths Water in..... Inch
/10ths Merc. in..... Inch
Volume..... Cu. Ft.
Rock Pressure..... lbs..... hrs.
Oil..... bbls., 1st 24 hrs.
Fresh water..... feet..... feet
Salt water..... feet..... feet

Casing and Tubing	Used in Drilling	Left in Well	Packers
Size			
Conductor	16		Kind of Packer.....
13.....			
10.....	225	17	Size of.....
8 3/4.....	1597	1597	
6 5/8.....	2317	2317	Depth set.....
5 3/16.....	249	249	
3.....			Perf. top.....
2.....			Perf. bottom.....
Liners Used.....			Perf. top.....
			Perf. bottom.....

CASING CEMENTED..... SIZE..... No. FT..... Date.....
COAL WAS ENCOUNTERED AT 840 FEET..... 80 INCHES
1055 FEET 72 INCHES 1165 FEET 72 INCHES
..... FEET..... INCHES..... FEET..... INCHES

Formation	Color	Hard or Soft	Top	Bottom	Oil Gas or Water	Depth Found	Remarks
Clay-Slate-Lime			0	825			
Bluff Sand			825	840			
Waynesburg Coal			840	845			
Mapletown Coal			1055	1061			
Pittsburgh Coal			1165	1171			
Murphy Sand			1370	1390			
Little Dunkard			1590	1610			
Gas Sand			1750	1775			
Salt Sand			2065	2100			
Marion Sand			2215	2235			
Little Line			2275	2300			
Pencil Cave			2300	2310			
Big Line			2310	2357			
Big Injun Sand			2357	2605			
Slate & Shells			2601	3150			
Fifty Foot Sand			3150	3159			
Slate			3159	3198			
Gordon Sand			3198	3223	Oil	3215-3218	
Total Depth				3223			

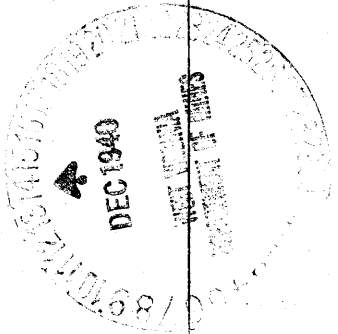

051788

COLUMBIA GAS ESTORAGE

