

COAL OWNED BY \_\_\_\_\_  
**REDRILL FOR STORAGE**

NEW LOCATION.....

DRILL DEEPER.....

ABANDONMENT.....  *issued 7-15-70*

0-25-9

COMPANY THE MANUFACTURERS LIGHT & HEAT

ADDRESS 800 UNION TRUST BLDG., PGH. PA.

FARM E. E. C. HARTLY

TRACT \_\_\_\_\_ ACRES 100 LEASE No. 19438

WELL (FARM) No. 2 SERIAL No. F-14586  
4691

ELEVATION (SPIRIT LEVEL) 1261.60'

QUADRANGLE CAMERON NE

COUNTY MARSHALL DISTRICT WEBSTER

ENGINEER A. Streater M.

ENGINEER'S REGISTRATION No. 9442

FILE No. \_\_\_\_\_ DRAWING No. Y-25-495

DATE 7 MAR. 62 SCALE 1" = 800'

STATE OF WEST VIRGINIA  
 DEPARTMENT OF MINES  
 OIL AND GAS DIVISION  
 CHARLESTON

WELL LOCATION MAP  
 FILE No. MARS-440-Red-P

+ DENOTES LOCATION OF WELL ON UNITED STATES TOPOGRAPHIC MAPS, SCALE 1 TO 62,500, LATITUDE AND LONGITUDE LINES BEING REPRESENTED BY BORDER LINES AS SHOWN.

— DENOTES ONE INCH SPACES ON BORDER LINK OF ORIGINAL TRACING.

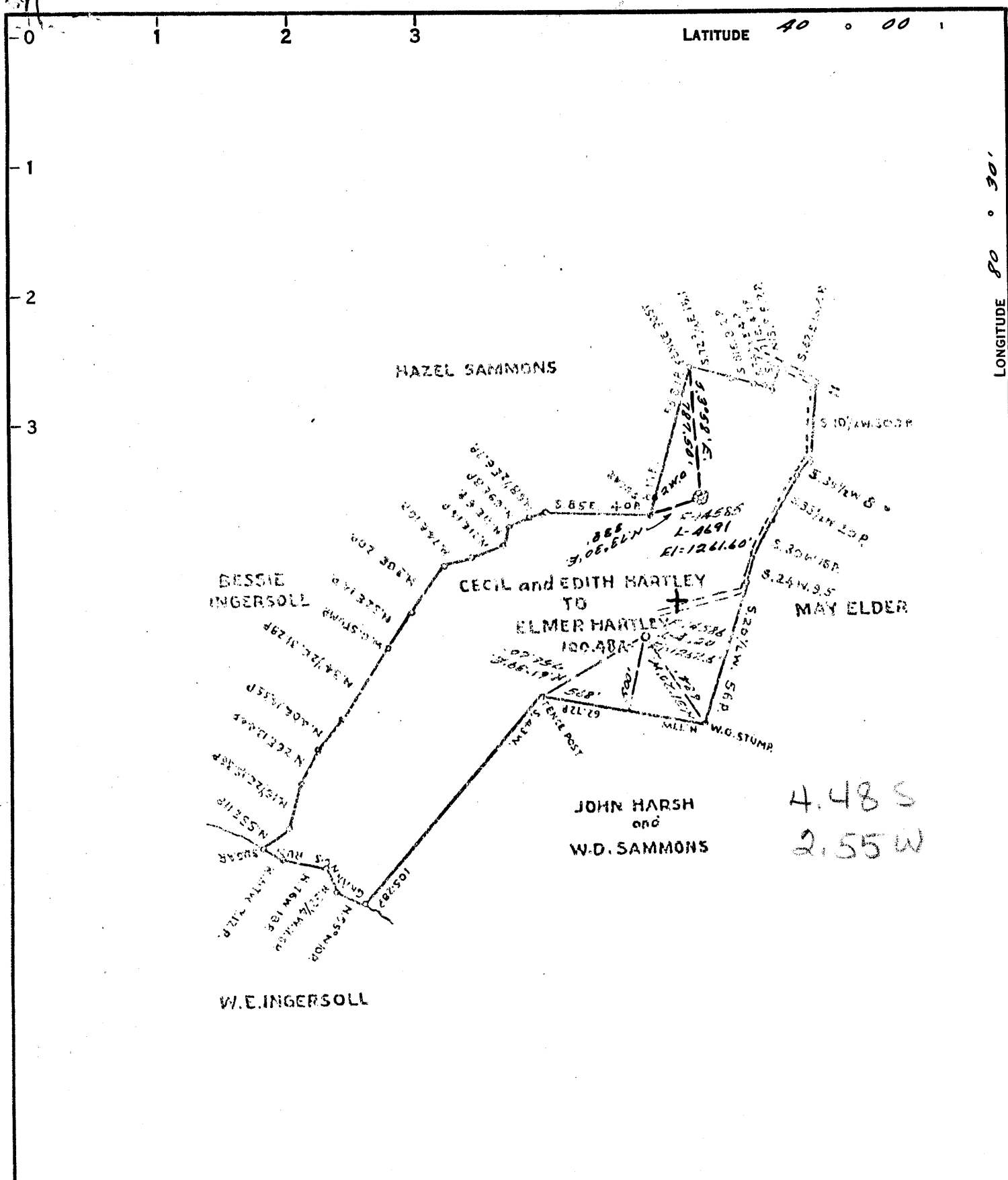

COAL OWNED BY \_\_\_\_\_  
**REDRILL FOR STORAGE**

NEW LOCATION...

DRILL DEEPER.....

ABANDONMENT.....

0-25-9

COMPANY THE MANUFACTURERS LIGHT & HEAT

ADDRESS 800 UNION TRUST BLDG., PGH. PA.

FARM E. E. C. HARTLY

TRACT \_\_\_\_\_ ACRES 100 LEASE No. 19438

WELL (FARM) No. 2 SERIAL No. 4691

ELEVATION (SPIRIT LEVEL) 1261.60'

QUADRANGLE CAMERON NE

COUNTY MARSHALL DISTRICT WEBSTER

ENGINEER A. Streater M.

ENGINEER'S REGISTRATION No. 9442

FILE No. \_\_\_\_\_ DRAWING No. Y-25-495

DATE 7 MAR. 62 SCALE 1" = 800'

STATE OF WEST VIRGINIA  
 DEPARTMENT OF MINES  
 OIL AND GAS DIVISION  
 CHARLESTON

**WELL LOCATION MAP**

FILE No. MARS-440-R

+ DENOTES LOCATION OF WELL ON UNITED STATES TOPOGRAPHIC MAPS. SCALE 1 TO 62,500. LATITUDE AND LONGITUDE LINES BEING REPRESENTED BY BORDER LINES AS SHOWN.

— DENOTES ONE INCH SPACES ON BORDER LINE OF ORIGINAL TRACING.



STATE OF WEST VIRGINIA  
DEPARTMENT OF MINES  
OIL AND GAS DIVISION

Quadrangle Cameron

Permit No. MARS-440-R

WELL RECORD

Oil or Gas Well GAS  
(MMS)

Company The Mfrs. Lt. and Ht. Co.  
Address 800 Union Trust Bldg., Pittsburgh 19, Pa.  
Farm Elmer and Cecil Hartly Acres 100  
Location (waters) \_\_\_\_\_  
Well No. 4691 Elev. 1261.60' G. 118  
District Webster County Marshall  
The surface of tract is owned in fee by \_\_\_\_\_  
Address \_\_\_\_\_  
Mineral rights are owned by \_\_\_\_\_  
Address \_\_\_\_\_  
Drilling commenced July 3, 1962  
Drilling completed June 6, 1963  
Date Shot 6/3/63 From Big Injuro  
With Orifice Well Tester  
Open Flow 18/10ths Water in \_\_\_\_\_ 1/2 Inch  
\_\_\_\_\_ /10ths Merc. in \_\_\_\_\_ Inch  
Volume 8,000 Cu. Ft.  
Rock Pressure 485 lbs. 72 hrs.  
Oil \_\_\_\_\_ bbls., 1st 24 hrs.  
Fresh water \_\_\_\_\_ feet  
Salt water \_\_\_\_\_ feet

Casing and Tubing	Used in Drilling	Left in Well	Packers
Size			Kind of Packer
18 3/8"	100'6"	100'6"	
10 3/4"	749'10"	749'10"	Size of
8 5/8"	1227'9"	1227'9"	Depth set
<del>6 7/8"</del> 7"	1287'5"	1287'5"	
5 8/16"			
4 1/2"	2040'5"	2040'5"	Perf. top
2"			Perf. bottom
Liners Used			Perf. top
			Perf. bottom

CASING CEMENTED \_\_\_\_\_ SIZE \_\_\_\_\_ No. Ft. \_\_\_\_\_ Date \_\_\_\_\_

COAL WAS ENCOUNTERED AT 735 FEET \_\_\_\_\_ INCHES  
\_\_\_\_\_ FEET \_\_\_\_\_ INCHES FEET \_\_\_\_\_ INCHES  
\_\_\_\_\_ FEET \_\_\_\_\_ INCHES FEET \_\_\_\_\_ INCHES

Formation	Color	THICKNESS	Top	Bottom	Oil, Gas or Water	Depth Found	Remarks
<del>Pittsburgh Coal</del>		4	735	739			
<del>Big Dunkard</del>		39	1211	1250			
<del>Gas Sand</del>		55	1373	1428			
<del>1st Salt Sand</del>		41	1509	1550			
<del>3rd Salt Sand</del>		50	1732	1782			
<del>Big Injun</del>			1803				
Redrilled to original depth of 2040'. Cemented 4 1/2" Tubing. Cement left inside Tubing to 1980'							
TOTAL DEPTH				1980			
					Pay Zone: determined from Gamma Ray & Gamma-Gamma 1903'-1909' Perforated with 4-2 1/8" Capsule Jets per foot.		

