

DANFORD & DEBORAH O'BRIAN

LATITUDE 39°57'30"



WELL LOCATION	
UTM 17-NAD83	
N:4420920.484	
E:539591.283	
NAD83, WY NORTH	
N:525254.680	
E:1677835.961	
LAT/LON DATUM-WGS84	
LAT:39°56'14.91"	
LOX:80°32'11.78"	

LONGITUDE 80°30'00"

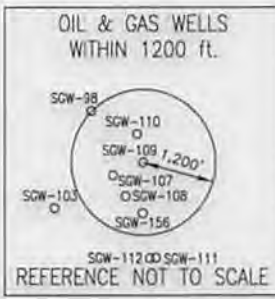

LINE	BEARING	DISTANCE
L1	S 89°35'00" W	190.10'
L2	N 32°27'00" E	319.00'
L3	N 02°07'00" E	582.00'
L4	N 25°48'00" W	430.00'
L5	N 43°03'00" W	198.00'
L6	N 10°13'00" W	315.00'
L7	N 30°00'00" W	163.00'
L8	N 38°32'00" W	536.00'
L9	N 12°27'00" W	281.00'
L10	N 25°15'00" E	203.00'
L11	N 50°35'00" E	244.00'
L12	N 76°02'00" E	231.00'
L13	N 78°45'00" E	49.50'
L14	N 68°30'00" E	231.00'
L15	N 59°30'00" E	94.00'
L16	N 44°45'00" E	86.00'
L17	N 88°15'00" E	600.00'
L18	N 73°15'00" E	510.00'
L19	S 01°45'00" W	831.00'
L20	S 02°45'00" W	730.00'

COORDINATES:  
10,331' WEST  
7,634' SOUTH

BRIAN K. MILLIKEN  
TM/PAR 15-5/43  
DB/PG 665/461  
96.0 ACRES ±

**Blue Mountain Inc.**  
11023 MASON DIXON HIGHWAY  
BURTON, WV 26562  
PHONE: (304) 662-6486

NOTE:  
It is not the purpose or intention of this plat to represent surveyed locations of the surface or mineral parcels depicted herein. The location of the boundary lines, as shown, are based on record deed descriptions, field evidence found and/or tax map position, unless otherwise noted.

FILE #: SGW-109  
 DRAWING #: SGW-109  
 SCALE: 1" = 600'  
 MINIMUM DEGREE OF ACCURACY: 1/2500  
 PROVEN SOURCE OF ELEVATION: U.S.G.S. MONUMENT THOMAS 1498.81'

I, THE UNDERSIGNED, HEREBY CERTIFY THAT THIS PLAT IS CORRECT TO THE BEST OF MY KNOWLEDGE AND BELIEF AND SHOWS ALL THE INFORMATION REQUIRED BY LAW AND THE REGULATIONS ISSUED AND PRESCRIBED BY THE DEPARTMENT OF ENVIRONMENTAL PROTECTION.

Signed: *[Signature]*  
 R.P.E.: \_\_\_\_\_ L.L.S.: P.S. No. 2000

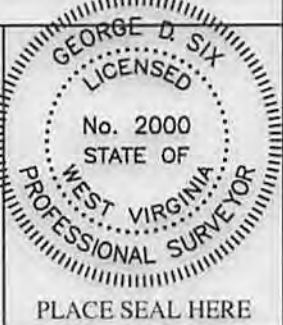

(+) DENOTES LOCATION OF WELL ON UNITED STATES TOPOGRAPHIC MAPS WVDEP  
 OFFICE OF OIL & GAS  
 601 57TH STREET  
 CHARLESTON, WV 25304



DATE: AUGUST 21, 2014  
 OPERATOR'S WELL #: SGW-109  
 API WELL #: 47 51 00382 P  
 STATE COUNTY PERMIT

Well Type:  Oil  Waste Disposal  Production  Deep  
 Gas  Liquid Injection  Storage  Shallow

WATERSHED: UNNAMED TRIBUTARY TO DUNKARD FORK ELEVATION: 1203.46'

COUNTY/DISTRICT: MARSHALL/WEBSTER QUADRANGLE: MAJORSVILLE, WV-PA 7.5'

SURFACE OWNER: BRIAN K. MILLIKEN ACREAGE: 96.0±

OIL & GAS ROYALTY OWNER: \_\_\_\_\_ ACREAGE: \_\_\_\_\_

DRILL  CONVERT  DRILL DEEPER  REDRILL  FRACTURE OR STIMULATE   
 PLUG OFF OLD FORMATION  PERFORATE NEW FORMATION  PLUG & ABANDON   
 CLEAN OUT & REPLUG  OTHER CHANGE  (SPECIFY): \_\_\_\_\_

TARGET FORMATION: NONE ESTIMATED DEPTH: \_\_\_\_\_

WELL OPERATOR CONSOLIDATION COAL COMPANY DESIGNATED AGENT RONNIE HARSH  
 Address 6126 ENERGY DRIVE Address 6126 ENERGY DRIVE  
 City MOUNDSVILLE State WV Zip Code 26041 City MOUNDSVILLE State WV Zip Code 26041

09/05/2014

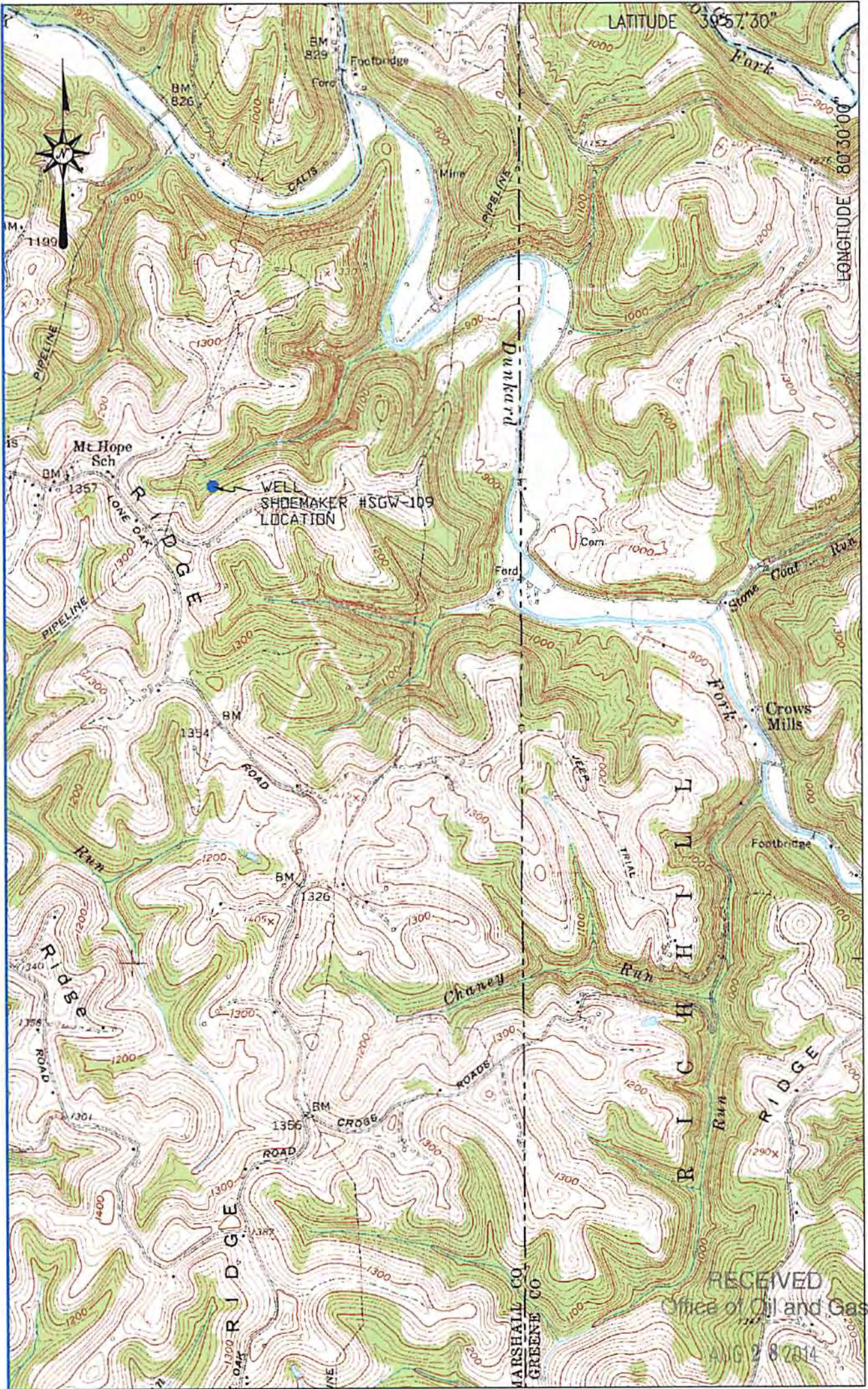

RECEIVED  
Office of Oil and Gas  
AUG 28 2014

WV Department of  
Environmental Protection  
LOCATION MAP  
AUGUST 21, 2014

**Blue Mountain Inc.**  
11023 MASON DIXON HIGHWAY  
BURTON, WV 26562  
PHONE: (304) 662-6486

SHOEMAKER WELL # SGW-109  
MAJORSVILLE QUADRANGLE  
WEST VIRGINIA - PENNSYLVANIA

SCALE 1" = 2000'  
0' 2000' 4000' 6000'



**BLUE MOUNTAIN ENGINEERING**