

NORTH

SURROUNDING WELLS WITHIN 1200' RADIUS

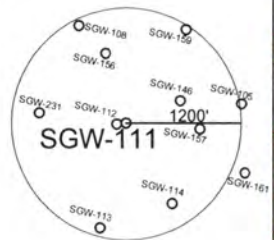

UTM ZONE 17N NAD83 CONUS	LAT/LONG NAD27 CONUS
NORTHING 4,420,441 METERS	39° 55' 59.1" N
EASTING 539,658 METERS	80° 32' 09.8" W

I THE UNDERSIGNED, HEREBY CERTIFY THAT THIS PLAT IS CORRECT TO THE BEST OF MY KNOWLEDGE AND BELIEF AND SHOWS ALL THE INFORMATION REQUIRED BY LAW AND THE REGULATIONS ISSUED AND PRESCRIBED BY THE DEPARTMENT OF ENVIRONMENTAL PROTECTION.  
P.S. 2002

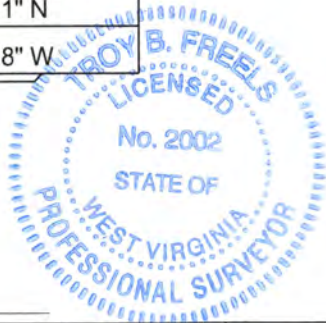

(+) DENOTES LOCATION OF WELL ON UNITED STATES TOPOGRAPHIC MAPS.

DATE MARCH 11, 20 16

OPERATORS WELL NO. SGW-111

API WELL NO. 47 - 51 - 00344P  
STATE COUNTY PERMIT

MINIMUM DEGREE OF ACCURACY: 1 / 2500  
FILE NO.: MAJORSVILLE6.DWG  
PROVEN SOURCE OF ELEVATION: GPS METADATA OR COMPANY NETWORK TIED INTO U.S.G.S.  
SCALE: 1"=2000'

WV DEP  
OFFICE OF OIL AND GAS  
601 57TH ST., CHARLESTON, WV 25304



WELL TYPE: OIL \_\_\_\_\_ GAS  LIQUID INJECTION \_\_\_\_\_ WASTE DISPOSAL \_\_\_\_\_ "GAS" PRODUCTION \_\_\_\_\_ STORAGE \_\_\_\_\_ DEEP \_\_\_\_\_ SHALLOW

LOCATION: ELEVATION: 1261.09' WATERSHED: DUNKARD FORK OF WHEELING CREEK  
DISTRICT: WEBSTER COUNTY: MARSHALL QUADRANGLE: MAJORSVILLE, WV PA 7.5'  
SURFACE OWNER: BRIAN K. MILLIKEN ACREAGE: 96± ACRES  
ROYALTY OWNER: \_\_\_\_\_ LEASE ACREAGE: \_\_\_\_\_  
PROPOSED WORK: \_\_\_\_\_ LEASE NO.: \_\_\_\_\_  
DRILL: \_\_\_\_\_ CONVERT: \_\_\_\_\_ DRILL DEEPER: \_\_\_\_\_ REDRILL: \_\_\_\_\_ FRACTURE OR STIMULATE: \_\_\_\_\_ PLUG OFF OLD: \_\_\_\_\_  
FORMATION: \_\_\_\_\_ PERFORATE NEW FORMATION: \_\_\_\_\_ PLUG AND ABANDON:  CLEAN OUT AND REPLUG: \_\_\_\_\_ OTHER: \_\_\_\_\_  
PHYSICAL CHANGE IN WELL (SPECIFY): \_\_\_\_\_ TARGET FORMATION: NONE ESTIMATED DEPTH: \_\_\_\_\_

RECEIVED  
Office of Oil and Gas  
APR 29 2016  
04/29/2016  
WV Department of Environmental Protection

WELL OPERATOR: CONSOLIDATION COAL COMPANY DESIGNATED AGENT: RONNIE HARSH  
ADDRESS: 6126 ENERGY DRIVE, MOUNDSVILLE WV 26041 ADDRESS: 6126 ENERGY DRIVE, MOUNDSVILLE WV 26041

4705100344P



 WELL# SGW-111

10.1  
57'30"  
4423  
4422  
4421  
4420  
4419  
55'  
4418

RECEIVED  
Office of Oil and Gas  
APR 13 2016  
WV Department of  
Environmental Protection  
04/29/2016