

SURFACE HOLE
STATE PLANE WV NORTH/SOUTH ZONE NAD 1927 N - 611,592.44 : E - 1,668,310.77
LATITUDE: (N) 38.6738651 LONGITUDE: (W) 82.1618006
UTM, NAD83 17 - 84W TO 78W, METERS N - 4,281,235.516 : E - 398,947.616

(+) DENOTES LOCATION OF WELL ON UNITED STATES TOPOGRAPHIC MAPS

FILE NO. WAGNER 1916.DGN
 DRAWING NO. WAGNER P-304
 SCALE 1" = 1000'
 MINIMUM DEGREE OF ACCURACY 1:200
 PROVEN SOURCE OF ELEVATION MAPPING GRADE GPS

I THE UNDERSIGNED, HEREBY CERTIFY THAT THIS PLAT IS CORRECT TO THE BEST OF MY KNOWLEDGE AND BELIEF AND SHOWS ALL THE INFORMATION REQUIRED BY LAW AND THE REGULATIONS ISSUED AND PRESCRIBED BY THE DEPARTMENT OF ENVIRONMENTAL PROTECTION.

(SIGNED) *Paul E. Miller*
 R.P.E. _____ L.L.S. 647

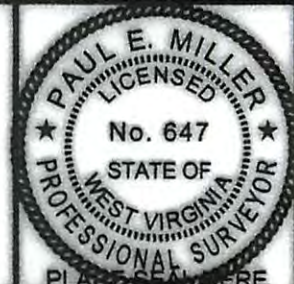

STATE OF WEST VIRGINIA
 DIVISION OF ENVIRONMENTAL PROTECTION
 OIL AND GAS DIVISION

DATE MAY 19, 20 14
 OPERATOR'S WELL NO. 1916
 API WELL NO. 47 053 00304 P
 STATE COUNTY PERMIT

WELL TYPE: OIL GAS LIQUID INJECTION WASTE DISPOSAL
 (IF "GAS,") PRODUCTION STORAGE DEEP SHALLOW

LOCATION: ELEVATION 659' WATER SHED FLATFOOT CREEK OF OHIO RIVER
 DISTRICT CLENDENIN COUNTY MASON
 QUADRANGLE APPLE GROVE, WV 7.5'

SURFACE OWNER CLYDE W. BOWEN, JR. & JANETTE BOWEN ACREAGE 130
 OIL & GAS ROYALTY OWNER _____ LEASE ACREAGE 130
 LEASE NO. C-2-189

PROPOSED WORK: DRILL CONVERT DRILL DEEPER REDRILL FRACTURE OR STIMULATE PLUG OFF OLD FORMATION PERFORATE NEW FORMATION OTHER PHYSICAL CHANGE IN WELL (SPECIFY) _____

PLUG AND ABANDON CLEAN OUT AND REPLUG

TARGET FORMATION _____ ESTIMATED DEPTH _____

WELL OPERATOR WAGNER OIL COMPANY DESIGNATED AGENT PAUL STRICKLAND
 ADDRESS 500 COMMERCE ST. STE. 600, FT. WORTH, TX 76102 ADDRESS SAME

FORM WW-6

COUNTY NAME PERMIT

10/17/2014