

LATITUDE 39 ° 45 ' 1

0.625
1.58W

.58s
1.59w

LONGITUDE 80 ° 35 '

COAL OWNED BY BELTON FUEL CO. P.O. BOX 403
UNIONTOWN PA
 NEW LOCATION - Redrill
 DRILL DEEPER
 ABANDONMENT

COMPANY The Manufacturers Light and Heat Co.
 ADDRESS 800 Union Trust Bldg. Pittsburgh Pa.
 FARM J.M. Pyles et al.
 TRACT _____ ACRES 100 ± LEASE No. 2257
 WELL (FARM) No. 1 SERIAL No. 2618
 ELEVATION (SPIRIT LEVEL) 1297
 QUADRANGLE LITTLETON N.E. 1/4
 COUNTY Marshall DISTRICT Liberty
 ENGINEER J. Mercer
 ENGINEER'S REGISTRATION No. _____
 FILE No. Well Bk. 24 P. 17 DRAWING No. Y-11-227
 DATE _____ SCALE _____

STATE OF WEST VIRGINIA
 DEPARTMENT OF MINES
 OIL AND GAS DIVISION
 CHARLESTON

WELL LOCATION MAP

FILE No. MARS-238A
MARS-265-Redrill

+ DENOTES LOCATION OF WELL ON UNITED STATES TOPOGRAPHIC MAPS, SCALE 1 TO 62,500. LATITUDE AND LONGITUDE LINES BEING REPRESENTED BY BORDER LINES AS SHOWN.

- DENOTES ONE INCH SPACES ON BORDER LINE OF ORIGINAL TRACING.

+ 0.64S
1.59W

165
1.60

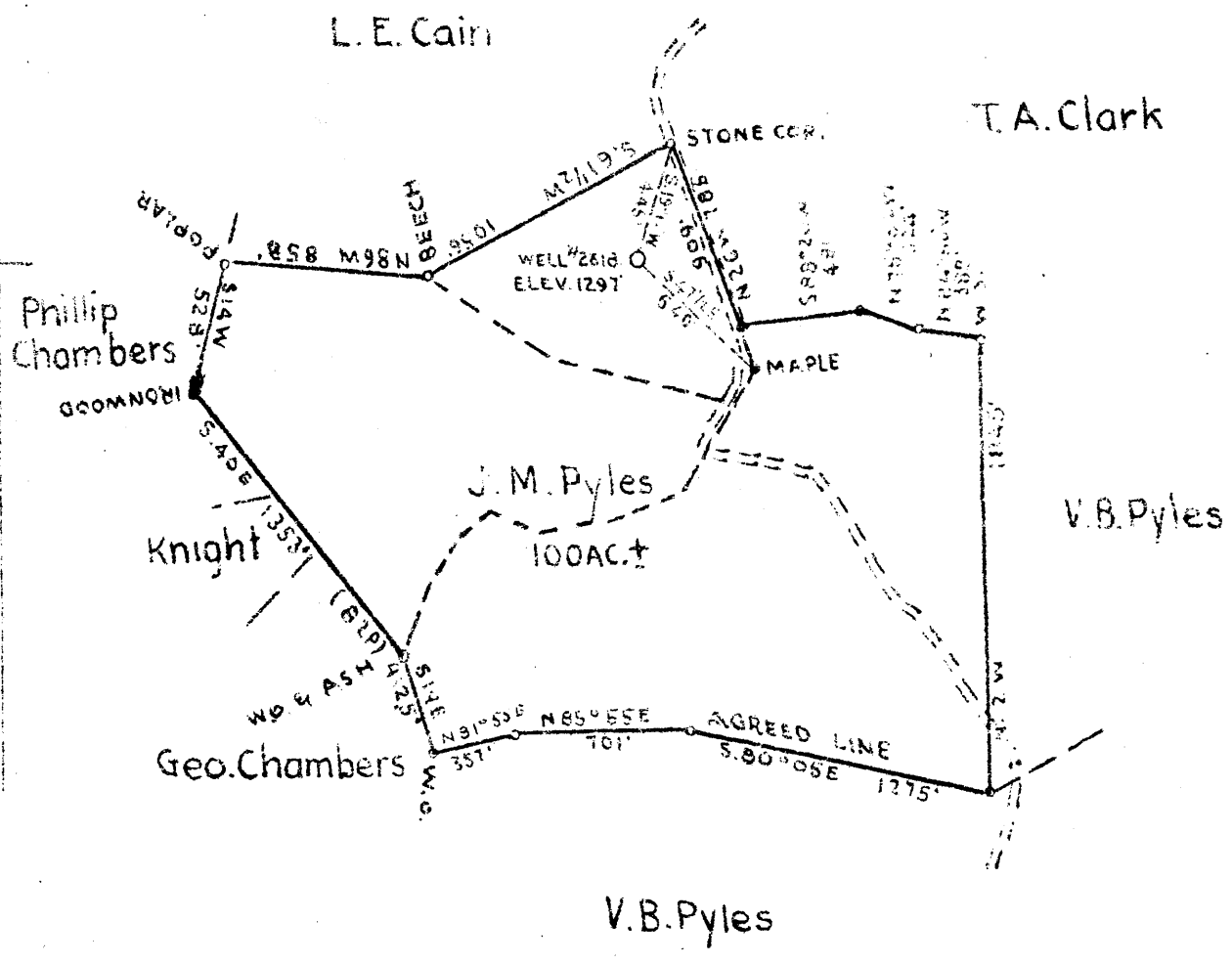

WELL OWNED BY... BELTON FUEL CO. P.O. BOX 403
UNIONTOWN PA

WELL LOCATION
WELL DEEPER
LAND IN WENT

BY The Manufacturers Light and Heat Co.
 OFFICE 500 Union Trust Bldg. Pittsburgh Pa.
 BY J.M. Pyles et al.
 ACRES 100.± LEASE NO. 2257
 WELL (HARM) NO. 1 SERIAL NO. 2618
 ELEVATION (SPIRIT LEVEL) 1297
 RANGE LITTLETON N.E. 1/4 NC
 COUNTY Marshall DISTRICT Liberty
 COUNTY Marshall
 DIRECTOR'S REGISTRATION NO.
 WELL No. Well Bk. 24 P. 17 (D.P. AING NO. Y-11-227)

STATE OF WEST VIRGINIA
DEPARTMENT OF MINES
OIL AND GAS DIVISION
CHARLESTON

WELL LOCATION MAP

FILE NO. MARS-238-A
265

* DENOTES LOCATION OF WELL ON UNITED STATES TOPOGRAPHIC MAPS (SCALE 1 TO 62,500, LATITUDE AND LONGITUDE COORDINATES REPRESENTED BY BORDER LINE AS SHOWN)

INCLUDES ONE INCH SPACES ON BORDER LINE OF ORIGINAL TRACING



STATE OF WEST VIRGINIA
DEPARTMENT OF MINES
OIL AND GAS DIVISION

287

238A

WELL RECORD

Permit No. Drilled in 1920

Oil or Gas Well Gas
(KIND)

Company The Manufacturers Light & Heat Company
 Address P. O. Box 1196, Pittsburgh 30, Pa.
 Farm J. M. Pyles Acres 100
 Location (waters) _____
 Well No. 1 - 2618 Elev. 1297 ft.
 District Liberty County Marshall
 The surface of tract is owned in fee by Eunice Cain, Agent,
63 Linden Ave., Address Moundsville, W.Va.
 Mineral rights are owned by The Mfrs Light & Heat Co.
 Address Pittsburgh, Pa.
 Drilling commenced 10/9/20
 Drilling completed 3/1/21
 Date Shot ? From _____ To _____

Casing and Tubing	Used in Drilling	Left in Well	Packers
Size			
16			Kind of Packer
18			
10	235'	-	Size of
8 1/2	1529' 10"	1529' 10"	
6 1/2	2056'	2056'	Depth set
5 3/16			
3			Perf. top
2			Perf. bottom
Liners Used			Perf. top
			Perf. bottom

Open Flow 26 /10ths Water in 4 Inch
 _____ /10ths Merc. in _____ Inch
 Volume ? Cu. Ft.
 Rock Pressure ? lbs _____ hrs.
 Oil _____ bbls., 1st 24 hrs.
 Fresh water _____ feet _____ feet
 Salt water _____ feet _____ feet

CASING CEMENTED _____ SIZE _____ No. Ft. _____ Date _____
 COAL WAS ENCOUNTERED AT 310 FEET 36 INCHES
616 FEET 48 INCHES 670 FEET 36 INCHES
976 FEET 84 INCHES _____ FEET _____ INCHES

Formation	Color	Hard or Soft	Top	Bottom	Oil, Gas or Water	Depth Found	Remarks
Clay			0	12			
Sand			12	25			
Slate & Lime			25	75			
Sand			75	110			
Red Rock			110	125			
Slate & Lime			125	170			
Sand			170	220			
Lime			220	250			
Red Rock			250	265			
Slate & Lime			265	310			
Coal			310	313			
Lime & Slate			313	400			
Sand			400	410			
Lime			410	455			
Sand			455	480			
Slate & Lime			480	616			
Native Coal			616	620			
Lime			620	655			
Sand			655	660			
Slate & Lime			660	870			
Coal			670	673			
Lime			673	976			
Pittsburgh Coal			976	983			
Lime			983	1090			
Murphy Sand			1090	1110			
Red Rock			1110	1130			
Lime			1130	1160			
Red Rock			1160	1170			
Lime & Slate			1170	1210			
Sand			1210	1252			
Slate			1252	1260			
Red Rock			1260	1290			
Slate & Lime			1290	1415			
Sand			1415	1430			
Slate & Lime			1430	1510			
Big Dunkard Sand			1510	1555			
Slate & Lime			1555	1865			
Salt Sand			1865	1890			

Handwritten circle

MAR 20 1926
 DEPARTMENT OF MINES
 108203737

Formation	Color	Hard or Soft	Top	Bottom	Oil, Gas or Water	Depth Found	Remarks
Slate & Lime			1890	1972			
Maxon Sand			1972	2020			
Slate & Lime			2020	2056			
Total depth				2056			

Date March 19th, 1946

APPROVED THE MANUFACTURERS LIGHT & HEAT COMPANY, Owner

By *[Signature]*
(Title) Land Agent.