

New Location
 Drill Deeper
 Abandonment

C AlliedSingal, Inc.
 P.O. Box J
 A Moundsville, wva. 26041

Farm ALLIED CHEMICAL & DYE CORP

Tract 2 Acres 106 1/2 Lease No. —

Well (Farm) No. 2(3) Serial No. —

Elevation (Spirit Level) 634.5

Quadrangle CLARINGTON Businessburg 7.5

County MARSHALL District CLAY

Engineer N. JAMES SCHELLHASE

Engineer's Registration No. 1673

File No. OIL WELLS Drawing No. 3

Date AUGUST 1, 1952 Scale 1 inch = 800 ft.

WEST VIRGINIA
 DIVISION OF ENVIRONMENTAL PROTECTION
 OFFICE OF OIL AND GAS
 #10 McJUNKIN ROAD
 NITRO, WEST VIRGINIA 25143-2506

WELL LOCATION MAP

FILE NO. MARS-241-P

+ Denotes location of well on United States Topographic Maps, scale 1 to 62,500, latitude and longitude lines being represented by border lines as shown.

- Denotes one inch spaces on border line of original tracing.

JAN 30 1998

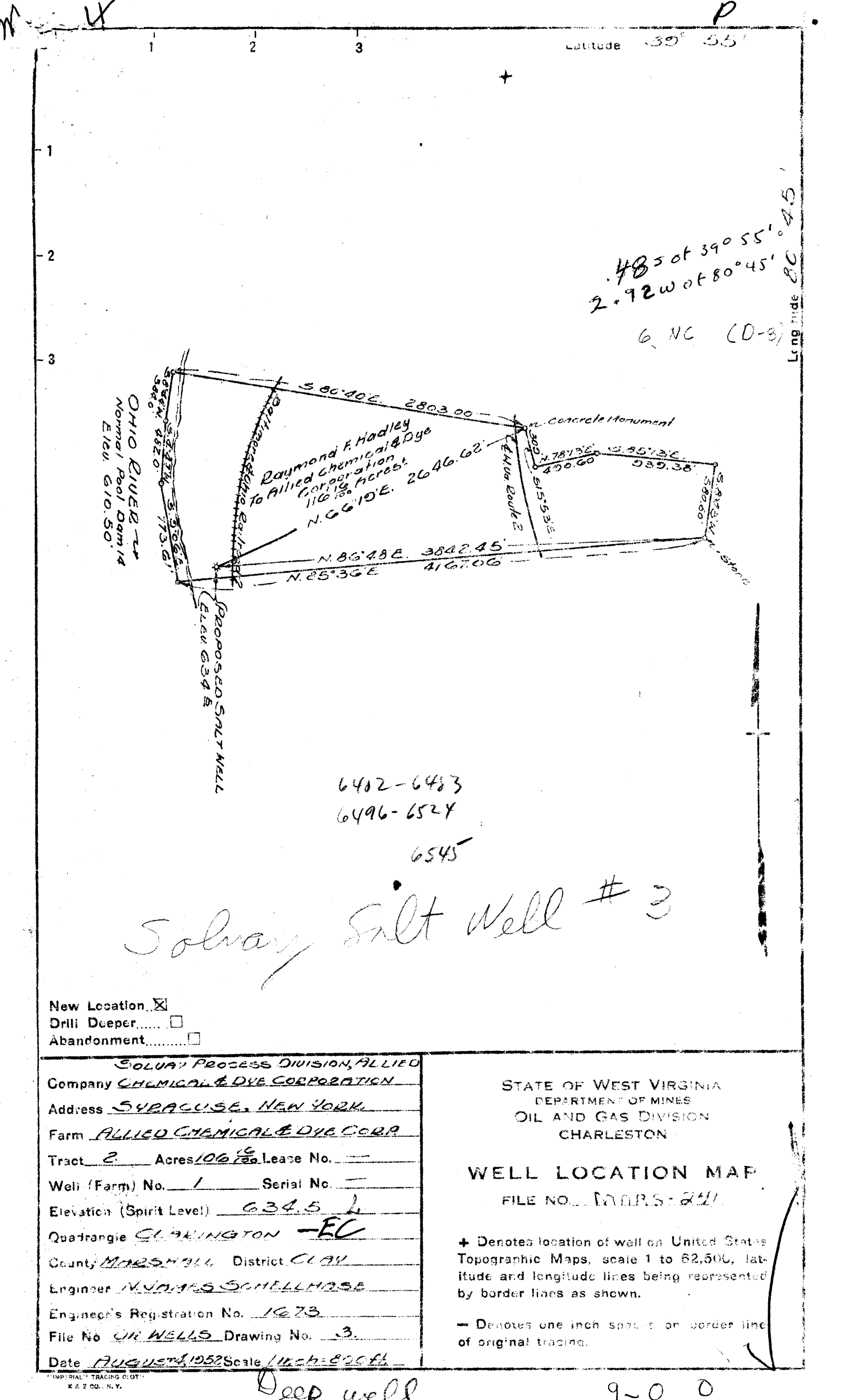

485 of 39° 55'
 2.92 W of 80° 45'
 6 NC (D-8)
 Long side 80

OHIO RIVER
 Normal Pool Dam
 Elev. 610.50

PROPOSED SALT WELL
 Elev 634.5

Raymond F. Hadley
 To Allied Chemical & Dye
 Corporation
 110.19 Acres

6402-6483
 6496-6524
 6545

Solvay Silt Well # 3

New Location
 Drill Deeper
 Abandonment

SOLVAY PROCESS DIVISION, ALLIED
 Company CHEMICAL & DYE CORPORATION
 Address SYRACUSE, NEW YORK
 Farm ALLIED CHEMICAL & DYE CORP
 Tract 2 Acres 106.19 Lease No. —
 Well (Farm) No. 1 Serial No. —
 Elevation (Spirit Level) 634.5
 Quadrangle CLARKINGTON - EC
 County MARSHALL District CLAY
 Engineer N. JAMES SCHELLHASE
 Engineer's Registration No. 1673
 File No. OR WELLS Drawing No. 3
 Date AUGUST 1952 Scale 1 inch = 820 ft

STATE OF WEST VIRGINIA
 DEPARTMENT OF MINES
 OIL AND GAS DIVISION
 CHARLESTON

WELL LOCATION MAP
 FILE NO. MARS-241

+ Denotes location of well on United States
 Topographic Maps, scale 1 to 62,500, lat-
 itude and longitude lines being represented
 by border lines as shown.

- Denotes one inch space on border line
 of original tracing.

Deep well

9-0 0

FINAL-24

slate & shells	1922 - 4959	
sh	4959 - 5542	- Gas pocket
Lime	5542 - 5742	
Sand	5752 - 5800	
Lime	5800 - 6402	- Gas pocket 6100
Salt	6402 - 6483	
Anhydrite dells	6483 - 6496	
Salt	6496 - 6524	
Anhydrite	6524 - - - -	
TD	6545	

comp Dec 18, 1952

Rock salt well

STATE OF WEST VIRGINIA
DEPARTMENT OF MINES
OIL AND GAS DIVISION

WELL RECORD

Oil or Gas Well Oil
(KIND)

Clairington
Permit No. Mar-241

Company Solvay Process Division
Address P. O. Drawer 271, Syracuse 1, New York
Farm Solvay Process Division Acres 106.16
Location (waters) Ohio River
Well No. 3 Elev. 634.5'
District Round Bottom County Marshall
The surface of tract is owned in fee by Solvay Process Division Address Syracuse, N. Y.
Mineral rights are owned by Solvay Process Division Address Syracuse, N. Y.
Drilling commenced July 28, 1952.
Drilling completed December 18, 1952.
Date Shot _____ From _____ To _____
With _____

Casing and Tubing	Used in Drilling	Left in Well	Packers
Size			
16 14"	79' 5"	79' 5"	Kind of Packer
13			
10	427' 9"	427' 9"	Size of
8 8-5/8"	1810' 3"	1810' 3"	
6 7" O.D.	6373' 2"	6373' 2"	Depth set
5 3/16			
3 4" Hard Pipe			Perf. top
2			Perf. bottom
Liners Used			Perf. top
			Perf. bottom

Open Flow _____ /10ths Water in _____ Inch
_____ /10ths Merc. in _____ Inch
Volume _____ Cu. Ft.
Pressure _____ lbs. _____ hrs.
Oil _____ bbls., 1st 24 hrs.
Fresh water _____ feet _____ feet
Salt water _____ feet _____ feet

CASING CEMENTED 8-5/8 SIZE 1810 No. Ft. 9/15/52 Date
7" O. D. 6373 12/6/52
COAL WAS ENCOUNTERED AT 612 FEET _____ INCHES
644 FEET _____ INCHES FEET _____ INCHES
FEET _____ INCHES FEET _____ INCHES

Formation	Color	Hard or Soft	Top	Bottom	Oil, Gas or Water	Depth Found	Remarks
Clay			0	40			
Gravel			40	79			
Slate			79	155			79' 5" of 14" O.D. Drive Pipe
Sand			155	217	Water	185	
Slate			217	227			
Red Rock			227	238			
Slate			238	245			
Red Rock			245	297			
Slate			297	339			
Slate and Red Rock			339	356			
Slate			356	377			
Sand			377	381			
Slate			381	403			
Red Rock and Slate			403	415			
Gritty Lime			415	462			Run 10" Casing at 424'.
Slate			462	530			
Lime Shells			530	559			
Sand			559	612			
Coal			612	613			
Slate and Shells			613	644			
Coal			644	646			
Slate and Shells			646	670			
Sand Shell, hard			670	685			
Slate			685	699			
Sand			699	715			
Slate and Sand Shell			715	740			
Sand			740	793			
Slate			793	802			
Sand			802	850			
Slate and Shells			850	981			
Lime			981	989			
Sand			989	1086	Water	1060	
Lime			1086	1119			
Sand			1119	1395	Water	1200-1210	
Slate and Lime Shells			1395	1828			
Pink Slate and Shells			1828	1927			
Slate and Shells			1927	4959	Smell of Oil	2750	Run 8" Casing at 1,810". Surveyed Well.



Handwritten initials/signature

GRBR 1059
635
-424
1124

Formation	Color	Hard or Soft	Top	Bottom	Oil, Gas or Water	Depth Found	Remarks
Shale			4959	5542	Gas Pockets	5,416 5452 5457 5460 5463 5467 5475 5480 5485 5487 5492 5498 5505	
Shale			5542	5752			
Shale			5752	5800			
Shale			5800	6402	Gas Pocket	6108	1/2 Bailer in 3 hr Run 7" O. D. Casing at 6,402' Surveyed Well. Surveyed Well. Run 4" Tubing.
Salt			6402	6483	Water	6240	
Anhydrite Shells			6483	6496			
Salt			6496	6524			
Anhydrite			6524				
Total Depth				6545			

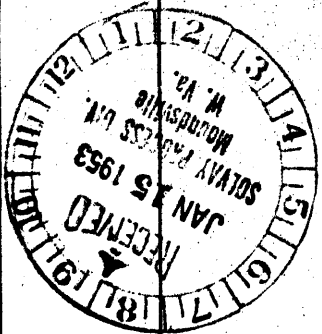

Report Filled out by
 J. G. Fox, Drilling Contractor
 Box 205
 Washington, Pennsylvania

APPROVED Solway Group Inc Owner
 By [Signature]
 Date Jan 16 1953

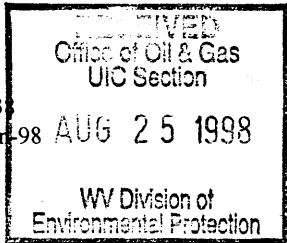

WR-3
26-Jan-98

API # 47- 51-00241-P

STATE OF WEST VIRGINIA
DIVISION OF ENVIRONMENTAL PROTECTION
SECTION OF OIL AND GAS

AFFIDAVIT OF PLUGGING AND FILLING WELL

AFFIDAVIT SHOULD BE IN TRIPLICATE, one copy mailed to the Division, one copy to be retained by the Well Operator and the third copy (and extra copies if required) should be mailed to each coal operator at their respective addresses.

Farm name: HANLIN CHEMICALS Operator Well No.: 3

LOCATION: Elevation: 634.50 Quadrangle: BUSINESSBURG
District: CLAY County: MARSHALL
Latitude: 2400 Feet South of 39 Deg. 55 Min. 0 Sec.
Longitude: 3150 Feet West of 80 Deg. 47 Min. 30 Sec.

Well Type: OIL _____ GAS _____ OTHER: BRINE

Company: Allied Signal Inc. Coal Operator _____
PO Box J or Owner _____
Moundsville, WV 26041

Agent: Don P. DeNoon Coal Operator _____
or Owner _____

Permit Issued: 01/26/98

AFFIDAVIT

STATE OF WEST VIRGINIA,
County of _____ ss:

Union Drilling and James R. Harry, Consultant being first duly sworn according to law depose and say that they are experienced in the work of plugging and filling oil and gas wells and were employed by the above named operator, and participated in the work of plugging and filling the above well, and Michael W. Lewis Oil and Gas Inspector representing the Director, say that said work was commenced on the 15 day of December, 1997, and that the well was plugged and filled in the following manner:

Type	From	To	Pipe Removed	Left
Class A	4.534'	4.568'	14" 0'	79'
Salt Gel	4.337'	4.534'	10(3/4)" 0'	428'
Class A w/Latex	3.779'	4.337'	8(5/8)" 0'	1.810'
Salt Gel	2.100'	3.779'	7" 2.070'	4.330'
Class A	1.859'	2.100'		
Salt Gel	0'	1.859'		
7" Window Cut	4.090'	4.139'		
Bridge Plug	4.568'			
Bridge Plug	4.620'			

Description of monument: 8(5/8) welded pipe w/2" vent (5' length)
and that the work of plugging and filling said well was completed on the 23 day of February, 1998.

and further deponents saith not. with regard Union Drilling

Sworn and subscribe before me this 6 day of AUGUST, 1998

My commission expires: 2-7-2006

Joyce E Haggerty
Notary Public

Oil and Gas Inspector: Michael W Lewis

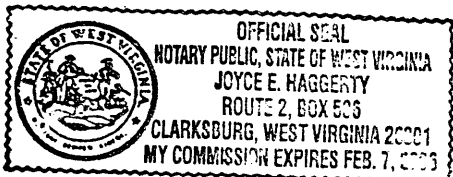

AUG 31 1998

MARS 0241-P