

COAL OWNED BY EVERETT MOORE MOUNDSVILLE W.VA.

NEW LOCATION
 DRILL DEEPER
 ABANDONMENT - *land 3/19/71*

COMPANY <u>THE MANUFACTURERS LIGHT AND HEAT CO</u>	
ADDRESS <u>800 UNION TRUST BLD'G. PITTSBURGH PA.</u>	
FARM <u>NORA HARSH</u>	
TRACT <u> </u>	ACRES <u>273.59</u> LEASE No. <u>19436</u>
WELL (FARM) No. <u>4</u>	SERIAL No. <u>4052</u>
ELEVATION (SPIRIT LEVEL) <u>935'</u>	
QUADRANGLE <u>CAMERON</u>	<u>NE</u>
COUNTY <u>MARSHALL</u>	DISTRICT <u>SANDHILL</u>
ENGINEER <u>A.C. Treator</u>	
ENGINEER'S REGISTRATION No. <u> </u>	
FILE No. <u> </u>	DRAWING No. <u>Y-13-321</u>
DATE <u>10-17-49</u>	SCALE <u>1" = 600'</u>

STATE OF WEST VIRGINIA
 DEPARTMENT OF MINES
 OIL AND GAS DIVISION
 CHARLESTON

WELL LOCATION MAP
 FILE No. MARS-211-P

+ DENOTES LOCATION OF WELL ON UNITED STATES TOPOGRAPHIC MAPS. SCALE 1 TO 62,500. LATITUDE AND LONGITUDE LINES BEING REPRESENTED BY BORDER LINES AS SHOWN.
 - DENOTES ONE INCH SPACES ON BORDER LINE OF ORIGINAL TRACING.

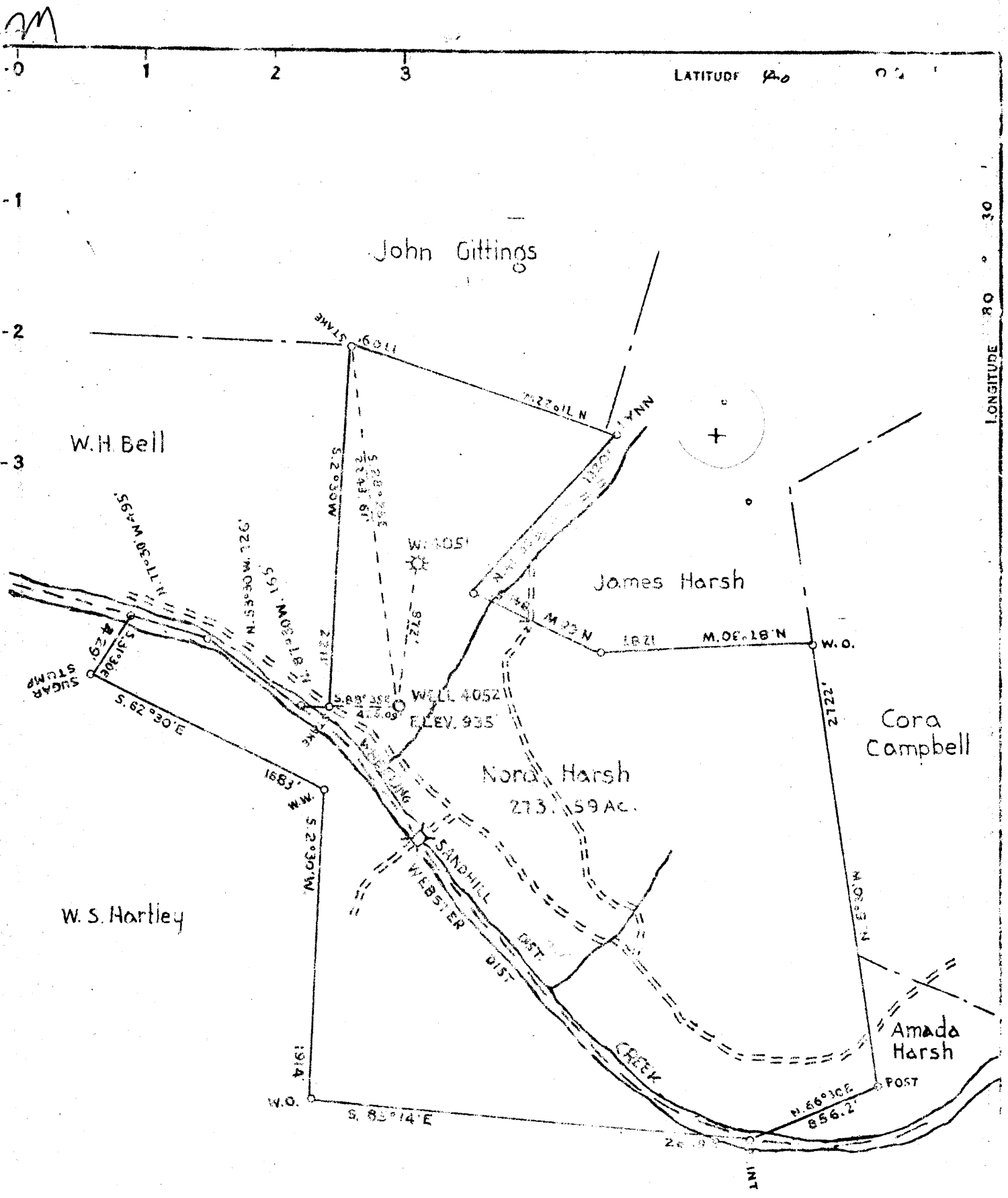

COAL OWNED BY EVERETT MOORE MOUNDSVILLE W.VA.

NEW LOCATION...
 DRILL DEEPER...
 ABANDONMENT...

S-294
 W-219

COMPANY THE MANUFACTURERS LIGHT AND HEAT CO	
ADDRESS 800 UNION TRUST BLD'G. PITTSBURGH PA.	
FARM NORA HARSH	
TRACT	ACRES 273.59 LEASE NO. 19436
WELL (FARM) NO. 4	SERIAL NO. 4052
ELEVATION (SPIRIT LEVEL) 935'	
QUADRANGLE CAMERON	
COUNTY MARSHALL	DISTRICT SANDHILL
ENGINEER <i>A. C. Trotter</i>	
ENGINEER'S REGISTRATION NO.	
FILE NO.	DRAWING NO. Y-13-321
DATE 10-17-49	SCALE 1" = 600'

STATE OF WEST VIRGINIA
 DEPARTMENT OF MINES
 OIL AND GAS DIVISION
 CHARLESTON

WELL LOCATION MAP

FILE NO. MARS-211

+ DENOTES LOCATION OF WELL ON UNITED STATES TOPOGRAPHIC MAPS. SCALE 1 TO 62,500. LATITUDE AND LONGITUDE LINES BEING REPRESENTED BY BORDER LINES AS SHOWN.
 - DENOTES ONE INCH SPACES ON BORDER LINE OF ORIGINAL TRACT.

WEST VIRGINIA DEPARTMENT OF MINES
OIL & GAS DIVISION
W E L L R E C O R D

Permit No. Mars 211

Gas Well
CASING & TUBING

Cameron Quad.

The Manf. Light & Heat Co.

Company

Address

Farm

Well No.

District

Commenced

Completed

Open flow

Volume

Rock Pressure

Water

Nora Harsh 300 A

L-4052 Elev. 935

Sandhill & Webster Marshall County

Oct. 26, 1949

Nov. 25, 1949

20/10 W 1" 11-25-49

35,962 Big Injun Sand

290# 48 hrs.

396' 3 blrs. per hr.

16" Cond.

10 424

8 1/2 1490

4

Anchor Packer

Size 6 5/8 x 4

Depth 1505'

Pitts. coal 389-396

16"

424

1490

1712

Clay	0	15	Slate	1248	1264			
Sandstone	15	28	Lime	1264	1276			
Blue Slate	28	50	Slate, Black	1276	1284			
Lime	50	72	Lime	1284	1299			
Slate	72	90	Slate & Lime Shells	1299	1348			
Coal	90	93	Lime	1348	1359			
Slate	93	98	Slate	1359	1370			
Lime	98	135	3rd Salt Sand	1370	1445			
Slate	135	172	Slate, Black	1445	1478			
Lime	172	281	Injun Sand	1478	1694			
Slate	281	284	Slate	1694				
Mapletown Coal	284	287	T.D.	1700				
Slate	287	298						
Lime	298	355	SLM 396'; 1024'; 1189'; 1489'; 1581';					
Slate	355	372						
Lime	372	377	Gas 1185' to 1190'					
Black Slate	377	389	Gas at 1577'-1581'. Test 62/10 W 1"					
Lime	396	431	61,725 C.F.					
Slate	431	435						
Lime	435	447	3 jts. 10" casing below packer. 10 x 13"					
Red Rock	447	458	packer set at 337'. 11 jts. of 10" above					
Lime	458	470	packer. 6 5/8" bottom hole packer set at					
Red Rock	470	488	1490'. 12 jts. casing between packers.					
Lime Shells & Slate	488	532	1-6 5/8" upside down packer set at 1146'					
Black Slate	532	547	39 jts. of 6 5/8" above packer.					
Lime	547	556						
Red Rock	556	581	4" tubing record (Thds. off)					
Slate	581	589	Perf. 15'	5"				
Lime	589	594	3 jts. tubing 73'	3"				
Slate	594	655	Perf. 31'	11"				
Red Rock	655	670	Perf. 24'	11"				
Lime	670	675	2 jts. tubing 49'	0"				
Red Rock	675	683	6 5/8" x 4 Packer					
Lime	683	689	49 jts. tubing 1505'	2"				
Slate	689	705	1699'	9"				
Sand	705	735	Add for thds. 12'	11"				
Slate	735	750	1712'	8"				
Red Rock	750	765						
Lime	765	777						
Slate	777	789	1 5 10 30 60 24 hr 48hr					
Lime	789	802	0 9 19 57 107 275 290					
Slate	802	855						
Slate & Shells	855	878						
Lime, Gritty	878	901						
Slate, Black	901	912						
Lime	912	990						
Slate, Black	990	997						
Lime	997	1012						
Slate Black	1012	1020						
Gas Sand	1020	1094						
Slate, Black	1094	1140						
Lime	1140	1148						
Slate & Lime Shells	1148	1186						
2nd Salt Sand	1186	1202						
Slate, Black	1202	1230						
Lime	1230	1248						

370

1478
935
543

838
377
658