

Latitude

80°30'00"

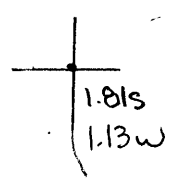

Longitude

Topo Location

7.5' Loc. _____ 15' Loc. _____
 _____ (calc.) _____

Company Mammoth Hill

Farm Michael Cowley Hrs # 2 -3722

15' Quad _____
(sec.)

7.5' Quad Majorsville

District Webster

WELL LOCATION PLAT

County 051 Permit 147

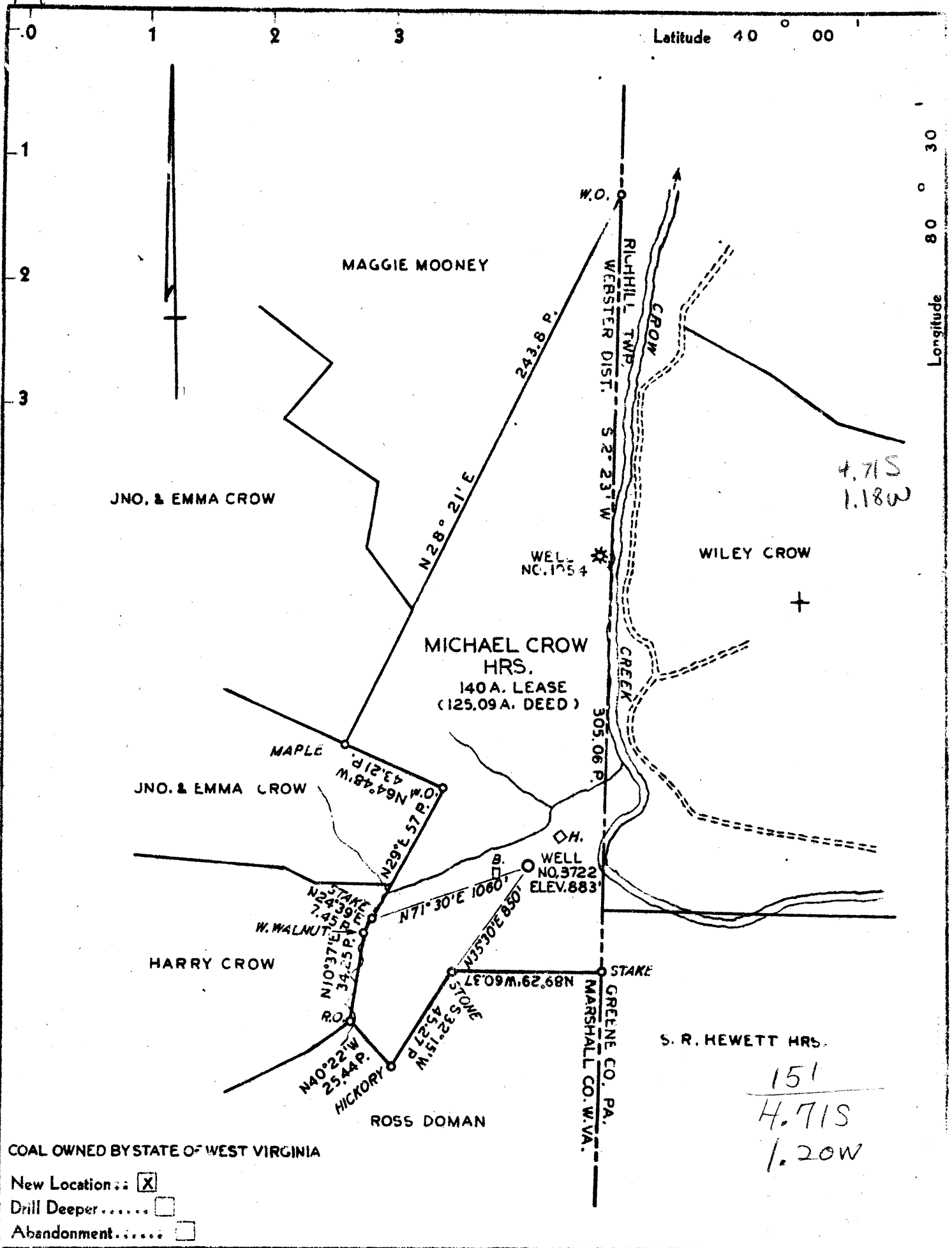

Company THE MANUFACTURERS LIGHT & HEAT CO.
 Address 800 UNION TRUST BLDG. PITTSBURGH PA.
 Farm MICHAEL CROW HRS.
 Tract Acres 140 Lease No. 2897
 Well (Farm) No. 2 Serial No. 3722
 Elevation (Spirit Level) 883'
 Quadrangle CAMERON N.E.
 County MARSHALL District WEBSTER
 Engineer A. J. Russell
 Engineer's Registration No.
 File No. Drawing No. Y-10 963
 Date OCT. 7, 1943. Scale 1" = 800'

STATE OF WEST VIRGINIA
 DEPARTMENT OF MINES
 OIL AND GAS DIVISION
 CHARLESTON

WELL LOCATION MAP
 File No. MARS-147

- Denotes location of well on United States Topographic Maps, scale 1 to 62,500, latitude and longitude lines being represented by border lines as shown.

- Denotes one inch spaces on border line of original tracing.

WEST VIRGINIA DEPARTMENT OF MINES
OIL & GAS DIVISION
W E L L R E C O R D

Permit No. Mars 147 D		Gas Well
Cameron N.E. Quad.		CASING & TUBING
Company	The Manufacturers Light & Heat Co.	
Address	800 Union Trust Bldg., Pittsburgh, Pa.	8 1/2 1201'8 Same
Farm	Michael Crow Acres 140	6 5/8 1436'11 Same
Location		
Well No	2 - 3722 Elev. 1135' <i>wrong</i>	Anchor Packer
District	Webster Marshall County	Size
Surface	W.S. Phillips, R.D. 3 Cameron, W.Va.	8 1/2 x 6 5/8
Mineral	The Mfrs. Light & Heat Co., 800 Union Trust Bldg. Pittsburgh, Pa.	Depth 815'
Commenced (deeper)	7-11-44	
Completed	8-10-44	Coal at 1114' 24"
Not shot		
Open flow	46/10ths M in 2"	
Volume	784, 826 C.F.	
Rock Pressure	132 lbs. 48 hrs.	
Fresh Water	1290'	

DRILLED DEEPER

Sand	1092	1114	
✓ Coal	1114	1116	
Slate & Shells	1116	1137	
✓ Sand	1137	1176	
Slate	1176	1197	
Lime Shells	1197	1225	
Sand Shells	1225	1255	
✓ Salt Sand 30'	1255	1350	Gas 1265'
Slate	1350	1387	
Sand	1387	1412	
✓ Big Lime	1412	1425	
✓ Injun Sand	1425	1643	Gas 1496 to 1528
Slate & Shells	1643	1933	
Lime	1933	1954	
Slate	1954	1996	
Sand	1996	2024	
Slate & Shells	2024	2035	
Lime	2035	2058	
Slate & Shells	2058	2105	
Red Sand	2105	2125	
Slate & Shells	2125	2253	
✓ 50' Sand	2253	2262	
Slate & Shells	2262	2310	
✓ 30' Shells	2310	2320	
Slate & Shells	2320	2352	
✓ Gordon Stray Sand	2352	2375	
Slate & Shells	2375	2475	
Sand Shell	2475	2482	
Slate & Shells	2482	2540	
Sand	2540	2550	
Slate & Shells	2550	2563	
TOTAL DEPTH		2563	

*1135
322
213*

*1092
147'*

*2563
120 exp 120
1643 - 1644 exp*

WEST VIRGINIA DEPARTMENT OF MINES
OIL & GAS DIVISION
W E L L R E C O R D

Gas Well
CASING & TUBING

Permit No. Mars 147			
Cameron N.E. Quad.			
Company	The Mfrs. Light & Heat Co.		
Address	800 Union Trust Bldg, Pittsburgh, Pa.		
Farm	Michael Crow	Acres 140	10 363'6 Same
Location			4 1091'7 Same
Well No	2- 3722	Elev. 883'	
District	Webster	Marshall County	
Surface	W. S. Phillips, RD3, Cameron, W.Va.		
Mineral	The M L & H Co., Pittsburgh, Pa.		
Commenced	1-6-44		Anchor Packer
Completed	2-23-44		Size 10 x 8 $\frac{1}{2}$
Open flow	22/10ths M in 3"		
Volume	357,000 Gas Sand(CF)		
Rock Pressure	174 lbs. 48 hrs.		Coal at 220' 60";
Fresh Water	25'		322' 72"; 859' 72"

Clay	0	14	
Slate & Lime	14	160	
Lime	160	220	
Mapletown Coal	220	225	
Lime	225	280	
Slate & Shells	280	322	
Pittsburgh Coal	322	328	
Slate, Lime & Shells	328	390	
Red Rock	390	395	
Lime & Shells	395	425	
Red Rock	425	432	
Slate & Shells	432	446	
Red Rock	446	475	
Lime	475	488	
Red Rock	488	515	
Slate	515	576	
Red Rock	576	610	
Slate & Shells	610	630	
Sand	630	638	
Slate & Shells	638	695	
Lime	695	712	
Red Rock	712	720	
Little Dunkard Sand	720	741	
Slate	741	792	
Big Dunkard Sand	792	823	
Slate & Shells	823	859	
Coal	859	865	Gas 859'
Slate	865	900	
Shell Sand	900	918	Gas 904 to 907
Slate & Shells	918	970	
Sand	970	1012	
Black Shale	1012	1028	Gas 1020- to 1026
Slate	1028	1060	
Broken Lime	1060	1084	
Sand	1084		Gas 1084 to 1092
TOTAL DEPTH		1092	

563
722
1092