

New Location
 Drill Deeper
 Abandonment

D.P.C. PLANCOR 394 CHLORINE PLANT
 H.K. FERUSON CO PRIME CONTRACTOR.

PPG Industries, Inc.
 State Rt. 2, New Martinsville, WV 26155
 Surface: PPG, Industries
 Well NO: Brine #1

Tract _____ Acres 262 Lease No. _____
 Well (Farm) No. 1 Serial No. _____
 Elevation (Spirit Level) 689'
 Quadrangle NEW MARTINSVILLE
 County MARSHALL District FRANKLIN
 Engineer George L. M. Intine
 Engineer's Registration No. 1187
 File No. _____ Drawing No. _____
 Date JUNE 19, 1942 Scale 1" = 800 FEET

STATE OF WEST VIRGINIA
 DEPARTMENT OF MINES
 OIL AND GAS DIVISION
 CHARLESTON

WELL LOCATION MAP
 FILE NO. Mars-131-P

+ Denotes location of well on United States Topographic Maps, scale 1 to 62,500, latitude and longitude lines being represented by border lines as shown.
 - Denotes one inch spaces on border line of original tracing.

MAR 22 1936

200

031-0151-1

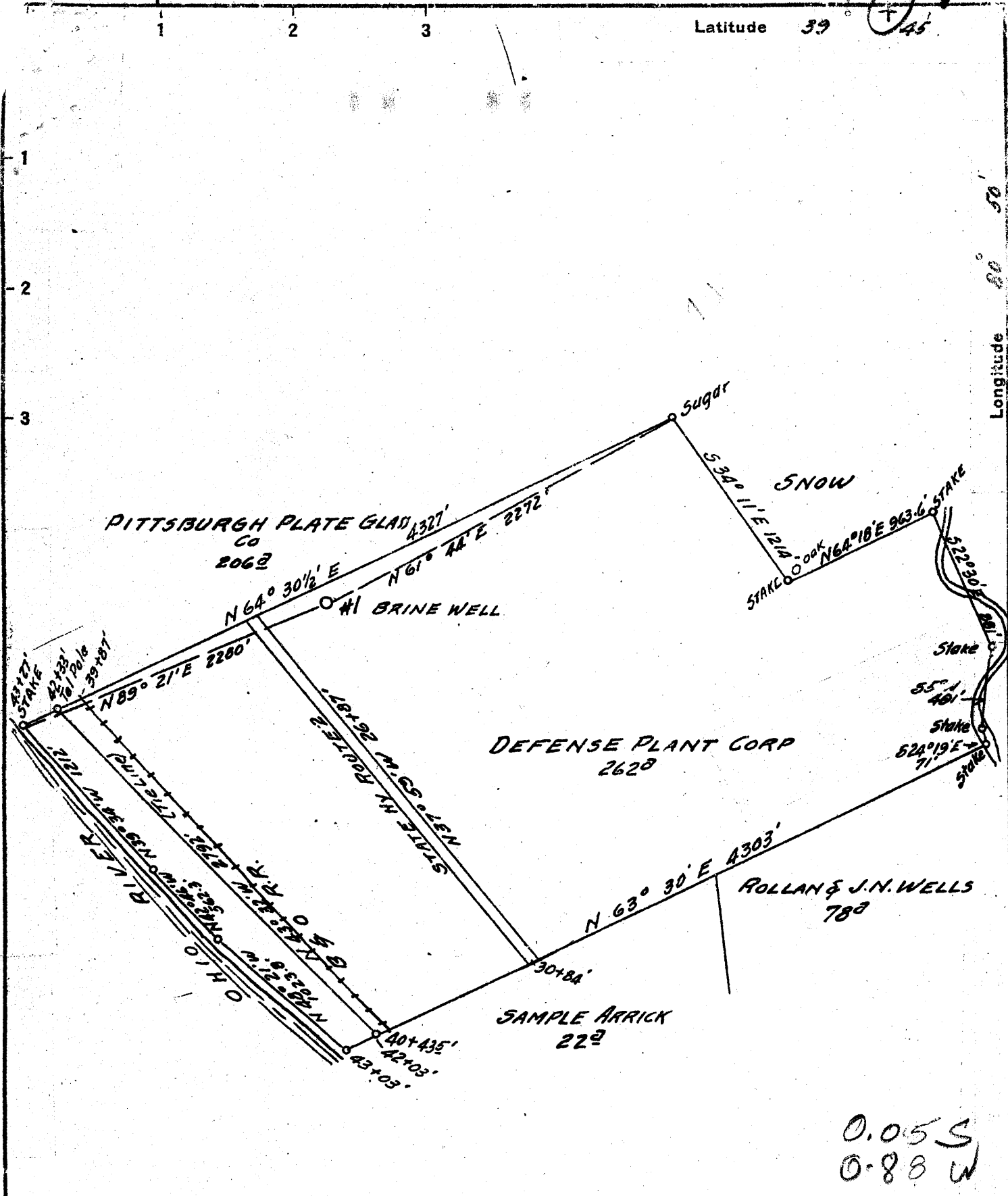

0.05 S
0.88 W

- New Location...
- Drill Deeper.....
- Abandonment.....

D.P.C. PLANCOR 39A CHLORINE PLANT.
H.K. FERGUSON CO PRIME CONTRACTOR.

Company PITTSBURGH PLATE GLASS CO
ENGINEERS & LESSEES
 Address NEW MARTINSVILLE WEST VA.
 Farm DEFENSE PLANT CORP.
 Tract _____ Acres 262 Lease No. _____
 Well (Farm) No. 1 Serial No. _____
 Elevation (Spirit Level) 689'
 Quadrangle NEW MARTINSVILLE - NC
 County MARSHALL District FRANKLIN
 Engineer George L M Intire
 Engineer's Registration No. 1187
 File No. _____ Drawing No. _____
 Date JUNE 19, 1942 Scale 1" = 800 FEET

STATE OF WEST VIRGINIA
 DEPARTMENT OF MINES
 OIL AND GAS DIVISION
 CHARLESTON

WELL LOCATION MAP
 FILE NO. MAYS - 131

+ Denotes location of well on United States Topographic Maps, scale 1 to 62,500, latitude and longitude lines being represented by border lines as shown.
 - Denotes one inch spaces on border line of original tracing.

"IMPERIAL" TRACING CLOTH
 K & E CO., N. Y.

Samples 4B

WEST VIRGINIA DEPARTMENT OF MINES
OIL & GAS DIVISION
WELL RECORD

Permit No. Mars 131
Company
Address
Farm
Location
Well No
District
Surface
Commenced
Completed

Pitts. Plate Glass Company
New Martinsville, W.Va.
Defense Plant Corp Acres --
About 4 Mi. north of Proctor
1 Elev. 689.0
Franklin Marshall County
Defense Plant Corp., Washington, D.C.
Jun. 15, 1942
Sept. 12, 1942

Salt Well
CASING & TUBING
13 3/8 327
85/8 6473
CASING CEMENTED:
8 5/8 2000'
Coal at 218'

Rotary table to ground		0	12	
Clay	Bk S	12	25	
Sand-Gravel	S	25	85	
Sand	S	85	170	
Limestone	Lt Br to Gr H	170	218	
✓ Coal	Bk S	218	224	
Siltstone	Gr S	224	240	
Limestone	Bk S	240	260	
Sandstone	Lt Gr S	260	275	
Limestone	Lt Br S	275	335	
Siltstone	Gr S	335	345	
Sandstone	Lt Gr S	345	350	
Shale-Sand	Lt Gr S	350	1190	
Limestone	Gr S	1190	1208	
Sandstone	Lt Gr H	1298	1320	
Sandstone	Wh S	1320	1381	
✓ Limestone	Wh S	1381	1412	
✓ Sandstone	Wh S	1412	1635	
Siltstone	Gr S	1635	1775	
Sandstone	Lt Gr S	1775	1780	
Siltstone	Gr S	1780	1795	
Sandstone	Wh H	1795	1875	
Siltstone	Gr S	1875	1975	
✓ Shale	Gr H	1975	2640	
Siltstone	Gr S	2640	3290	
Shale	Gr H	3290	3300	
Sandstone	Lt Gr H	3300	3310	
Shale	Gr H	3310	3410	
Siltstone	Lt Gr H	3410	3430	
Shale & Siltstone	Gr H	3430	3520	
Siltstone	Gr H	3520	3680	
Shale	Lt Gr H	3680	5830	
✓ Limestone	Br H	5830	5970	
✓ Chert	Wh H	5970	5985	
Limestone	Br H	5985	6060	
✓ Sandstone	Wh H	6060	6125	Oriskany
✓ Sandstone	Br H	6125	6145	Helderberg
Limestone	Wh H	6145	6415	"
✓ Limestone	Br H	6415	6510	Bottom of Devonian System at 6415
Dolomite	Lt Br & Gr H	6510	6535	Silurian System (6415-6510)
Limestone	Lt Br H	6535	6585	
Dolomite		6585	6645	
Anhydrite Rock	Gr Br H			
Limestone	Br H	6645	6665	
Dolomite	Lt Gr H	6665	6725	
Salt	S	6725	6838	
Dolomite		6838	6843	Bottom of Hole
& Anhydrite	H			

519

STATE OF WEST VIRGINIA
DIVISION OF ENVIRONMENTAL PROTECTION
SECTION OF OIL AND GAS

AFFIDAVIT OF PLUGGING AND FILLING WELL

AFFIDAVIT SHOULD BE IN TRIPPLICATE, one copy mailed to the Division, one copy to be retained by the Well Operator and the third copy (and extra copies if required) should be mailed to each coal operator at their respective addresses.

Farm name: PPG INDUSTRIES, INC. Operator Well No.: BRINE #1 WELL

LOCATION: Elevation: 689.00 Quadrangle: NEW MARTINSVILLE
District: FRANKLIN County: MARSHALL
Latitude: 200 Feet South of 39 Deg. 45 Min. 0 Sec.
Longitude 4500 Feet West of 8 Deg. 5 Min. 0 Sec.

Well Type: OIL _____ GAS _____ BRINE X

Company: PPG INDUSTRIES, INC
PO BOX 191
NEW MARTINSVILLE WV 26155

Coal Operator PPG INDUSTRIES, INC.
or Owner PO BOX 191
NEW MARTINSVILLE WV 26155

Agent: _____

Coal Operator _____
or Owner _____

Permit Issued: 03/22/96

AFFIDAVIT

STATE OF WEST VIRGINIA,
County of MARSHALL ss:

LANG BROS., INC. and DOWELL SCHLUMBERGER being first duly sworn according to law depose and say that they are experienced in the work of plugging and filling oil and gas wells and were employed by the above named well operator, and participated in the work of plugging and filling the above well, and RANDALL MICK Oil and Gas Inspector representing the Director, say that said work was commenced on the 19th day of MARCH, 1996, and that the well was plugged and filled in the following manner:

TYPE	FROM	TO	PIPE REMOVED	LEFT
BAKER 5 3/4" DOUBLE ANCHOR PICKER	6041.56	6027.26		
CEMENT 32 BARRELS	6027.26	5641.26		All casing CTS
5% GEL 130 BARRELS	5641.26	3496.44		No Pipe Removed
CEMENT 23.1 BARRELS	3496.44	3166.44		
6% GEL	3166.44	1734'		
CEMENT 57 SACKS	1734'	1549'		
6% GEL	1549'	894'		
CEMENT	894'	SURFACE		

Description of monument: 7" DIAMETER, 4' HIGH WITH 2" VALVE AND WELL ID
and that the work of plugging and filling said well was completed on the 12th day of APRIL, 1996.

And further deponents saith not.

A. T. Hearn 10/20/97

Sworn and subscribe before me this 20th day of October, 1997

My commission expires: Mar 23, 2002

Alice K. Johnson
Notary Public



Oil and Gas Inspector: [Signature]