

39°47'30"

Latitude

80°37'30"

Longitude

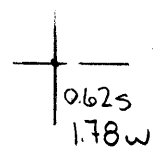

Topo Location

7.5' Loc. _____ 15' Loc. _____
 _____ (calc.) _____

Company Manufact Lt+Ht

Farm CH Carpenter # 3401

15' Quad _____
(sec.)

7.5' Quad Glen Easton

District Liberty

WELL LOCATION PLAT

County 051 Permit 9

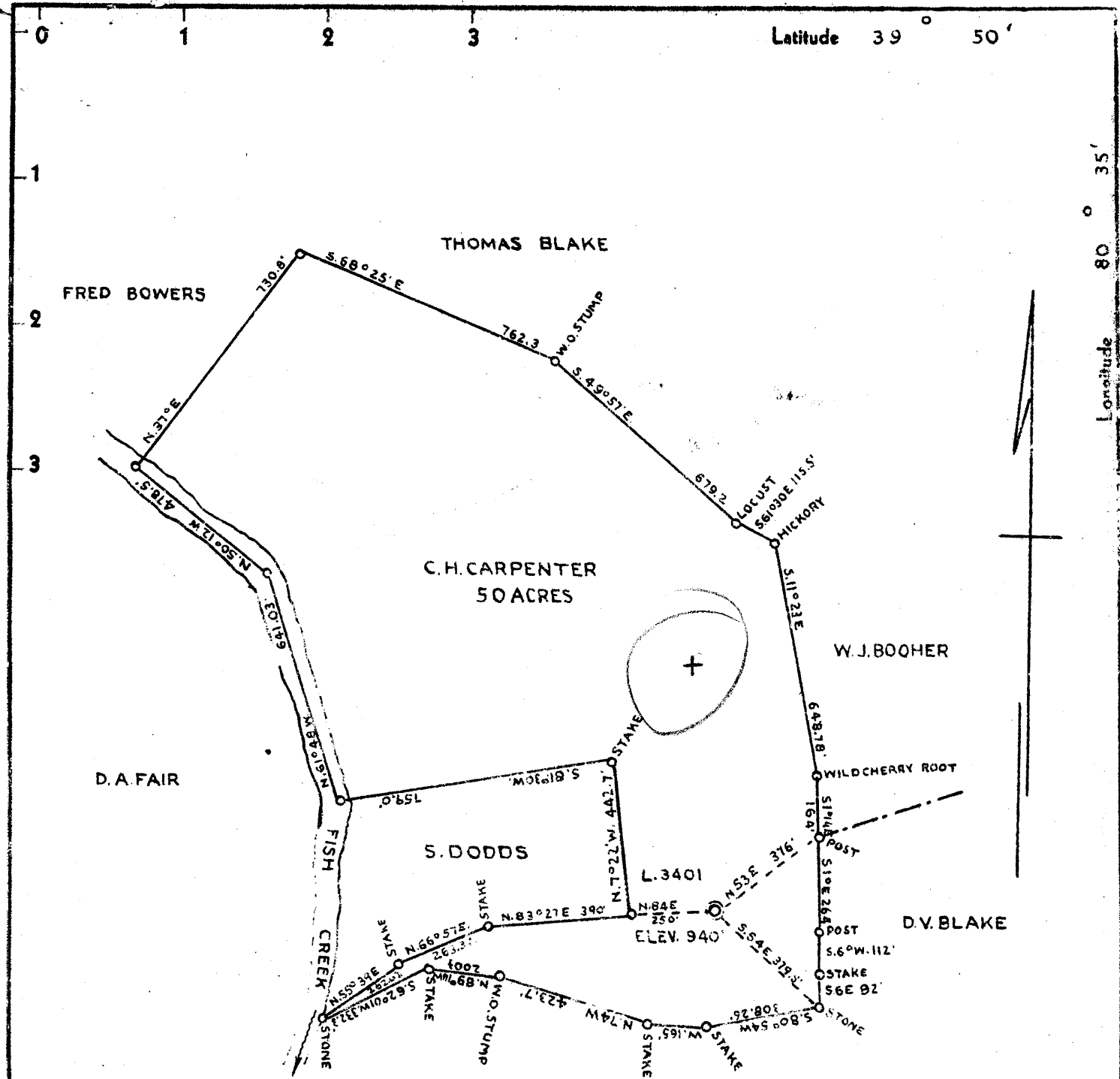

COAL OWNED BY LIBERTY COAL CO.

4.465
2.92W

Handwritten notes and initials, including 'F. 493' and 'CS'.

- New Location:
- Drill Packer:
- Abandonment:

Company THE MANUFACTURERS LIGHT & HEAT CO
 Address 80 UNION TRUST BLD'G. PITTSBURGH PA
 Farm C.H. CARPENTER
 Tract Acres 50 Lease No. 2559
 Well (Farm) No. 1 Serial No. 3401
 Elevation (Spirit Level) 940'
 Quadrangle CAMERON S.W. 1/4 SC
 County MARSHALL District LIBERTY
 Engineer Donald K. Bell
 Engineer's Registration No. _____
 File No. 0-25-28 Drawing No. Y-10-389
 Date NOV. 5-1941 Scale 1" = 400'

STATE OF WEST VIRGINIA
 DEPARTMENT OF MINES
 OIL AND GAS DIVISION
 CHARLESTON

WELL LOCATION MAP
 File No. MARS 9-PA

— Denotes location of well on United States Topographic Maps, scale 1 to 62,500, latitude and longitude lines being represented by border lines as shown.
 --- Denotes one inch spaces on border line of original tracing

WEST VIRGINIA DEPARTMENT OF MINES
OIL & GAS DIVISION
W E L L R E C O R D

Permit No. Mars.-9
Cameron Quad.
Company
Address
Farm
Well No.
District
Surface
Mineral
Commenced
Completed
Rock Pressure

Manufacturers Light & Heat Co.,
800 Union Trust Bldg., Pittsburgh, Pa.
C.H. Carpenter
1-3401
~~Liberty - Marshall County~~
S.W. Booher, Moundsville, W. Va.
The M L & H Co.
11/16/29
1/2/30
74lbs

Gas Well
Casing & Tubing
10 504'2"
8 1/2 1305' 1305'
6-5/8 1665 1665
4 1917'9" 1917'9"
Packer - Anchor
Size 6-5/8x4"
Depth set 1892'
Coal 390' 60"
475' 60"
655' 96"
755' 108"

Clay, Shells	0	60
Sand	60	80
Shale, Lime, Shells	80	390
Coal	390	395
Shale, Lime, Shells	395	475
Waynesburg Coal	475	480
Rock, Shale, Lime	480	655
Mapletown Coal	655	663
Shale, Rock, Lime	663	755
Pittsburgh Coal	755	764
Shale, Lime, Rock	764	1145
Little Dunkard	1145	1155
Shale, Lime, Rock	1155	1280
Big Dunkard	1280	1305
Shale, Lime, Rock	1305	1425
Gas Sand	1425	1442
Rock, Shale	1442	1495
1st. Salt Sand	1495	1545
Lime	1545	1585
2nd Salt Sand	1585	1665 HFW 1630
Lime	1665	1695
3rd Salt Sand	1695	1790 Gas 1750-55
Shale, Rock	1790	1810
Maxon Sand	1810	1848
Big Lime	1848	1890
Big Injun Sand	1890	1908 Gas 1895-1900
Total Depth		1908

1848
945

908

1848
95

1943
940

1003

1943
764

1179

1848
940

908

940
764

1704

480
1100