

39° 30' 00"

80° 15' 00"

Latitude



Longitude

Topo Location

7.5' Loc. _____ 15' Loc. _____
_____ (calc.) _____

Company _____

Farm _____

15' Quad _____
(sec.)

7.5' Quad Shannonston

District Lincoln

WELL LOCATION PLAT

County 049 Permit 30953

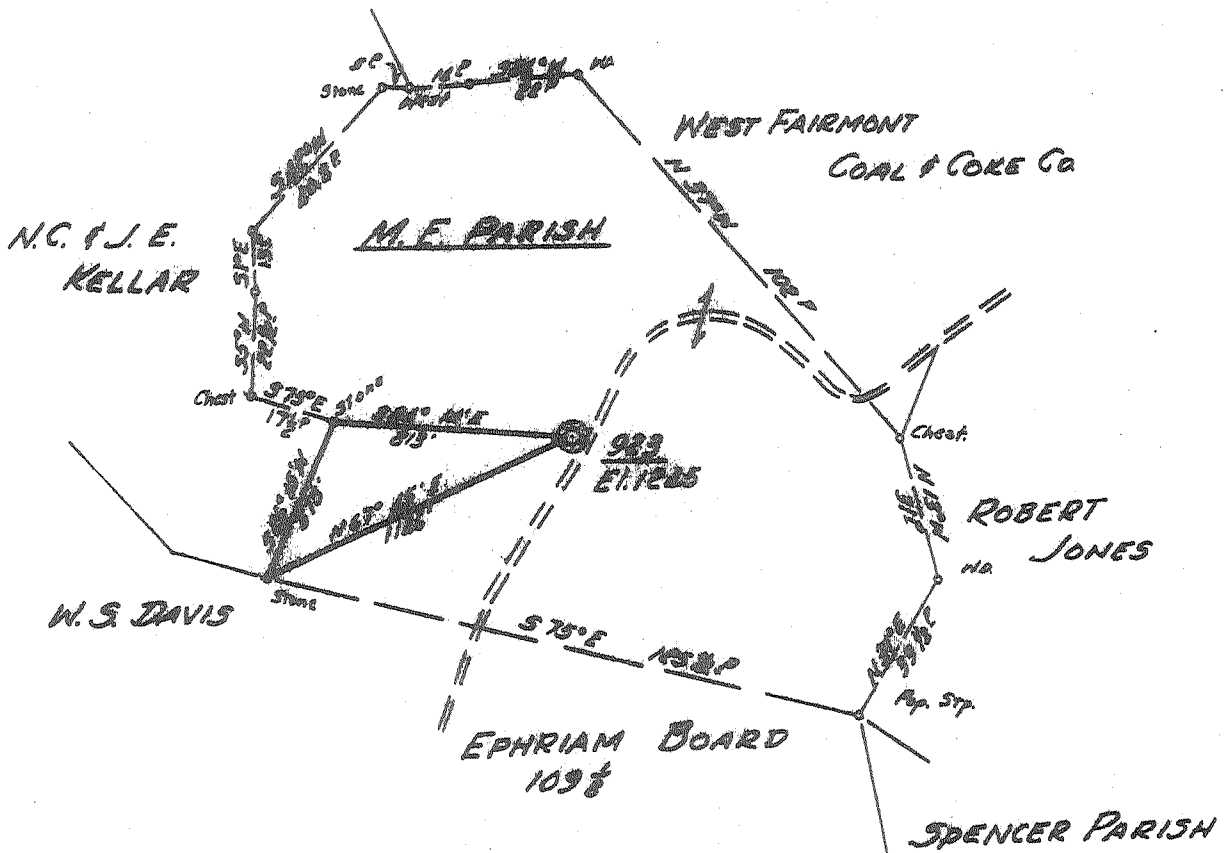

Minimum Error of Closure 1' IN 200'
 Source of Elevation CON GAS SUPPLY CORP WELL 787
ELEV. 1149.59
 "I, the undersigned, hereby certify that this map is correct to the best of my knowledge and belief and shows all the information required by paragraph 6 of the rules and regulations of the oil and gas section of the mining laws of West Virginia."

New Location
 Drill Deeper
 Abandonment

4-19-73

MAP SHEET 30-N 3, E 19 F.B. 571, Pg 19

0.455
1.96W

Company CONSOLIDATED GAS SUPPLY CORP
 Address CLARKSBURG WEST VA
 Farm MARGARET PARRISH
 Tract _____ Acres 83 Lease No. 942
 Well (Farm) No. _____ Serial No. 229
 Elevation (Spirit Level) 1245'
 Quadrangle CLARKSBURG NE
 County MARION District LINCOLN
 Engineer Jacques M. Stevens
 Engineer's Registration No. 2297
 File No. _____ Drawing No. _____
 Date 4-16-73 Scale 1" = 40 FEET

STATE OF WEST VIRGINIA
 DEPARTMENT OF MINES
 OIL AND GAS DIVISION
 CHARLESTON

WELL LOCATION MAP
 FILE NO. MAR-953-A

+ Denotes location of well on United States Topographic Maps, scale 1 to 62,500, latitude and longitude lines being represented by border lines as shown.
 — Denotes one inch spaces on border line of original tracing. 47-049

STATE OF WEST VIRGINIA
DEPARTMENT OF MINES
OIL AND GAS WELLS DIVISION

RECEIVED
JUN 21 1973
OIL & GAS
DEPT. OF MINES

AFFIDAVIT OF PLUGGING AND FILLING WELL

AFFIDAVIT SHOULD BE MADE IN TRIPLICATE, ONE COPY MAILED TO THE DEPARTMENT, ONE COPY TO BE RETAINED BY THE WELL OPERATOR AND THE THIRD COPY (AND EXTRA COPIES IF REQUIRED) SHOULD BE MAILED TO EACH COAL OPERATOR AT THEIR RESPECTIVE ADDRESSES.

Bethlehem Mines Corporation
COAL OPERATOR OR OWNER
26 Kanawha St., Buckhannon, W. Va.
ADDRESS

Consolidated Gas Supply Corp.
NAME OF WELL OPERATOR
Clarksburg, W. Va.
COMPLETE ADDRESS

COAL OPERATOR OR OWNER
ADDRESS

June 13 19 73
WELL AND LOCATION
Lincoln District

Hartzel A. Boord, Agent
LEASE OR PROPERTY OWNER
Rt. 1, Farmington, W. Va.
ADDRESS

Marion County
Well No. 923

Margaret Parrish Farm

STATE INSPECTOR SUPERVISING PLUGGING Mr. Wm. Blosser, Box 1857, Colfax, W. Va.
Ph. 363-9105

AFFIDAVIT

STATE OF WEST VIRGINIA,
County of Monongalia } ss:
James Gump

and Dale Chisler

being first duly sworn according to law depose and say that they are experienced in the work of plugging and filling oil and gas wells and were employed by Chisler Brothers, well operator, and participated in the work of plugging and filling the above well, that said work was commenced on the 18th day of May, 19 73, and that the well was plugged and filled in the following manner:

| SAND OR ZONE RECORD FORMATION | FILLING MATERIAL TOTAL DEPTH | PLUGS USED SIZE & KIND | CASING | |
|----------------------------------|---------------------------------|---|------------|-------------|
| | | | CSS PULLED | CSS LEFT IN |
| Gel | 3,154-2,775' | 2" tubing | 2,775' | 379' |
| Cement | 2,775-2,750' | | | |
| Gel | 2,750-2,476' | 5 1/2" casing | 1,675' | 286' |
| Cement | 2,476-2,450' | | | |
| Gel | 2,450-1,675" | 7" casing | 1,567' | 41' |
| Cement | 1,675-1,645' | | | |
| Gel | 1,645-1,470' | | | |
| Cement | 1,470-1,440' | | | |
| Gel | 1,440- 980' | | | |
| Cement | 980- 950' | | | |
| Gel | 950- 600' | | | |
| Cement | 600- 570' | | | |
| Gel | 570-Surface | | | |
| COAL SEAMS | | DESCRIPTION OF MONUMENT | | |
| (NAME) | | Erected a 10x2" reducer on 10" casing with 2" vent extending approximately 3' above the surface with date and well no. welded as well identification. | | |
| (NAME) | | | | |
| (NAME) | | | | |
| (NAME) | | | | |

and that the work of plugging and filling said well was completed on the 30th day of May, 19 73.

And further deponents saith not.

James Gump
Dale Chisler

Sworn to and subscribed before me this 18th day of May, 19 73.

Catherine S. Weston
Notary Public.

My commission expires: June 12, 1976

Permit No. 453-A C. NOLL