

Latitude

Longitude

+  
1.84s  
.97w

Topo Location

7.5' Loc. \_\_\_\_\_ 15' Loc. \_\_\_\_\_  
\_\_\_\_\_ (calc.) \_\_\_\_\_

Company \_\_\_\_\_

Farm \_\_\_\_\_

15' Quad \_\_\_\_\_  
(sec.)

7.5' Quad Grant Town

District Paw Paw

WELL LOCATION PLAT

County 049 Permit 30386

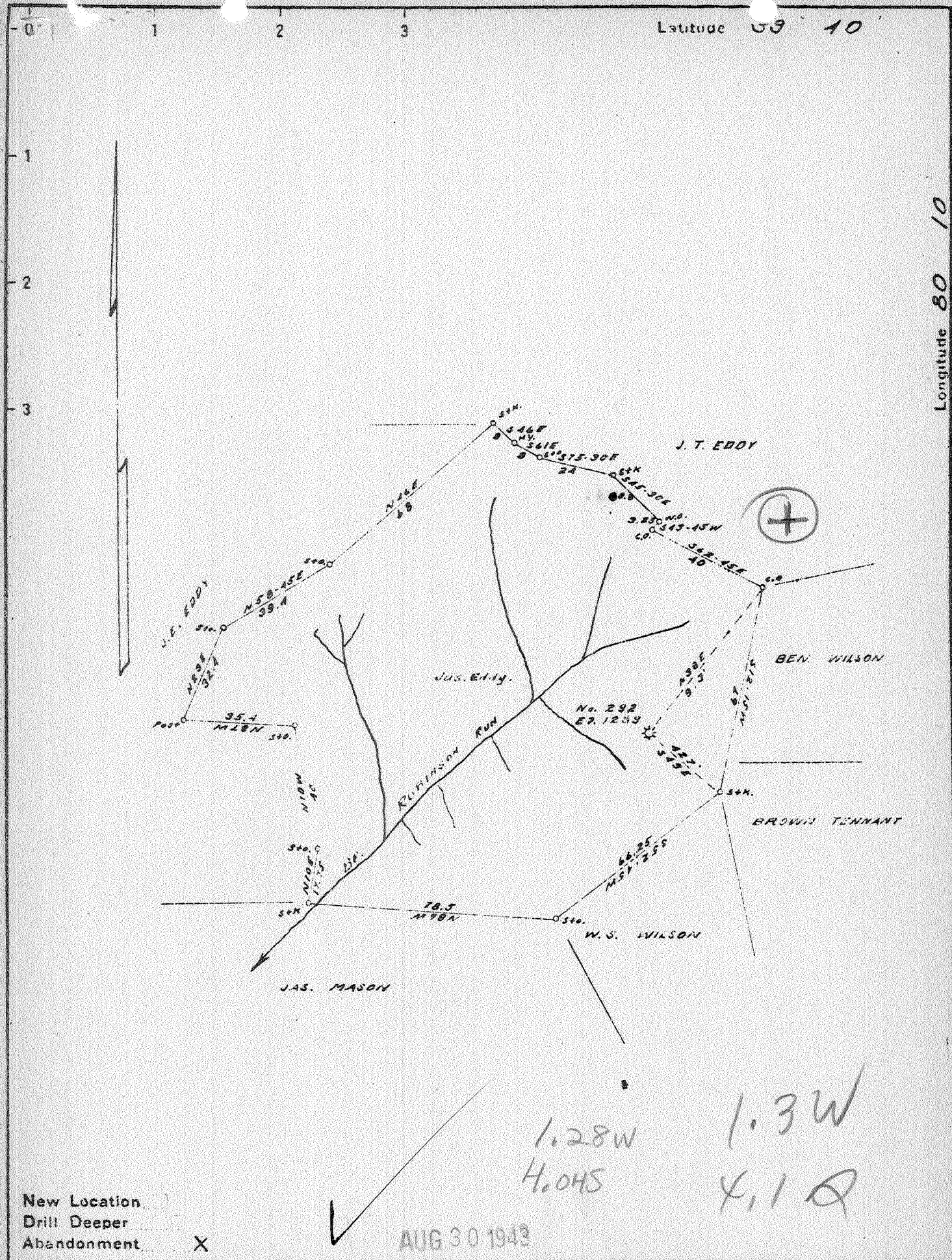

New Location   
 Drill Deeper   
 Abandonment  X

✓ AUG 30 1943  
 1.28W  
 H. O. H. S.  
 1.3W  
 Y. I. Q.

Company CARNEGIE NATURAL GAS  
 Address PITTSBURGH PA.  
 Farm JAMES EDDY  
 Tract \_\_\_\_\_ Acres 307 Lease No. E-5437-42  
 Well (Farm) No. 3 Serial No. E-292  
 Elevation (Spirit Level) 1239  
 Quadrangle BLACKSVILLE S.W.  
 County MARION District PAW PAW  
 Engineer R. L. Sweeney  
 Engineer's Registration No. \_\_\_\_\_  
 File No. \_\_\_\_\_ Drawing No. \_\_\_\_\_  
 Date 11-3-41 Scale 1"=40 RODS

STATE OF WEST VIRGINIA  
 DEPARTMENT OF MINES  
 OIL AND GAS DIVISION  
 CHARLESTON

WELL LOCATION MAP  
 FILE NO. MAR-386-A

+ Denotes location of well on United States Topographic Maps, scale 1 to 62,500, latitude and longitude lines being represented by border lines as shown.  
 - Denotes one inch spaces on border line of original tracing.

JAMES EDDY No. 3 (E-292) - CARNEGIE N.G. Co. - MAR-386-A



STATE OF WEST VIRGINIA  
DEPARTMENT OF MINES  
OIL AND GAS DIVISION

460

ADP  
386-A

WELL RECORD

Permit No. 3-292 WELL TO BE ABANDONED. Oil or Gas Well GAS  
(KIND)

Company CARNEGIE NATURAL GAS COMPANY  
Address 1015 FRICK BLDG. PITTSBURGH, PA.  
Farm JAMES EDDY Acres 307  
Location (waters) Branch of Robinson Run  
Well No. 3-292 Elev. 1239  
District PAW PAW County MARION  
The surface of tract is owned in fee by CHICKASAW WOOD PRODUCTS CO., P.O. Box #467, Address CLARKSBURG, W. VA.  
Mineral rights are owned by SAME  
Address \_\_\_\_\_

Drilling commenced 6-15-13  
Drilling completed 9-13-13  
Date Shot \_\_\_\_\_ From \_\_\_\_\_ To \_\_\_\_\_  
With \_\_\_\_\_  
Open Flow \_\_\_\_\_ /10ths Water in \_\_\_\_\_ Inch  
\_\_\_\_\_ /10ths Merc. in \_\_\_\_\_ Inch  
Volume 231,000 Cu. Ft.  
Rock Pressure \_\_\_\_\_ lbs \_\_\_\_\_ hrs.  
Oil \_\_\_\_\_ bbls., 1st 24 hrs.  
Fresh water \_\_\_\_\_ feet \_\_\_\_\_ feet  
Salt water 1425 feet 1550 feet

Casing and Tubing	Used in Drilling	Left in Well	Packers
Size			
16			Kind of Packer
13			Size of
8 1/4	640'	None	Depth set
6 3/8		1365'	
5 3/16		1823'	Perf. top
3			Perf. bottom
2		3010'	Perf. top
Liners Used			Perf. bottom

CASING CEMENTED \_\_\_\_\_ SIZE \_\_\_\_\_ No. Ft. \_\_\_\_\_ Date \_\_\_\_\_  
COAL WAS ENCOUNTERED AT 493 FEET \_\_\_\_\_ INCHES  
591 FEET \_\_\_\_\_ INCHES FEET \_\_\_\_\_ INCHES  
FEET \_\_\_\_\_ INCHES FEET \_\_\_\_\_ INCHES

Formation	Color	Hard or Soft	Top	Bottom	Oil, Gas or Water	Depth Found	Remarks
Mapletown Coal			493	500			
Pittsburgh Coal			591	598			
Little Dunkard			968	990			
Big Dunkard			1090	1140			
1st Salt Sand			1400	1445	Water	1425'	
2nd Salt Sand			1485	1625	Water	1550'	
Little Lime			1800	1806			
Pencil Cave			1806	1810			
Big Lime			1810	1873			
Big Injun			1873	2055	Gas	1890-2008'	
Gants Sand			2115	2195			
50-Foot Sand			2450	2570			
30-Foot Sand			2590	2640			
Gordon Sand			2830	2860			
Fourth Sand			2885	2905			
Fifth Sand			2947	2980	Gas	2973'	
TOTAL DEPTH				3010'			

