

049-30330

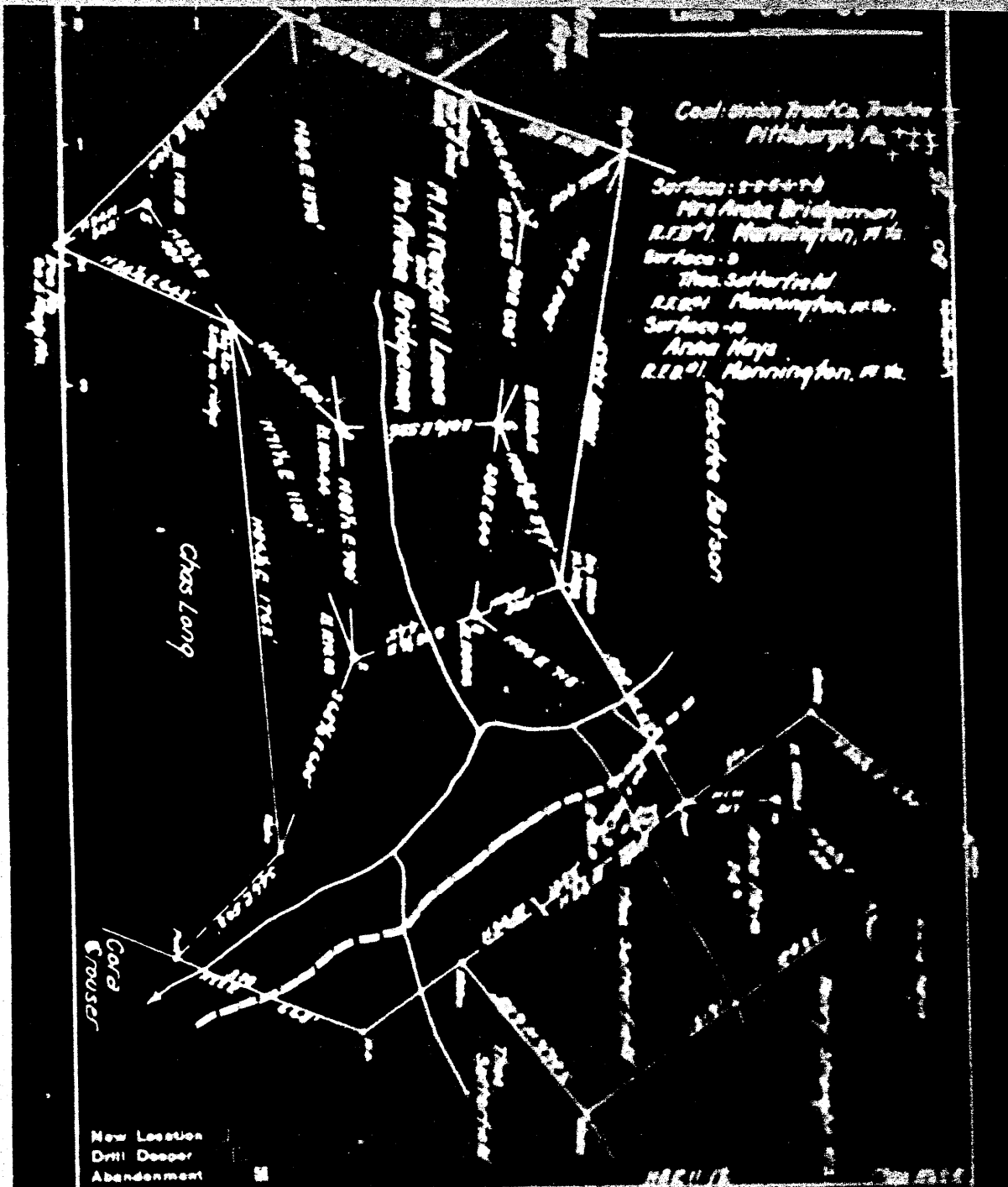

New Location  
Drill Deeper  
Abandonment

Company South Penn Natural Gas Co.  
 Address Parkersburg, W. Va.  
 Farm M. M. Kendall  
 Tract Acres 117 Lease No. 24815  
2-1-1-7-3-8-20

STATE OF WEST VIRGINIA  
 DEPARTMENT OF COMMERCE  
 OIL AND GAS DIVISION  
 CHARLESTON

WELL LOCATION MAP

LATITUDE 39 35



1.14S  
2.14W

LONGITUDE 80 22 30

7'5 OGIS topo location

7.5' loc \_\_\_\_\_ 15' loc \_\_\_\_\_  
(calc.) \_\_\_\_\_

Company \_\_\_\_\_

Farm M M KENDALL 9

Quad GLOVER GAP

County MARION

District MANNINGTON

WELL LOCATION MAP

File No. 30330



STATE OF WEST VIRGINIA  
DEPARTMENT OF MINES  
OIL AND GAS DIVISION

410

WELL RECORD

Ab  
Permit No. 370 A

Oil or Gas Well **Oil**  
(KIND)

Company **South Penn Natural Gas Company**  
 Address **Union Trust Bldg. Parkersburg, W. Va.**  
 Farm **M. M. Kendall** Acres **117**  
 Location (waters) **Denta Run**  
 Well No. **9** Elev. **1152.19'**  
 District **Mannington** County **Marion**  
 The surface of tract is owned in fee by **Thos. Satterfield**  
**R. F. D. No. 1** Address **Mannington, W. Va.**  
 Mineral rights are owned by **S. M. Kendall et al**  
**120 First St.** Address **Elkins, W. Va.**  
 Drilling commenced **Jan. 2, 1917**  
 Drilling completed **March 8, 1917**  
 Date shot **4-19-17-20 ft.** Depth of shot **---**  
 Open Flow **---** /10ths Water in **---** Inch  
**---** /10ths Merc. in **---** Inch  
 Volume **---** Cu. Ft.  
 Rock Pressure **---** lbs. **---** hrs.  
 Oil **15** bbls., 1st 24 hrs.  
 Fresh water **---** feet **---** feet  
 Salt water **---** feet **---** feet

Casing and Tubing	Used in Drilling	Left in Well	Packers
Size			Kind of Packer
16			---
13			---
10	<b>305' (Pulled)</b>		Size of
8 1/4	<b>1355' (Pulled)</b>		---
6 1/2	<b>2134'</b>		Depth set
5 3/16	<b>2475'</b>		---
3			Perf. top
2			Perf. bottom
Liners Used			Perf. top
			Perf. bottom
CASING CEMENTED	---	SIZE	No. Ft.
			Date
COAL WAS ENCOUNTERED AT <b>760</b> FEET <b>60</b> INCHES			
<b>872</b> FEET <b>108</b> INCHES			

Formation	Color	Hard or Soft	Top	Bottom	Oil, Gas or Water	Depth Found	Remarks
Bluff Sand			450	460			
Mapletown Coal			760	765			
Pittsburgh Coal			872	881			
Little Dunkard			1265	1308			
Big Dunkard			1345	1392			
Gas Sand			1525	1640			
1st Salt Sand			1645	1675			
2nd Salt Sand			1688	1756			
3rd Salt Sand			1774	1795			
4th Salt Sand			1850	1873			
Maxon Sand			1950	2040			
Little Line			2095	2100			
Pencil Cave			2100	2104			
Big Line			2104	2186			
Big Injun			2186	2341			
Fifty Foot Sand			2825	2835			
Thirty Foot Sand			2895				
					<b>Oil show</b>	<b>2895</b>	
					<b>Oil</b>	<b>2903</b>	
<b>Total Depth</b>				<b>2913</b>			

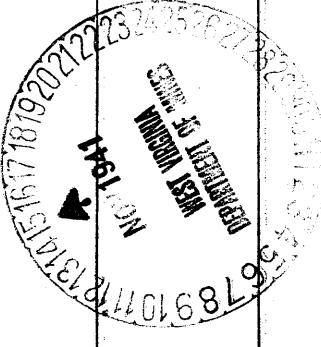



Mannington District, Marion County, W. Va.  
 By South Fern Natural Gas Co., Union Trust Bldg., Parkersburg, W. Va.  
 Abandoned under permit Mar-.....-A7

On 117 acres, on Dents Run.

Elevation, 1152.19' L.

Surface owned by Thos. Satterfield, R. F. D. No. 1, Mannington, W. Va.,  
 and minerals by S. H. Kendall et al., 120 First St., Martinsburg, W. Va.

Drilling commenced Jan. 2, 1917; completed, March 8, 1917.

Shot March 19, 1917, with 20 qts.; April 11, 1917, with 30 qts.;  
 and April 19, 1920, with 40 qts.

Oil, 15 bbls., 1st 24 hrs.

10" casing, 305' (pulled); 8", 1355' (pulled); 6", 2134';  
 5", 2475'.

Coal was encountered at 760-765 and 872-881'.

Oil well. Abandonment reported to Dept. of Mines Nov. 13, 1941.

Record to NCT from Mrs. Griffith Dec. 9, 1941. Old File No. 410.

	Top.	Bottom.
Mud? Sand	450	- 460
Mapletown (Sawickley) Coal	760	- 765
Pittsburgh Coal	872	- 881
Little Bankard Sand	1265	- 1308
Big Bankard Sand	1345	- 1392
Gas Sand	1525	- 1640
1st Salt Sand	1625	- 1675
2nd Salt Sand	1685	- 1756
3rd Salt Sand	1774	- 1795
4th Salt Sand	1850	- 1873
Maxton Sand	1950	- 2040
Little Line	2095	- 2100
Pencil Cove	2100	- 2104
Big Line	2104	- 2186
Big Injun Sand	2186	- 2341
Fifty-foot Sand	2325	- 2835
Thirty-foot Sand (oil show, 2895'; oil, 2903')	2895	- ....
Total depth		2913