

049-30325

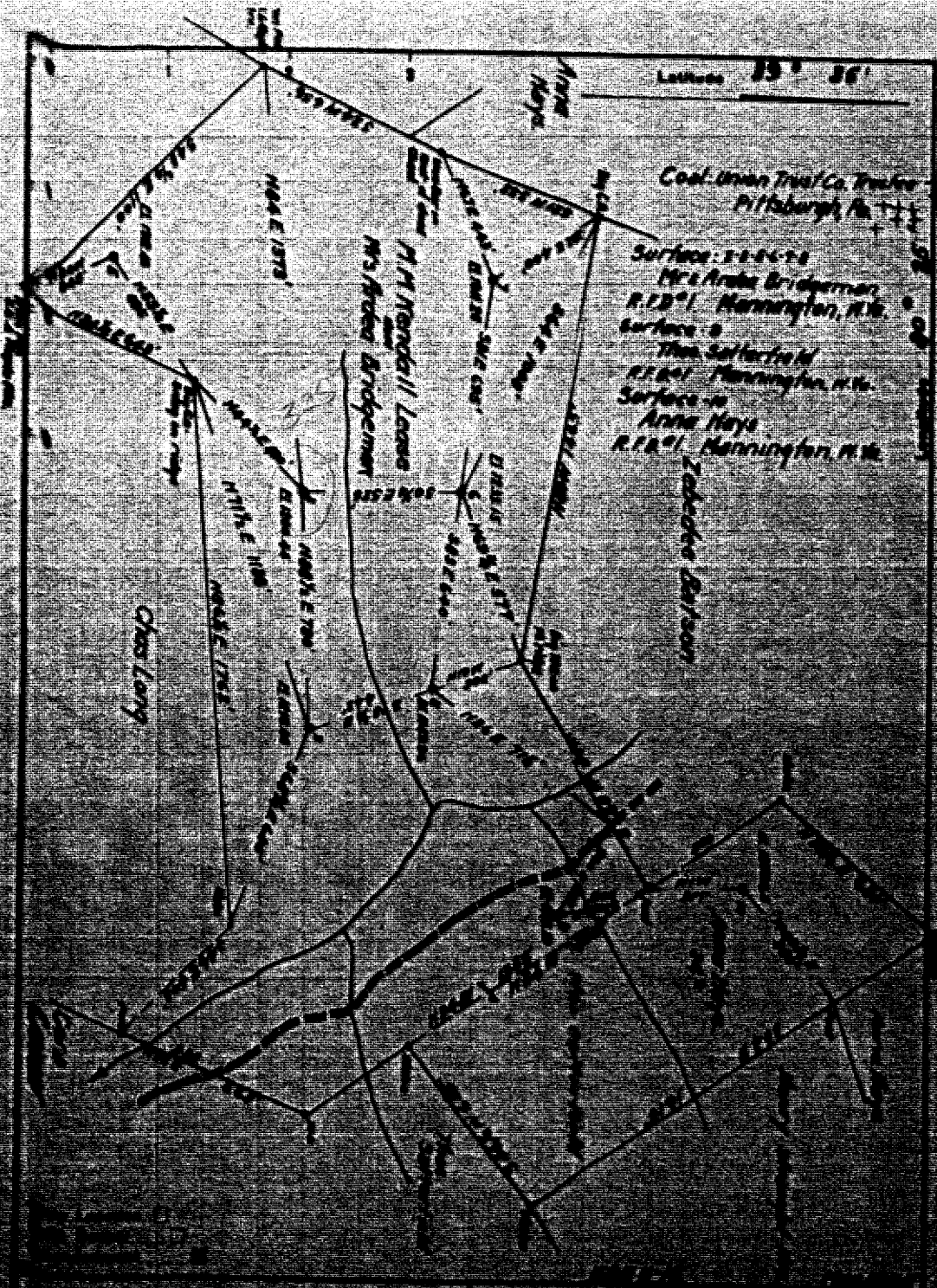

Coal Union Trunk Co.
Pittsburgh, Pa.

LATITUDE 39 35

LONGITUDE 80 25



1.35
m
16w

7'5 OGIS topo location

7.5' loc _____ 15' loc _____
(calc.) _____

Company _____

Farm MM KENDALL 3

Quad GLOVER GAP

County MARION

District MANNINGTON

WELL LOCATION MAP

File No. 30325

STATE OF WEST VIRGINIA
DEPARTMENT OF MINES
OIL AND GAS DIVISION

405

WELL RECORD

AP 325A
Permit No.

Oil or Gas Well..... **OIL**
(KIND)

Company..... South Penn Natural Gas Company,	Casing and Tubing	Used in Drilling	Left in Well	Packers
Address..... Union Trust Bldg. Parkersburg, W. Va.	Size			
Farm..... M. M. Kendall Acres..... 117	16			Kind of Packer..... -
Location (waters)..... Dents Run	13			Size of..... -
Well No..... 3 Elev..... 1250.44'	10	340' (Pulled)		Depth set..... -
District..... Mannington County..... Marion	8 1/4	1470'		Perf. top..... -
The surface of tract is owned in fee by..... Mrs. Ardea Bridgeman	6%	2230'		Perf. bottom..... -
R.F.D. No. 1. Address..... Mannington, W. Va.	5 3/16			Perf. top..... -
Mineral rights are owned by..... S.M. Kendall et al	3			Perf. bottom..... -
120 First St. Address..... Elkins, W. Va.	2			Perf. top..... -
Drilling commenced..... June 1, 1916	Liners Used.....			Perf. bottom..... -
Drilling completed..... July 17, 1916	Cond.	14'		
Date shot..... 10-22-19-20qt Depth of shot..... B. Injun				
Open Flow /10ths Water in..... -- Inch				
/10ths Merc. in..... -- Inch				
Volume..... -- Cu. Ft.	CASING CEMENTED..... -	SIZE..... -	No. Ft..... -	Date..... -
Rock Pressure..... -- lbs..... -- hrs.				
Oil..... 50 bbls., 1st 24 hrs.	COAL WAS ENCOUNTERED AT..... 880 FEET..... 80 INCHES			
Fresh water..... -- feet..... -- feet	980 FEET..... 84 INCHES..... FEET..... INCHES			
Salt water..... 1745 feet..... 1900 feet	- FEET..... INCHES..... FEET..... INCHES			

Formation	Color	Hard or Soft	Top	Bottom	Oil, Gas or Water	Depth Found	Remarks
Bluff Sand			570	615			
Mapletown Coal			880	885			
Pittsburgh Coal			980	987			
Little Dunkard			1380	1415			
Big Dunkard			1450	1545			
Gas Sand			1630	1720			
1st Salt Sand			1730	1850	Water	1745	
2nd Salt Sand			1860	1925	Water	1900	
Sand			1965	2015			
Little Line			2145	2204			
Pencil Cave			2204	2208			
Big Line			2208	2292			
Big Injun			2292		Oil Water	2360-2374 2374	
Total Depth				2378			

Formation	Color	Hard or Soft	Top	Bottom	Oil, Gas or Water	Depth Found	Remarks

Date **Nov. 13, 1941.** , 194...

APPROVED **SOUTH PENN NATURAL GAS COMPANY**, Owner

By *Elton Elbaum* Land Agent
(Title)

Hamington District, Marion County, W. Va.
 By South Penn Natural Gas Co., Union Trust Bldg., Parkersburg, W. Va.
 Abandoned under permit Mar-----A7
 On 117 acres, on Dents Run.
 Elevation, 1250.14' L.
 Surface owned by Mrs. Arden Bridgman, P. O. No. 1, Hamington,
 W. Va., and minerals by H. H. Kendall et al., 120 First St.,
 Elkins, W. Va.
 Drilling commenced June 1, 1916; completed, July 17, 1916.
 Shot Oct. 22, 1919, with 20 qts., in Big Injun Sand.
 Oil, 50 bbls., 1st 24 hrs.
 Salt water at 1745 and 1900'.
 10" casing, 340' (pulled); 8", 1470'; 6", 2230'; conductor, 14'.
 Coal was encountered at 530-535 and 960-967'.
 Oil well. Abandonment reported to Dept. of Mines Nov. 13, 1941.
 Record to NCF from Mrs. Griffith Dec. 9, 1941. Old File No. 405.

	Top.	Bottom.
Bluff Sand	670	- 615
Appleton (Devickley) Coal	630	- 535
Pittsburgh Coal	530	- 987
Little Bunkard Sand	1325	- 1415
Big Bunkard Sand	1450	- 1545
Gas Sand	1630	- 1720
1st Salt Sand (water, 1745')	1730	- 1650
2nd Salt Sand (water, 1900')	1860	- 1925
Sand	1965	- 2015
Little Line	2045	- 2204
Pencil Cave	2204	- 2208
Big Line	2208	- 2292
Big Injun Sand (oil, 2360-2374'; water, 2374')	2292	-
Total depth		2378