

LATITUDE 39 35

LONGITUDE 80 27 30



1.515
.83w

7'5 OGIS topo location

7.5' loc _____

15' loc _____
(calc.) _____

Company _____ 359 _____

Farm J W KENDALL

Quad GLOVER GAP

County MARION

District MANNINGTON

WELL LOCATION MAP

File No. 30118

Plot of WELLS NO 359 & 360

HOPE CONSTRUCTION & REFINING CO.

J. W. KENDALL

MANNINGTON

District

MARION

of the

Clarkburg, W. Va. on the

Farm consisting of 158 Acres

County, W. Va.

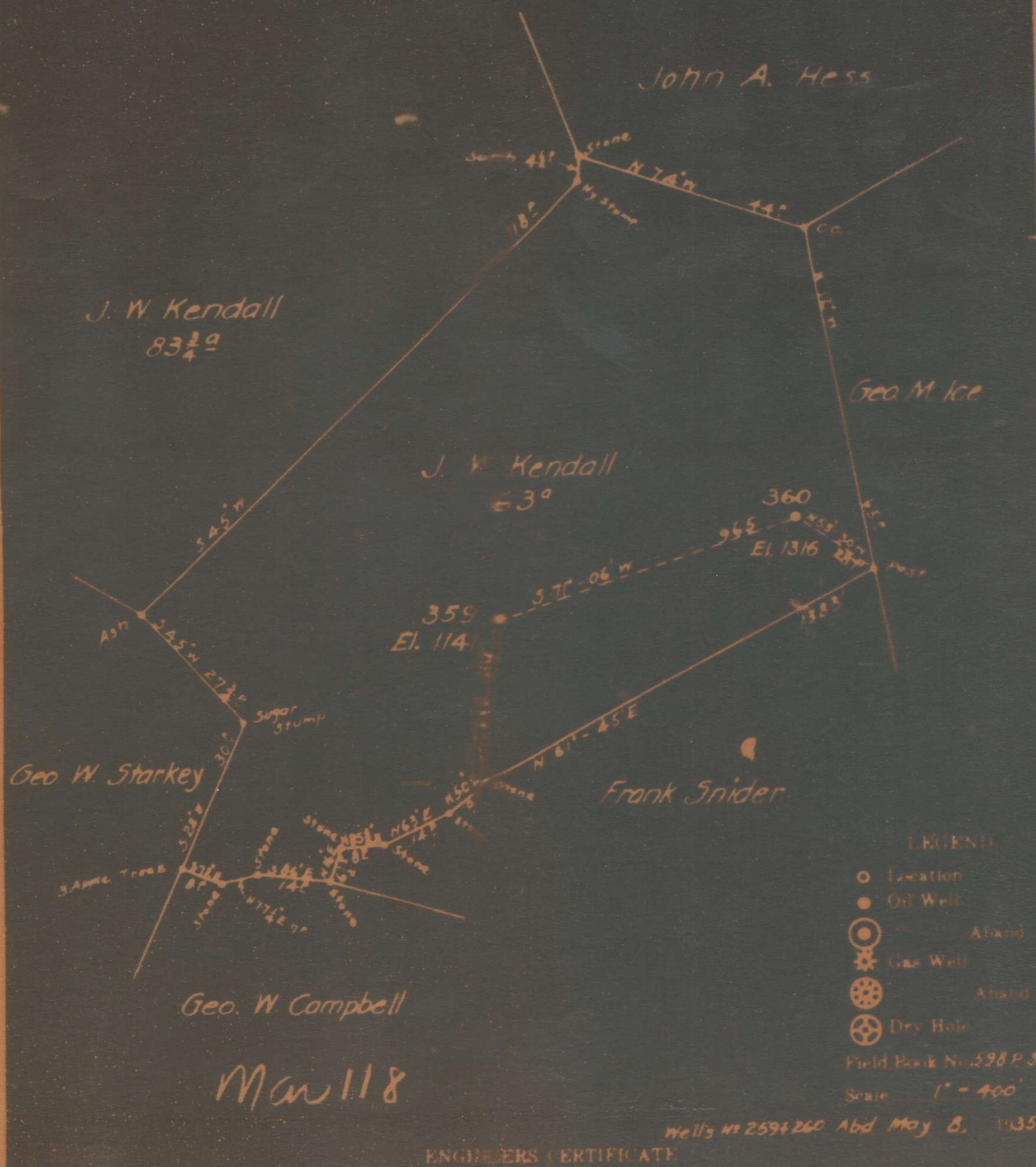

Mannington District, Marion County, W. Va.

By Hope Construction & Refining Co., 445 W. Main St.,
Clarksburg, W. Va.

On 158 acres, surface owned by J. B. Lazear, Mannington, W. Va.;
coal owner, unknown.

Elevation, 1141' L.

8 1/2" casing, 1934'; 6-5/8", 2203'; 2" tubing, 2331'.

Coal was encountered at 860-865 and 955-960'.

Abandonment reported to Dept. of Mines June 28, 1935.

Well was shot at 2308'.

Water not recorded.

Oil well.

	Top.	Bottom.	Thickness.
Native coal	860	- 865	5
Pittsburgh Coal	955	- 960	5
Little Dunkard Sand	1320	- 1345	25
Big Dunkard Sand	1440	- 1484	44
Gas Sand	1600	- 1640	40
Salt Sand	1900	- 1970	70
Maxton Sand	2095	- 2156	61
Big Lime	2160	- 2226	66
Big Injun Sand (oil, 2308')	2226		
Total depth			2331

MAR-118-A