

I, the undersigned, hereby certify that this plat is correct to the best of my knowledge and belief and shows all the information required by law and the regulations issued and prescribed by the Department of Environmental Protection.

Ben R. Singleton

P.S. 2092



FILE NO: 113-21
 DRAWING NO: Radcliff 14H
 SCALE: 1" = 2000'
 MINIMUM DEGREE OF ACCURACY: 1:2500
 PROVEN SOURCE OF ELEVATION: NGS CORS Station

STATE OF WEST VIRGINIA
 DEPARTMENT OF ENVIRONMENTAL PROTECTION
 OIL AND GAS DIVISION

DATE: July 17 20 23
 OPERATOR'S WELL NO.: Radcliff 14H
 API WELL NO
 47 - 049 - 02513
 STATE COUNTY PERMIT

WELL TYPE: OIL GAS LIQUID INJECTION WASTE DISPOSAL
 (IF GAS) PRODUCTION: STORAGE DEEP SHALLOW

LOCATION: ELEVATION: 1493' WATERSHED: Bartholomew Fork QUADRANGLE: Glover Gap
 DISTRICT: Mannington COUNTY: Marion

SURFACE OWNER: Jackie D. & Sheila L. Radcliff ACREAGE: 46.08
 ROYALTY OWNER: Rebecca R. Shuttlesworth, et al. LEASE NO: 109790001 ACREAGE: 1090

PROPOSED WORK: DRILL CONVERT DRILL DEEPER FRACTURE OR STIMULATE PLUG OFF OLD FORMATION
 PERFORATE NEW FORMATION OTHER PHYSICAL CHANGE IN WELL (SPECIFY)
 PLUG AND ABANDON CLEAN OUT AND REPLUG TARGET FORMATION: Marcellus ESTIMATED DEPTH: 7916'

WELL OPERATOR: EQT Production Company DESIGNATED AGENT: Joseph C. Mallow
 ADDRESS: 400 Woodcliff Drive ADDRESS: 427 Midstate Drive
 Canonsburg, PA 15317 Clarksburg, WV 26301

09/15/2023

Radcliff 14H
Radcliff
EQT Production Company

Tract I.D.	Tax Map No.	Parcel No.	County	District	Surface Tract Owner	Acres
1	40	10.1	Marion	Mannington	Jackie D. & Sheila L. Radcliff	48.06
2	40	10	Marion	Mannington	Shelly L. Nelson	43.05
3	40	3	Marion	Mannington	Jason G. & Heather R. Stout	99.75
4	40	2	Marion	Mannington	Lula B. Knight	56.32
5	40	11	Marion	Mannington	Clarence W. Sweeney	63
6	40	12	Marion	Mannington	Jackie D. & Sheila L. Radcliff	27.35
7	40	13	Marion	Mannington	Shelly L. Nelson	29.75
11	39	4	Marion	Mannington	Coastal Forest Resources Company	245.722
24	40	2.1	Marion	Mannington	Jason G. & Heather R. Stout	29.58
25	39	3	Marion	Mannington	Thomas G. & Theresa A. Jones	10.25
26	39	5	Marion	Mannington	Thomas G. & Theresa A. Jones	61.85
85	26	16	Marion	Mannington	Jason G. & Heather R. Stout	48.12
86	39	2	Marion	Mannington	Lula B. Knight	43.29
94	40	9	Marion	Mannington	Karl A. Gouzd	35.32
95	40	4	Marion	Mannington	EBN-EM LLC	20.8
96	NA	NA	Marion	Mannington	Tax info Not Available	NA
97	26	13	Marion	Mannington	Jason G. & Michelle R. Stout	95.9
98	39	15	Marion	Mannington	Jason G. & Michelle R. Stout	7.5
99	26	17	Marion	Mannington	Jason G. & Michelle R. Stout	57
100	39	16	Marion	Mannington	Jason G. & Michelle R. Stout	7.351
101	39	7	Marion	Mannington	Dennis Markel & John Pheasant	84
120	26	12	Marion	Mannington	EBN-EM LLC	152.25
121	26	17	Marion	Mannington	Jason G. & Michelle R. Stout	57
122	39	1	Marion	Mannington	Albert C. Woods Heins	90.6

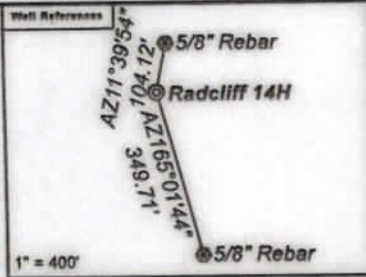

Notes:
 Radcliff 14H coordinates are
 NAD 83 N: 397,624.10 E: 1,704,139.36
 NAD 83 Lat: 39.587899 Long: -80.438054
 NAD 83 UTM N: 4,382,170.48 E: 548,254.80
 Radcliff 14H Landing Point coordinates are
 NAD 83 N: 397,044.28 E: 1,705,822.88
 NAD 83 Lat: 39.586355 Long: -80.432059
 NAD 83 UTM N: 4,382,002.39 E: 548,770.68
 Radcliff 14H Bottom Hole coordinates are
 NAD 83 N: 394,355.57 E: 1,707,076.78
 NAD 83 Lat: 39.579010 Long: -80.427512
 NAD 83 UTM N: 4,381,189.62 E: 549,166.34
 West Virginia Coordinate system of 1927 (North Zone)
 based upon Differential GPS Measurements.
 Plat orientation, corner and well ties are based upon
 the grid north meridian.
 Well location references are based upon the grid north
 meridian.
 UTM coordinates are NAD83, Zone 17, Meters.

- Radcliff**
- Radcliff 18H
 - Radcliff 16H
 - Radcliff 14H
 - Radcliff 12H
 - Radcliff 10H
 - Radcliff 8H
 - Radcliff 6H
 - Radcliff 4H

Lease No.	Owner	Acres
109790001	Rebecca R. Shuttlesworth, et al.	1090
174985003	Country Roads Minerals, LLC, et al.	59
133771000	Bounty Minerals LLC, et al.	72.75

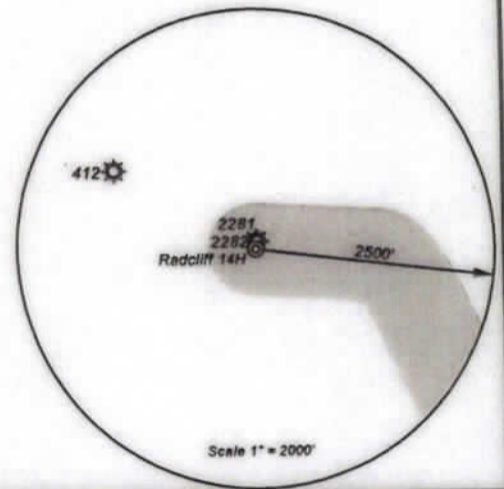

I, the undersigned, hereby certify that this plat is correct to the best of my knowledge and belief and shows all the information required by law and the regulations issued and prescribed by the Department of Environmental Protection.

Ben R. Singleton
 P.S. 2092



FILE NO: 113-21
 DRAWING NO: Radcliff 14H
 SCALE: 1" = 2000'
 MINIMUM DEGREE OF ACCURACY: 1:2500
 PROVEN SOURCE OF ELEVATION: NGS CORS Station



DATE: July 17 20 23
 OPERATOR'S WELL NO.: Radcliff 14H
 API WELL NO
 47 - 049 - 02513
 STATE COUNTY PERMIT

WELL TYPE: OIL GAS LIQUID INJECTION WASTE DISPOSAL
 (IF GAS) PRODUCTION: STORAGE DEEP SHALLOW
 LOCATION: ELEVATION: 1493' WATERSHED Bartholomew Fork QUADRANGLE: Glover Gap
 DISTRICT: Mannington COUNTY: Marion
 SURFACE OWNER: Jackie D. & Sheila L. Radcliff ACREAGE: 1090
 ROYALTY OWNER: Rebecca R. Shuttlesworth, et al. LEASE NO: 109790001 ACREAGE: 1090
 PROPOSED WORK: DRILL CONVERT DRILL DEEPER FRACTURE OR STIMULATE PLUG OFF OLD FORMATION
 PERFORATE NEW FORMATION OTHER PHYSICAL CHANGE IN WELL (SPECIFY)
 PLUG AND ABANDON CLEAN OUT AND REPLUG TARGET FORMATION: Marcellus ESTIMATED DEPTH: 7916'
 WELL OPERATOR: EQT Production Company DESIGNATED AGENT: Joseph C. Mallow
 ADDRESS: 400 Woodcliff Drive ADDRESS: 427 Midstate Drive
 Canonsburg, PA 15317 Clarksburg, WV 26301

08/15/2023