



1) Date: April 25, 19 83
 2) Operator's Well No. Consol (3805)
 3) API Well No. 47 049 0750-RED
 State County Permit

DRILLING CONTRACTOR:

N/A

STATE OF WEST VIRGINIA
DEPARTMENT OF MINES, OIL AND GAS DIVISION

OIL AND GAS WELL PERMIT APPLICATION

- 4) WELL TYPE: A Oil / Gas / Plugged
 B (If "Gas", Production / Underground storage / Deep / Shallow)
- 5) LOCATION: Elevation: 1064.0 Watershed: Sugar Run
 District: Paw Paw County: Marion Quadrangle: Mannington 7.5
- 6) WELL OPERATOR Consolidation Coal Co. 11) DESIGNATED AGENT Roger E. Duckworth
 Address P. O. Box 1314 Address P. O. Box 1314
Morgantown, WV 26507-1314 Morgantown, WV 26507-1314
- 7) OIL & GAS ROYALTY OWNER Unknown 12) COAL OPERATOR Consolidation Coal Co.
 Address _____ Address P. O. Box 1314
 _____ Morgantown, WV 26507-1314
 Acreage _____
- 8) SURFACE OWNER Consolidation Coal Co. 13) COAL OWNER(S) WITH DECLARATION ON RECORD:
 Address _____ Name Same
 _____ Address _____
 _____ Name _____
 Address _____
- 9) FIELD SALE (IF MADE) TO:
 Address _____
- 10) OIL & GAS INSPECTOR TO BE NOTIFIED
 Name William Blosser
 Address Colfax, WV
- 15) PROPOSED WORK: Drill / Drill deeper / Redrill / Fracture or stimulate
 Plug off old formation / Perforate new formation / Redrill to plug
 Other physical change in well (specify) _____
- 16) GEOLOGICAL TARGET FORMATION, _____
- 17) Estimated depth of completed well, _____ feet
- 18) Approximate water strata depths: Fresh, _____ feet; salt, _____ feet.
- 19) Approximate coal seam depths: 687 to 696 Is coal being mined in the area? Yes / No

20) CASING AND TUBING PROGRAM

CASING OR TUBING TYPE	SPECIFICATIONS					FOOTAGE INTERVALS		CEMENT FILL-UP OR SACKS (Cubic feet)	PACKERS
	Size	Grade	Weight per ft.	New	Used	For drilling	Left in well		
Conductor									Kinds
Fresh water									Sizes
Coal									Depths set
Intermediate		SEE EXHIBIT #1							Perforations:
Production									Top Bottom
Tubing									
Liners									

21) EXTRACTION RIGHTS

Check and provide one of the following:

- Included is the lease or leases or other continuing contract or contracts by which I hold the right to extract oil or gas.
 The requirement of Code 22-4-1-(c) (1) through (4). (See reverse side for specifics.)

22) ROYALTY PROVISIONS

Is the right to extract, produce or market the oil or gas based upon a lease or other continuing contract or contracts providing for flat well royalty or any similar provision for compensation to the owner of the oil or gas in place which is not inherently related to the volume of oil or gas so extracted, produced or marketed? Yes No

If the answer above is No, nothing additional is needed. If the answer is Yes, you may use Affidavit Form IV-60.

23) Required Copies (See reverse side.)

24) Copies of this Permit Application and the enclosed plat and reclamation plan have been mailed by registered mail or delivered by hand to the above named coal operator, coal owner(s), and coal lessee on or before the day of the mailing or delivery of this Permit Application to the Department of Mines at Charleston, West Virginia.

Notary: _____
 My Commission Expires _____

Signed: Roger E. Duckworth
 Its: Project Engineer

OFFICE USE ONLY
DRILLING PERMIT

Permit number 47-049-0750-RED. Date May 18 08/25/2023

This permit covering the well operator and well location shown below is evidence of permission granted to drill in accordance with the pertinent legal requirements subject to the conditions contained herein and on the reverse hereof. **Notification must be given to the District Oil and Gas Inspector. (Refer to No. 10) Prior to the construction of roads, locations and pits for any permitted work.** In addition, the well operator or his contractor shall notify the proper district oil and gas inspector 24 hours before actual permitted work has commenced.)

Permit expires January 18, 1984 unless drilling is commenced prior to that date and prosecuted with due diligence.

Bond:	Agent:	Plat:	Casing	Fee
		<u>OS</u>	<u>TS</u>	

[Signature]
 Administrator, Office of Oil and Gas

Line Item Explanation

- 1) Date of Application
- 2) Your well name and number
- 3) To be filled out by office of oil & gas
- 4A) "Oil" means natural crude oil or petroleum and other hydrocarbons, regardless of gravity, which are produced at the well in liquid form by ordinary production methods and which are not the result of condensation of gas after it leaves underground reservoirs: "Gas" means all natural gas and all other fluid hydrocarbons not defined as oil.
- 4B) "Shallow well" means any well drilled and completed in a formation above the top of the uppermost member of the "Onondaga Group" or a depth less than six thousand feet, whichever is shallower.
"Deep well" means any well drilled and completed in a formation at or below the top of the uppermost member of the "Onondaga Group" or at a depth less than six thousand feet, whatever is shallower.
- 5) Where well is located
- 6) Before a permit can be issued in a corporation, company partnership, or fictitious name, the name must be registered with the Secretary of State Office
- 7) Use separate sheet if necessary
- 8) Present surface owner at time application is filed.
- 9) Optional
- 11) See Reg. 7.01 relating to code §22-4-1k
- 12) "Coal Operator" means any persons, firm, partnership, partnership association or corporation that proposes to or does operate a coal mine. See Note 24
- 13 & 14) As per §22-4-20; See Note 24
- 15) Work that will be attempted—A separate Form IV-2 shall not be required for fracturing or stimulating a well where fracturing or stimulating is to be part of the work for which a permit is sought and is noted as such on the Form IV-2 filed in connection therewith.
- 16) Anticipated formation for which well will be completed
- 17) Self explanatory
- 18) Depth to deepest freshwater, and shallowest salt water, taken from nearby wells corrected for differences in elevation
- 19) All coal seam depths
- 20) Proposed casing program and cementing refer to Code 22-4-5, 22-4-6, 22-4-7, 22-4-8, 22-4-8a Reg 9.01, 15.01, 15.02, 15.03, 15.04, 25.01, 25.02, 25.03, 25.04
- 21) Code 22-4-11(c) - In lieu of filing the lease or leases or other continuing contract or contracts, the applicant for a permit described herein may file the following:
 - (1) A brief description of the tract of land including the district and county wherein the tract is located;
 - (2) The identification of all parties to all leases or other continuing contractual agreements by which the right to extract, produce or market the oil or gas is claimed;
 - (3) The book and page number wherein each such lease or contract by which the right to extract, produce or market the oil or gas is recorded;
 - (4) A brief description of the royalty provisions of each such lease or contract.
- 22) Code 22-4-11(d) and 22-4-11(e).
- 23) Regulation 7.02 of the Department of Mines provides that the original and four copies of Form IV-2 must be filed with the Department, accompanied by (i) a plat in the form prescribed by Regulation 11, (ii) a bond in one of the forms prescribed by Regulation 12, or in lieu thereof the other security allowed by Code §22-4-2, (iii) Form IV-9, "Reclamation Plan", applicable to the reclamation required by Code §22-4-12b and Regulation 23, (iv) unless previously paid on the same well, the fee required by Code §22-4-12a, and (v) if applicable, the consent required by Code §22-4-8a from the owner of any water well or dwelling within 200 feet of the proposed well.
- 24) **The above named coal operator, coal owner(s), and coal lessee are hereby notified that any objection they wish to make or are required to make by Code §22-4-3 must be filed with the Department of Mines within fifteen (15) days after the receipt of this Application by the Department.**

The following waiver must be completed by the coal operator and by any coal owner or coal lessee who has recorded a declaration under Code 22-4-20, if the permit is to be issued within fifteen (15) days of receipt thereof.

WAIVER

The undersigned coal operator X / owner _____ / lessee _____ of the coal under this well location has examined this proposed well location. If a mine map exists which covers the area of the well location, the well location has been added to the mine map. The undersigned has no objection to the work proposed to be done at this location, provided, the well operator has complied with all applicable requirements of the West Virginia Code and the governing regulations.

08/25/2023

CONSOLIDATION COAL COMPANY

Date: _____, 19_____

By C. W. Mc Donnell
Its Senior Vice President - Mining

IV-9
(Rev 8-81)

MAY 13 1983



DATE MAY 11, 1983

WELL NO. CONSOL 3805

API NO. 47-049-0750-R-P

OIL & GAS DIVISION State of West Virginia
DEPT. OF MINES Department of Mines
Oil and Gas Division

CONSTRUCTION AND RECLAMATION PLAN

COMPANY NAME Consolidation Coal Co.
Address P. O. Box 1314, Morgantown, WV
Telephone 296-3461

DESIGNATED AGENT Roger E. Duckworth
Address P. O. Box 1314, Morgantown, WV
Telephone 296-3461 26507-1314

LANDOWNER Consolidation Coal Company
Revegetation to be carried out by Consol (Agent)

SOIL CONS. DISTRICT _____

This plan has been reviewed by Monongahela SCD. All corrections
and additions become a part of this plan: 5/11/83 (Date)

Howard Clark
(SCD Agent)

ACCESS ROAD	LOCATION
* <u>EXISTING</u> Structure <u>Culverts</u> (A)	Structure <u>Diversion Ditches</u> (1)
Spacing _____	Material <u>Earthen</u>
Page Ref. Manual <u>I-8</u>	Page Ref. Manual <u>I-11</u>
Structure <u>Drainage Ditch</u> (B)	Structure <u>Rip Rap</u> (2)
Spacing _____	Material <u>Rock</u>
Page Ref. Manual <u>I-11</u>	Page Ref. Manual <u>N/A</u>
Structure _____ (C)	Structure _____ (3)
Spacing _____	Material _____
Page Ref. Manual _____	Page Ref. Manual _____

All structures should be inspected regularly and repaired if necessary. All commercial timber is to be cut and stacked and all brush and small timber to be cut and removed from the site before dirt work begins.

AREA Will be Reclaimed to ORIGINAL conditions
REVEGETATION PRIOR to Plugging

Treatment Area I

Lime _____ Tons/acre
or correct to pH _____

Fertilizer _____ lbs/acre
(10-20-20 or equivalent)

Mulch _____ Tons/acre

Seed* _____ lbs/acre
_____ lbs/acre
_____ lbs/acre

Treatment Area II

Lime _____ Tons/acre
or correct to pH _____

Fertilizer _____ lbs/acre
(10-20-20 or equivalent)

Mulch _____ Tons/acre

Seed* _____ lbs/acre
_____ lbs/acre
_____ lbs/acre

*Inoculate all legumes such as vetch, trefoil and clovers with the proper bacterium. Inoculate with 3X recommended amount.

PLAN PREPARED BY Roger E. Duckworth
ADDRESS P. O. Box 08125/2023
Morgantown, WV 26507-1314
PHONE NO. 296-3461 Ext. 232

NOTES: Please request landowner's cooperation to protect new seedling for one growing season. Attach separate sheets as necessary for comments.

049-0750-R-P

MANNINGTON QUADRANGLE
WEST VIRGINIA
7.5 MINUTE SERIES (TOPOGRAPHIC)
SE/4 MANNINGTON 15' QUADRANGLE

4963 II NW
BLACKSVIL

59 17'30" 60 1 780 000 FEET 61 HUNDRED 15 MI. WADESTOWN (W. VA. 7) 6.1 MI. 62 63 80° 15' 39° 37' 30"

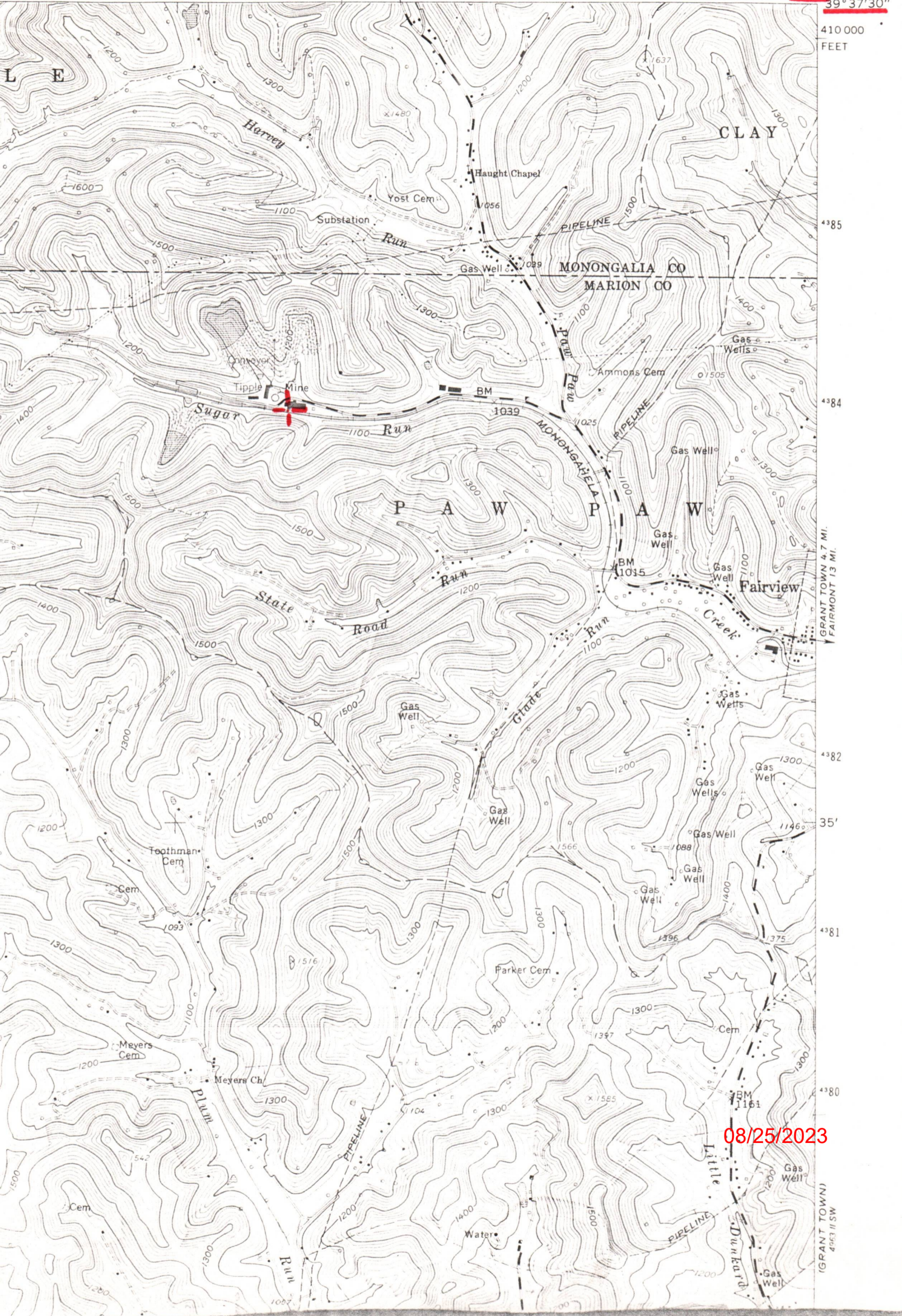

08/25/2023

GRANT TOWN
4963 II SW

Permit No. U-78-83
S.M.A. No. 791

STATE OF WEST VIRGINIA
Department of Natural Resources
DIVISION OF RECLAMATION
Charleston, West Virginia 25305

Effective Date April 18, 1983
Expiration Date April 18, 1988



THINK RECLAMATION

THINK RECLAMATION

SURFACE MINING Permit To Engage In Surface Mining

Issued to

Name of Applicant or Company CONSOLIDATION COAL COMPANY

County Marion/Monongalia Magisterial District Paw Paw/Mannington/Battelle

Nearest Post Office Metz/Fairview/Mannington/ Limited to 390.0 Acres

Pursuant to Article 6, Chapter 20 of the Code of West Virginia, a Permit is hereby granted to the above named principal to engage in surface mining in the State of West Virginia. As a condition of this permit, all surface coal mining and reclamation operations shall be conducted as described in and in compliance with the complete application and only on those lands specifically designated on the map(s) submitted. All operations shall be conducted to prevent significant imminent environmental harm to the health or safety of the public. The permittee shall, as soon as possible after learning of such condition or of noncompliance with any term or condition of the permit, warn any person whose health and safety is in imminent danger and the Permittee shall immediately commence implementation of measures necessary to comply and shall also accelerate or provide the additional monitoring necessary to determine the nature and extent of such noncompliance. The following are special terms and conditions of this permit: _____

A copy of this permit shall be kept at the site of the operation at all times.

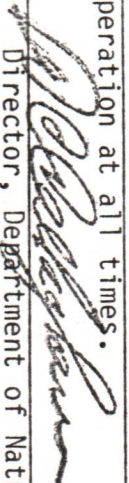
Director, Department of Natural Resources

CONSOLIDATION COAL COMPANY

NORTHERN WEST VIRGINIA REGION
VISTA DEL-RIO
POST OFFICE BOX 1314
MORGANTOWN, WEST VIRGINIA 26505

April 26, 1983



RECEIVED

MAY 5 - 1983

OIL & GAS DIVISION
DEPT. OF MINES

Ted Streit
WV Department of Mines
Oil & Gas Division
1613 Washington Street, East
Charleston, West Virginia 25303

RE: MAR-652, OI No. 132,
Edgar Fox No. 1

Dear Mr. Streit:

Consolidation Coal Company plans to replug, in order to mine through, the old Edgar Fox No. 1 well. This plugged well is located on Consol property near Fairview, WV. The well was plugged by Victor E. Tennant and A. P. Hought on the 17th day of November, 1949, under West Virginia permit No. MAR-652.

Included with new permit application are the following:

- Plat, as filed in 1949.
- Affidavit, as filed in 1949.
- Notice to plug and abandon well (new).
- Exhibit No. 1 (new).
- Oil and gas well permit application (new).
- Topographic map.
- Mine map.
- Construction and reclamation plan.

If you have any questions regarding this well, please call 296-3461, ext. 232.

Sincerely,

A handwritten signature in blue ink that reads "Roger Duckworth". The signature is written in a cursive, flowing style.

Roger E. Duckworth
Project Engineer

RED/ela
Enclosures

08/25/2023



STATE OF WEST VIRGINIA
DEPARTMENT OF MINES
OIL AND GAS DIVISION

WELL RECORD

Permit No. Mar-750

Oil or Gas Well Gas
(KIND)

Company OWENS, ILLINOIS GLASS CO., GAS DEPARTMENT

Address P. O. Box 4158, Charleston 4, W. Va.

Farm Edgar Fox Acres 100

Location (waters) Sugar Run

Well No. OI #132, farm #1 Elev. _____

District Paw Paw County Marion

The surface of tract is owned in fee by _____

Coal _____ Address _____
Mineral rights are owned by Jamison Coal & Coke Co.

Address Fairmont, W. Va.

Drilling commenced 5-27-29

Drilling completed 7-15-29

Date Shot _____ From _____ To _____

With _____

Open Flow _____ /10ths Water in _____ Inch

_____ /10ths Merc. in _____ Inch

Volume 890 M Cu. Ft.

Rock Pressure 580 lbs. 24 hrs.

Oil _____ bbls., 1st 24 hrs.

Fresh water _____ feet _____ feet

Salt water _____ feet _____ feet

Casing and Tubing	Used in Drilling	Left in Well	Packers
Size			Kind of Packer
16			
13	161'	0	Anchor
10	717'	717'	Size of
8 3/4	1718'	1718'	6-5/8" x 8-1/4"
6 5/8	2002'	2002'	Depth set
5 3/16			1949'
3	2012'	2012'	Perf. top
2			Perf. bottom
Liners Used			Perf. top
			Perf. bottom

CASING CEMENTED _____ SIZE _____ No. Ft. _____ Date _____

COAL WAS ENCOUNTERED AT _____ FEET _____ INCHES

_____ FEET _____ INCHES _____ FEET _____ INCHES

_____ FEET _____ INCHES _____ FEET _____ INCHES

Formation	Color	Hard or Soft	Top	Bottom	Oil, Gas or Water	Depth Found	Remarks
Clay	Yellow	Soft	0	10			
Stone	Blue	Hard	10	20	Water	18'	Hole full
Lime	Gray	Hard	20	35			
Shale	Brown	Soft	35	47			
Red Rock	Red	Hard	47	65			
Lime	White	Medium	65	125			
Lime	Gray	Hard	125	140			
Coal	Black	Soft	140	144			
Slate	Brown	Soft	144	152			
Lime	Gray	Hard	152	160			
Slate	White	Soft	160	180			
Lime	White	Hard	180	220			
Lime	Black	Soft	220	224			
Lime	White	Hard	224	245			
Sand	White	Hard	245	292			
Slate	Black	Soft	292	303			
Coal	Black	Soft	303	308			
Slate	Black	Soft	308	330			
Sand	White	Hard	330	363			
Lime	White	Hard	363	549			
Sand	White	Hard	549	594			
Mapletown Coal	Black	Soft	594	600			
Lime	Brown	Hard	600	621			
Lime	Dark	Hard	621	636			
Lime	White	Hard	636	686			
Slate	Black	Soft	686	687			
Pittsburgh Coal	Black	Soft	687	696			
Lime	White	Hard	696	717			
Lime	Dark	Hard	717	734			
Lime	White	Hard	734	800			
Sand	White	Hard	800	820			
Red Rock	Red	Soft	820	825			
Lime	White	Hard	825	875			
Red Rock	Red	Soft	875	890			
Lime	Gray	Hard	890	931			
Red Rock	Red	Soft	931	941			
Lime	Black	Hard	941	985			
Lime	White	Hard	985	1031			



Geologist

A. H. Smith (Title)

By

A. H. Smith

APPROVED OWENS-ILLINOIS GLASS CO., GAS DEPT., Owner

Date October 26, 1949

Formation	Color	Hard or Soft	Top	Bottom	Oil, Gas or Water	Depth Found	Remarks
Sand	White	Hard	1031	1066	Gas test	2000-2003	1,200 M
Lime	White	Hard	1066	1130	Gas test	2012	890 M
Lime	Black	Hard	1130	1217			
Sand	White	Hard	1217	1250			
Sand Shells	Gray	Hard	1250	1291			
Lime	White	Hard	1291	1323			
Black Shale	Black	Soft	1323	1328			
Lime Shells	Black	Hard	1328	1372			
Sand	Dark	Hard	1372	1445			
Slate	Black	Soft	1445	1467			
Sand	Black	Hard	1467	1480			
Slate	Black	Soft	1480	1505			
Slate & Shells	Black	--	1505	1524			
Slate	Black	Soft	1524	1539			
Sand Shells	Black	--	1539	1664			
Salt Sand	Dark	Hard	1664	1718			
Lime	Dark	Hard	1718	1750			
Slate & Lime	Dark	--	1750	1773			
Shells	Dark	--	1773	1788			
Lime	White	Hard	1788	1793			
Red Rock	Red	Soft	1793	1830			
Lime	Red	Hard	1830	1878			
Red Rock	Red	Soft	1878	1883			
Slate	Black	Soft	1883	1889			
Lime	White	Hard	1889	1906			
Lime Shells	Dark	Medium	1906	1922			
Lime	White	Hard	1922	1928			
Pencil Cave	Black	Soft	1928	1933			
Big Lime	White	Hard	1933	1948			
Big Lime	Dark	Hard	1948	1995			
Injun Sand	White	Hard	1995	2012			
Total Depth							

10/25/2023

STATE OF WEST VIRGINIA
DEPARTMENT OF MINES
OIL AND GAS WELLS DIVISION

INSPECTOR'S WELL REPORT

Permit No. _____

Oil or Gas Well _____
(KIND)

Company _____ Address _____ Farm _____ Well No. _____ District _____ County _____ Drilling commenced _____ Drilling completed _____ Total depth _____ Date shot _____ Depth of shot _____ Initial open flow _____ /10ths Water in _____ Inch Open flow after tubing _____ /10ths Merc. in _____ Inch Volume _____ Cu. Ft. Rock pressure _____ lbs. _____ hrs. Oil _____ bbls., 1st 24 hrs. Fresh water _____ feet _____ feet Salt water _____ feet _____ feet	CASING AND TUBING	USED IN DRILLING	LEFT IN WELL	PACKERS
	Size			
	16			Kind of Packer _____
	13			
	10			Size of _____
	8 1/4			
	6 5/8			Depth set _____
	5 3/16			
	3			Perf. top _____
	2			Perf. bottom _____
	Liners Used _____			Perf. top _____
				Perf. bottom _____

CASING CEMENTED _____ SIZE _____ No. FT. _____ Date _____

NAME OF SERVICE COMPANY _____

COAL WAS ENCOUNTERED AT _____ FEET _____ INCHES

_____ FEET _____ INCHES FEET _____ INCHES

_____ FEET _____ INCHES FEET _____ INCHES

Drillers' Names _____

Remarks: _____

DATE

08/25/2023

DISTRICT WELL INSPECTOR

STATE OF WEST VIRGINIA
DEPARTMENT OF MINES
OIL AND GAS WELLS DIVISION

INSPECTOR'S WELL REPORT

Permit No. _____

Oil or Gas Well _____
(KIND)

	CASING AND TUBING	USED IN DRILLING	LEFT IN WELL	PACKERS
Company _____	Size			Kind of Packer _____
Address _____	16			
Farm _____	13			Size of _____
Well No. _____	10			
District _____ County _____	8 1/4			Depth set _____
Drilling commenced _____	6 5/8			
Drilling completed _____ Total depth _____	5 3/16			Perf. top _____
Date shot _____ Depth of shot _____	3			
Initial open flow _____ /10ths Water in _____ Inch	2			Perf. bottom _____
Open flow after tubing _____ /10ths Merc. in _____ Inch	Liners Used			Perf. top _____
Volume _____ Cu. Ft.				Perf. bottom _____
Rock pressure _____ lbs. _____ hrs.	CASING CEMENTED _____ SIZE _____ No. FT. _____ Date _____			
Oil _____ bbls., 1st 24 hrs.	NAME OF SERVICE COMPANY _____			
Fresh water _____ feet _____ feet	COAL WAS ENCOUNTERED AT _____ FEET _____ INCHES			
Salt water _____ feet _____ feet	_____ FEET _____ INCHES _____ FEET _____ INCHES			
	_____ FEET _____ INCHES _____ FEET _____ INCHES			

Drillers' Names _____

Remarks: _____

DATE _____

DISTRICT WELLS INSPECTOR
08/25/2023

EXHIBIT NO. 1

Plugging Technique To Be Utilized When A Previously
Abandoned Well Cannot Be Cleaned Out To Its Total Depth

Since the inception of Consolidation Coal Company's well plugging program, a total of 100 previously abandoned oil and gas wells have been effectively plugged and a total of 42 wells have been successfully mined through.

Using the experience and technology gained from these successful operations, Consol proposes an alternate, safer method of plugging abandoned oil and gas wells.

The method proposed will enhance present day mining through safety standards by:

1. Allowing for more sealing material (expanding cement) in critical areas within the wellbore below the coal bed of interest.
2. Allowing for a positive indication of the environment within the wellbore across the coal seam.
3. Allowing for the use of the existing wellbore for other mine usages, i.e. methane drainage, power holes, etc.
4. Using a cleanout technique which lends itself more readily to rotary operations which are inherently safer than cable tool operations.



Therefore, it is felt that the proposed technique as set forth below will provide an alternate method of plugging abandoned wells, which is as safe or safer than today's method.

1. A diligent effort shall be made to clean the wellbore to total depth. If this depth cannot be reached, the wellbore will be cleaned out below the first possible hydrocarbon producing zone ① and/or no less than 300' below the lowest mineable coal seam.
2. A 4½" vent pipe (or larger) shall be run into the wellbore to a depth 100 feet below the lowest mineable coal seam. This coal protection string of casing shall be cemented by circulation with expandable cement from the bottom of the casing to the surface using standard cementing practices. ③
3. An expandable cement plug ② will be set in the wellbore adhering to the following specifications:
 - a) The wellbore shall be filled with fluid from a point 300 feet below the lowest mineable coal seam to the surface, such that an over balanced condition will exist in the wellbore.

08/25/2023

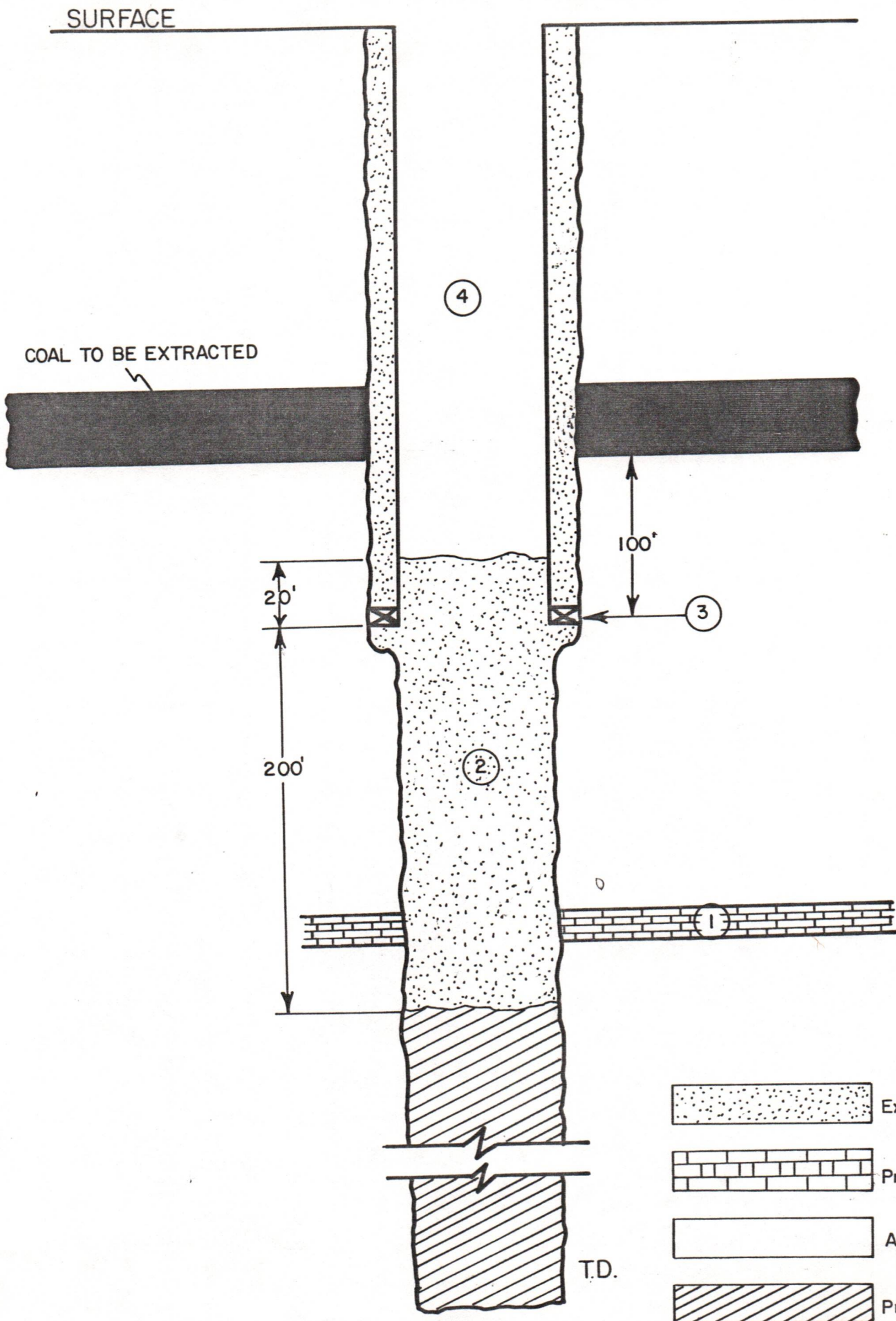
- b) While maintaining this over balanced condition in the wellbore, an expandable cement plug shall be set through tubing by the "balanced plug" method. The bottom of said cement plug shall be no less than 300 feet below the lowest mineable coal seam and shall extend 20 feet (80 feet below the coalbed of interest) into the 4½" casing.
 - c) After the cement has had adequate time to harden, the plug shall be tagged to verify the exact final location and condition of the plug.
4. In order to determine the effectiveness of the sealing project, all fluid shall be evacuated (4) from the wellbore. A vent shall then be installed on top of the casing in such a manner that will prevent liquids and solids from entering the well, but will permit ready access to the full internal diameter of the coal protection string when required.
 5. Prior to commencement of "mining through" operation, Consol shall sample the atmosphere across the coal seam for methane. This sample will prove the effectiveness and condition of the sealing process.

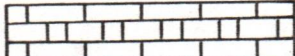
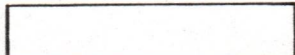

-  Expanding Cement
-  Producing Zone
-  Atmosphere
-  Previous Plug

08/25/2023

STATE OF WEST VIRGINIA
DEPARTMENT OF MINES
OIL AND GAS DIVISION

AFFIDAVIT OF PLUGGING AND FILLING WELL

AFFIDAVIT SHOULD BE MADE IN TRIPPLICATE, ONE COPY MAILED TO THE DEPARTMENT, ONE COPY TO BE RETAINED BY THE WELL OPERATOR AND THE THIRD COPY (AND EXTRA COPIES IF REQUIRED) SHOULD BE MAILED TO EACH COAL OPERATOR AT THEIR RESPECTIVE ADDRESSES.

The Charleston National Bank, Trustee
COAL OPERATOR OR OWNER
c/o Bernard G. Sampson
ADDRESS
Box 368, Fairmont, West Virginia
COAL OPERATOR OR OWNER
ADDRESS
LEASE OR PROPERTY OWNER
ADDRESS

The Charleston National Bank, Trustee
COAL OPERATOR OR OWNER
c/o Mr. Bernard G. Sampson
Box 368, Fairmont, W. Va.
COMPLETE ADDRESS
December 1, 19 49
WELL AND LOCATION
Paw Paw District
Marion County
Well No. 1
Edgar E. Fox Farm

STATE INSPECTOR SUPERVISING PLUGGING Oliver W. Lineberg

AFFIDAVIT

STATE OF WEST VIRGINIA,
County of MARION

SS:

Victor E. Tennant and A. P. Haught

OIL & GAS DIVISION
DEPT. OF MINE

RECEIVED
MAY 5 - 1983

being first duly sworn according to law depose and say that they are experienced in the work of plugging and filling oil and gas wells and were employed by The Chas. Nat'l Bk., Trustee, well operator, and participated in the work of plugging and filling the above well, that said work was commenced on the 7th day of November, 19 49, and that the well was plugged and filled in the following manner:

SAND OR ZONE RECORD FORMATION	FILLING MATERIAL			PLUGS USED SIZE & KIND	CASING	
	CONTENT	FROM	TO		CSG PULLED	CSG LEFT IN
				3" tubing	2012	
				6-5/8" casing	1967'	
	Clay	2012	1975	8-1/4" casing	1420'	
	Rock & Cement	1975	1965			
	Clay	1965	1730'			
	Rock & Cement	1730	1720			
	Shot 8-1/4" casing at 1420'					
	Crushed stone	1420	1400			
	Cement	1400	1390			
	Crushed stone	1390	1380			
	Clay	1380	1050			
	Crushed stone	1050	1040			
	Cement	1040	1025			
	Left 10" csg. in as permanent vent to the surface. Swedged to 3" at surface.					
	3" extends to approx 6' above surface					
COAL SEAMS	DESCRIPTION OF MONUMENT					
(NAME)						
(NAME)						
(NAME)						
(NAME)						

and that the work of plugging and filling said well was completed on the 17th day of November, 19 49.

And further deponents saith not. SIGNED: Victor E. Tennant

A. P. Haught

Sworn to and subscribed before me this 1st day of February, 19 50

08/25/2023

SIGNED: John E. Henderson

Notary Public.

My commission expires: January 2, 1955

Permit No. MAR-652

RECEIVED
78



STATE OF WEST VIRGINIA
DEPARTMENT OF MINES
OIL AND GAS WELLS DIVISION

RECEIVED
MAY 5 - 1983

NOTICE OF INTENTION TO PLUG AND ABANDON WELL
(REQUIRED BY SECTION 9, ARTICLE 4, CHAPTER 22 OF THE CODE)

TO THE DEPARTMENT OF MINES,
Charleston, W. Va.

Consolidation Coal Company
Coal Operator
P. O. Box 1314, Morgantown, WV 26507-1314
Address
Same
Coal Owner
Consolidation Coal Company
Lease or Property Owner
P. O. Box 1314, Morgantown, WV 26507-1314
Address

Consolidation Coal Company
Name of Well Operator
P. O. Box 1314, Morgantown, WV 26507-1314
Complete Address
April 25, 1983
Date
WELL TO BE ABANDONED
Paw Paw District
Marion County
Well No. Consol (3805) Edgar E. Fox #1
Old Edgar E. Fox Farm

Inspector William Blosser Telephone 363-9105

TO BE NOTIFIED 24 HOURS IN ADVANCE OF PLUGGING OPERATIONS
Gentlemen:—

The undersigned well operator is about to abandon the above described well and will commence the work of plugging and abandoning said well on the date inspector is notified (which date shall not be less than five days after the day on which this notice so mailed is received, or in due course should be received by the Department of Mines).

This notice is given you in order that your respective representatives may be present at the plugging and filling of said well. You are further notified that whether you are represented or not represented the undersigned will proceed on that date, or shortly thereafter, to plug and fill said well in the manner required by Section 10, Article 4, Chapter 22 of the Code and given in detail on the reverse side of this notice, in "Work Order."

This notice is being mailed by registered mail to each of you at the above addresses on the above date.

Very truly yours,
Roger E. Duckworth
Well Operator

NOTE: Upon the abandonment of any well drilled prior to June 1, 1929, a plat prepared by a registered engineer, shall be filed with THREE COPIES OF APPLICATION, (OG-9) AND "WORK ORDER" AND TWO COPIES OF THE WELL RECORD, (OG-10). The map must show the district and county in which the tract of land is located, the name and acreage of same, the name or names of the owners and names of adjacent tracts and the location of the well to be abandoned, determined by survey with the courses and distances of such well from two permanent points or landmarks on said tract, in compliance with Rule 5 of the Rules and Regulations.

NOTE: In case plugging is not commenced within four months from the date of permit, same shall expire and be of no further force or effect.

NOTE: PERMIT IS NOT TRANSFERABLE.

049-0750-Red-P
Permit Number

ATTENTION, FORM OG-8, MANNER WELL PLUGGED MUST BE SUBMITTED TO OBTAIN RELEASE OF WELL UNDER BOND

PROPOSED MANNER OF PLUGGING AND FILLING WELL

(REQUIRED BY RULES AND REGULATIONS)

WEST VIRGINIA DEPARTMENT OF MINES
OIL AND GAS DIVISION
WORK ORDER

Well to be plugged and filled as follows:

1. Clean out wellbore to T.D., if practical.
2. Fill wellbore with fluid such that an "overbalanced" condition exists in the wellbore.
3. Set through tubing, by the "balanced plug" method, an expandable cement plug adhering to the following specifications:
 - a. The bottom of the cement plug shall be no less than 300' below the lowest mineable coal seam and shall extend to no less than 100' below the lowest mineable coal seam. (The plug shall be no less than 200' in length).
4. Run 4½" O. D. vent pipe to the top of the expandable cement plug (100' below the lowest mineable coal seam).
5. Cement the 10" x 4½" annulus from the bottom of the 4½" O. D. casing to the surface and 20' inside the 4½" O. D. pipe with expandable cement.

(See Exhibit No. 1)

To the Department of Mines
Coal Owner or Operator,
Lease or Property Owner.

IF PARTIAL PLUGGING
PLEASE SUBMIT REVISED WELL RECORD
WHEN WORK IS COMPLETED.

Gentlemen:

This "work order" is submitted for your approval and concurrence and unless notified of your disapproval or non-concurrence, the undersigned will proceed with the plugging and filling of said well in the above described manner on the date inspector is notified after permit is issued.

Very truly yours,

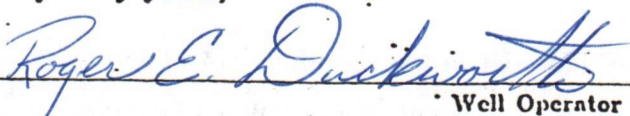
Well Operator

No objections have been filed by the coal owner or coal operator, or any available adjacent lease or property owners or interposed by the Department of Mines to the manner herein described for the plugging and filling of the well above mentioned. Therefore, the same is hereby approved this

18th day of May, 1983.

DEPARTMENT OF MINES
Oil and Gas Division

08/25/2023

By: 

NOTE: This "work order" shall be filed in triplicate, one copy for the files of the Department of Mines; one to be approved or corrected and returned to the well operator as his authority for plugging said well; and one for the well inspector.

STATE OF WEST VIRGINIA
DEPARTMENT OF MINES
OIL AND GAS WELLS DIVISION

RECEIVED
JUN 28 1983

AFFIDAVIT OF PLUGGING AND FILLING WELL OIL & GAS DIVISION
DEPT. OF MINES

AFFIDAVIT SHOULD BE MADE IN TRIPLICATE. ONE COPY MAILED TO THE DEPARTMENT, ONE COPY TO BE RETURNED BY THE WELL OPERATOR AND THE THIRD COPY (AND EXTRA COPIES IF REQUIRED) SHOULD BE MAILED TO EACH COAL OPERATOR AT THEIR RESPECTIVE ADDRESSES.

Consolidation Coal Company <small>COAL OPERATOR OR OWNER</small> P. O. Box 1314, Morgantown, WV 26507-1314 <small>ADDRESS</small> Same <small>COAL OPERATOR OR OWNER</small> Consolidation Coal Company <small>ADDRESS</small> Consolidation Coal Company <small>LEASE OR PROPERTY OWNER</small> ADDRESS	Consolidation Coal Company <small>NAME OF WELL OPERATOR</small> P. O. Box 1314, Morgantown, WV 26507-1314 <small>COMPLETE ADDRESS</small> June 17, 1983 <small>WELL AND LOCATION</small> Paw Paw District Marion County Well No. Consol 3805 Old Edgar E. Fox Farm STATE INSPECTOR SUPERVISING PLUGGING William Blosser
--	---

AFFIDAVIT

STATE OF WEST VIRGINIA,

County of Monongalia }
 Larry Yost

ss:

and David Yost

being first duly sworn according to law depose and say that they are experienced in the work of plugging and filling oil and gas wells and were employed by _____ well operator, and participated in the work of plugging and filling the above well, that said work was commenced on the 25th day of May, 1983, and that the well was plugged and filled in the following manner:

SAND OR ZONE RECORD FORMATION	FILLING MATERIAL	PLUGS USED SIZE & KIND	CASING	
			CSG PULLED	CSG LEFT IN
Cleaned wellbore to 1381'. Found 10" casing from 722' to surface. Cut 10" at 706' and 713'.		4 1/2" casing	1368' to	828'
Perforated 10 shots from 660' to 650'. Ran coal protection string as follows: 4 1/2" casing from 1368' to 828'. 8 5/8" casing from 828' to surface. Ran cement as follows: Pumped 475 sacks of expanding cement and was unable to circulate. Ran cement bond log and found top of cement at 661'. Perforated 4 holes from 656' to 657'. Established circulation and cemented to surface. Cleaned wellbore to 828' and removed water.		8 5/8" casing 10" casing	828' to	surface surface
COAL SEAMS		DESCRIPTION OF MONUMENT		
(NAME) Pittsburgh	706' - 714'	Five feet of 4 1/2" casing with plaque stating: Consol 3805 049-0750-RED-P		
(NAME)				
(NAME)				
(NAME)				

and that the work of plugging and filling said well was completed on the 7th day of June, 1983

And further deponents saith not.

Sworn to and subscribed before me this 23rd day of June, 1983

Larry L. Yost
David D. Yost
 08/25/2023
Kelli D. Wilson

My commission expires:

March 25, 1993

Notary Public.

Permit No. 049-0750- RED-P

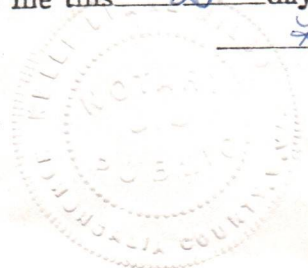

08/25/2023

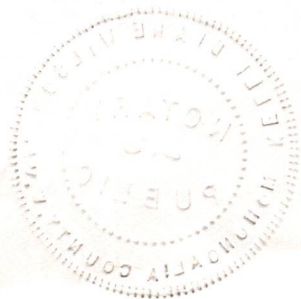



RECEIVED
MAY 8 - 1984
OIL & GAS DIVISION
DEPT. OF MINES

State of West Virginia
Department of Mines
Oil and Gas Division
Charleston 25305
FINAL INSPECTION REPORT
INSPECTORS COMPLIANCE REPORT

COMPANY CONSOLIDATION COAL CO.
MORGANTOWN W.V.

PERMIT NO 049-750R-P
FARM & WELL NO E. FOX (CON COAL) 1-3805
DIST. & COUNTY PAW-PAW/MARION

RULE	DESCRIPTION	IN COMPLIANCE	
		Yes	No
23.06	Notification Prior to Starting Work	_____	_____
16.01	Required Permits at Wellsite	_____	_____
17.02	Method of Plugging	_____	_____
18.01	Materials used in Plugging	_____	_____
23.02	Maintained Access Roads	_____	_____
25.01	Necessary Equipment to Prevent Waste	_____	_____
23.04	Reclaimed Drilling Pits	<u>✓</u>	_____
23.05	No Surface or Underground Pollution	_____	_____
17.06	Statutory Affidavit	_____	_____
7.06	Parties Responsible	_____	_____
7.05	Identification Markings	<u>✓</u>	_____

I HAVE INSPECTED THE ABOVE CAPTIONED WELL AND RECOMMEND THAT IT BE RELEASED:

SIGNED Dwight B. Ellis
DATE 5-2-84

Your Affidavit of Plugging was received and reclamation requirements approved. The well designated by the above permit number has been released under your bond.

T. H. ...
Administrator-Oil & Gas Division

May 18, 1984
DATE

08/25/2023

Latitude 39° 40'

Longitude 80° 15'

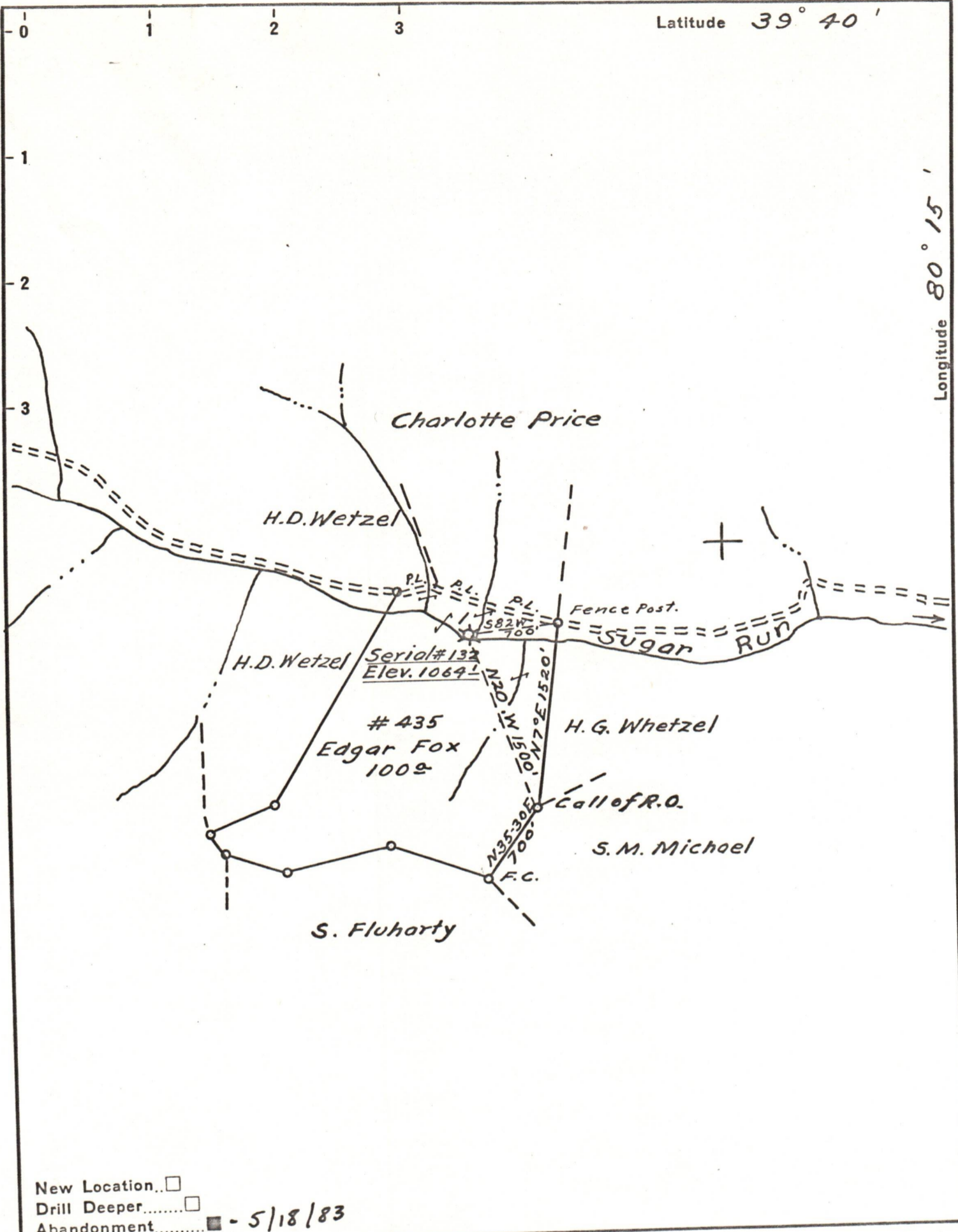

New Location..
 Drill Deeper.....
 Abandonment..... - 5/18/83

Company Consolidation Coal Company
 Address PO Box 1314 - Morgantown WVa 26505
 Farm Edgar Fox
 Tract _____ Acres 100 Lease No. 435
 Well (Farm) No. 1 Serial No. 432
 Elevation (Spirit Level) 1064'
 Quadrangle Mannington 6-5437" N182"
 County Marion District POW POW
 Engineer T.S. Flournoy
 Engineer's Registration No. 269
 File No. _____ Drawing No. _____
 Date Oct. 26, 1949 Scale 1" = 1000'

STATE OF WEST VIRGINIA
 DEPARTMENT OF MINES
 OIL AND GAS DIVISION
 CHARLESTON

WELL LOCATION MAP

FILE NO. 049-0750-Red-P

Formerly: Mar-652-A 08/25/2023

+ Denotes location of well on United States Topographic Maps, scale 1 to 62,500, latitude and longitude lines being represented by border lines as shown.

- Denotes one inch spaces on border line of original tracing.