

LATITUDE 39° 30' 00"

LONGITUDE 80° 51' 08"

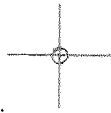

7'5 OGIS topo location

7.5' loc 1.245 15' loc _____
 1.47 w (calc.) _____

Company _____

Farm _____

Quad SHINUSTON 7 1/2'

County MARION

District LINCOLN

(Elev 1205 ± (7000))

WELL LOCATION MAP

File No. 049-0388

HOPE NATURAL GAS COMPANY. ✓

LOCATION FOR WELL No. 3925

DISTRICT

On *John Martin* Farm, on waters of *Carroll River*

Carroll District, *Carroll* County, West Virginia

Lease No. *21234* Acres *42* N. *2* S. E. *19* W.

Scale, one inch equals

800 feet Sent to Clarksburg Office

Sept 1 1915

Location to be *600 feet from D.S. Martin farm + same distance from mine line as Fairmont Gas Co #1*

Consolidation Coal Co. Eng. Fairmont, W. Va.

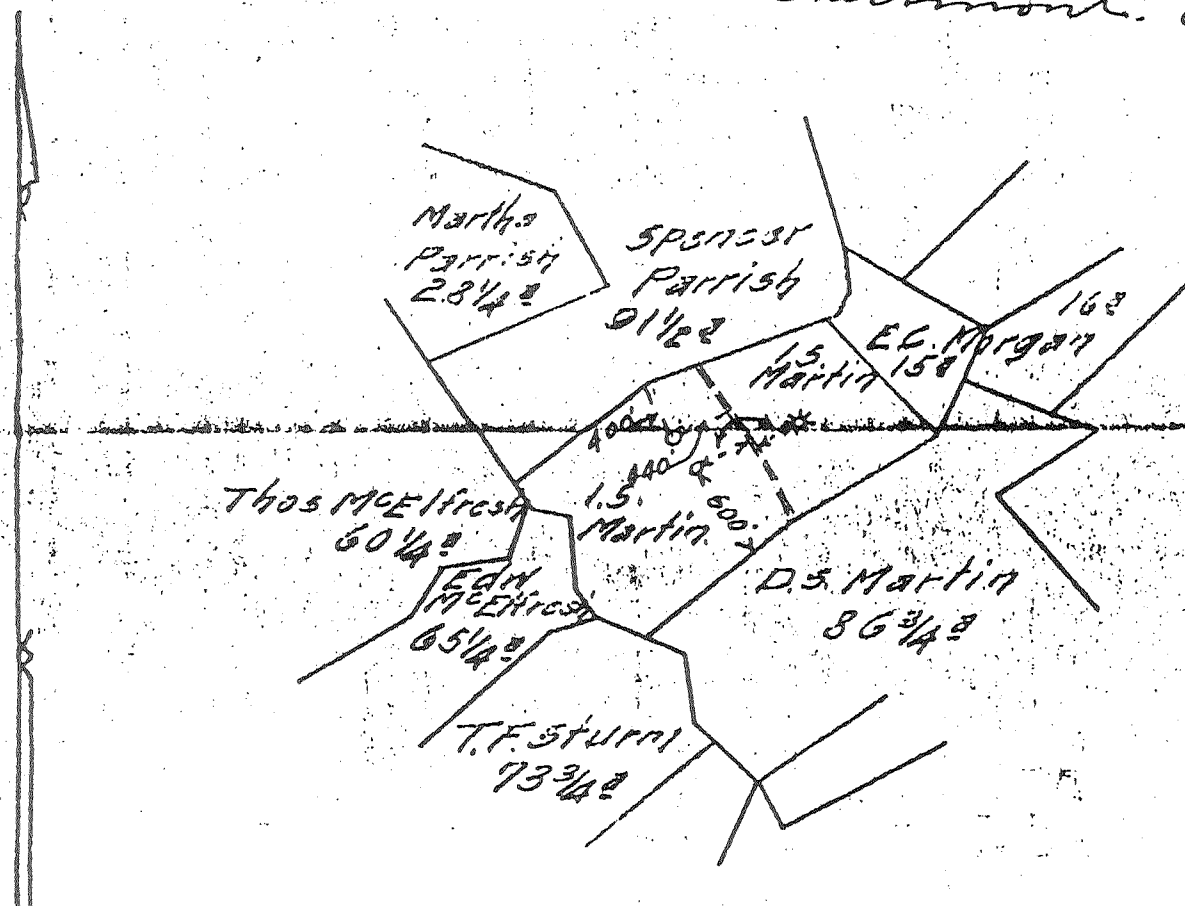

30

APC-049-0388

Title

RESERVE *None*

SPECIAL INSTRUCTIONS: Complete Well on or Before *July 2 1916*

Consolidation Coal Co.

Location made *9-24-15* by *W.H. Bradley* as per plat, except as noted. On field map

4-25-15 Returned to Pittsburgh *9-25-15*

Location changed on account of *Consolidation Coal Co.*

Authorized by *J. Blain* Date *9-22-15* Signed *W.H. Bradley*

Well No. 39254
 Located on 1011/2 Carter
 District Lincoln County Marion State W.Va

Location Made 9-24-15 First Work Done 10-28-1915
 Rig Commenced 10-20-15 Rig Completed 10-26-15
 Drilling Commenced 11-2-15 Drilling Completed 3-8-16
 Rig Contractor John Natural Gas Co Drilling Contractor W. H. B. Co
 Drillers Wm. Flick Frank Garvey O. Summers John Burns Frank Garney
 Tool Dressers G. O. Ginkel F. Leonard Mike Flanagan

FORMATION	TOP	BOTTOM	Steel Line Measurements	Water Found Depth	Oil Found Depth	Gas Found Depth	REMARKS
Surface	430	436					
Pittsburg Coal	546	554					
Little Dunkard	910	950					
Gas Sand	1200	1245					5 1/16" 2798
First Salt	1325	1375		1485			
Second Salt	1450	1563		1500			Hole Full
Little Lime	1820	1828					
Pencil Cave	1828	1838					
Big Lime	1838	1917					
Big Isjun	1917	2015	1917				1932 42/10 Water 2" of sg. 273 Meft
Squaw							
Berea							
Gantz							
Fifty Foot	2405	2455	2405				
Thirty Foot	2470	2510	2470				
Gordon Stray	Shell						
Gordon	2790	2806	2790				
Fourth	2848	2854	2848				
Fifth	2925	2945	2925				2930 68/10 Water 2" of sg. 2936 348 Meft
Dayard							
Total Depth		2970	2970				

SIZE	Charged to Well		Put in Well		Pulled Out		Left in Well		Transferred Before Completion		Left of Well Not in Use		If more than two strings of casing are left in hole, give reasons for leaving additional strings
	Feet	In.	Feet	In.	Feet	In.	Feet	In.	Feet	In.	Feet	In.	
13" Csg.													
10" "	702	2	606	2			606	2	81	6	14	6	
8 1/4" "	1603	11	1473	3			1473	3	83	3	47	5	
6 5/8" "	2056	7	1890	-			1890	-	47	-	119	7	
5 3/16" "	2994	7	2812	6			2812	6			182	1	
2 Tbg.	669	3									669	3	No id to Run Cement

PACKER RECORD

SIZE	KIND	Amount Asker	Amount Above Asker	REMARKS
10x15	F. Grange		604	
8 1/4	Steel Shov		1454	
6 5/8	"		1872	
5 3/16	"	3-6	2794	

SHOOTING RECORD (If shot before or upon completion of well)

DATE	Quarts	Top of Shell	Bottom of Shell	Diameter	Sand	Test Before Shot			Test After Shot			Test Taken After Shot No. Hours	By Whom Shot
						Reading	Liquid	Opening	Reading	Liquid	Opening		
3-10-16	15	2929	2938	3x9	5 1/2	68/10	Water	2	90/10	W	2	John Marquette	Y. Base

CEMENTING RECORD

Date Cemented 11-16-15 Size Hole Cemented 1 1/2" Size Casing Cemented 1 1/2"
 Top Pittsburg Coal 546 Top Cementing 461 Amount Cement Used 4500 lb
 Bottom Pittsburg Coal 554 Bottom Cementing 604 Amount Sand Used 9000 lb
 Mr. H. Perry Dent Co. Garrett Cement Company on ground when coal was cemented
 Remarks: Water under 8 1/2' Gallego under 2454 at 30 ft from shell
 Signature of persons who cemented well: John Marquette
 Approved by: John Marquette Foreman

APL-049-0388