

Jackson Resources Co. Gas Well 233

WV South N.A.D. 27 GRID NORTH

LONGITUDE: 81°50'00"

10,452'

LATITUDE: 37°45'46.61"N

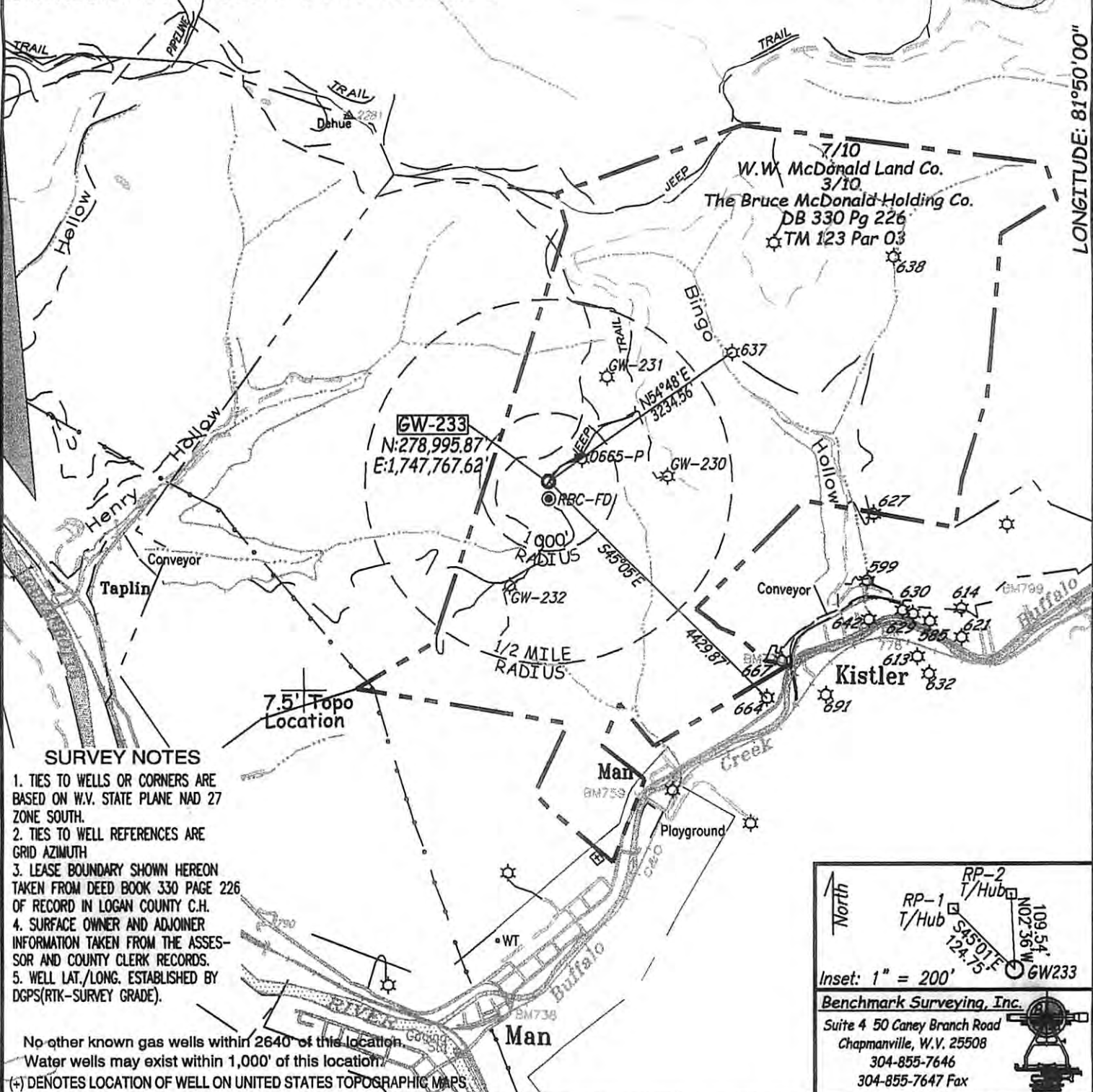

- SURVEY NOTES**
1. TIES TO WELLS OR CORNERS ARE BASED ON W.V. STATE PLANE NAD 27 ZONE SOUTH.
 2. TIES TO WELL REFERENCES ARE GRID AZIMUTH
 3. LEASE BOUNDARY SHOWN HEREON TAKEN FROM DEED BOOK 330 PAGE 226 OF RECORD IN LOGAN COUNTY C.H.
 4. SURFACE OWNER AND ADJOINER INFORMATION TAKEN FROM THE ASSESSOR AND COUNTY CLERK RECORDS.
 5. WELL LAT./LONG. ESTABLISHED BY DGPS(RTK-SURVEY GRADE).

No other known gas wells within 2640' of this location.
 Water wells may exist within 1,000' of this location.
 (+) DENOTES LOCATION OF WELL ON UNITED STATES TOPOGRAPHIC MAPS

Inset: 1" = 200'

Benchmark Surveying, Inc.
 Suite 4 50 Caney Branch Road
 Chapmanville, W.V. 25508
 304-855-7646
 304-855-7647 Fax

FILE NO. 2008-130
 DRAWING NO. 233
 SCALE 1" = 2,000'
 MINIMUM DEGREE OF ACCURACY 1:2,500'
 PROVEN SOURCE OF ELEVATION NGVD 29 VERTICAL DATUM
VIA OPUS OBSERVATION

I THE UNDERSIGNED, HEREBY CERTIFY THAT THIS PLAT IS CORRECT TO THE BEST OF MY KNOWLEDGE AND BELIEF AND SHOWS ALL THE INFORMATION REQUIRED BY LAW AND THE REGULATIONS ISSUED AND PRESCRIBED BY THE DEPARTMENT OF ENVIRONMENTAL PROTECTION.
 (SIGNED) Kenneth D. Bias
 P.S. 837-SU

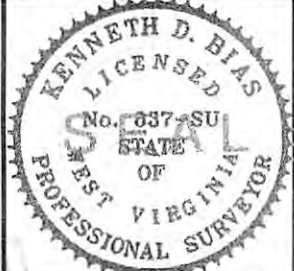

STATE OF WEST VIRGINIA
 DEPARTMENT OF ENVIRONMENTAL PROTECTION
 OIL AND GAS DIVISION

DATE: October 8th 2008
 OPERATOR'S WELL NO. 233
 API WELL NO. 47 - 045 - 02339

WELL TYPE: OIL GAS LIQUID INJECTION WASTE DISPOSAL
 (IF "GAS,") PRODUCTION STORAGE DEEP SHALLOW C.B.M. CANCELLED

LOCATION: ELEVATION 2190.97' WATER SHED Un-named Tributary of Buffalo Creek of the Guyandotte River
 DISTRICT Triadelphia COUNTY Logan
 QUADRANGLE Amherstdale, W.V. 7.5'

SURFACE OWNER W.W. McDonald Land Co. & The Bruce McDonald Holding Co. ACREAGE 1,156.8 Acres
 OIL & GAS ROYALTY OWNER McDonald Land/Feanster et. al. LEASE ACREAGE 1,182.05 Acres
 LEASE NO. _____

PROPOSED WORK: DRILL CONVERT DRILL DEEPER REDRILL FRACTURE OR STIMULATE PLUG OFF OLD FORMATION PERFORATE NEW FORMATION OTHER PHYSICAL CHANGE IN WELL (SPECIFY) _____

PLUG AND ABANDON CLEAN OUT AND REPLUG
 TARGET FORMATION Devonian ESTIMATED DEPTH _____
 WELL OPERATOR Jackson Resources Company DESIGNATED AGENT Dale Coleman
 ADDRESS 24 Second Street, Hamlin, West Virginia 25523 ADDRESS 24 Second Street, Hamlin, West Virginia 25523

FORM WW-6

LOGAN COUNTY NAME PERMIT