

WW-7
8-30-06



West Virginia Department of Environmental Protection
Office of Oil and Gas
WELL LOCATION FORM: GPS

API: 47-045-00262 WELL NO.: WV 018140 (Ritter #106)

FARM NAME: Ritter Lumber Company

RESPONSIBLE PARTY NAME: EQT Production Company

COUNTY: Logan DISTRICT: Triadelphia

QUADRANGLE: Mallory 7.5'

SURFACE OWNER: Heartwood Forestland Fund IV

ROYALTY OWNER: Plum Creek Timberlands, LP

UTM GPS NORTHING: 4173613

UTM GPS EASTING: 432864 GPS ELEVATION: 433 m (1422 ft)

The Responsible Party named above has chosen to submit GPS coordinates in lieu of preparing a new well location plat for a plugging permit or assigned API number on the above well. The Office of Oil and Gas will not accept GPS coordinates that do not meet the following requirements:

- Datum: NAD 1983, Zone: 17 North, Coordinate Units: meters, Altitude: height above mean sea level (MSL) – meters.
- Accuracy to Datum – 3.05 meters
- Data Collection Method:
Survey grade GPS : Post Processed Differential
Real-Time Differential
Mapping Grade GPS X: Post Processed Differential X
Real-Time Differential

4. **Letter size copy of the topography map showing the well location.**

I the undersigned, hereby certify this data is correct to the best of my knowledge and belief and shows all the information required by law and the regulations issued and prescribed by the Office of Oil and Gas.

Ben B. Saylor
Signature

P.S. 2092
Title

10/11/13
Date

Topo Quad: Mallory

Scale: 1" = 2000'

County: Logan

Date: September 27, 2013

District: Triadelphia

Project No: 21-21-00-08

47-045-00262 "Ritter #106" WV 018140

Topo

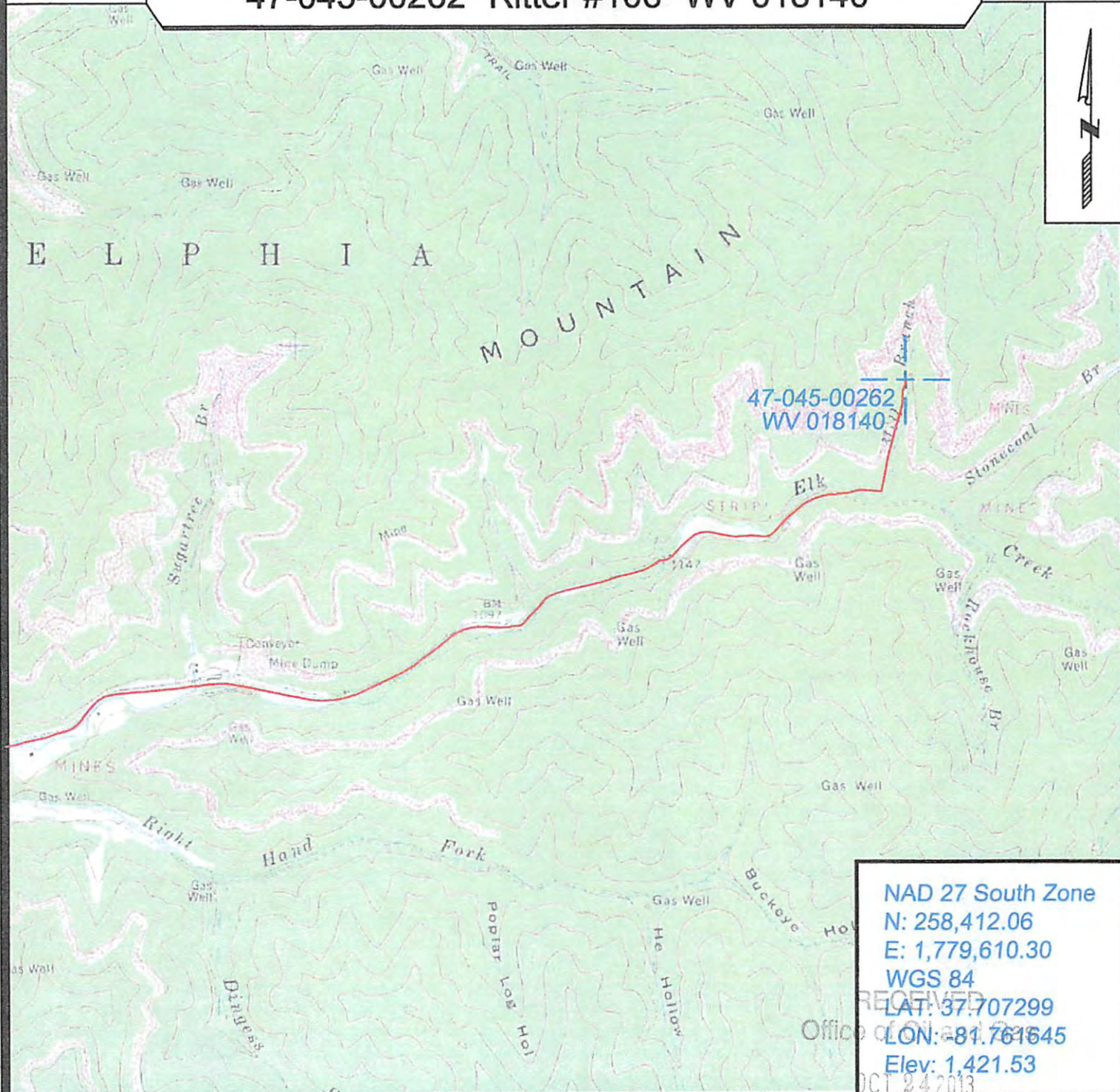

NAD 27 South Zone
 N: 258,412.06
 E: 1,779,610.30
 WGS 84
 LAT: 37.707299
 LON: -81.761645
 Elev: 1,421.53



SURVEYING AND MAPPING SERVICES PERFORMED BY:
ALLEGHENY SURVEYS, INC.

1-800-482-8606
 P.O. BOX 438
 BIRCH RIVER, WV 26610
 PH: (304) 649-8606
 FAX: (304) 649-8608

PREPARED FOR:

WV Department of
 Environmental Protection
EQT Production Company
 P.O. Box 280
 Bridgeport, WV 26330