

Latitude 38° 20'

Longitude 82° 05'

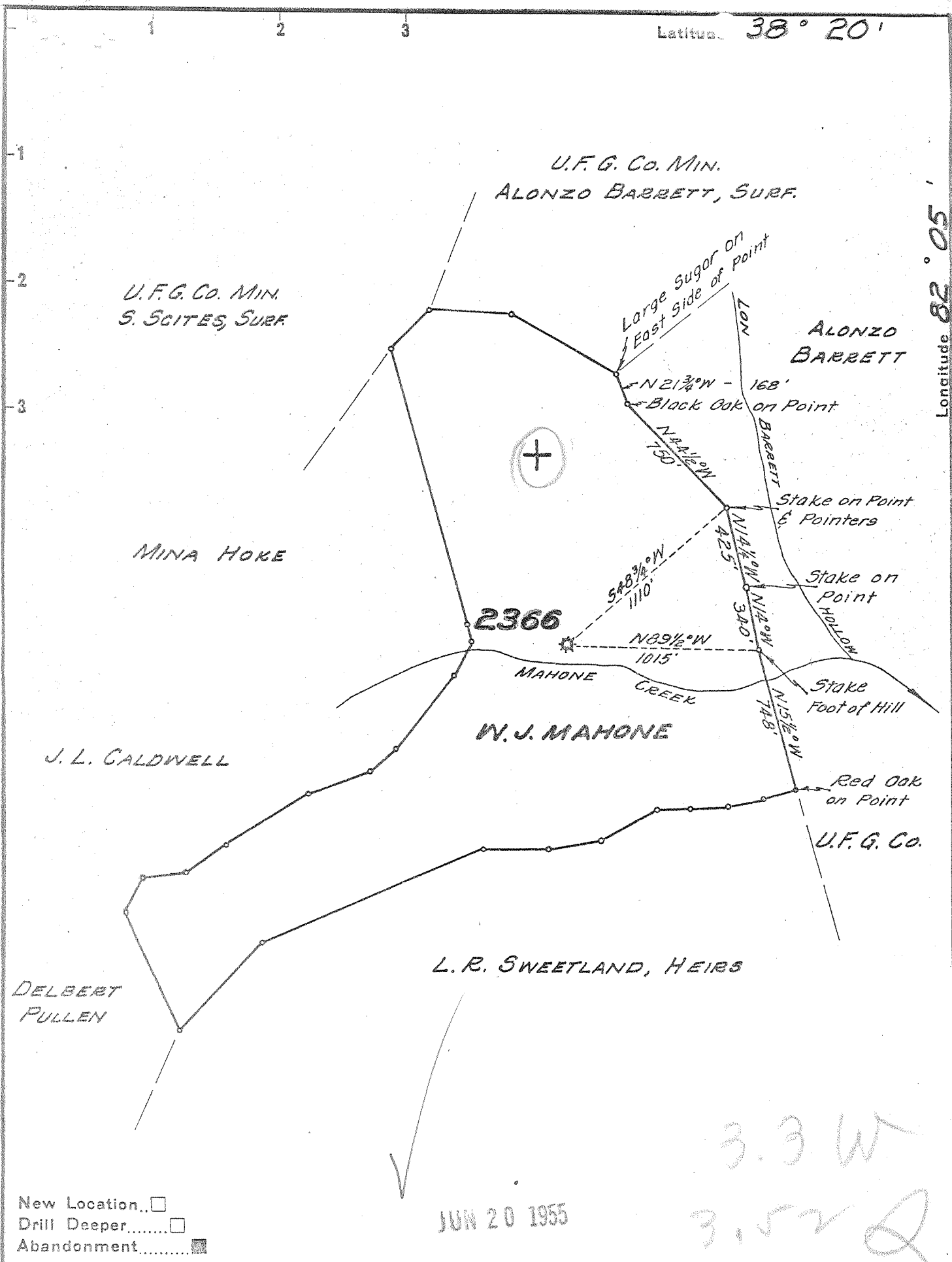

New Location
 Drill Deeper
 Abandonment

JUN 20 1955

3.3 W
 3.52 Q

Company UNITED FUEL GAS CO.
 Address CHARLESTON, W. VA.
 Farm W. J. MAHONE
 Tract _____ Acres 118 Lease No. 24639
 Well (Farm) No. _____ Serial No. 2366
 Elevation (Spirit Level) 693.7
 Quadrangle MILTON
 County LINCOLN District CARROLL
 Engineer Paul G. Osburn
 Engineer's Registration No. 669
 File No. 34-53 Drawing No. _____
 Date 5-6-55 Scale 1" = 600'

STATE OF WEST VIRGINIA
 DEPARTMENT OF MINES
 OIL AND GAS DIVISION
 CHARLESTON

WELL LOCATION MAP
 FILE NO. LIN-1163-A

+ Denotes location of well on United States Topographic Maps, scale 1 to 62,500, latitude and longitude lines being represented by border lines as shown.

- Denotes one inch spaces on border line of original tracing.

W. J. MAHONE No. 2366 — U. F. G. Co. — LIN-1163-A

1163A

Carroll District, Lincoln County, W. Va.

By United Fuel Gas Co.

On 100 acres; Branchland field; Lease No. 1116.

Drilling commenced June 17, 1921; completed, Aug. 4, 1921.

10" casing, 22'; 8 $\frac{1}{4}$ ", 321' 4" (pulled); 6 $\frac{5}{8}$ ", 1263' 10"; 5 $\frac{3}{8}$ ", 1551' 1";
2" tubing, 2051' 7".

Shut in Aug. 4, 1921, in 2 in. tubing.

1 - 5 $\frac{5}{16}$ " anchor packer; 1 - 6 $\frac{5}{8}$ " x 5 $\frac{3}{16}$ " B.H. packer; 1 - 6 $\frac{5}{8}$ " x 8 $\frac{1}{4}$ " B. H. packer.

1st perf. set 22' from bottom.

Test before shot, 10/10th water in 2".

Test after shot, 15/10ths Merc. in 2";

Rock pressure, 575 lbs.

No.....in Gas Report.

	Top.	Bottom.	Thickness.
Slate and shale	0	1180	1180
Little Lime	1180	1200	20
Pencil Cave	1200	1205	5
Big Lime	1205	1220	15
Slate	1220	1223	3
Big Lime (gas at 1365-1368')	1223	1408	185
Big Injun Sand	1408	1444	36
Slate and shell	1444	1450	6
Squaw Sand	1450	1472	22
Slate and shell	1472	1988	516
Berea Sand (gas)	1988	2005	17
Total depth		2031	



STATE OF WEST VIRGINIA
DEPARTMENT OF MINES
OIL AND GAS DIVISION

1474

Quadrangle Milton
Permit No. 1163 A

WELL RECORD

Oil or Gas Well Gas
(KIND)

Company UNITED FUEL GAS COMPANY
Address P.O. Box 1273, Charleston 25, W. Va.
Farm W. J. Mahone Acres 118
Location (waters) Mahone Creek
Well No. 2366 Elev. 693.7'
District Carroll County Lincoln
The surface of tract is owned in fee by _____
Address _____
Mineral rights are owned by J. B. McGhee, et al
2875 Third Ave. Address Huntington, W. Va.
Drilling commenced 6-17-21
Drilling completed 8-4-21
Date Shot 8-2-21 From _____ To _____
With 40 qts.
Open Flow 15 /10ths Water in _____ Inch
2 /10ths Merc. in _____ Inch
Volume 681,000 Cu. Ft.
Rock Pressure 575 lbs. _____ hrs.
Oil _____ bbls., 1st 24 hrs.
Fresh water 70 feet _____ feet
Salt water _____ feet _____ feet

Casing and Tubing	Used in Drilling	Left in Well	Packers
Size			
16			Kind of Packer
13			<u>B. H.</u>
10		<u>22'</u>	Size of
8 1/4	<u>321'4"</u>		<u>5-3/16x6-5/8</u>
6 5/8		<u>1263'10"</u>	Depth set
5 3/16		<u>1551'1"</u>	<u>1551'</u>
3			Perf. top
2		<u>2051'7"</u>	Perf. bottom
Liners Used			Perf. top
			Perf. bottom

CASING CEMENTED _____ SIZE _____ No. Ft. _____ Date _____

COAL WAS ENCOUNTERED AT 467 FEET 36 INCHES
_____ FEET _____ INCHES _____ FEET _____ INCHES
_____ FEET _____ INCHES _____ FEET _____ INCHES

Formation	Color	Hard or Soft	Top	Bottom	Oil, Gas or Water	Depth Found	Remarks
Native Soil			0	20			
Rock			20	40			
Shale			40	60			
Rock			60	70			Fresh water at 70'
Slate & Shells			70	140			
Sand			140	170			
Native Coal			170	178			
Sand			178	220			
Slate			220	230			
Sand			230	300			
Slate			300	315			
Sand			315	375			
Slate			375	385			
Sand			385	405			
Slate			405	467			
Coal			467	470			
Slate & Shell			470	550			
Sand			550	580			
Slate & Shell			580	675			
Sand			675	690			
Slate			690	715			
Sand			715	720			
Slate			720	750			
Sand			750	880			
Broken Sand			880	960			
Sand			960	1110			
Slate			1110	1150			
Red Rock			1150	1160			
Slate & Shell			1160	1180			
Little Lime			1180	1200			
Pencil Cave			1200	1205			
Big Lime			1205	1220			
Slate			1220	1223			Gas in Big Lime 1364-1368
Big Lime			1223	1408			
Big Injun			1408	1444			
Slate & Shell			1444	1450			Gas in Berea 1993-2001
Squaw			1450	1472			
Slate & Shell			1472	1988			Reduced hole at 1537
Berea			1988	2005			
Total depth			2031'				

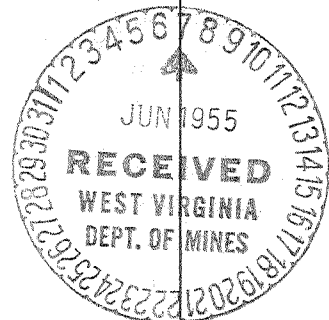

AUG 12 1955

(Over)

