

Latitude 39° 15'

Longitude 82° 10'

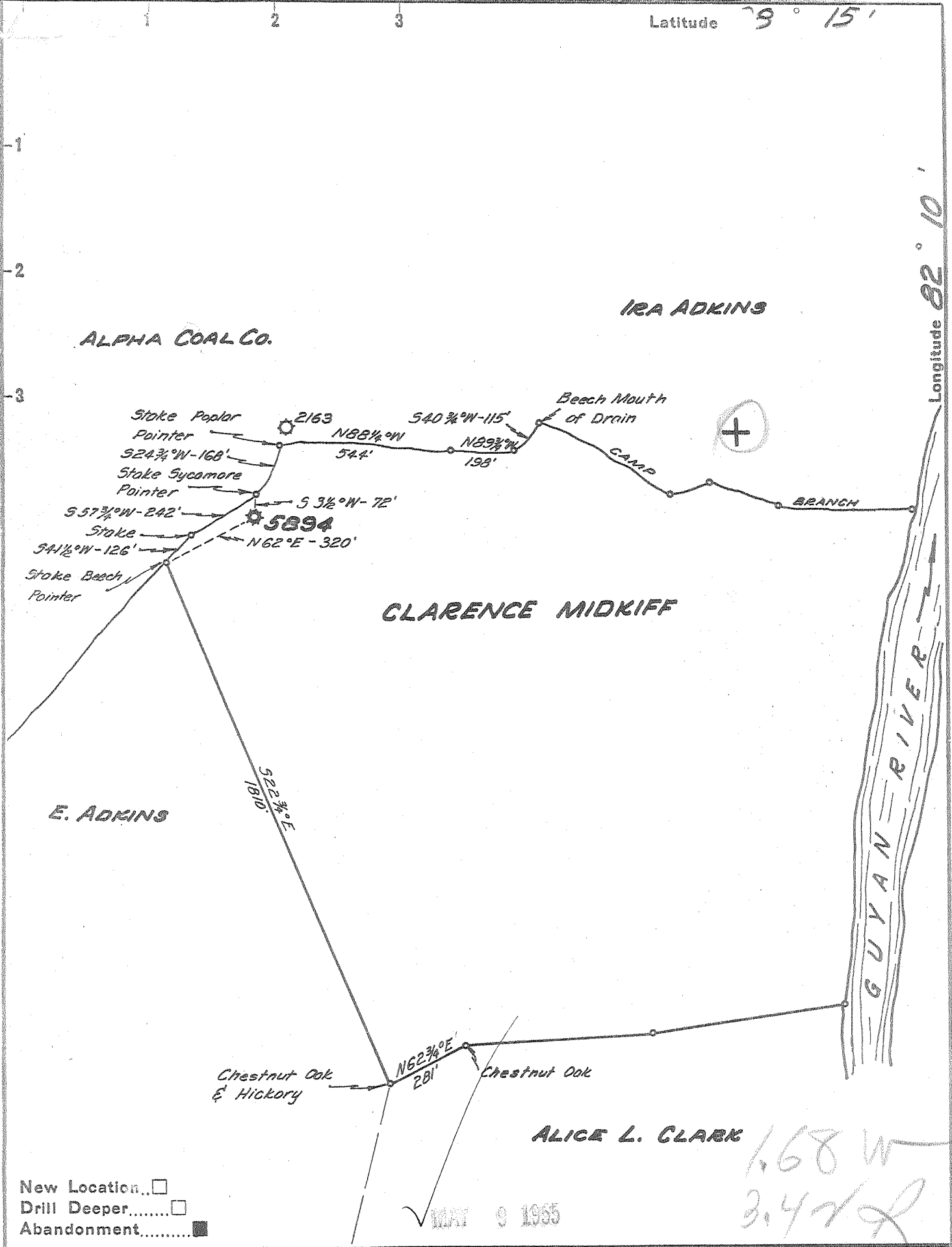

New Location   
 Drill Deeper   
 Abandonment

Company UNITED FUEL GAS CO.  
 Address CHARLESTON, W. VA.  
 Farm CLARENCE MIDKIFF  
 Tract \_\_\_\_\_ Acres 86 Lease No. 45197  
 Well (Farm) No. \_\_\_\_\_ Serial No. 5894  
 Elevation (Spirit Level) 618.0  
 Quadrangle MIDKIFF  
 County LINCOLN District SHERIDAN  
 Engineer Seayberry R. Howell  
 Engineer's Registration No. 2529  
 File No. 30-49 Drawing No. \_\_\_\_\_  
 Date 4-20-55 Scale 1"=400'

STATE OF WEST VIRGINIA  
 DEPARTMENT OF MINES  
 OIL AND GAS DIVISION  
 CHARLESTON

**WELL LOCATION MAP**  
 FILE NO. LIN-1145-A

+ Denotes location of well on United States Topographic Maps, scale 1 to 62,500, latitude and longitude lines being represented by border lines as shown.

- Denotes one inch spaces on border line of original tracing.



STATE OF WEST VIRGINIA  
DEPARTMENT OF MINES  
OIL AND GAS DIVISION

1437

Quadrangle Midkiff

Permit No. 145A

WELL RECORD

Oil or Gas Well Gas  
(KIND)

Company UNITED FUEL GAS CO.  
Address P.O. Box 1273, Charleston 25, W. Va.  
Farm Clarence Midkiff #27 Acres 86  
Location (waters) Camp Br. of Guyan River  
Well No. 5894 Elev. 618'  
District Sheridan County Lincoln  
The surface of tract is owned in fee by \_\_\_\_\_  
Address \_\_\_\_\_  
Mineral rights are owned by Howard Elkins, et al  
Address Midkiff, W. Va.  
Drilling commenced 9-14-14  
Drilling completed 10-15-14  
Date Shot 10-5-14 From 1270 To 1288  
With 80 qts.  
Open Flow 56 /10ths Water in \_\_\_\_\_ Inch  
2 /10ths Merc. in \_\_\_\_\_ Inch  
Volume 1,284,000 Cu. Ft.  
Rock Pressure 415 lbs. \_\_\_\_\_ hrs.  
Oil \_\_\_\_\_ bbls., 1st 24 hrs.  
Fresh water \_\_\_\_\_ feet \_\_\_\_\_ feet  
Salt water \_\_\_\_\_ feet \_\_\_\_\_ feet

Casing and Tubing	Used in Drilling	Left in Well	Packers
Size			
16			Kind of Packer <u>Special Gas</u>
13			
10		<u>38</u>	Size of <u>6-5/8x3x2</u>
8 1/4	<u>138</u>		
6 5/8		<u>1053</u>	Depth set
5 3/16			
3		<u>99</u>	Perf. top
2		<u>1204</u>	Perf. bottom
Liners Used			Perf. top
			Perf. bottom

CASING CEMENTED \_\_\_\_\_ SIZE \_\_\_\_\_ No. Ft. \_\_\_\_\_ Date \_\_\_\_\_  
COAL WAS ENCOUNTERED AT 160 FEET 60 INCHES  
\_\_\_\_\_ FEET \_\_\_\_\_ INCHES FEET \_\_\_\_\_ INCHES  
\_\_\_\_\_ FEET \_\_\_\_\_ INCHES FEET \_\_\_\_\_ INCHES

Formation	Color	Hard or Soft	Top	Bottom	Oil, Gas or Water	Depth Found	Remarks
Gravel			0	35	Gas from Big Injun		
Slate			35	100			
Sand			100	135			
Slate			135	160			
Coal			160	165			
Slate			165	295			
Sand			295	330			
Slate			330	400	Show of gas in Big Line 1173'		
Salt Sand			400	820			
Slate			820	830			
Red Rock			830	840			
Slate			840	870			
Lime			870	885			
Sand			885	918			
Slate			918	935			
Red Rock			935	940			
Slate			940	973			
Red Rock			973	980			
Slate			980	1015			
Little Lime			1015	1040			
Pencil Cave			1040	1045			
Big Lime			1045	1233			
Red Rock			1233	1253			
Slate			1253	1265			
Injun Sand			1265	1292			
Slate			1292	1306			
Total depth			1306'				



AUG 12 1955

(Over)

