

Latitude 38° 15'

Longitude 82° 10'

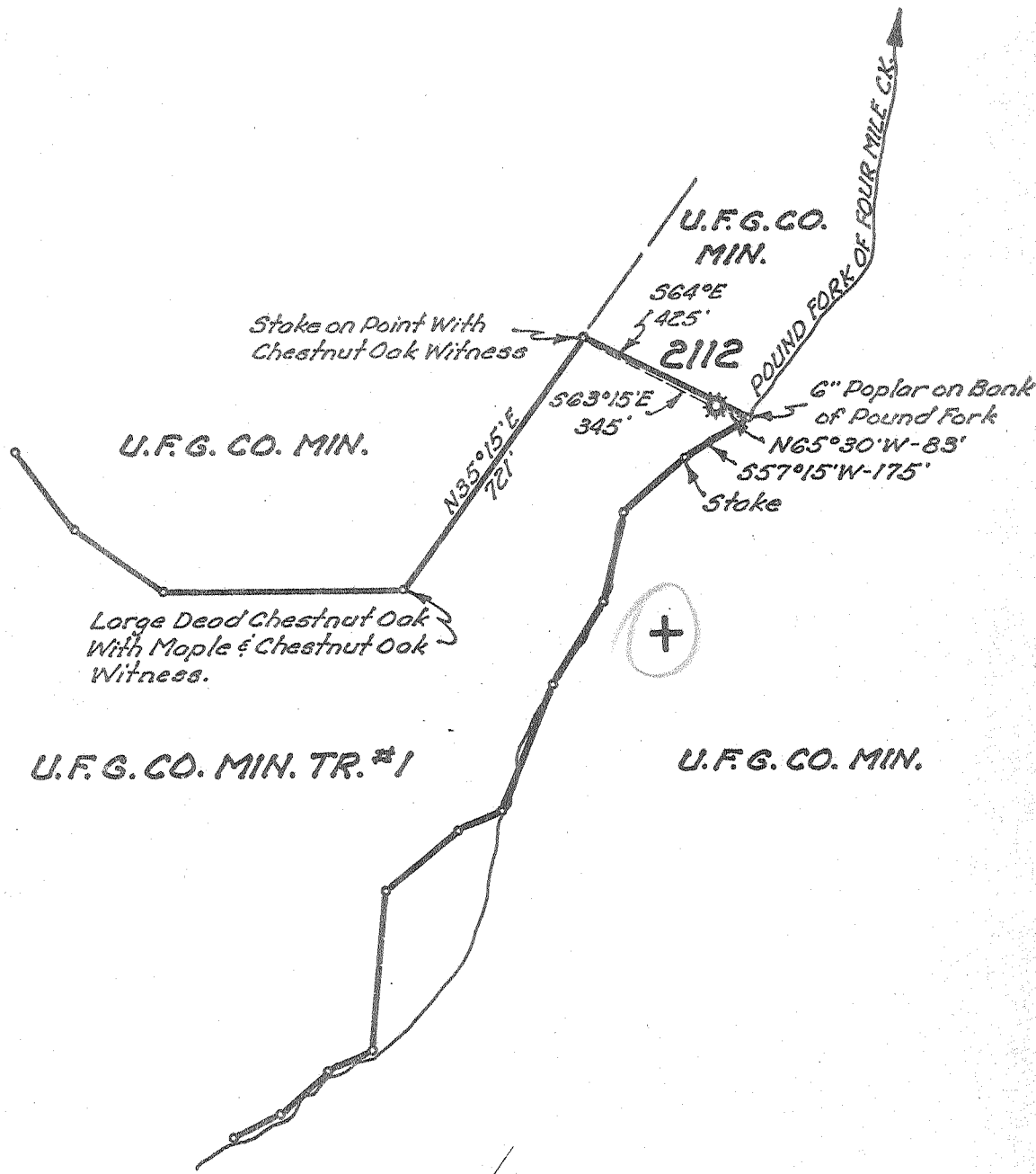

New Location
 Drill Deeper
 Abandonment

DEC 27 1954

2.9 W
5.4 Q

Company UNITED FUEL GAS CO.
 Address CHARLESTON, W.VA.
 Farm U.F.G. CO. MIN. TR. #1
 Tract 1 Acres 24,293 ^{Ref.} Case No. 24689
 Well (Farm) No. _____ Serial No. 2112
 Elevation (Spirit Level) 755.61'
 Quadrangle MIDKIFF
 County LINCOLN District LAUREL HILL
 Engineer Paul E. Joachim
 Engineer's Registration No. 669
 File No. 30-47 Drawing No. _____
 Date 12-8-54 Scale 1"=400'

STATE OF WEST VIRGINIA
 DEPARTMENT OF MINES
 OIL AND GAS DIVISION
 CHARLESTON

WELL LOCATION MAP
 FILE NO. LIN-1137-A

+ Denotes location of well on United States Topographic Maps, scale 1 to 62,500, latitude and longitude lines being represented by border lines as shown.
 - Denotes one inch spaces on border line of original tracing.

U.F.G. Co. (M. Tr. #1) No. 2112 - U.F.G. Co. - LIN-1137-A



STATE OF WEST VIRGINIA
DEPARTMENT OF MINES
OIL AND GAS DIVISION

1406

Quadrangle Midkiff

Permit No. 1137-A

WELL RECORD

Oil or Gas Well Gas
(KIND)

Company UNITED FUEL GAS CO.
 Address P.O. Box 1273, Charleston 25, W. Va.
 Farm U.F.G.Co. Min. Tr. #1 Acres 24,293.44
 Location (waters) Pound Fork
 Well No. 2112 Elev. 755.61
 District Laurel Hill County Lincoln
 The surface of tract is owned in fee by _____
 Address _____
 Mineral rights are owned by United Fuel Gas Co.
 Address _____
 Drilling commenced _____
 Drilling completed _____
 Date Shot _____ From _____ To _____
 With _____
 Open Flow _____ /10ths Water in _____ Inch
 _____ /10ths Merc. in _____ Inch
 Volume 2,500,000 Cu. Ft.
 Rock Pressure _____ lbs. _____ hrs.
 Oil _____ bbls., 1st 24 hrs.
 Fresh water 60-80' feet 420 feet
 Salt water 670 feet _____ feet

Casing and Tubing	Used in Drilling	Left in Well	Packers
Size			
16			Kind of Packer
13			
10			Size of
8 1/4			
6 3/4			Depth set
5 3/16			
3			Perf. top
2			Perf. bottom
Liners Used			Perf. top
			Perf. bottom

CASING CEMENTED _____ SIZE _____ No. Ft. _____ Date _____

COAL WAS ENCOUNTERED AT 80 FEET 36 INCHES
 _____ FEET _____ INCHES _____ FEET _____ INCHES
 _____ FEET _____ INCHES _____ FEET _____ INCHES

Formation	Color	Hard or Soft	Top	Bottom	Oil, Gas or Water	Depth Found	Remarks
Coal			80	83	Fresh water	60-80'	enough to drill with Hole full water 670'
Salt Sand			665	940	Water	420'	
Big Lime			1145	1368			
Big Injun			1400	1426			
Total depth			1426				
					Oil	1262-1263'	
					Gas	1401-1411'	
					FINAL OPEN FLOW	2,500 M	

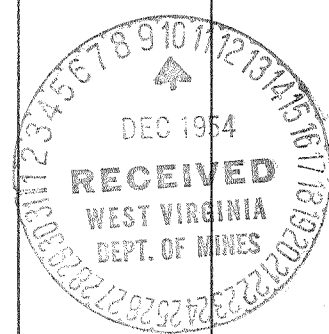

APR 22 1956

